

RED INDICATES ORIGINAL

DATA CONTAINED IN THIS DOCUMENT IS PROPRIETARY TO TROMPETER ELECTRONICS INC. AND SHALL NOT BE DISCLOSED, COPIED OR USED FOR PROCUREMENT OR MANUFACTURE WITHOUT EXPRESS WRITTEN PERMISSION.		REVISIONS		1-0421	SH 1
REV	ED	DESCRIPTION	DWN	APPROVED	DATE
H	12678	ADDED: -7 SEE ECO	R L	<i>[Signature]</i>	12/23/98

DASH NO	MODEL NO	IMPEDANCE VALUE	CASE COLOR	A DIM	
-1	LP-50	50 OHMS	GREEN	3.765	
-W1	LPW-50			3.458	
-2	LP-75	75 OHMS	VIOLET	3.765	
-W2	LPW-75			3.458	
-3	LP-93	93 OHMS	WHITE	3.765	
-W3	LPW-93			3.458	
-4	LP-4- \triangle	\triangle	BLACK	3.765	
-W4	LPW-4- \triangle			3.458	
-5	LP-5- \triangle		RED	3.765	
-W5	LPW-5- \triangle			3.458	
-6	LP-6- \triangle		GRAY	3.765	
-W6	LPW-6- \triangle			3.458	
-7	LP-7		\triangle	GREEN/BLACK	3.765

\triangle \triangle

INCH	MM
.010	0.25
.030	0.76
.540	13.72
.590	14.99
.625	15.88
1.200	30.48
2.250	25.40
3.485	88.52
3.765	95.63

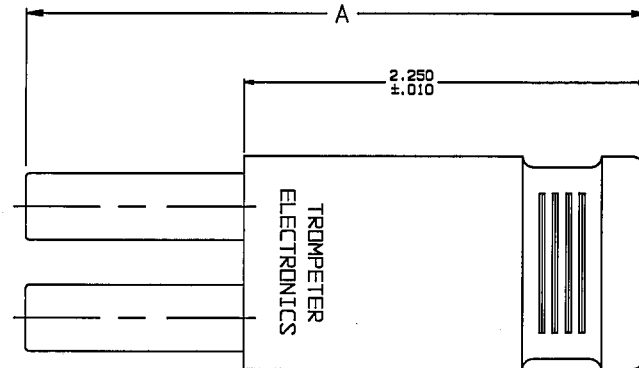
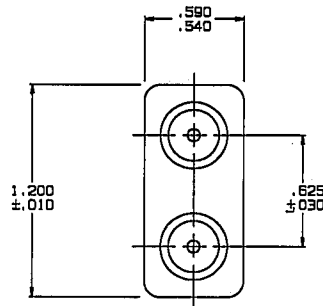

-W2, -W4-75, -W5-75 & -W6-75 SHOWN

- \triangle 50 OHMS DOUBLE SHIELDED RG223-M17/167-00001
- \triangle IMPEDANCE VALUE OF -4 THRU -W6, MAY BE -50, -75, OR -93 (OHMS). EXAMPLE: 1-0421-4-50, -4-75, ETC
- \triangle PREFIX "W" DENOTES W.E.CO. TYPE. ALL OTHERS ARE RCA
- 3. COAXIAL STANDARD SIZE LOOPING PLUG
- 2. FINISH: BARREL, TFS-1U (NICKEL) CASE (SEE CHART)
- 1. ALL DIMENSIONS ARE IN INCHES

QTY	DESCRIPTION	PART NUMBER	ITEM
TOL. UNLESS SPECIFIED INCH ± .030 MILL ± .030 ANGLES	TROMPETER ELECTRONICS, INC.	LP / LPW	
DWN <i>[Signature]</i> 12/21/98	MATERIAL	CODE IDENT	DRAWING NO.
CHK <i>[Signature]</i> 12.21.98		14949	1-0421
ENGR			REV H
APPR <i>[Signature]</i> 12/22/98	SCALE: 2/1	DATE: 6-25-74	SHEET 1 OF 2

Mouser Electronics

Authorized Distributor

Click to View Pricing, Inventory, Delivery & Lifecycle Information:

[Emerson Connectivity Solutions:](#)

[LP-75](#)