

FP1010R

High frequency, high current power inductors



Applications

- Multi-phase and Vcore regulators
- Voltage Regulator Modules (VRMs)
 - Server and desktop
 - Central processing unit (CPU)
 - Graphics processing unit (GPU)
- Application specific integrated circuit (ASIC)
- High power density
- Data networking and storage systems
- Graphics cards and battery power systems
- Portable electronics
- Point-of-Load modules
- DCR Sensing circuits

Description

- High current carrying capacity
- Low core loss
- Magnetically shielded
- Tight tolerance DCR for sensing circuits
- 10 mm x 7.0 mm footprint surface mount package in a 10 mm height
- Ferrite core material
- Halogen free, lead free, RoHS compliant

Environmental Data

- Storage temperature range (Component): -40 °C to +125 °C
- Operating temperature range: -40 °C to +125 °C (ambient plus self-temperature rise)
- Solder reflow temperature: J-STD-020D compliant



Product Specifications

Part Number ⁸	OCL ¹ (nH) ± 15%	FLL ² (nH) minimum	I _{rms} ³ (A)	I _{sat} ¹⁴ (A)	I _{sat} ²⁵ (A)	I _{sat} ³⁶ (A)	DCR (mΩ) ±5% @ 20°C	K-factor ⁷
FP1010R1-R120-R	120	84	50	94	80	75	0.185	371
FP1010R1-R150-R	150	105	50	80	68	64	0.185	371
FP1010R1-R330-R	330	230	50	30	25	23	0.185	371

1. Open Circuit Inductance (OCL) Test Parameters: 100 kHz, 0.1 Vrms, 0.0 Adc, +25 °C

2. Full Load Inductance (FLL) Test Parameters: 100 kHz, 0.1 Vrms, Isat1, +25 °C

3. I_{rms}: DC current for an approximate temperature rise of 40 °C without core loss. Derating is necessary for AC currents.

PCB layout, trace thickness and width, air-flow, and proximity of other heat generating components will affect the temperature rise. It is recommended that the temperature of the part not exceed 125 °C under worst case operating conditions verified in the end application.

4. I_{sat}¹: Peak current for approximately 20% rolloff @ +25 °C

5. I_{sat}²: Peak current for approximately 20% rolloff @ +100 °C

6. I_{sat}³: Peak current for approximately 20% rolloff @ +125 °C

7. K-factor: Used to determine Bp-p for core loss (see graph). Bp-p = K * L * ΔI * 10⁻³. Bp-p(Gauss),

K: (K-factor from table), L: (Inductance in nH), Symbol I (Peak to peak ripple current in Amps).

8. Part Number Definition: FP1010Rx-Rxxx-R

FP1010R= Product code and size

x= Version indicator

-Rxxx= Inductance value in μH, R= decimal point

-R suffix = RoHS compliant

Dimensions (mm)

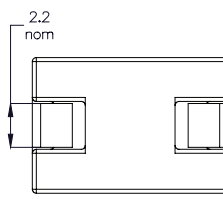
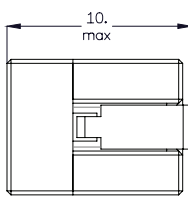
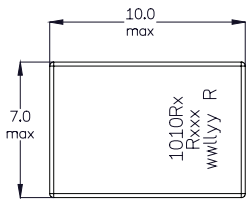
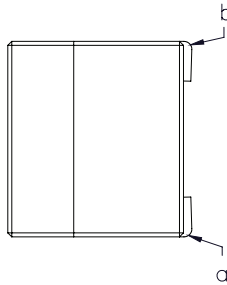

Recommended Pad Layout

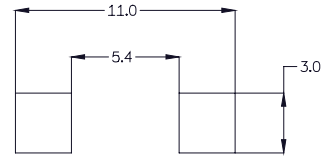

Schematic

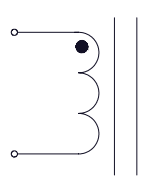

Part marking: 1010Rx (x = Version Indicator), Rxxx = Inductance value in μH (R = decimal point)

wwlyy = date code, R = revision level

Tolerances are ±0.15 millimeters unless stated otherwise

All soldering surfaces to be coplanar within 0.1 millimeters

PCB tolerances are ±0.1 millimeters unless stated otherwise

DCR measured from point "a" to point "b"

Do not route traces or vias underneath the inductor

Packaging information (mm)

Supplied in tape and reel packaging , 300 parts per 13" diameter reel

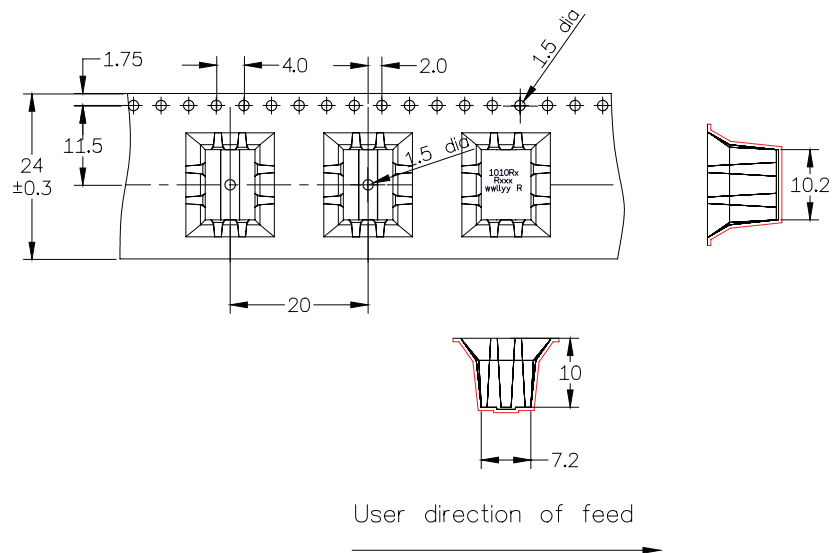

Temperature rise vs. total loss

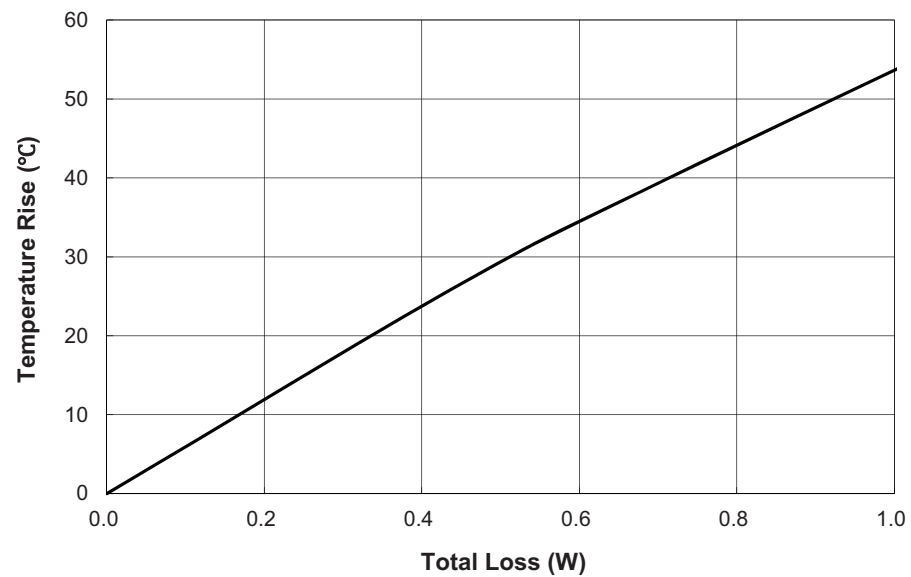

Core loss vs. B_{p-p}

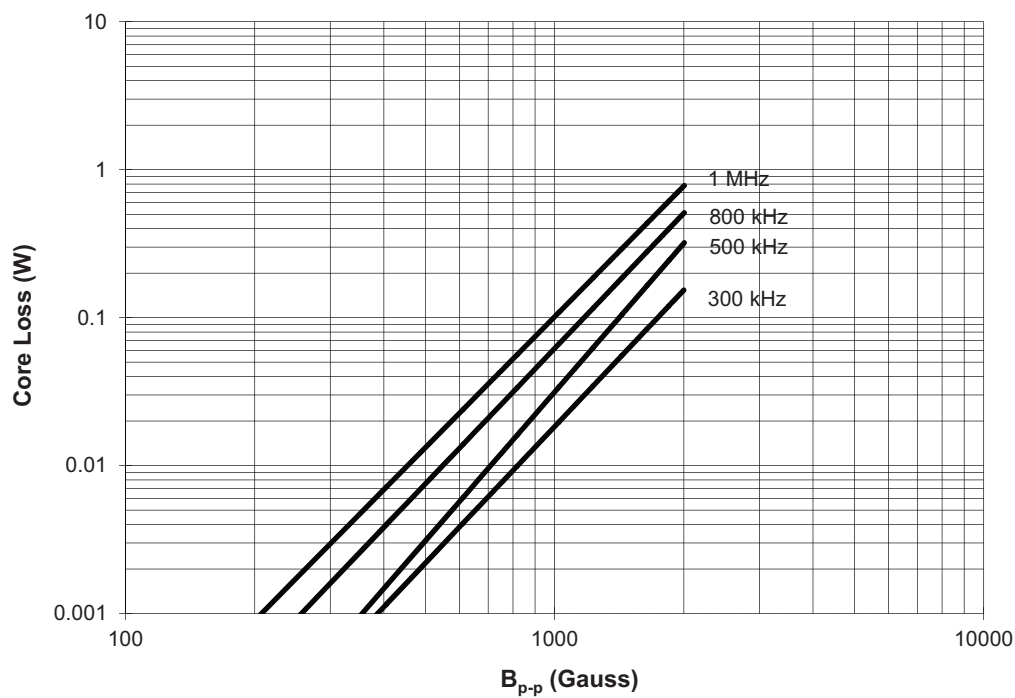

Inductance characteristics

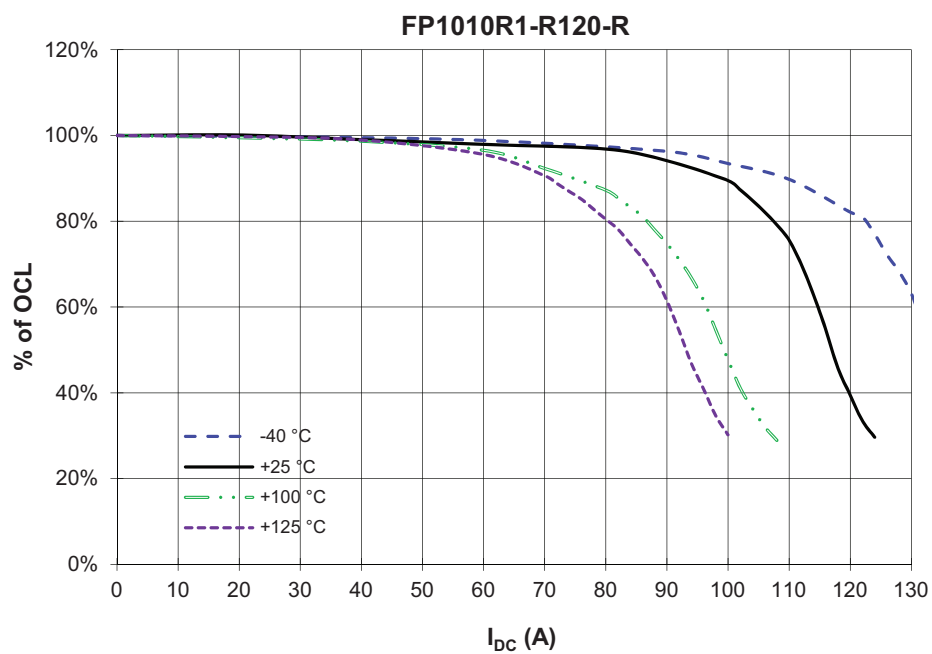

Inductance characteristics

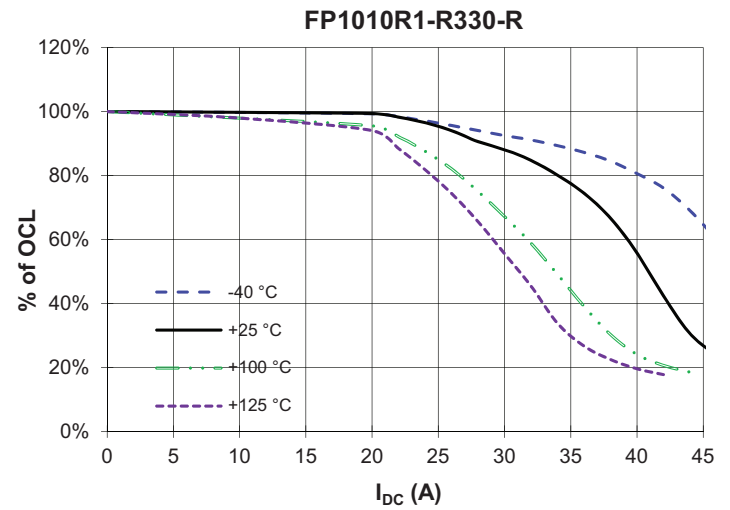
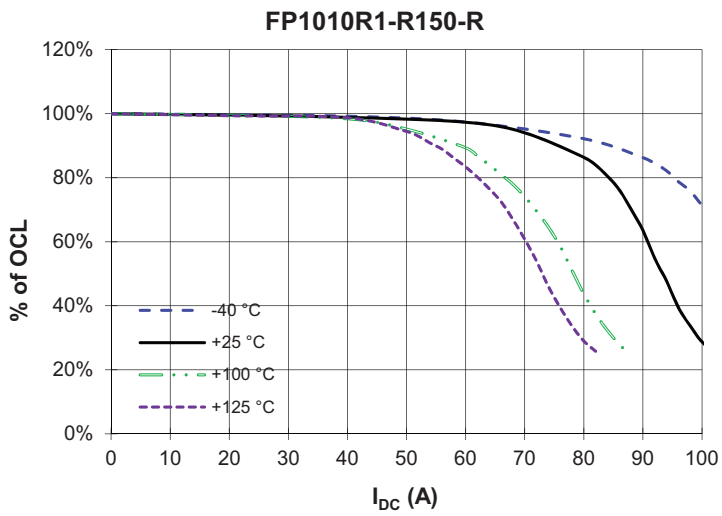

Solder reflow profile

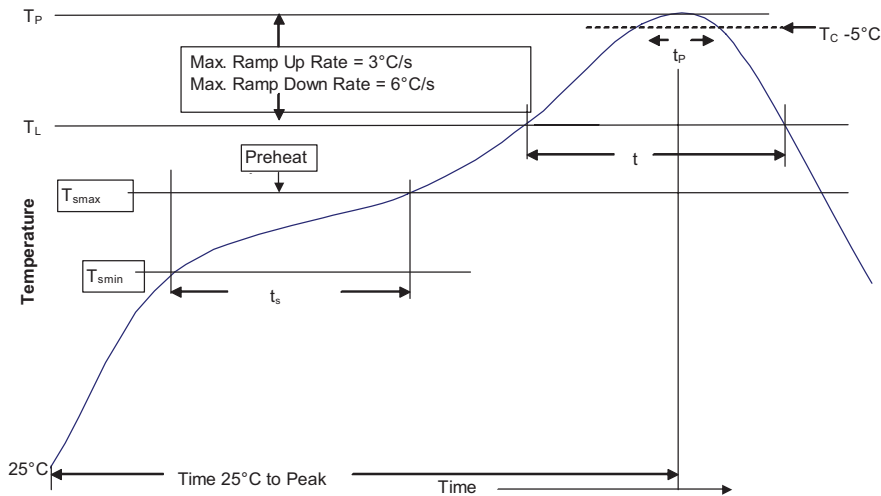

Table 1 - Standard SnPb Solder (T_C)

Package Thickness	Volume mm ³ <350	Volume mm ³ ≥350
<2.5mm)	235°C	220°C
≥2.5mm	220°C	220°C

Table 2 - Lead (Pb) Free Solder (T_C)

Package Thickness	Volume mm ³ <350	Volume mm ³ 350 - 2000	Volume mm ³ >2000
<1.6mm	260°C	260°C	260°C
1.6 – 2.5mm	260°C	250°C	245°C
>2.5mm	250°C	245°C	245°C

Reference JEDEC J-STD-020D

Profile Feature	Standard SnPb Solder	Lead (Pb) Free Solder
Preheat and Soak		
• Temperature min. (T_{smin})	100°C	150°C
• Temperature max. (T_{smax})	150°C	200°C
• Time (T_{smin} to T_{smax}) (t_s)	60-120 Seconds	60-120 Seconds
Average ramp up rate T_{smax} to T_P	3°C/ Second Max.	3°C/ Second Max.
Liquidous temperature (T_L)	183°C	217°C
Time at liquidous (t_L)	60-150 Seconds	60-150 Seconds
Peak package body temperature (T_P)*	Table 1	Table 2
Time (t_p)** within 5 °C of the specified classification temperature (T_C)	20 Seconds**	30 Seconds**
Average ramp-down rate (T_P to T_{smax})	6°C/ Second Max.	6°C/ Second Max.
Time 25°C to Peak Temperature	6 Minutes Max.	8 Minutes Max.

* Tolerance for peak profile temperature (T_P) is defined as a supplier minimum and a user maximum.

** Tolerance for time at peak profile temperature (t_p) is defined as a supplier minimum and a user maximum.

Life Support Policy: Eaton does not authorize the use of any of its products for use in life support devices or systems without the express written approval of an officer of the Company. Life support systems are devices which support or sustain life, and whose failure to perform, when properly used in accordance with instructions for use provided in the labeling, can be reasonably expected to result in significant injury to the user.

Eaton reserves the right, without notice, to change design or construction of any products and to discontinue or limit distribution of any products. Eaton also reserves the right to change or update, without notice, any technical information contained in this bulletin.

Eaton
Electronics Division
1000 Eaton Boulevard
Cleveland, OH 44122
United States
www.eaton.com/elx

© 2016 Eaton
All Rights Reserved
Printed in USA
Publication No. 10531 BU&MC16039
April 2016

Mouser Electronics

Authorized Distributor

Click to View Pricing, Inventory, Delivery & Lifecycle Information:

[Eaton:](#)

[FP1010R1-R330-R](#) [FP1010R1-R120-R](#) [FP1010R1-R150-R](#)