

**Technical specification:**

Rated voltage: IEC 60664-1	300 V
Oversvoltage category: IEC 60664-1	2
Oversvoltage: IEC 60664-1	2,7 kV
Current rating: IEC 60512-3 at 40°C	0,75mm <sup>2</sup> 1,5mm <sup>2</sup> 8 A 12 A
Insulation resistance: IEC 60512	>=100 MΩ
Pollution degree: IEC 60664-1	3/2
Degree of protection: IEC 60529	IP 68, in mated condition
Temperature range: IEC 60664-1	-30°C ... +80°C
Mating cycles: IEC 60512-9a	>=100
Termination:	crimped

**Materials:**

Contact:	CuZn
Contact plating:	Nickel, gold plated
Contact carrier:	TPU, UL 94
Coupling screw:	CuZn, nickel plated
Moulding body:	TPU, UL 94, grey

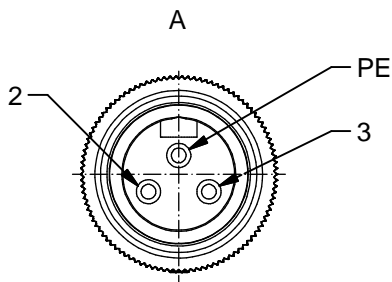

**Contact assignment:**

- PE ■ green-yellow
- 2 ■ brown
- 3 ■ blue

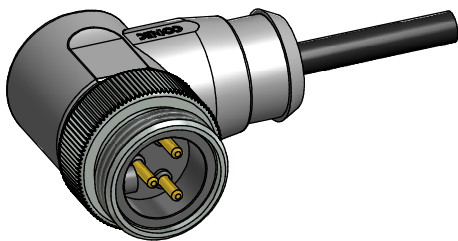

Part no:	Description:	Length L:	Cable:
41-01028	SAL - 7/8 - RSW2PE - 2 / K0	2m	TPU, UL 20940, black, 3x0,75mm <sup>2</sup> Cable: 781-K07300
41-01029	SAL - 7/8 - RSW2PE - 3 / K0	3m	
41-01030	SAL - 7/8 - RSW2PE - 5 / K0	5m	
41-01031	SAL - 7/8 - RSW2PE - 10 / K0	10m	
41-xxxxx	SAL - 7/8 - RSW2PE - ... / K0	x	
41-01125	SAL - 7/8 - RSW2PE - 2 / K0 / 150	2m	TPU, UL 20940, black, 3x1,50mm <sup>2</sup> Cable: 781-K08300
41-01126	SAL - 7/8 - RSW2PE - 3 / K0 / 150	3m	
41-01127	SAL - 7/8 - RSW2PE - 5 / K0 / 150	5m	
41-01128	SAL - 7/8 - RSW2PE - 10 / K0 / 150	10m	
41-xxxxx	SAL - 7/8 - RSW2PE - ... / K0 / 150	x	

D see data sheet cable

DO NOT ALTER CAD DRAWING BY HAND Directive 2002/95/EC RoHS compliant	Index: b 14.02.11 VF Ä3891 cable type changed, technical specification changed, part no. cable in table added, neutral line added	dim. in mm	title: <h2 style="margin: 0;">Male connector 7/8" angled</h2>							
	tolerance of cable: L ≤ 4m: L + 40mm L > 4m: L + 1%	<table border="1" style="width: 100%; border-collapse: collapse;"> <tr> <td style="width: 30px;">date</td> <td style="width: 100px;">name</td> </tr> <tr> <td>drawn 11.10.07</td> <td>Franz</td> </tr> <tr> <td>appd. 11.10.07</td> <td>Mankopf</td> </tr> </table>			date	name	drawn 11.10.07	Franz	appd. 11.10.07	Mankopf
	date	name								
	drawn 11.10.07	Franz								
appd. 11.10.07	Mankopf									
general tolerance: 0 ± 0,50mm 0,0 ± 0,25mm 0,00 ± 0,10mm										
THIS DRAWING MAY NOT BE COPIED OR REPRODUCED IN ANY WAY, AND MAY NOT BE PASSED ON TO A THIRD PARTY WITHOUT WRITTEN PERMISSION. OWNERSHIP AND COPYRIGHT OF CONEC GmbH			part no: <h2 style="margin: 0;">see table</h2>							

# Mouser Electronics

Authorized Distributor

Click to View Pricing, Inventory, Delivery & Lifecycle Information:

[CONEC:](#)

[41-01128](#)