

1N5550 1N5553  
 1N5551 1N5554  
 1N5552

**GLASS PASSIVATED  
 SILICON RECTIFIERS  
 3.0 AMP, 200 THRU 1000 VOLT**



[www.centrasemi.com](http://www.centrasemi.com)

**DESCRIPTION:**

The CENTRAL SEMICONDUCTOR 1N5550 series types are silicon rectifiers mounted in a hermetically sealed, glass passivated package designed for general purpose applications where high reliability is required.

**MARKING: FULL PART NUMBER**

**MAXIMUM RATINGS:** ( $T_A=25^\circ\text{C}$  unless otherwise noted)

	SYMBOL	1N5550	1N5551	1N5552	1N5553	1N5554	UNITS
Peak Repetitive Reverse Voltage	$V_{RRM}$	200	400	600	800	1000	V
DC Blocking Voltage	$V_R$	200	400	600	800	1000	V
RMS Reverse Voltage	$V_{R(RMS)}$	140	280	420	560	700	V
Average Forward Current ( $T_A=55^\circ\text{C}$ )	$I_O$			3.0			A
Peak Forward Surge Current, $t_p=8.3\text{ms}$	$I_{FSM}$			100			A
Operating and Storage Junction Temperature	$T_J, T_{stg}$			-65 to +200			$^\circ\text{C}$
Thermal Resistance (Note 1)	$\Theta_{JL}$			30			$^\circ\text{C/W}$

**ELECTRICAL CHARACTERISTICS:** ( $T_A=25^\circ\text{C}$  unless otherwise noted)

SYMBOL	TEST CONDITIONS	MIN	MAX	UNITS
$I_R$	$V_R=\text{Rated } V_{RRM}$		1.0	$\mu\text{A}$
$I_R$	$V_R=\text{Rated } V_{RRM}, T_A=100^\circ\text{C}$		75	$\mu\text{A}$
$V_F$	$I_F=3.0\text{A}$ (200V thru 600V)		1.0	V
$V_F$	$I_F=3.0\text{A}$ (800V thru 1000V)		1.1	V
$BV_R$	$I_R=50\mu\text{A}$ (1N5550)	240		V
$BV_R$	$I_R=50\mu\text{A}$ (1N5551)	460		V
$BV_R$	$I_R=50\mu\text{A}$ (1N5552)	660		V
$BV_R$	$I_R=50\mu\text{A}$ (1N5553)	880		V
$BV_R$	$I_R=50\mu\text{A}$ (1N5554)	1100		V
$t_{rr}$	$I_F=0.5\text{A}, I_R=1.0\text{A}, I_{rr}=0.25\text{A}$ (200V thru 600V)		2.0	$\mu\text{s}$
$t_{rr}$	$I_F=0.5\text{A}, I_R=1.0\text{A}, I_{rr}=0.25\text{A}$ (800V thru 1000V)		4.0	$\mu\text{s}$

Notes: (1) At 0.375 inch (9.52mm) lead length from body.

1N5550 1N5553  
 1N5551 1N5554  
 1N5552



GLASS PASSIVATED  
 SILICON RECTIFIERS  
 3.0 AMP, 200 THRU 1000 VOLT

GPR-4AM CASE - MECHANICAL OUTLINE

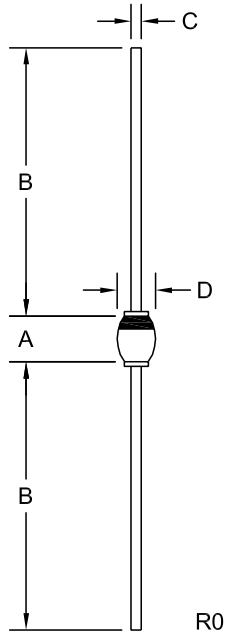

SYMBOL	INCHES		MILLIMETERS	
	MIN	MAX	MIN	MAX
A	0.165	0.189	4.20	4.80
B	1.024	--	26.00	--
C	0.037	0.042	0.95	1.06
D	0.130	0.175	3.30	4.45

GPR-4AM (REV: R0)

R2 (27-February 2013)

## OUTSTANDING SUPPORT AND SUPERIOR SERVICES



---

### PRODUCT SUPPORT

Central's operations team provides the highest level of support to insure product is delivered on-time.

- Supply management (Customer portals)
- Inventory bonding
- Consolidated shipping options
- Custom bar coding for shipments
- Custom product packing

---

### DESIGNER SUPPORT/SERVICES

Central's applications engineering team is ready to discuss your design challenges. Just ask.

- Free quick ship samples (2<sup>nd</sup> day air)
- Online technical data and parametric search
- SPICE models
- Custom electrical curves
- Environmental regulation compliance
- Customer specific screening
- Up-screening capabilities
- Special wafer diffusions
- PbSn plating options
- Package details
- Application notes
- Application and design sample kits
- Custom product and package development

---

### REQUESTING PRODUCT PLATING

1. If requesting Tin/Lead plated devices, add the suffix " TIN/LEAD" to the part number when ordering (example: 2N2222A TIN/LEAD).
2. If requesting Lead (Pb) Free plated devices, add the suffix " PBFREE" to the part number when ordering (example: 2N2222A PBFREE).

---

### CONTACT US

#### Corporate Headquarters & Customer Support Team

Central Semiconductor Corp.  
145 Adams Avenue  
Hauppauge, NY 11788 USA  
Main Tel: (631) 435-1110  
Main Fax: (631) 435-1824  
Support Team Fax: (631) 435-3388  
[www.centrasemi.com](http://www.centrasemi.com)

**Worldwide Field Representatives:**  
[www.centrasemi.com/wwreps](http://www.centrasemi.com/wwreps)

**Worldwide Distributors:**  
[www.centrasemi.com/wwdistributors](http://www.centrasemi.com/wwdistributors)

---

For the latest version of Central Semiconductor's **LIMITATIONS AND DAMAGES DISCLAIMER**, which is part of Central's Standard Terms and Conditions of sale, visit: [www.centrasemi.com/terms](http://www.centrasemi.com/terms)

# Mouser Electronics

Authorized Distributor

Click to View Pricing, Inventory, Delivery & Lifecycle Information:

Central Semiconductor:

[1N5552 TR](#) [1N5552 BK](#) [1N5552 TR TIN/LEAD](#) [1N5552 BK TIN/LEAD](#)