

# EAO – Your Expert Partner for Human Machine Interfaces

## 82-6151.1155 - Illuminated pushbutton 22 mm stainless-steel, momentary

### 82-6151.1155 - Illuminated pushbutton 22 mm stainless-steel, momentary



Attention: The preview is based on a sample product. This can differ from your current configuration.

#### Mounting

Mounting cut-out Ø 22,3 mm  
Design flush

#### Front

Front dimension Ø 25 mm  
Front shape round  
Front ring shape flush  
Front bezel material Stainless steel

#### Other Attributes

Operating voltage 110 V AC  
Weight 0,018 kg  
Operation current 2 mA

#### Operating-/Indication part

Lens optics opaque  
Lens material Stainless steel  
Lens profile flat  
Lens illumination illuminative  
Lens colour Stainless steel

#### IP-Rating

Front protection IP65, IP67

#### Connection Method

Terminal Solder 2.8 x 0.5 mm

#### Actuator

Switching action Momentary

#### Switching element

Switching current 3 A  
Contact material Silver  
Contacts 1 C  
Switching system Snap-action switching element  
Switching voltage 240 V AC/DC

#### Illumination

Illumination Ring with white LED

#### Function

Illuminated pushbutton

# EAO – Your Expert Partner for Human Machine Interfaces

82-6151.1155 - Illuminated pushbutton 22 mm stainless-steel, momentary

## Dimensions

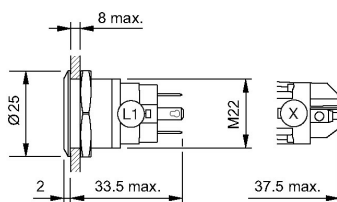

## Mounting cut-outs

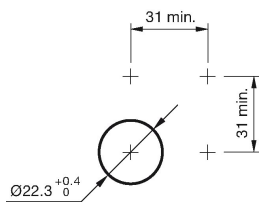

## Wiring diagram

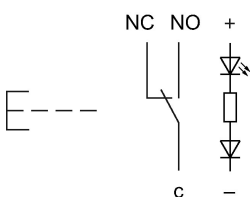

## Component layout



## Legend

Switching action: B = Momentary

Contacts: C = Changeover

# Mouser Electronics

Authorized Distributor

Click to View Pricing, Inventory, Delivery & Lifecycle Information:

EAO:

[82-6151.1155](tel:82-6151.1155)