

AB3010 SERIES

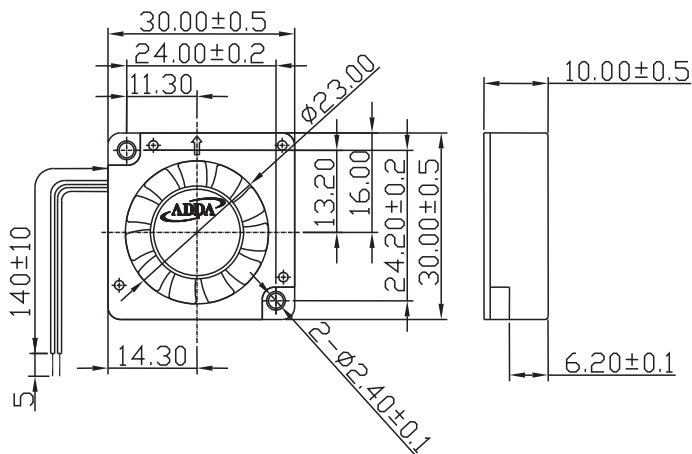

External Dimensions



Frame:Plastic(UL:94V-0)
Impeller:Plastic(UL:94V-0)
Lead wire:UL1571AWG28

Specifications(Nominal)

*:Noise is measured at the distance of one (1) meter from the axis of intake.

Bearing type: ◎=Ball ※=Sleeve ●=Hypro bearing

Frame size (mm)	Model No.	Bearing System Type	Rated Voltage (VDC)	Current (A)	Power (W)	Rated Speed (rpm)	Maximum AirFlow (CMM) (CFM)	Maximum Pressure (InAq) (mmAq)	*Noise Level (dB/A)	Weight (g)
30x30x10	AB0305MB-GA0(T)	◎ ●	5	0.083	0.415	7500	0.028 0.900	0.174 4.419	29.8	12.0
	AB0312MB-GA0(T)	◎ ●	12	0.065	0.780	7500	0.028 0.900	0.174 4.419	29.8	
	AB0312HB-GA0(T)	◎ ●	12	0.087	1.044	9000	0.031 1.095	0.220 5.588	34.0	

Specifications subject to change without notice.

The specification for bearing type is for reference only , for more bearing types information, please contact with your ADDA sales representative, thanks!!
(網頁上呈現產品軸承資訊均以2Ball為主，若需其他產品資訊請聯絡您在ADDA的業務代表，謝謝！！)

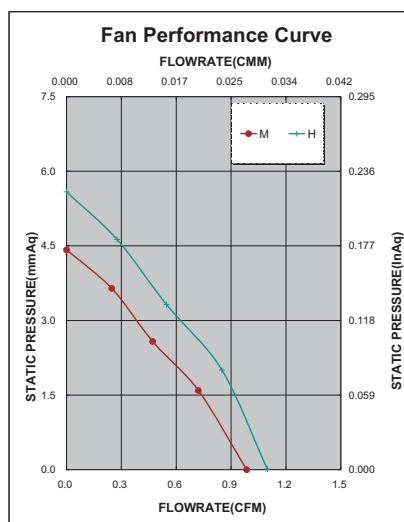

*Motor protective circuit and third lead wire functions

0	1	2	3	4	6	7	8	9	A	B
✓	✓	✓	✓		✓					

*Safety approvals

UL	UL	SP	CE	CE
✓	✓	✓		✓

Mouser Electronics

Authorized Distributor

Click to View Pricing, Inventory, Delivery & Lifecycle Information:

[ADDA:](#)

[AB0312MB-GA0-LF](#) [AB3012HB-GA0\(T\)](#)