

IE-C6FP8LD0020M40V40-D

Weidmüller Interface GmbH & Co. KG
Klingenbergstraße 26
D-32758 Detmold
Germany

www.weidmueller.com



Assembled IE cables, patch cable Cabinet Line, Cat. 6,
LSZH, grey, 90° angled on one side

General ordering data

| | |
|------------|--|
| Version | Patch cable, RJ45 IP 20, Angled 90°, RJ45 IP 20, Cat.6 _A / Class E _A (ISO/IEC 11801 2010), LSZH, 2 m |
| Order No. | 1248280020 |
| Type | IE-C6FP8LD0020M40V40-D |
| GTIN (EAN) | 4050118044805 |
| Qty. | 1 pc(s). |

Creation date January 22, 2022 5:05:31 AM CET

Catalogue status 14.01.2022 / We reserve the right to make technical changes.

IE-C6FP8LD0020M40V40-D

Weidmüller Interface GmbH & Co. KG

Klingenbergstraße 26

D-32758 Detmold

Germany

www.weidmueller.com

Technical data

Dimensions and weights

| | | | |
|------------|------|-----------------|------------|
| Length | 2 m | Length (inches) | 78.74 inch |
| Net weight | 90 g | | |

Temperatures

| | | | |
|--------------------------|----------------|-----------------------|----------------|
| Storage temperature | -20 °C...60 °C | Operating temperature | -20 °C...60 °C |
| Installation temperature | 0 °C...50 °C | | |

Electrical properties

| | | | |
|------------------------------------|-----|------------|----------------------------|
| Current-carrying capacity at 50 °C | 1 A | PoE / PoE+ | conforming to IEEE 802.3at |
|------------------------------------|-----|------------|----------------------------|

General standards

| | | | |
|---|---|--------------------|----------------|
| Application-specific communication cable facilities | ANSI / TIA / EIA-568-B.2-10, ISO / IEC 11801:2002, EN50173-1:2007 | Connector standard | IEC 60603-7-51 |
|---|---|--------------------|----------------|

Standards

| | |
|--------------------|----------------|
| Connector standard | IEC 60603-7-51 |
|--------------------|----------------|

Cable structure

| | | | |
|---------------------------|---|---------------------------------------|--|
| Arrangement of wire cores | Twisted pair | Colour sequence or wires - wire pairs | white - blue, white - orange, white - green, white - brown |
| Complete shielding | Shielding braid made from copper wiring | Copper diameter | 0.43 mm |
| Cross-section | 4*2*AWG 27/7 - 4*2*0.1 mm ² | Insulation | PE |
| Insulation cross-section | 1.04 mm | Material sheath | LSZH |
| Number of wires | 8 | Overlap of shielding braid | 60 % |
| Sheath diameter, max. | 5.9 mm | Sheath diameter, min. | 5.5 mm |
| Sheathing colour | grey | Shielding | S/FTP |
| Strands | 7 | Wire pair shielding | Aluminium foil |

Electrical properties of cable

| | | |
|-------------------------------------|--|--------|
| Capacity at 1 kHz | 46 nF/km | |
| Category | Cat.6 _A / Class E _A (ISO/IEC 11801 2010) | |
| Characteristic impedance | 100 ± 15 Ω at 1–100 MHz | |
| Coupling attenuation up to 1000 MHz | 80 dB | |
| Coupling resistance at 10 MHz | 5 mΩ/m | |
| Deviation | 25 ns/100m | |
| Operating voltage | 50 V DC | |
| Operating voltage (UL rating) | Operating voltage | 30 V |
| | Voltage type | AC |
| | Operating voltage | 42.4 V |
| | Voltage type | DC |
| Operating voltage (UL rating) | 30 V AC / 42.4 V DC | |
| Operating voltage, UL | 30 V AC / 42.4 V DC | |
| Resistance differential | 5 % | |

Creation date January 22, 2022 5:05:31 AM CET

Catalogue status 14.01.2022 / We reserve the right to make technical changes.

2

IE-C6FP8LD0020M40V40-D**Weidmüller Interface GmbH & Co. KG**

Klingenbergstraße 26

D-32758 Detmold

Germany

www.weidmueller.com

Technical data

| | |
|--|-----------------|
| Separating class according to EN 50174-2 | d |
| Speed | 10 GBit/s |
| Test voltage: wire-wire-shield | 750 V DC, 1 min |

Mechanical and material properties of cable

| | | | |
|--------------------------------|--------------------|-------------------------------|---|
| Colour | grey | Halogen | halogen-free, according to IEC 60754-2 |
| Min. bending radius, once only | | Resistance to spread of flame | in accordance with IEC 60332-2-2, in accordance with IEC 60332-1-2, in accordance with IEC 60332-3-24, in accordance with UL 2556 (FT1) |
| | 5 x cable diameter | | |
| Speed | 10 GBit/s | | |

Plug, left

| | |
|----------------|------------------------|
| Connector left | RJ45 IP 20, Angled 90° |
|----------------|------------------------|

Plug, right

| | | | |
|-----------------------|-------------|-----------------|-------------|
| Connector right | RJ45 IP 20 | Contact surface | Au ≥ 0.8 µm |
| Housing main material | PC UL 94 V0 | Plugging cycles | 750 |

plug

| | | | |
|----------------|------------------------|-----------------|------------|
| Connector left | RJ45 IP 20, Angled 90° | Connector right | RJ45 IP 20 |
|----------------|------------------------|-----------------|------------|

Classifications

| | | | |
|-------------|-------------|-------------|-------------|
| ETIM 6.0 | EC002599 | ETIM 7.0 | EC002599 |
| ETIM 8.0 | EC002599 | ECLASS 9.0 | 27-06-03-08 |
| ECLASS 9.1 | 27-06-03-08 | ECLASS 10.0 | 27-06-03-08 |
| ECLASS 11.0 | 27-06-03-08 | | |

Approvals

Approvals



| | |
|------|---------|
| ROHS | Conform |
|------|---------|

IE-C6FP8LD0020M40V40-D**Weidmüller Interface GmbH & Co. KG**

Klingenbergstraße 26

D-32758 Detmold

Germany

www.weidmueller.com**Technical data****Downloads**

| | |
|---|---|
| Approval/Certificate/Document of Conformity | ISO/IEC EN and TIA/EIA Screened Class EA Category 6A, 2 connector channel DUXR.E316369 |
| Engineering Data | CAD data – STEP |
| Product Change Notification | PCN-PB47-20180213-00-A_EN PCN-PB47-20180213-00-A_DE 20210804 Technical change to CabinetLine (RJ45 CAT.6A patch cable LSZH) 20210804 Technische Änderung zur der CabinetLine (RJ45 CAT.6A Patchkabel LSZH) |
| User Documentation | MAN IE GUIDE DE MAN IE GUIDE EN |
| Catalogues | Catalogues in PDF-format |
| Brochures | FL FIELDWIRING EN PI PROFINET CABLING EN PI PROFINET CABLING EN |

IE-C6FP8LD0020M40V40-D

Weidmüller Interface GmbH & Co. KG
 Klingenbergstraße 26
 D-32758 Detmold
 Germany

www.weidmueller.com

Drawings

Wiring

| | | | | |
|------|---|----------------|---|------|
| RJ45 | 1 | white (orange) | 1 | RJ45 |
| | 2 | orange | 2 | |
| | 3 | white (green) | 3 | |
| | 4 | blue | 4 | |
| | 5 | white (blue) | 5 | |
| | 6 | green | 6 | |
| | 7 | white (brown) | 7 | |
| | 8 | brown | 8 | |

Dimensioned drawing



Dimensioned drawing

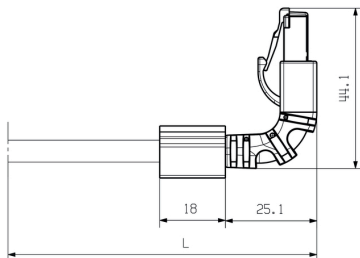

Accessories

Blank



TM-I is an acknowledged and accredited marker type for traffic engineering applications. There are various different tag lengths available for individual labelling with long character strings. Easy handling of separation and installation thanks to the project marker field. Pre-attachment of sleeves and retrofitting of tags offer excellent versatility

The special contour of TM-I allows easy assembly and secures firm positioning. They are compatible with a number of commercially available sleeves. Thanks to the MultiCard format, the tags can be printed quickly and conveniently with the PrintJet CONNECT, plotter or the STI pen.

- Easy handling of separation and installation thanks to the project marker field.
- Acknowledged and accredited marker for traffic engineering applications
- Pre-attachment of sleeves and retrofitting of tags offer excellent versatility
- Not suited for labelling with P-Ink or STI pen in connection with CLI T sleeves

For custom printing: Please send us a file of our labeling software M-Print PRO or M-Print PRO Online (without installation) for your labeling specifications.

General ordering data

| Type | TM-I 12 MC NE WS | Version |
|------------|----------------------------|--|
| Order No. | 1718411044 | TM-I, Insert markers, 12 x 4 mm, white |
| GTIN (EAN) | 4008190348977 | |
| Qty. | 320 pc(s). | |

IE-C6FP8LD0020M40V40-D

Weidmüller Interface GmbH & Co. KG

Klingenbergstraße 26

D-32758 Detmold

Germany

www.weidmueller.com

Accessories

Blank



TM-I is an acknowledged and accredited marker type for traffic engineering applications. There are various different tag lengths available for individual labelling with long character strings. Easy handling of separation and installation thanks to the project marker field. Pre-attachment of sleeves and retrofitting of tags offer excellent versatility

The special contour of TM-I allows easy assembly and secures firm positioning. They are compatible with a number of commercially available sleeves. Thanks to the MultiCard format, the tags can be printed quickly and conveniently with the PrintJet CONNECT, plotter or the STI pen.

- Easy handling of separation and installation thanks to the project marker field.
- Acknowledged and accredited marker for traffic engineering applications
- Pre-attachment of sleeves and retrofitting of tags offer excellent versatility
- Not suited for labelling with P-Ink or STI pen in connection with CLI T sleeves

For custom printing: Please send us a file of our labeling software M-Print PRO or M-Print PRO Online (without installation) for your labeling specifications.

General ordering data

| Type | TM-I 18 MC NE WS | Version |
|------------|----------------------------|--|
| Order No. | 1718431044 | TM-I, Insert markers, 18 x 4 mm, white |
| GTIN (EAN) | 4008190349011 | |
| Qty. | 320 pc(s). | |

Mouser Electronics

Authorized Distributor

Click to View Pricing, Inventory, Delivery & Lifecycle Information:

[Weidmuller:](#)

[1248280020](#)