

THIS DRAWING CONTAINS INFORMATION THAT IS PROPRIETARY TO J.S.T. AND SHALL NOT BE USED OR SHOWN WITHOUT WRITTEN PERMISSION.

4		3		2		1
ITEM	CONNECTOR PART NO.	DESCRIPTION	IPI CHECK	EOR CHECK	Applicable Tooling	
1	SLEB-001T-P0.2	LEB CONNECTOR CONTACT			APPLICATOR	
2	UL1061, 22 AWG	BLACK				

Applicable Housings	
NO. OF CIRCUITS	HOUSING PART NO.
1	LEBRP-01V-S
2	LEBRP-02V-S

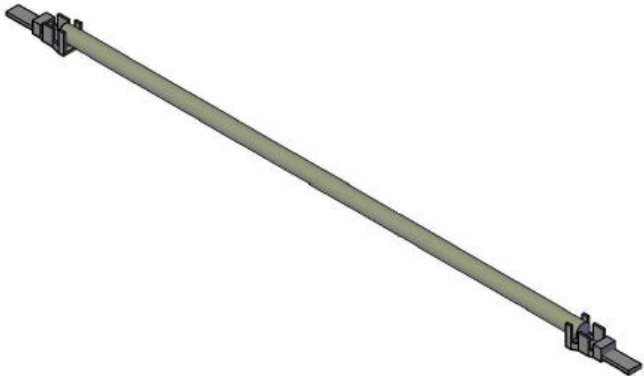
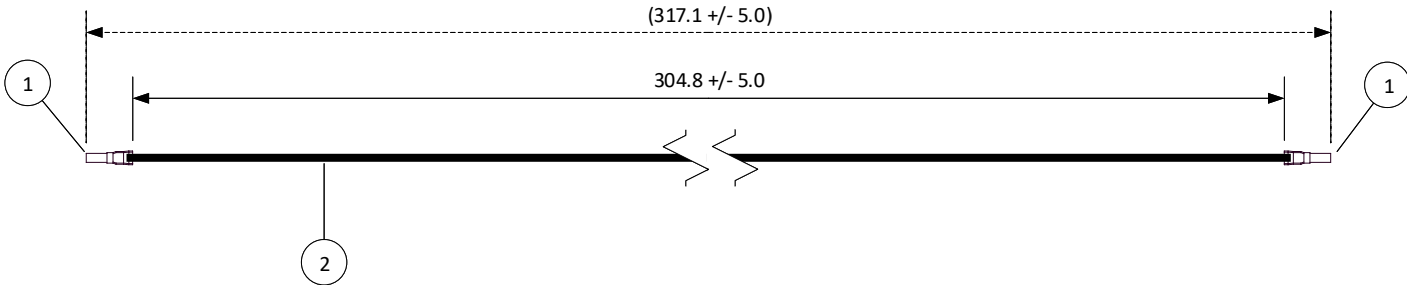

SCALE 1:1		CUSTOMER NAME	CUSTOMER PART NO.
DIMENSIONS All dimensions are in MM with a tolerance of +/- 3.0 unless otherwise specified.		DESCRIPTION 4.0 mm Pitch LEB Series Standard Leads - 12" Inside Length DOUBLE-END LEADS, F-F	
DRAWN BY STEVEN PILKINGTON		ASSEMBLY PART NO. ALEBLEB22K305	
CHECKED BY JUSTIN BAKER		DRAWING NO. & REVISION GAM-183	REVISED 5/6/2016

REV.	DESCRIPTION	DATE	BY
------	-------------	------	----

# Mouser Electronics

Authorized Distributor

Click to View Pricing, Inventory, Delivery & Lifecycle Information:

[JST:](#)

[ALEBLEB22K305](#)