

1		2		3		4		
A	Empfohlener Ausschnitt fuer Rastbefestigung (Grat gegenueber Bestueckungsseite) recommended cut-out for snap-in fixing (ledge opposite to snap-in direction)		Wanddicke wall thickness		Ausschnittlaenge length of cut-out		Ausschnittbreite width of cut-out	
			0.75	bis / to 1.25	19.2	-0.1	12.9	+0.1
			1.25	bis / to 2	19.4	-0.1	12.9	+0.1
			2	bis / to 3	19.8	-0.1	12.9	+0.1

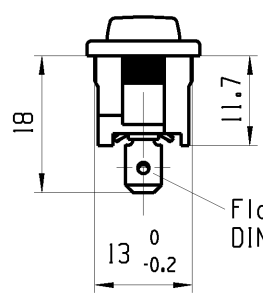

Flachstecker aeihn./ plug-in sim.
DIN 46244-A4.8-0.8

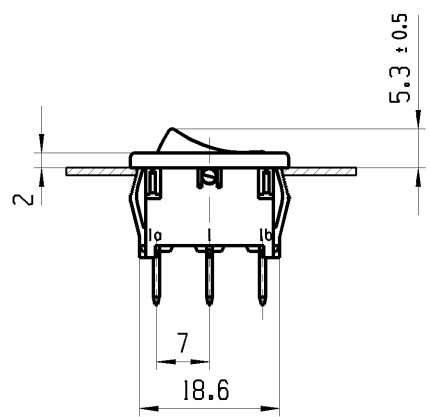
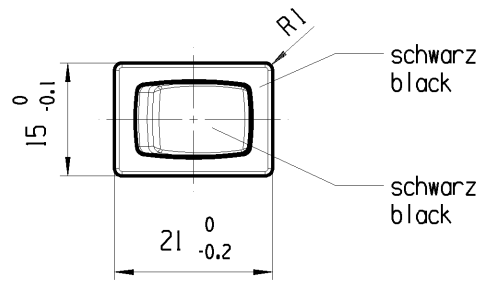

Aufschrift
Marking

1803.
4(21/250 ~ T100/55



6A 125V AC
4A 250V AC
1/10HP 125-250V AC
R 52

Wechsler 1-polig
Fuer Geraete der Klasse II geeignet

single pole changeover
suitable for appliances of class II

Herstellort/-jahr/-woche nach DIN EN 60062
date code of manufacture : place/year/week acc. to DIN EN 60062

fuer Form und Lage FOR SHAPE AND LOC.		☉ =	Allgemeintoleranzen UNTOLERANCED DIMENSIONS						Pause COPY	Blatt SHEET 01		TYP K	Zeichn./DRAWING NO. 18031202	Index f
			PROJEKTION	Abmasse und Nennmassbereiche Angaben in mm	<div><div></div><div></div></div>	Laenge LENGTH	Radien RADII							
								<div><div>0-6</div><div>± 0.2</div><div>± 0.2</div></div> <div><div>>6-15</div><div>± 0.4</div><div>±</div></div> <div><div>>15-30</div><div>± 0.4</div><div>±</div></div> <div><div>>30-70</div><div>±</div><div>±</div></div> <div><div>>70-120</div><div>±</div><div>±</div></div> <div><div>>120-200</div><div>±</div><div>±</div></div>						
fuer Winkel FOR ANGLE ± 2		<div><div></div><div></div></div>		ALL DIMENSIONS ARE IN MILLIMETRES		0 10 20 30mm		GERAETESCHALTER appliance switch						
e	58806	09.07.08	VOR								CAD: NX V6.0			
d	43118	05.10.05	vor								gez./DRAWN BY 09.07.08 VOR			
c	29978	13.11.00	GRH								gepr./CHECKED BY			
b	15921	11.05.84	RIE	r	64510	29.09.09	MUT				Ersatz fuer/REPLACEMENT OF			
Ausg. ISSUE	Aenderung REVISION	gez. DRAWN BY		Ausg. ISSUE	Aenderung REVISION	gez. DRAWN BY		Zng.gl.Nr. vom 13.11.00			<div><div></div></div> MARQUARDT			

Mouser Electronics

Authorized Distributor

Click to View Pricing, Inventory, Delivery & Lifecycle Information:

[Marquardt:](#)

[01803.1202-01](#)