

| LOC | | DIST | | REVISIONS | | | |
|-----|-----|-----------------------|---------|-----------|------|--|--|
| P | LTN | DESCRIPTION | DATE | DMN | APVD | | |
| G | | REV PER ECO 15-010033 | 7-10-15 | CT | DH | | |

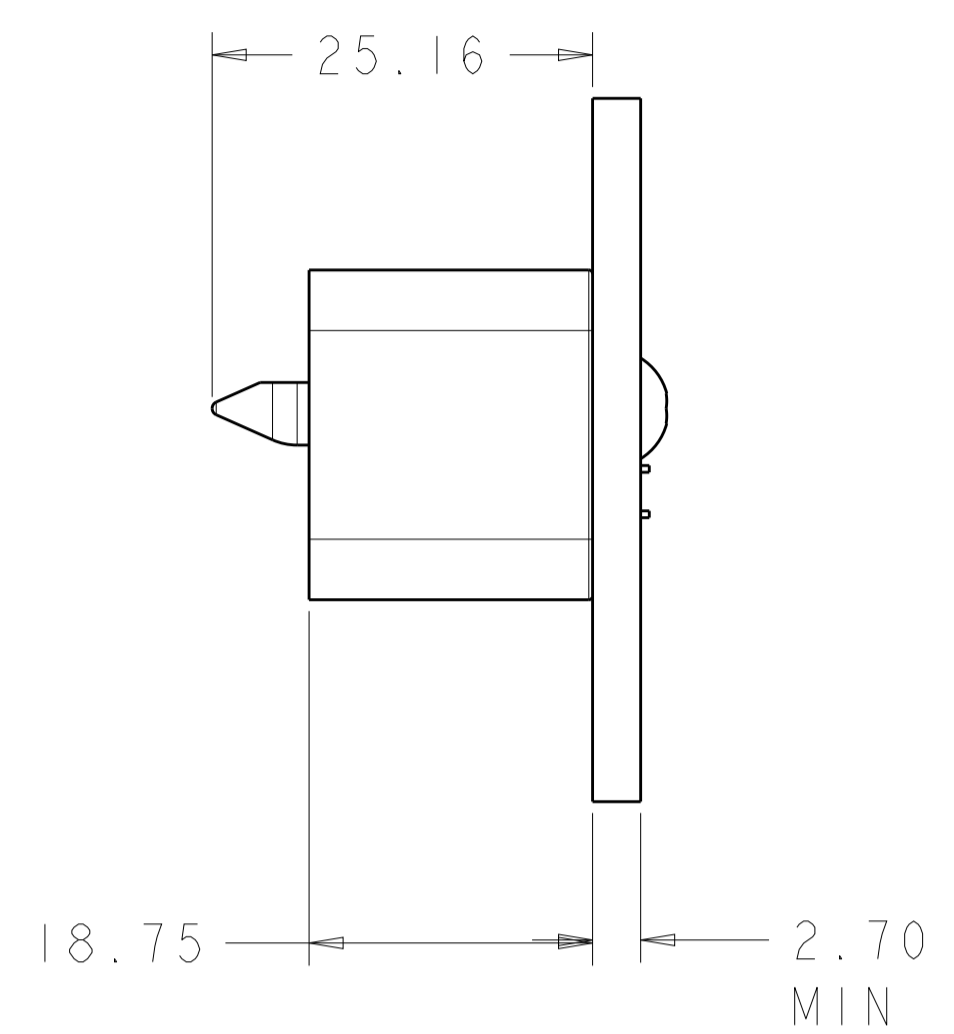

- MATING CONNECTOR FOR THIS CONNECTOR IS 2000979.
- MATERIAL- SHELL: ALUMINUM
HOUSING: GLASS FILLED POLYESTER, UL94VO
RETAINING RING: STAINLESS STEEL
KEYING GUIDE PIN: STAINLESS STEEL
- PLATING- SHELL: ELECTROLESS NICKEL
- KEYING GUIDE PIN PACKAGED FOR ASSEMBLY BY CUSTOMER.
- PLATING- CONTACT MATING AREA:
1.27µm MIN GOLD OVER 1.27µm MIN NICKEL
CONTACT PCB AREA: 0.5µm MIN TIN OVER 1.27µm MIN NICKEL

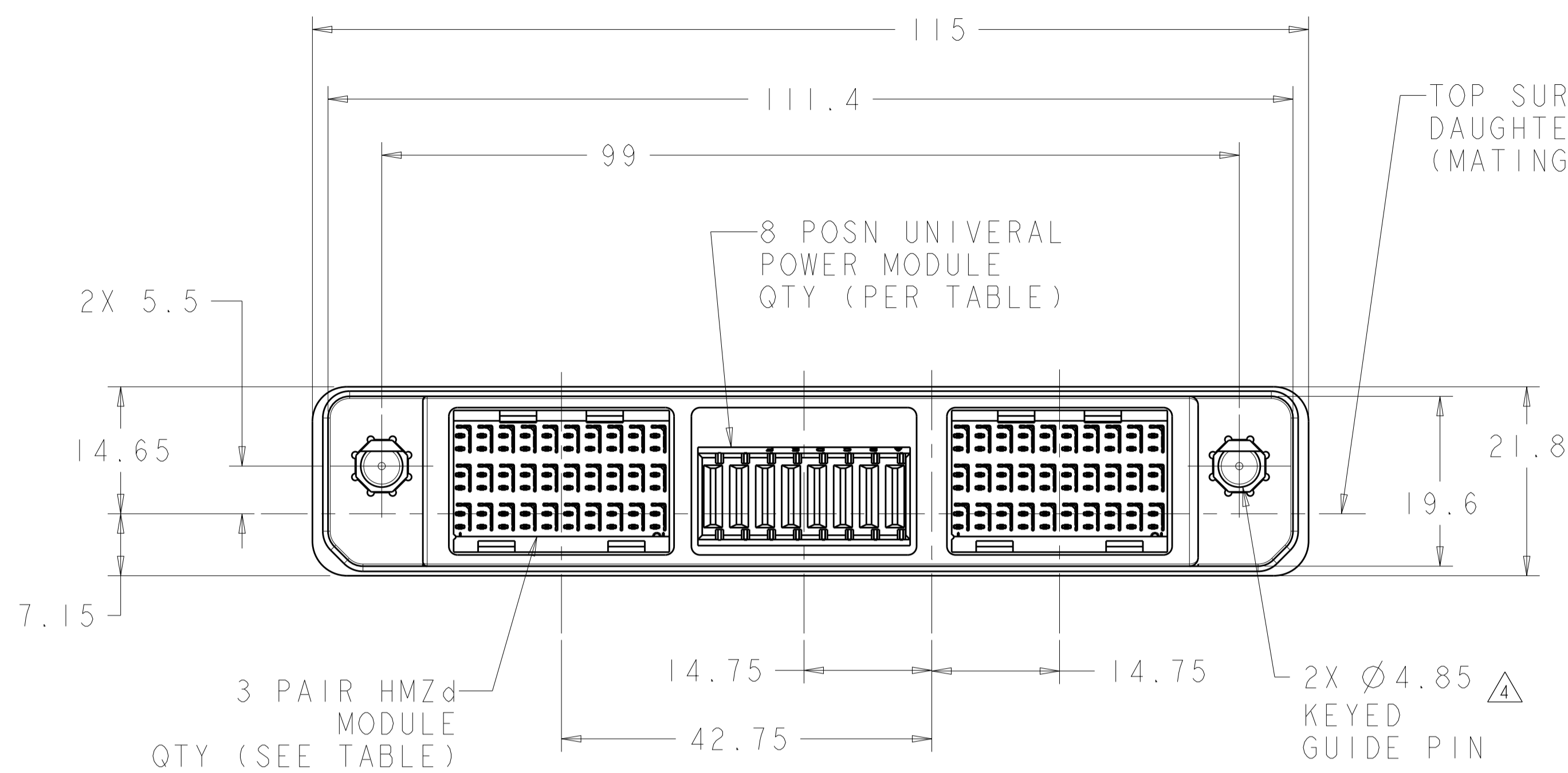
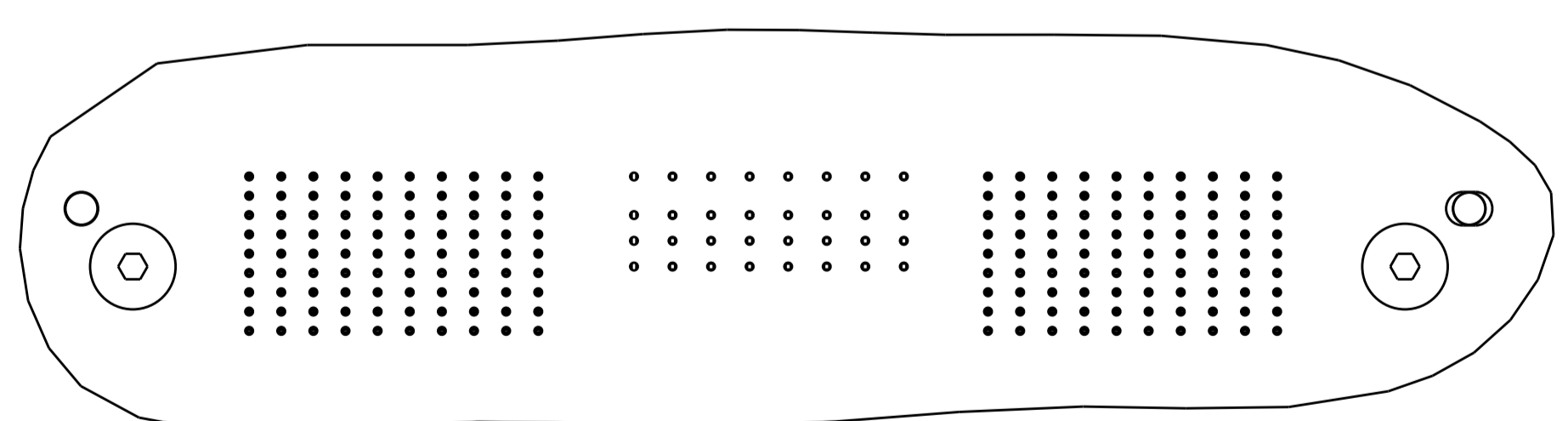
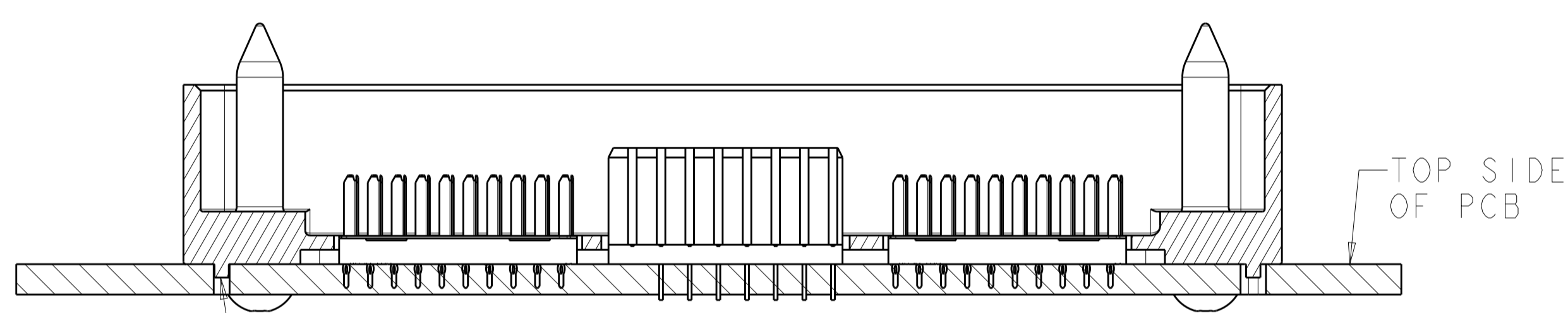

OBSOLETE
 NOT RELEASED FOR PRODUCTION

| | | | | | |
|-----------------------------|---------------------------|-------------------|-----------------------|--------------------|-------------|
| | 2 | 1 | -- | -- | 5-2000980-4 |
| OBSOLETE | 2 | 1 | -- | -- | 5-2000980-3 |
| NOT RELEASED FOR PRODUCTION | -- | 1 | 1 | 1 | 2000980-6 |
| | -- | - | - | 3 | 2000980-5 |
| | -- | 1 | - | 2 | 2000980-4 |
| OBSOLETE | -- | 1 | - | 2 | 2000980-3 |
| OBSOLETE | -- | 1 | 1 | 1 | 2000980-2 |
| OBSOLETE | -- | - | - | 3 | 2000980-1 |
| | 3 PAIR HMZd MODULE (RoHS) | 8 POSN UPM MODULE | 7 POSN RF COAX MODULE | 3 PAIR HMZd MODULE | PART NUMBER |
| MODULE QTY PER ASSY | | | | | |

THIS DRAWING IS A CONTROLLED DOCUMENT. DWN: Brent D. Tolm 13JAN2010
 CHK: CHONG YI 13JAN2010
 APVD: M. R. McALONIS 13JAN2010

DIMENSIONS: mm
 TOLERANCES UNLESS OTHERWISE SPECIFIED:
 0 PLC ±0.2
 1 PLC ±0.1
 2 PLC ±0.05
 3 PLC ±0.025
 4 PLC ±
 ANGLES °

MATERIAL:

FINISH:

WEIGHT: -
 CUSTOMER DRAWING

NAME: MOTHER BOARD CONNECTOR, HIGH SPEED RUGGEDIZED (HSR), 3 BAY, UNSEALED, VERTICAL
 PRODUCT SPEC: 108-2381
 APPLICATION SPEC: -

SIZE: A1
 CAGE CODE: 00779
 DRAWING NO: 2000980

RESTRICTED TO: -
 SCALE: 2:1
 SHEET: 1 OF 3
 REV: G

STE TE Connectivity

| LOC | DIST | REV | DATE | BY | APPV |
|-----|------|-----|-----------|----------------|------|
| - | - | 1 | 13JAN2010 | Brent D. Toth | |
| - | - | 2 | 13JAN2010 | CHONG YI | |
| - | - | 3 | 13JAN2010 | M. R. McALONIS | |

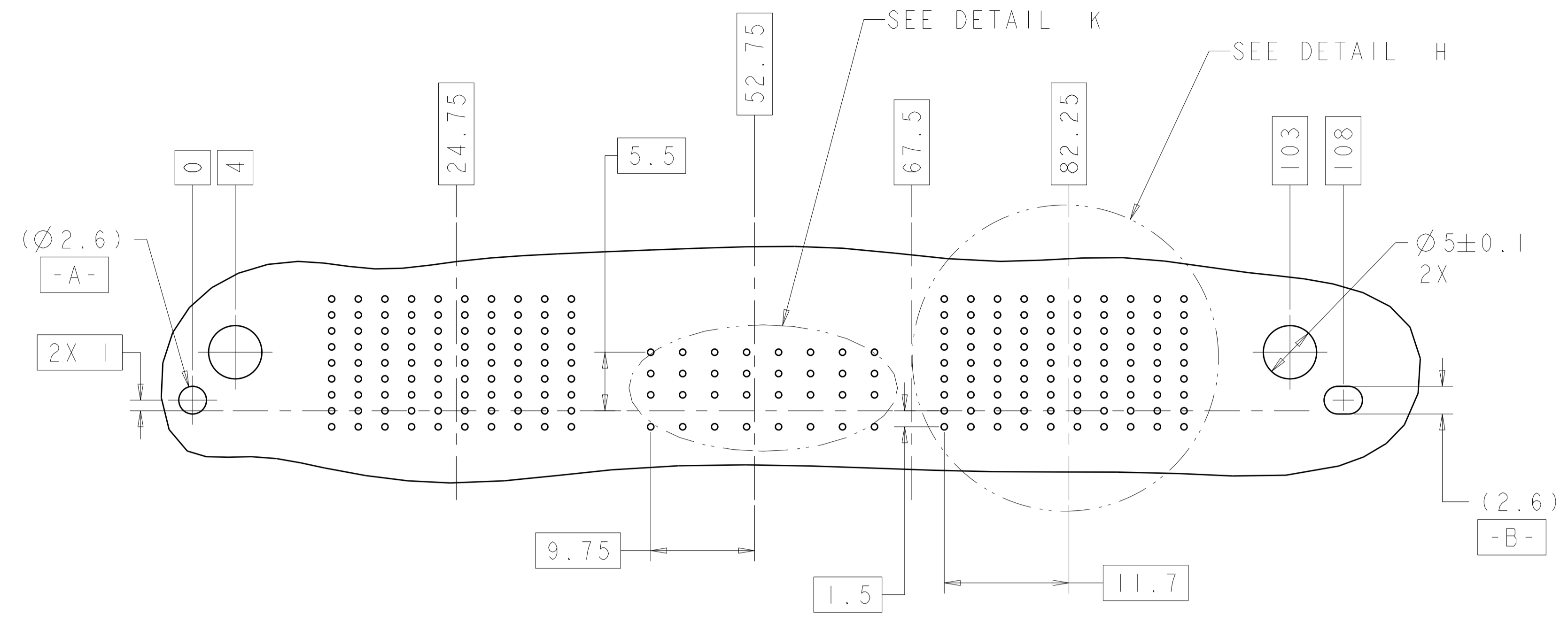

RECOMMENDED PC BOARD HOLE LAYOUT
AS VIEWED FROM TOP OF PCB
PCB FOR 2000980-4 SHOWN
(2 HM-Zd AND 1 UPM MODULE)
SCALE 3:1

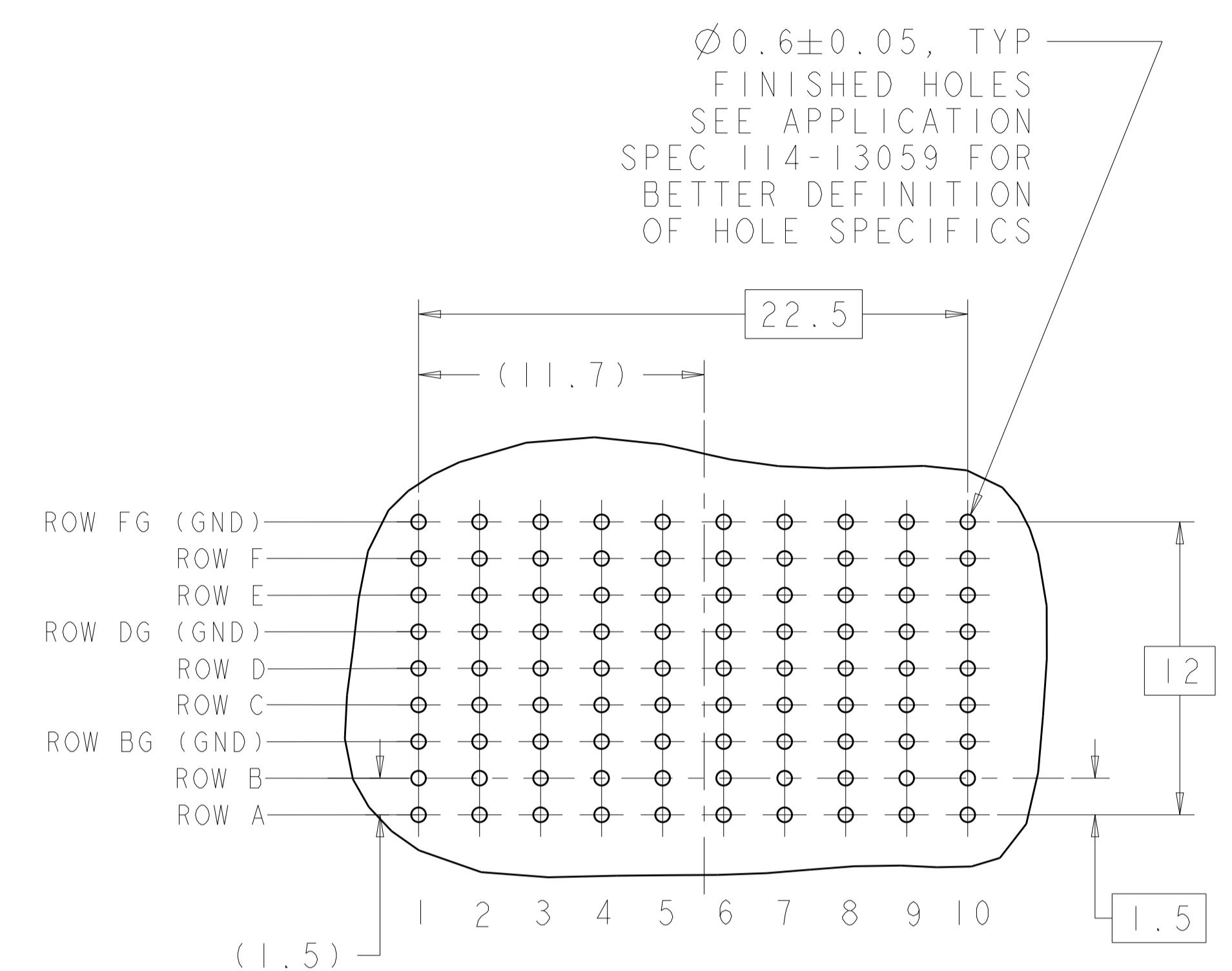

3 PAIR HMZd
TYP 2X FOR -4
TYP 3X FOR -5
DETAIL H
SCALE 5:1

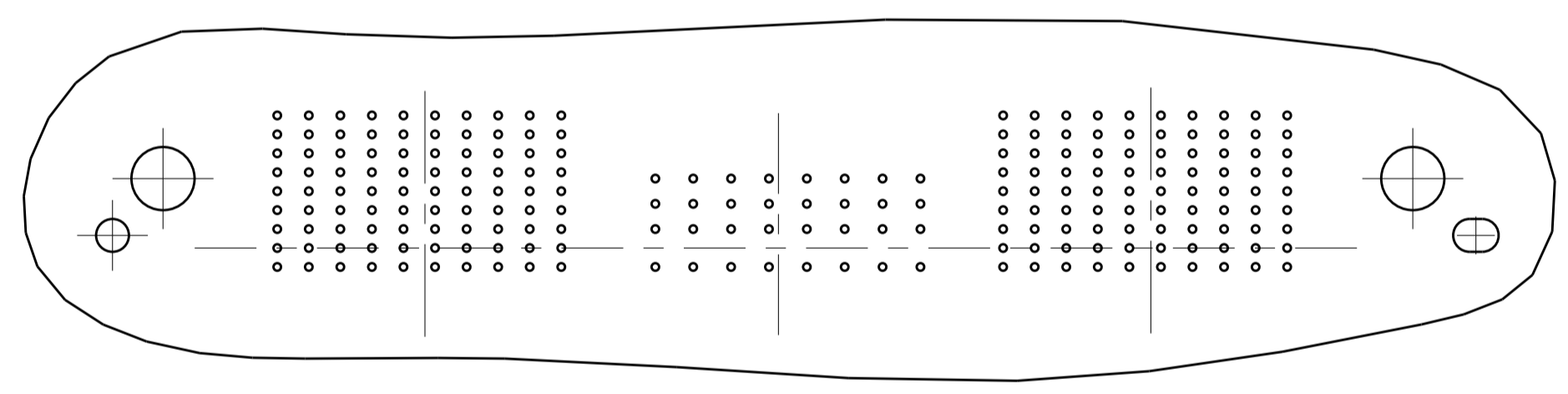

POCKET C POCKET B POCKET A
2000980-4 PCB
SCALE 2:1

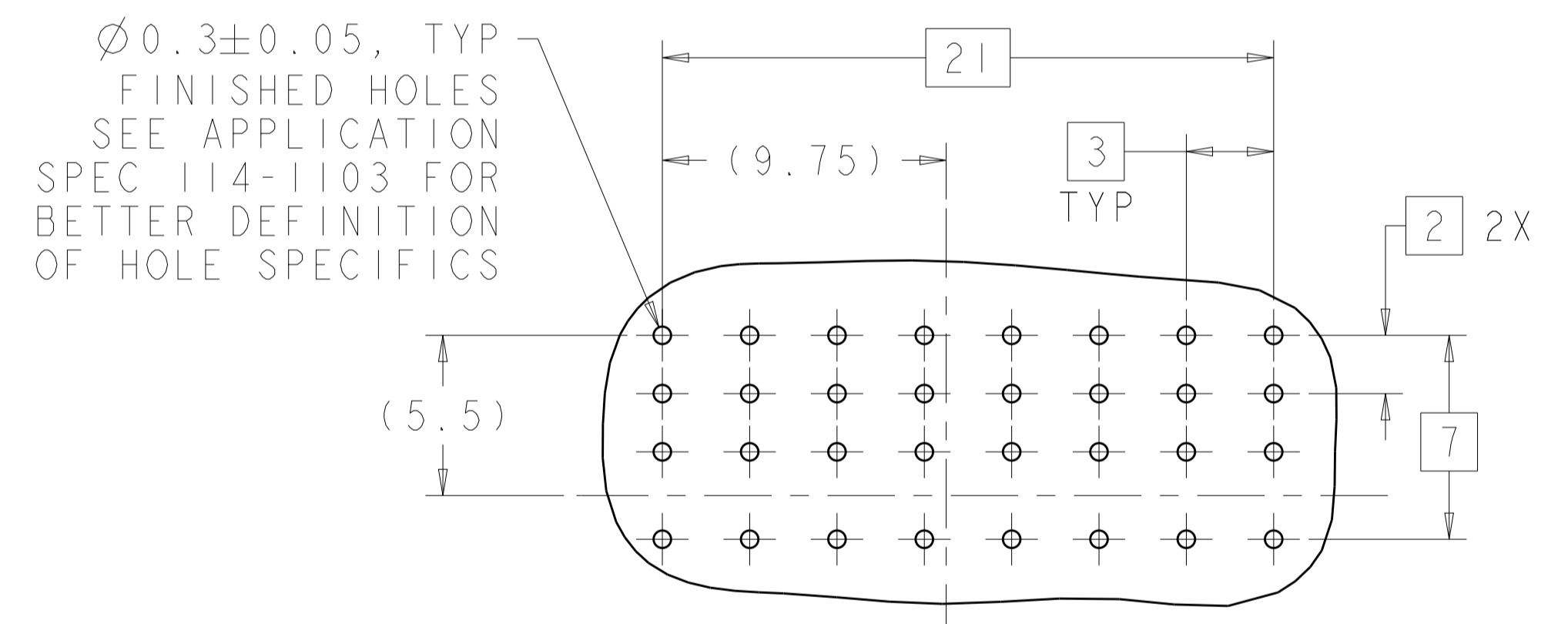

H G F E D C B A
8 POSITION
UNIVERSAL POWER MODULE
DETAIL K
SCALE 5:1

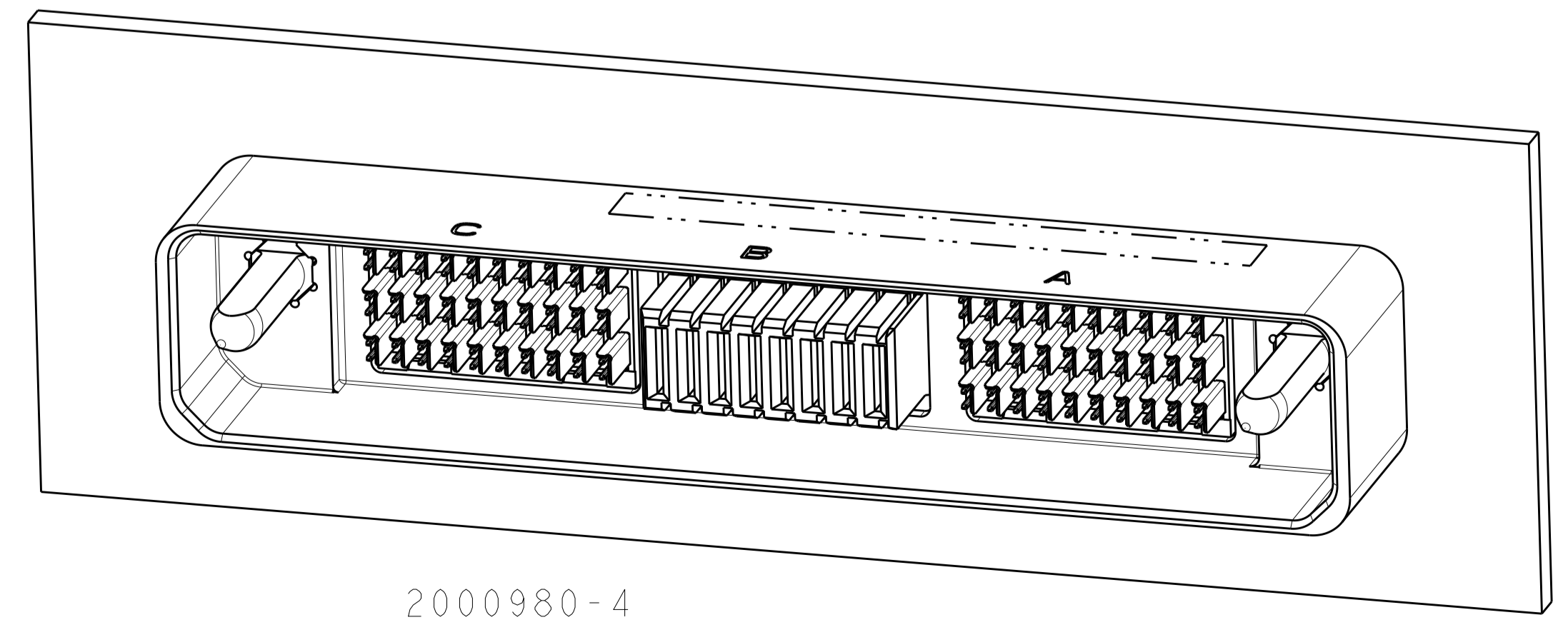

2000980-4
SCALE 2:1

| | | | | |
|---|--|---|-----------|---|
| THIS DRAWING IS A CONTROLLED DOCUMENT. | | OWN: Brent D. Toth | 13JAN2010 | TE Connectivity |
| DIMENSIONS: mm | | CHK: CHONG YI | 13JAN2010 | |
| TOLERANCES UNLESS OTHERWISE SPECIFIED: | | APVD: M. R. McALONIS | 13JAN2010 | NAME: MOTHER BOARD CONNECTOR, HIGH SPEED RUGGEDIZED (HSR), 3 BAY, UNSEALED, VERTICAL PRODUCT SPEC: 108-2381 APPLICATION SPEC: |
| 0 PLC ±0.2 1 PLC ±0.1 2 PLC ±0.05 3 PLC ±0.025 4 PLC ±0.1 | | SIZE: A1 CAGE CODE: 00779 DRAWING NO: 2000980 | | |
| MATERIAL: SEE TABLE | | WEIGHT: - | | RESTRICTED TO: - |
| FINISH: SEE TABLE | | CUSTOMER DRAWING | | SCALE: 1:1 SHEET 2 OF 3 REV G |

| LOC | | DIST | | REVISIONS | | | |
|-----|-----|-------------|------|-----------|------|---|---|
| P | LTN | DESCRIPTION | DATE | DMN | APVD | | |
| - | - | SEE SHEET 1 | - | - | - | - | - |
| | | | | | | | |
| | | | | | | | |

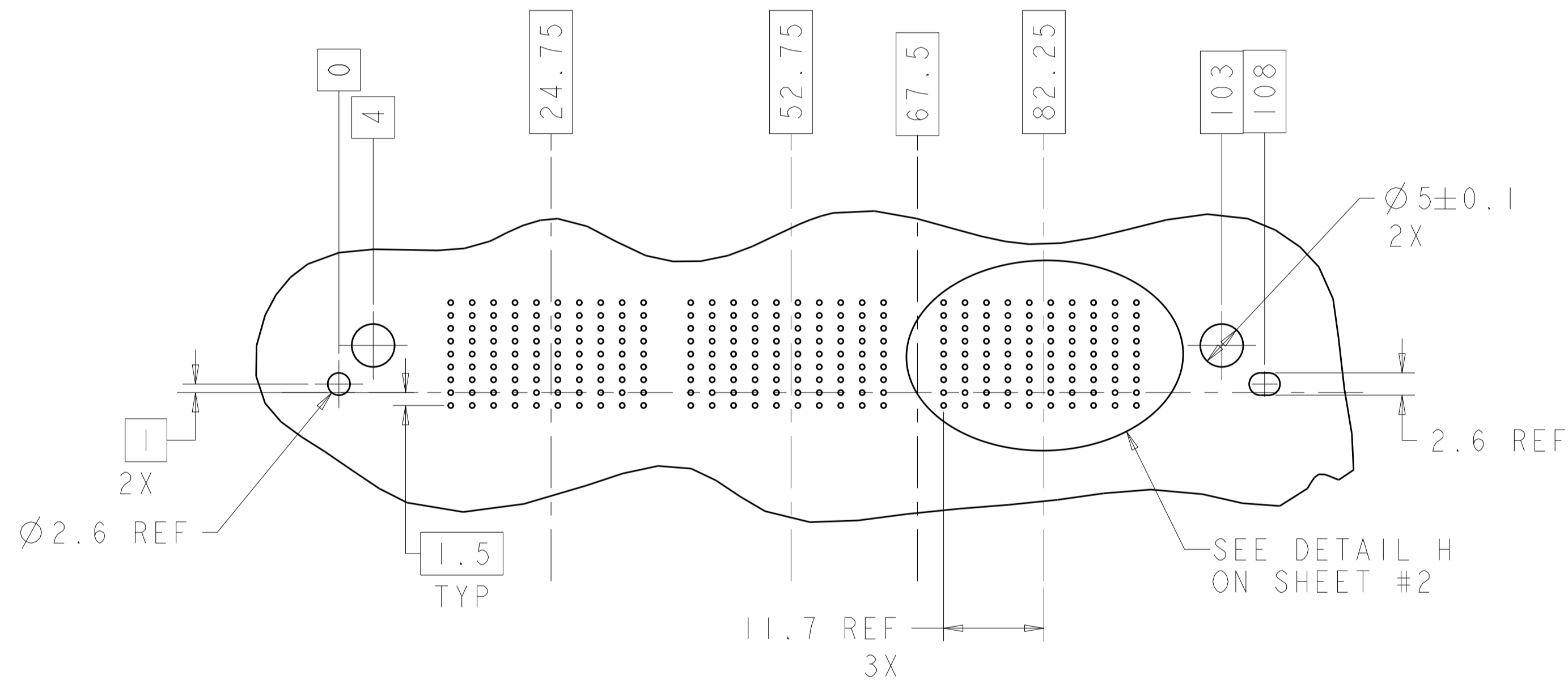

RECOMMENED PC BOARD LAYOUT (MOTHERBOARD)
 FOR 2000980-5
 AS VIEWED FROM TOP OF PCB
 (3 HM-Zd)

| | | | | |
|---|--|-------------------------------------|--|--------------------|
| THIS DRAWING IS A CONTROLLED DOCUMENT. | | DMN Brent D. Tolm 13JAN2010 | TE Connectivity | |
| DIMENSIONS: mm | | CHK CHONG YI 13JAN2010 | | |
| TOLERANCES UNLESS OTHERWISE SPECIFIED: 0 PLC ±0.2 1 PLC ±0.1 2 PLC ±0.05 3 PLC ±0.025 4 PLC ± ANGLES ±° | | APVD M. R. McALONIS 13JAN2010 | NAME MOTHER BOARD CONNECTOR, HIGH SPEED RUGGEDIZED (HSR), 3 BAY, UNSEALED, VERTICAL | |
| MATERIAL - | | FINISH SEE TABLE | WEIGHT - | RESTRICTED TO - |
| CUSTOMER DRAWING | | SCALE 1:1 | SHEET 3 | REV G |

Mouser Electronics

Authorized Distributor

Click to View Pricing, Inventory, Delivery & Lifecycle Information:

[TE Connectivity:](#)

[2000980-3](#)