

PART NUMBER	REV	FIRST USED	POWER UNIT	FEED TYPE	DESCRIPTION
1852751-1	A	122500-1	LEADMAKER	AIR FEED	CUTS CARRIER
1852751-2	A	565435-5	BENCH MODEL K	AIR FEED	CUTS CARRIER
1852751-3	A	354500-1	BENCH MODEL G	AIR FEED	CUTS CARRIER
7-1852751-7	A	-	-	-	SPARE PARTS

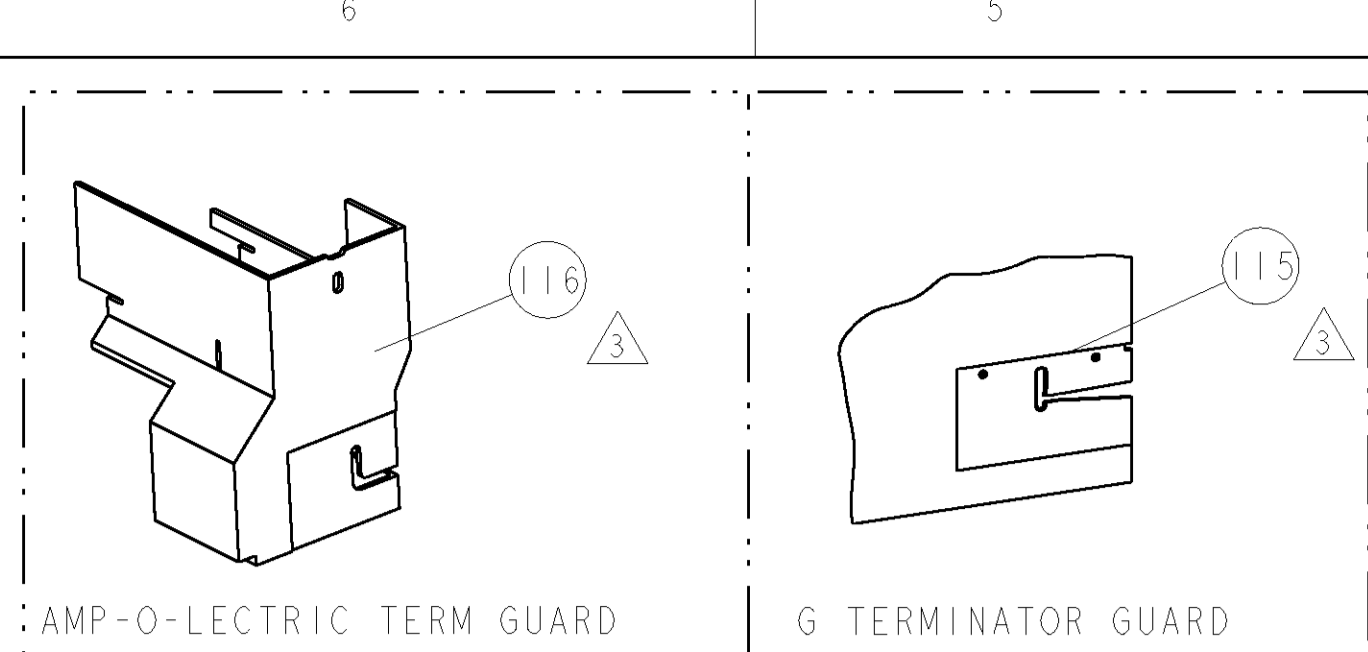

TERMINAL NAME: TERMINAL, RING		UTILUX TERM - UTILUX CRIMP SPECS		REF SETTING	
TYCO PN	MFR PN	CRIMP HEIGHT	WIRE SIZE		
1949768	ET-114CD				
-	-	1.65mm±0.05 [1.065±.002]	1.00mm2	B3	
-	-	1.55mm±0.05 [1.061±.002]	0.85mm2	C5	
-	-	1.55mm±0.05 [1.061±.002]	0.75mm2	C4	
-	-	1.45mm±0.05 [1.057±.002]	0.5mm2	D2	
CRIMP	SIZE	TYPE	RANGE		
-	-	WIRE	2.59mm [1.02]	F	0.4 - 1.0mm2
-	-	INSUL	3.86mm [1.52]	F	Ø2.8 mm MAX
WIRE STRIP LENGTH	TERM APPL SPEC	FEED	APPLICATOR INSTRUCTIONS	SET UP GAGE	
4.75mm	NONE	9.3mm	408-8040	458637-1	

LOC	REV	DESCRIPTION	DATE	DM	APVD
A	66	RELEASED	17NOV2008	DM	DM

- △ RECOMMENDED SPARE PARTS
- △ GREASE LIGHTLY
- △ GUARD MUST BE IN PLACE WHEN OPERATING APPLICATOR IN A BENCH MACHINE
- △ INSTALL ITEMS 101, 102, AND 119 ON SIDE OF STRIPPER ON APPL HOUSING USING ITEM 21.

*** WARNING**
ON INSTALLATION, SET WIRE DISC TO LARGEST WIRE SIZE SETTING. USE OF SETTINGS BELOW MIN. REQUIRED CRIMP HEIGHT SETTING WILL CAUSE DAMAGE TO CRIMP TOOLING.

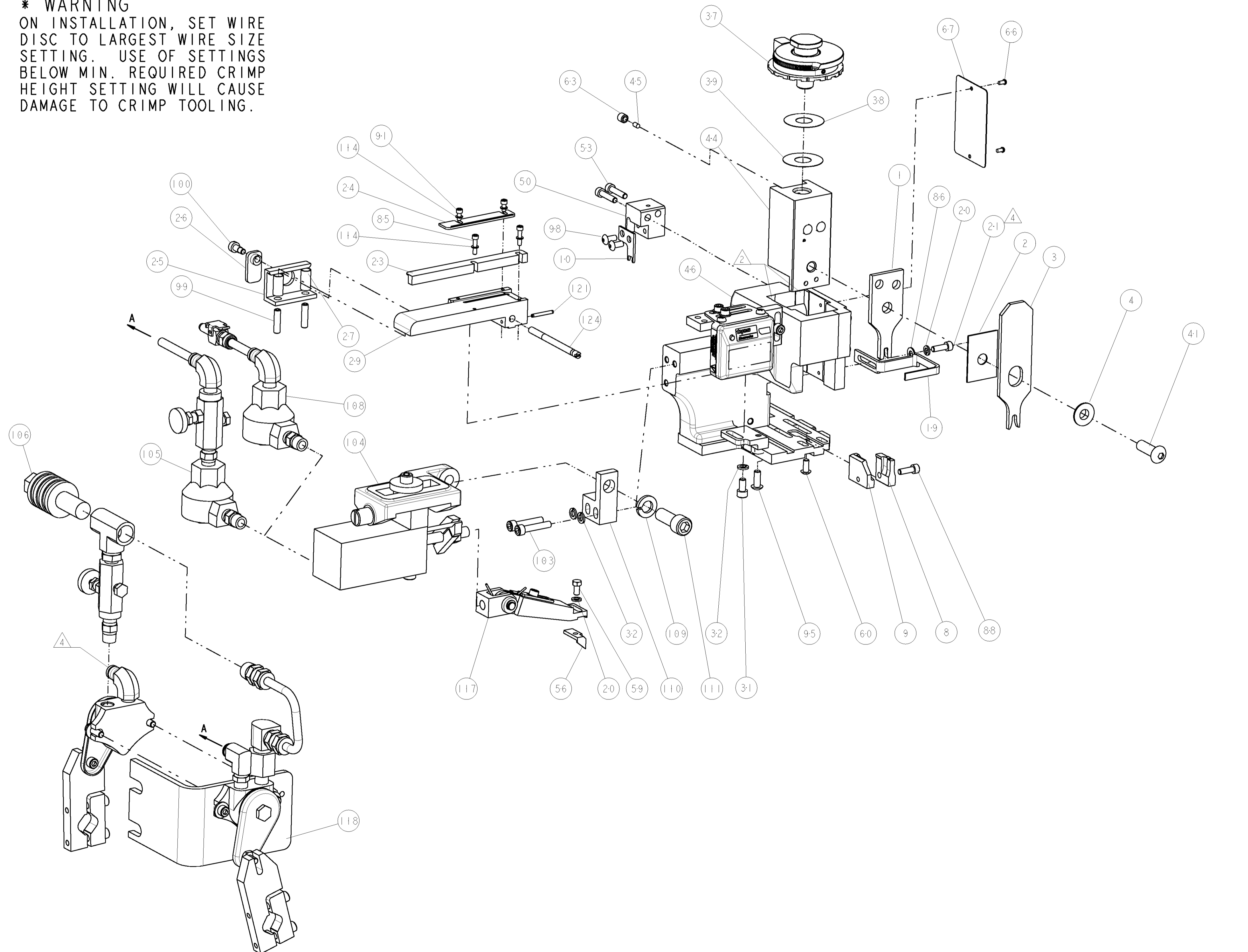

-	-	1	-	-	455350-4	AIR BLAST ASS'Y	125
-	1	1	1	-	690432-3	ADJUSTMENT SCREW	124
-	1	1	1	-	4-21028-0	PIN, SLOTTED SPRING .094 X .750	121
-	18	24	18	IN	27319-4	TUBING, POLY-FLO, NATURAL	119
-	-	1	-	-	692655-6	AIR FEED VALVE ASSEMBLY	118
-	-	1	1	1	461062-1	FEED FINGER ASSEMBLY	117
-	-	REF	-	-	455749-1	GUARD WINDOW	116
-	REF	-	-	-	679532-1	INSERT, GUARD	115
-	4	4	4	-	21024-2	WASHER, SPRG LOCK, REG NO 4	114
-	1	1	1	-	3-21001-5	SCR, SKT HD CAP 3/8-16 X 1.000	111
-	1	1	1	-	459610-1	MOUNT, FEED BRACKET	110
-	1	1	1	-	21024-8	WASHER, SPRG LOCK, REG 3/8	109
-	1	-	1	-	692655-7	AIR FEED VALVE ASSEMBLY	108
-	-	1	-	-	24042-2	VALVE, SLEEVE, 3-WAY	106
-	-	1	-	-	692655-5	AIR FEED VALVE ASSEMBLY	105
-	1	1	1	-	461065-1	ASSEMBLY, AIR FEED	104
-	2	2	2	-	3-21000-9	SCR, SKT HD CAP 10-32 X 1.000	103
-	1	1	1	-	986220-3	CLAMP, CABLE, BLACK	102
-	1	-	1	-	23238-1	INSERT, COUPLING	101
-	1	1	1	-	22353-8	SCR, SHLD, SLOT HD, 3/16 DIA	100
-	2	2	2	-	5-21006-6	SCR, SET, CUP POINT 10-32 X .750	99
-	2	2	2	-	2-21002-1	SCR, BTN SKT HD CAP 8-32 X .375	98
-	1	1	1	-	2-21002-7	SCR, BTN SKT HD CAP 10-32 X .500	95
-	2	2	2	-	1-21000-3	SCR, SKT HD CAP 4-40 X .250	91
-	1	1	1	-	2-21000-7	SCR, SKT HD CAP 8-32 X .500	88
-	1	1	1	-	21055-6	WASHER, FLAT, REG NO 8	86
-	2	2	2	-	1-21000-5	SCR, SKT HD CAP 4-40 X .500	85
-	1	1	1	-	4088040	SF APPL INST 408-8040	72
-	1	1	1	-	217238-1	GENERAL INSTRUCTION PKG	71
-	1	1	1	-	461264-5	PLATE, IDENTIFICATION	67
-	2	2	2	-	21017-2	SCREW, DRIVE	66
-	1	1	1	-	21009-2	SCR, SET, SELF LOCKING 1/4-20 X .250	63
-	1	1	1	-	22733-8	SCR, BHSC, SELF-LOCKING, 8-32 X .375	60
-	1	1	1	-	2-22603-0	SCR, HEX HD CAP 8-32 X .312	59
-	1	1	1	-	3-694433-9	FEED PAWL	56
-	2	2	2	-	2-21000-9	SCR, SKT HD CAP 8-32 X .750	53
-	1	1	1	-	1-1583893-0	HOLDER, SLUG BLADE	50
-	1	1	1	-	1-1633399-1	APPL., BASIC AIR FEED SUB ASSY	46
-	1	1	1	-	690191-1	PLUG, NYLON	45
-	1	1	1	-	455673-1	RAM, SIDE FEED	44
-	1	1	1	-	7-21002-9	SCR, BTN SKT HD CAP 5/16-24 X 1.00	41
-	1	1	1	-	690125-1	SHIM SUB-ASSY	39
-	1	1	1	-	469367-1	SHIM	38
-	1	1	1	-	879103-2	FINE ADJUST HEAD ASSEMBLY	37
-	3	3	3	-	21024-5	WASHER, SPRG LOCK, REG NO 10	32
-	1	1	1	-	3-21000-4	SCR, SKT HD CAP 10-32 X .375	31
-	1	1	1	-	3-844048-6	PLATE, REAR STRIP GUIDE	29
-	2	2	2	-	22281-9	SPRING, COMPRESSION	27
-	1	1	1	-	240793-1	LEVER, DRAG RELEASE	26
-	1	1	1	-	240792-1	DRAG, TERMINAL	25
-	1	1	1	-	1-690438-5	FRONT STRIP GUIDE	24
-	1	1	1	-	1-189124-4	GUIDE, FRONT STRIP	23
-	1	1	1	-	2-21000-7	SCR, SKT HD CAP 8-32 X .500	21
-	2	2	2	-	21024-4	WASHER, SPRG LOCK, REG NO 8	20
-	1	1	1	-	1-456468-1	STRIPPER, SPECIAL	19
-	1	1	1	-	1-1583859-3	BLADE, SLUG	10
-	1	1	1	-	1-1633124-8	PLATE, REAR SHEAR	9
-	1	1	1	-	1-1633507-4	ANVIL, SPECIAL, COMBINATION	8
-	1	1	1	-	238009-1	BLOCK, FL CRIMPER SPACER	4
-	1	1	1	-	9-1583690-6	CRIMPER, INSUL O	3
-	1	1	1	-	455888-8	SPACER, CRIMPER	2
-	1	1	1	-	1-1633664-0	CRIMPER, WIRE	1

Mouser Electronics

Authorized Distributor

Click to View Pricing, Inventory, Delivery & Lifecycle Information:

[TE Connectivity:](#)

[1852751-2](#)