

4

3

2

1

THIS DRAWING IS UNPUBLISHED. RELEASED FOR PUBLICATION  
© COPYRIGHT ALL RIGHTS RESERVED.

LOC	DIST	REVISIONS			
P	LTR	DESCRIPTION	DATE	DWN	APVD
	A1	ECR-14-002248	19FEB2014	GK	HMR

# REPLACED BY OCEAN STYLE APPLICATOR PART NUMBER 2266014-1

FOR REPLACEMENT PARTS FOR APPLICATOR 1528273 REFER TO ADDITIONAL PAGE(S). SPARE PARTS KIT (IF LISTED) WILL REMAIN AVAILABLE.

THE REPLACEMENT OCEAN STYLE APPLICATOR HAS THE SAME TERMINATOR/PRESS INTERFACE AS APPLICATOR 1528273

THIS DRAWING IS A CONTROLLED DOCUMENT.		DWN	GOPALAKRISHNA HV														
DIMENSIONS:		CHK	RAGHAVENDRA														
TOLERANCES UNLESS OTHERWISE SPECIFIED:		APVD	RAGHAVENDRA														
<table border="0"> <tr><td>0 PLC</td><td>±</td></tr> <tr><td>1 PLC</td><td>±</td></tr> <tr><td>2 PLC</td><td>±</td></tr> <tr><td>3 PLC</td><td>±</td></tr> <tr><td>4 PLC</td><td>±</td></tr> <tr><td>ANGLES</td><td>±</td></tr> </table>		0 PLC	±	1 PLC	±	2 PLC	±	3 PLC	±	4 PLC	±	ANGLES	±	PRODUCT SPEC	NAME		
0 PLC	±																
1 PLC	±																
2 PLC	±																
3 PLC	±																
4 PLC	±																
ANGLES	±																
MATERIAL		APPLICATION SPEC	FINE ADJUST SIDE FEED HD-I APPLICATOR														
FINISH		WEIGHT	SIZE	CAGE CODE	DRAWING NO												
			A3		©- 1528273												
		CUSTOMER DRAWING	SCALE	SHEET 1 OF 2	REV A1												

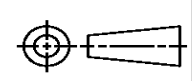

PART NUMBER	REV	TERMINATOR	FEED TYPE	DESCRIPTION
1528273-1	A	LEADMAKER	MECH POST FEED	CUTS CARRIER
1528273-2	A	BENCH	MECH PRE FEED	CUTS CARRIER
1528273-6	A	LEADMAKER	MECH POST FEED	CONTINUOUS CARRIER
7-1528273-1	A	LEADMAKER	MECH POST FEED	-1 AND SPARE PARTS
7-1528273-2	A	BENCH	MECH PRE FEED	-2 AND SPARE PARTS
7-1528273-6	A	LEADMAKER	MECH POST FEED	-6 AND SPARE PARTS
7-1528273-7	A	-	-	SPARE PARTS KIT

CRIMP	SIZE	TYPE	RANGE
WIRE	2.29 [ .090 IN ]	F	0.50-2.00mm <sup>2</sup> or 20-14 AWG
INSUL	3.56 [ .140 IN ]	O	1.20-2.70 [ .047-.106 IN ]
WIRE STRIP LENGTH	4.00-4.50 [ .157-.177 IN ]		
APPL INSTRUCTIONS	408-8322 & 408-8490		
TERMINAL APPL SPEC	114-8004		FEED 9.80 [ .386 IN ]

TERMINAL	SEAL		
184030	184139	-	-
184289	184140	-	-
-	184141	-	-

WIRE SIZE	CRIMP HEIGHT	REF SETTING
2.00mm <sup>2</sup> or 14AWG	1.70 ± 0.05 [ .067 ± .002 IN ]	B 2
1.50mm <sup>2</sup>	1.50 ± 0.05 [ .059 ± .002 IN ]	C 5
1.20mm <sup>2</sup> or 16AWG	1.45 ± 0.05 [ .057 ± .002 IN ]	C 8
1.00mm <sup>2</sup>	1.29 ± 0.05 [ .051 ± .002 IN ]	E 0
0.80mm <sup>2</sup> or 18AWG	1.24 ± 0.05 [ .049 ± .002 IN ]	E 2
0.75mm <sup>2</sup>	1.24 ± 0.05 [ .049 ± .002 IN ]	E 2
0.60mm <sup>2</sup>	1.19 ± 0.05 [ .047 ± .002 IN ]	E 5
0.50mm <sup>2</sup> or 20AWG	1.17 ± 0.05 [ .046 ± .002 IN ]	E 9

- △ RECOMMENDED SPARE PARTS.
- 2. GREASE RAM, CAM, CAM FOLLOWER AND FEED ROD LIGHTLY.
- △ CERTAIN TERMINALS REQUIRE LUBRICATION. REFER TO THE APPLICATOR INSTRUCTION SHEET FOR MORE INFORMATION.
- 4. LUBRICATE DAILY PER THE APPLICATOR INSTRUCTION SHEET SUPPLIED WITH THE APPLICATOR.
- △ THIS APPLICATOR APPLIES TERMINAL WITH A SEAL.  
SEAL PART NO. 184139 INSULATION DIA. RANGE 1.2 - 1.7.  
SEAL PART NO. 184140 INSULATION DIA. RANGE 1.6 - 2.1.  
SEAL PART NO. 184141 INSULATION DIA. RANGE 2.2 - 2.7.
- △ APPLY TORO-SEAL IN ALLEN SOCKET TO FILL HOLE AFTER FLAT HD HAS BEEN ADJUSTED TO CORRECT HEIGHT AT QUALIFICATION. APPLY #1-23419-5 LOC-TITE TO THREADS.
- △ MIN. TENSILE VALUE FOR 0.50mm<sup>2</sup> & 0.60mm<sup>2</sup> TO BE 80 N.

**VIEW B ROTATED 180°**

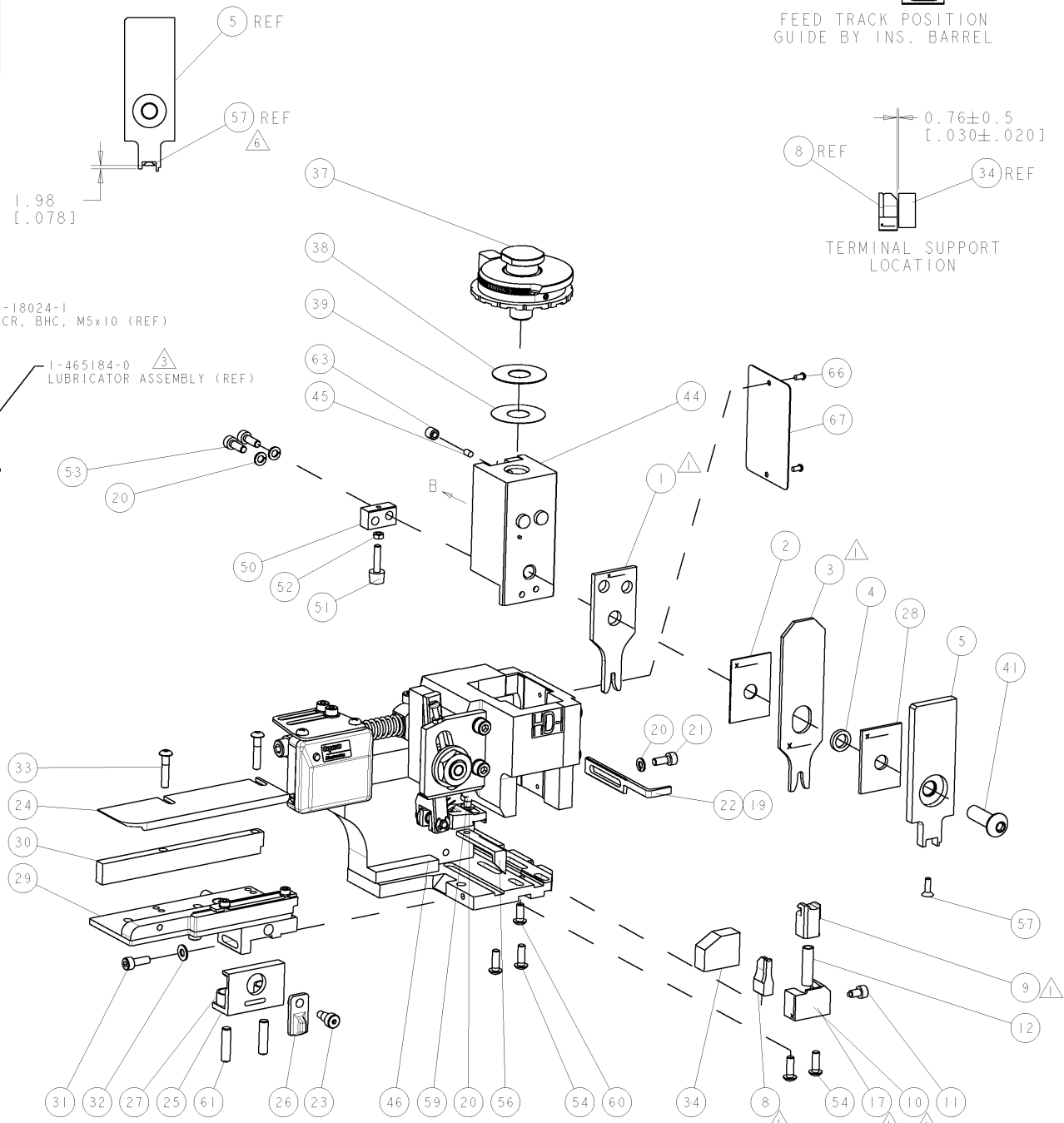
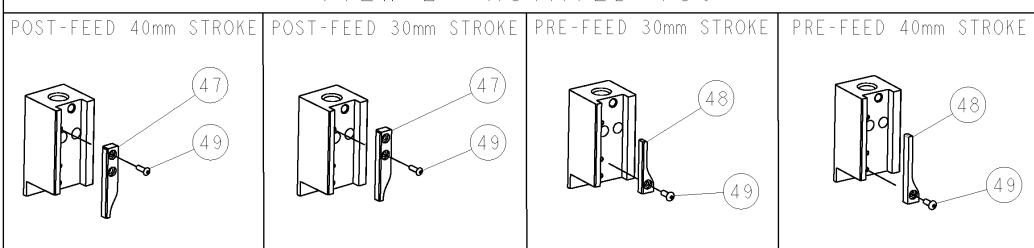

**\* WARNING**  
ON INSTALLATION, SET WIRE DISC TO LARGEST WIRE SIZE SETTING. USE OF SETTINGS BELOW MIN. REQUIRED CRIMP HEIGHT SETTING WILL CAUSE DAMAGE TO CRIMP TOOLING.



FEED TRACK POSITION GUIDE BY INS. BARREL

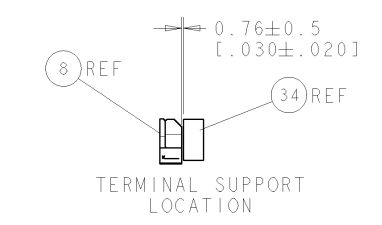

LOC	DIST	REV	DESCRIPTION	DATE	BY	APPV
A	66	A	SEE ECO-08-021762	07NOV2008	LJL	MC

-	-	-	-	-	-	-	-	-	-	-	73
-	-	-	-	-	-	-	-	-	-	-	72
-	1	1	1	1	1	1	1338705-3	DOCUMENTATION PACKAGE	-	-	71
-	-	-	-	-	-	-	-	-	-	-	70
-	-	-	-	-	-	-	-	-	-	-	69
-	-	-	-	-	-	-	-	-	-	-	68
-	1	1	1	1	1	1	461264-5	PLATE, IDENTIFICATION	-	-	67
-	2	2	2	2	2	2	21017-2	SCREW, DRIVE	-	-	66
-	-	-	-	-	-	-	-	-	-	-	65
-	-	-	-	-	-	-	-	-	-	-	64
-	1	1	1	1	1	1	3-18031-0	SCR, SET, CUP POINT M6 X 6.0	-	-	63
-	-	-	-	-	-	-	-	-	-	-	62
-	2	2	2	2	2	2	2-18032-5	SCR, SET, FLT POINT M5 X 20.0	-	-	61
-	1	1	1	1	1	1	18024-7	SCR, BTN SKT HD CAP (M4 X 10.0)	-	-	60
-	1	1	1	1	1	1	5-18022-2	SCR, HEX HD CAP M4 X 8.0	-	-	59
-	-	-	-	-	-	-	-	-	-	-	58
-	1	1	1	1	1	1	985575-3	SCR, FLT SKT HD CAP M3 X 10.0	-	-	57
-	1	1	1	1	1	1	1338685-1	PAWL, FEED	-	-	56
-	-	-	-	-	-	-	-	-	-	-	55
-	4	4	4	4	4	4	18024-8	SCR, BTN SKT HD CAP (M4 X 12.0)	-	-	54
-	2	2	2	2	2	2	1-18023-2	SCR, SKT HD CAP M4 X 12.0	-	-	53
-	1	1	1	1	1	1	18030-1	NUT, HEX, REG M3	-	-	52
-	1	1	1	1	1	1	811242-5	BUMPER, HOLD DOWN	-	-	51
-	1	1	1	1	1	1	690753-2	SPACER, TONKER	-	-	50
-	1	1	1	1	1	1	18024-3	SCR, BTN SKT HD CAP (M3 X 10.0)	-	-	49
-	-	-	-	-	-	-	-	-	-	-	48
-	-	-	-	-	-	-	-	-	-	-	47
-	1	1	1	1	1	1	1338676-1	CAM, UNIVERSAL PRE FEED	-	-	46
-	1	1	1	1	1	1	1320999-3	CAM, UNIVERSAL POST-FEED	-	-	45
-	1	1	1	1	1	1	1320999-3	APPLICATOR SUBASSEMBLY, HDI	-	-	46
-	1	1	1	1	1	1	690191-1	PLUG, NYLON	-	-	45
-	1	1	1	1	1	1	1338660-1	RAM	-	-	44
-	-	-	-	-	-	-	-	-	-	-	43
-	-	-	-	-	-	-	-	-	-	-	42
-	1	1	1	1	1	1	2-18024-6	SCR, BTN SKT HD CAP (M8 X 25.0)	-	-	41
-	-	-	-	-	-	-	-	-	-	-	40
-	1	1	1	1	1	1	690125-1	SHIM SUB-ASSY	-	-	39
-	1	1	1	1	1	1	469367-9	SHIM	-	-	38
-	1	1	1	1	1	1	879103-2	FINE ADJUST HEAD ASSEMBLY	-	-	37
-	-	-	-	-	-	-	-	-	-	-	36
-	-	-	-	-	-	-	-	-	-	-	35
-	1	1	1	1	1	1	1320934-1	SUPPORT, TERMINAL	-	-	34
-	2	2	2	2	2	2	1-18024-0	SCR, BTN SKT HD CAP (M4 X 20.0)	-	-	33
-	1	1	1	1	1	1	18027-2	WASHER, FLAT, REG M4	-	-	32
-	1	1	1	1	1	1	1-18023-2	SCR, SKT HD CAP M4 X 12.0	-	-	31
-	1	1	1	1	1	1	1320908-1	SPACER, STRIP GUIDE	-	-	30
-	1	1	1	1	1	1	1633073-1	STRIP GUIDE ASSEMBLY	-	-	29
-	1	1	1	1	1	1	1-455888-7	SPACER, CRIMPER	-	-	28
-	2	2	2	2	2	2	1-22284-0	SPRING, COMPRESSION	-	-	27
-	1	1	1	1	1	1	356835-1	LEVER, DRAG RELEASE	-	-	26
-	1	1	1	1	1	1	240792-1	DRAG, TERMINAL	-	-	25
-	1	1	1	1	1	1	1320928-1	PLATE, STRIP GUIDE	-	-	24
-	1	1	1	1	1	1	980371-4	SCR, SKT HD SHLDR 5.0 DIA X 6.0	-	-	23
-	1	1	1	1	1	1	690472-2	STRIPPER	-	-	22
-	1	1	1	1	1	1	1-18023-1	SCR, SKT HD CAP M4 X 10.0	-	-	21
-	4	4	4	4	4	4	18025-2	WASHER, SPRG LOCK, REG M4	-	-	20
-	-	-	-	-	-	-	-	-	-	-	19
-	-	-	-	-	-	-	-	-	-	-	18
△	1	-	-	-	-	-	1338684-2	SHEAR HOLDER, FRONT	-	-	17
-	-	-	-	-	-	-	-	-	-	-	16
-	-	-	-	-	-	-	-	-	-	-	15
-	-	-	-	-	-	-	-	-	-	-	14
-	-	-	-	-	-	-	-	-	-	-	13
-	1	1	1	1	1	1	3-22280-3	SPRING, COMPRESSION	-	-	12
-	1	1	1	1	1	1	356885-5	STOP, SHEAR	-	-	11
△	-	1	1	-	-	-	1-1320921-0	SHEAR HOLDER, FRONT, CUT	-	-	10
△	-	1	1	1	1	1	318707-1	FLOATING SHEAR, FRONT	-	-	9
△	1	2	2	2	1	1	3-1333205-2	ANVIL, COMBINATION	-	-	8
-	-	-	-	-	-	-	-	-	-	-	7
-	-	-	-	-	-	-	-	-	-	-	6
-	1	1	1	1	1	1	1338680-2	DEPRESSOR, SHEAR	-	-	5
-	1	1	1	1	1	1	1-238011-0	BLOCK, CRIMPER SPACER	-	-	4
△	1	2	2	2	1	1	5-683454-0	CRIMPER, INSULATION 0	-	-	3
-	1	1	1	1	1	1	455888-7	SPACER, CRIMPER	-	-	2
△	1	2	2	2	1	1	3-456406-3	CRIMPER, WIRE PREMIUM	-	-	1

-77	-76	-72	-71	-6	-2	-1	PART NO	DESCRIPTION	ITEM NO
-	-	-	-	-	-	-	-	-	84
-	-	-	-	-	-	-	-	-	83
-	-	-	-	-	-	-	-	-	82
-	-	-	-	-	-	-	-	-	81
-	-	-	-	-	-	-	-	-	80
-	-	-	-	-	-	-	-	-	79
-	-	-	-	-	-	-	-	-	78
-	-	-	-	-	-	-	-	-	77
-	-	-	-	-	-	-	-	-	76
-	-	-	-	-	-	-	-	-	75
-	-	-	-	-	-	-	-	-	74

# Mouser Electronics

Authorized Distributor

Click to View Pricing, Inventory, Delivery & Lifecycle Information:

[TE Connectivity:](#)

[1528273-6](#)