

4

3

2

1

THIS DRAWING IS UNPUBLISHED. RELEASED FOR PUBLICATION
© COPYRIGHT ALL RIGHTS RESERVED.

LOC	DIST	REVISIONS			
P	LTR	DESCRIPTION	DATE	DWN	APVD
	G1	ECR-14-003070	01MAR2014	GK	HMR

REPLACED BY OCEAN STYLE APPLICATOR PART NUMBER 2151153-1

FOR REPLACEMENT PARTS FOR APPLICATOR 1426244
REFER TO ADDITIONAL PAGE(S). SPARE PARTS KIT (IF LISTED)
WILL REMAIN AVAILABLE.

THE REPLACEMENT OCEAN STYLE APPLICATOR HAS THE
SAME TERMINATOR/PRESS INTERFACE AS APPLICATOR
1426244

THIS DRAWING IS A CONTROLLED DOCUMENT.		DWN	GOPALAKRISHNA HV														
DIMENSIONS:		CHK	RAGHAVENDRA														
TOLERANCES UNLESS OTHERWISE SPECIFIED:		APVD	RAGHAVENDRA														
<table border="0"> <tr><td>0 PLC</td><td>±</td></tr> <tr><td>1 PLC</td><td>±</td></tr> <tr><td>2 PLC</td><td>±</td></tr> <tr><td>3 PLC</td><td>±</td></tr> <tr><td>4 PLC</td><td>±</td></tr> <tr><td>ANGLES</td><td>±</td></tr> </table>		0 PLC	±	1 PLC	±	2 PLC	±	3 PLC	±	4 PLC	±	ANGLES	±	PRODUCT SPEC	NAME		
0 PLC	±																
1 PLC	±																
2 PLC	±																
3 PLC	±																
4 PLC	±																
ANGLES	±																
MATERIAL		APPLICATION SPEC	SIDE FEED HD-I APPLICATOR														
FINISH		WEIGHT	SIZE	CAGE CODE	DRAWING NO												
			A3		©- 1426244												
		CUSTOMER DRAWING	SCALE	SHEET 1 OF 2	REV G1												

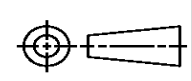

THIS DRAWING IS UNPUBLISHED. RELEASED FOR PUBLICATION
 © COPYRIGHT BY TYCO ELECTRONICS CORPORATION. ALL RIGHTS RESERVED.

LOC	QST	REVISIONS			
A	66	REV	DATE	BY	APPD
		G	6-2007	MY	GB

PART NUMBER	REV	FIRST USED	TERMINATOR	FEED TYPE	DESCRIPTION
1426244-1	G		LEADMAKER	MECH POST FEED	CUTS CARRIER
1426244-2	G		BENCH	MECH PRE FEED	CUTS CARRIER
1426244-6	G		LEADMAKER	MECH POST FEED	CONTINUOUS CARRIER
7-1426244-1	G		LEADMAKER	MECH POST FEED	-1 AND SPARE PARTS
7-1426244-2	G		BENCH	MECH PRE FEED	-2 AND SPARE PARTS
7-1426244-6	G		LEADMAKER	MECH POST FEED	-6 AND SPARE PARTS
7-1426244-7	A		-	-	SPARE PARTS KIT

CRIMP DATA AMP TERMINAL AMP CRIMP SPECS			
TERMINAL NAME: ELO PIN AND SOCKET TERMINAL			
CRIMP	SIZE	TYPE	RANGE
WIRE	1.40 [.055 IN]	F	0.22mm ² - 0.50mm ²
INSUL	2.03 [.080 IN]	0	1.20-1.60 [.047-.063 IN]
WIRE STRIP LENGTH	APPL INSTRUCTION		
3.80-4.60 [.150-.181 IN]	408-8322		

TERMINAL APPL SPEC	FEED
114-18433	5.08 [.200 IN]

TERMINALS APPLIED			
1411582	-	-	-
1411580	-	-	-
1411574	-	-	-
1411566	-	-	-
1411560	-	-	-
1411558	-	-	-
1411552	-	-	-
1411550	-	-	-

WIRE SIZE mm ² AWG	CRIMP HEIGHT	PIN PN AND LENGTH [IN]
0.50mm ²	1 ±0.03 [.039 ±0.001 IN]	3-354779-9 [.3185]
0.35mm ²	0.92 ±0.03 [.036 ±0.001 IN]	4-354779-5 [.3215]
0.22mm ²	0.87 ±0.03 [.034 ±0.001 IN]	4-354779-9 [.3235]

SET UP GAGE	LAYOUT
458637-3	L1426244

- ⚠️ RECOMMENDED SPARE PARTS.
- 2. GREASE RAM, CAM, CAM FOLLOWER AND FEED ROD LIGHTLY.
- 3. LUBRICATE DAILY PER THE APPLICATOR INSTRUCTION SHEET SUPPLIED WITH THE APPLICATOR.
- ⚠️ CUT TO LENGTH AT ASSY.
- ⚠️ THIS APPLICATOR HAS BEEN DESIGNED TO APPLY WIRES WITH THIN-WALL (FLR) INSULATION.

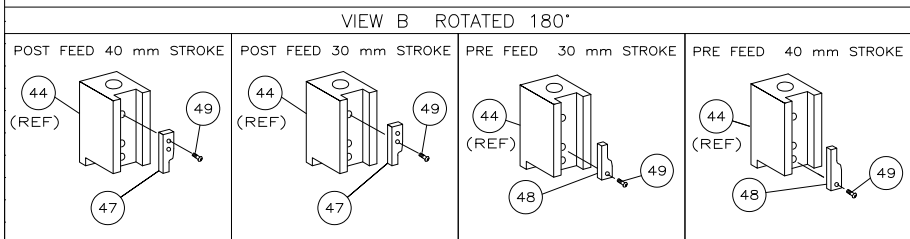
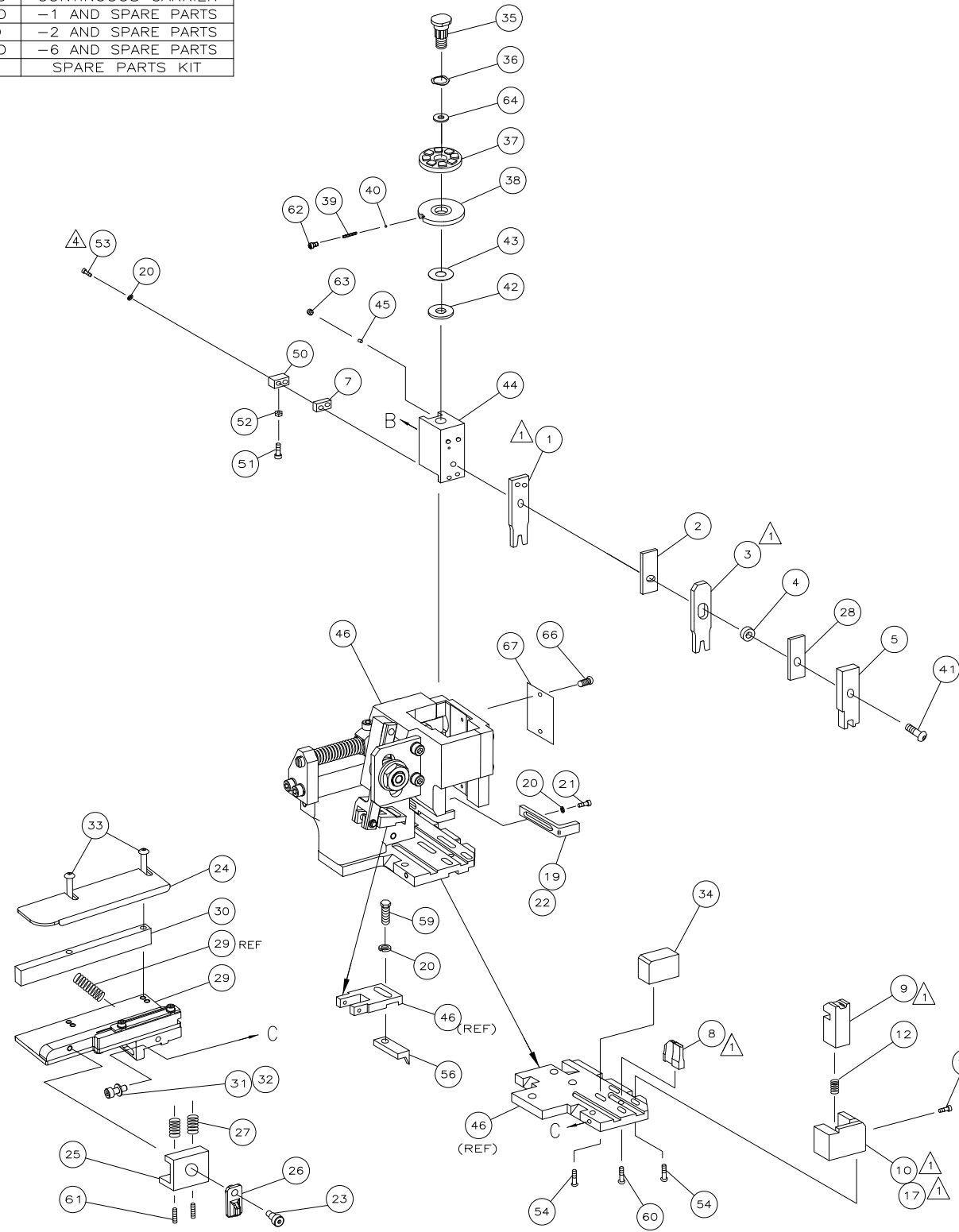

QTY	REQD	PER	ASSY	PART NO	DESCRIPTION	ITEM NO	
-	1	1	1	1	1426244	PRINT, APPLICATOR LOG SHEET	73
-	1	1	1	1	1338705-1	DOCUMENTATION PACKAGE	72
-	1	1	1	1			71
-	1	1	1	1			70
-	1	1	1	1			69
-	1	1	1	1			68
-	1	1	1	1	461264-1	PLATE, IDENTIFICATION	67
-	2	2	2	2	21017-2	SCR,DRIVE(#2x.19)ID PLATE	66
-	1	1	1	1			65
-	1	1	1	1	986950-1	WASHER, FLAT PRECISION	64
-	1	1	1	1	3-18031-0	SCR,SKT SET(M6X6)RAM	63
-	1	1	1	1	18023-9	SCR,SHC(M4X6)INS DISC	62
-	2	2	2	2	2-18032-5	SCR,SET(M5X20)DRAG	61
-	1	1	1	1	18024-7	SCR,BHC(M4X10)ANVIL	60
-	1	1	1	1	5-18022-2	SCR,HEX(M4X8)FEED FINGER	59
-	1	1	1	1			58
-	1	1	1	1			57
-	1	1	1	1	1338685-1	PAWL, FEED	56
-	1	1	1	1			55
-	4	4	4	4	18024-8	SCR,BHC(M4x12)SHEAR HOLDER	54
-	2	2	2	2	1-18023-3	SCR,SHC(M4x16)TERM HLD DWN	53
-	1	1	1	1	18030-1	NUT,HEX(M3)HOLD DOWN	52
-	1	1	1	1	811242-5	BUMPER, HOLDDOWN	51
-	1	1	1	1	690753-2	SPACER, TONKER	50
-	1	1	1	1	18024-3	SCR,BHC(M3X10)CAM	49
-	1	1	1	1	1338675-1	CAM, PRE FEED 30 & 40 mm ST	48
-	1	1	1	1	1338676-1	CAM, POST FEED 30 & 40 mm ST	47
-	1	1	1	1	1320999-3	APPLICATOR BASIC SUBASSY	46
-	1	1	1	1	690191-1	PLUG, NYLON	45
-	1	1	1	1	1338660-1	RAM	44
-	1	1	1	1	690125-1	WASHER, LAMINATED	43
-	1	1	1	1	690124-1	WASHER, RAM	42
-	1	1	1	1	2-18024-6	SCR,BHC(M8X25)RAM	41
-	1	1	1	1	23241-1	BALL, STEEL	40
-	1	1	1	1	2-22278-7	SPRING, COMPRESSION	39
-	1	1	1	1	1320922-1	DISC, INSULATION	38
-	1	1	1	1	354777-1	WIRE DISC, PLASTIC	37
-	1	1	1	1	22480-5	WASHER, SPRING	36
-	1	1	1	1	690212-1	POST, RAM	35
-	1	1	1	1	1320934-1	SUPPORT, TERMINAL	34
-	2	2	2	2	1-18024-0	SCR,BHC(M4X20)STRIP GUIDE	33
-	1	1	1	1	18027-2	WASHER, FLAT(M4)	32
-	1	1	1	1	1-18023-2	SCR,SKT CAP(M4X12)MOUNT BLOCK	31
-	1	1	1	1	1320908-4	SPACER, STRIP GUIDE	30
-	1	1	1	1	1633073-1	STRIP GUIDE PLATE ASSY	29
-	1	1	1	1	1-455888-0	SPACER, FRONT SHEAR DEP	28
-	2	2	2	2	1-22284-0	SPRING, DRAG	27
-	1	1	1	1	356835-1	LEVER, DRAG RELEASE	26
-	1	1	1	1	240792-1	DRAG, TERMINAL	25
-	1	1	1	1	1320928-1	PLATE, STRIP GUIDE	24
-	1	1	1	1	980371-4	SCR,SHC SHLD	23
-	1	1	1	1	690472-2	STRIPPER	22
-	1	1	1	1	1-18023-1	SCR,SHC(M4X10)STRIPPER	21
-	4	4	4	4	18025-2	WASHER,LOCK(M4)STRIPPER	20
-	1	1	1	1	690472-1	STRIPPER	19
-	1	1	1	1			18
-	1	1	1	1	1338684-1	HOLDER, SHEAR, FRONT (NO-CUT)	17
-	1	1	1	1			16
-	1	1	1	1			15
-	1	1	1	1			14
-	1	1	1	1			13
-	1	1	1	1	3-22280-3	SPRING, SHEAR	12
-	1	1	1	1	356885-4	STOP, SHEAR	11
-	1	1	1	1	1320921-1	HOLDER, SHEAR, FRONT (CUT)	10
-	1	1	1	1	462006-1	SHEAR, FLOAT (FRONT)	9
1	2	2	2	1	3-1333201-2	ANVIL	8
-	1	1	1	1	240641-1	SPACER, DEPRESSOR (REAR)	7
-	1	1	1	1			6
-	1	1	1	1	2-455889-0	DEPRESSOR, SHEAR (FRONT)	5
-	1	1	1	1	238011-8	SPACER, BLOCK CRIMPER	4
1	2	2	2	1	8-655830-9	CRIMPER, INSULATION	3
-	1	1	1	1	455888-3	SPACER, CRIMPER	2
1	2	2	2	1	5-456402-5	CRIMPER, WIRE	1

DIMENSIONS:		TOLERANCES UNLESS OTHERWISE SPECIFIED:	
INCHES	0 PLC ±	1 PLC ±	2 PLC ±
	3 PLC ±	4 PLC ±	ANGLES ±
			FINISH

REV	DATE	BY	APPD
A1	00779	GB	

THIS DRAWING IS A CONTROLLED DOCUMENT. L LOFTHOUSE 07SEP01
 Tyco Electronics Corporation Harrisburg, PA 17105-3608
 F BACKHURST 07SEP01
 SIDE FEED HD-I APPLICATOR
 SCALE: 1 OF 1 SHEET REV G

Mouser Electronics

Authorized Distributor

Click to View Pricing, Inventory, Delivery & Lifecycle Information:

[TE Connectivity:](#)

[1426244-2](#)