

| PART NUMBER | REV | FIRST USED |
|-------------|-----|------------|
| 1385337-1   | A   | 354500-1   |
| 1385337-2   | A   | 565435-5   |

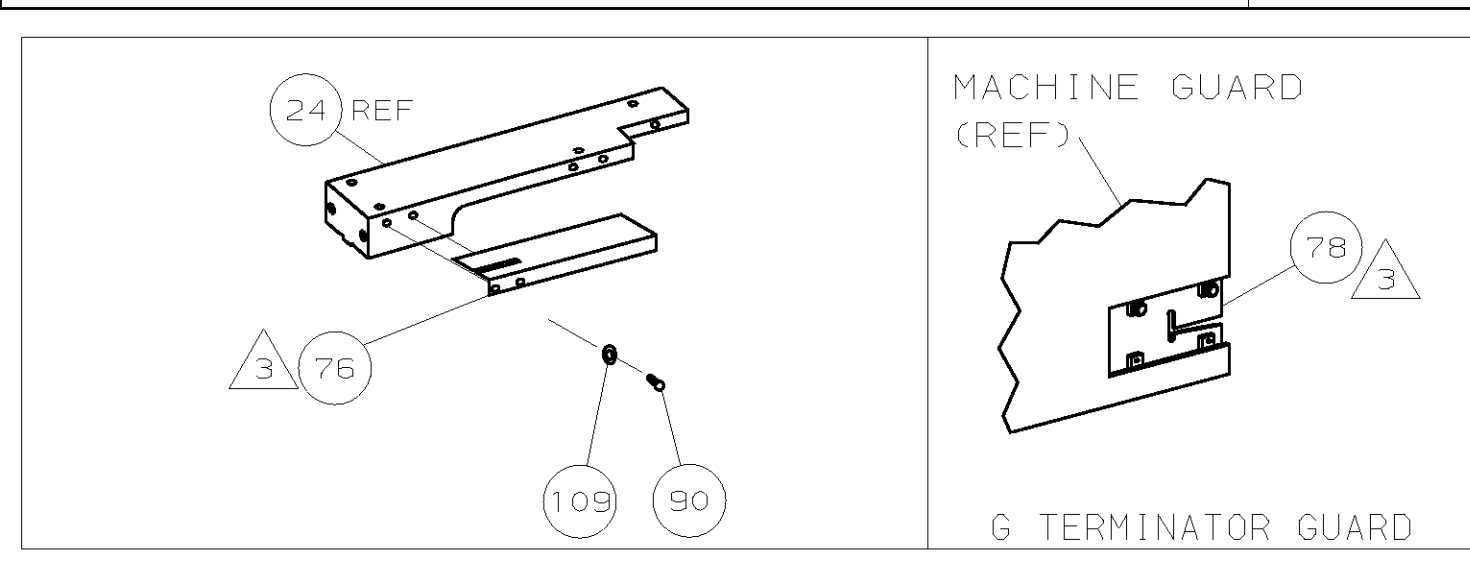

| TERMINAL NAME: .187 AMPLIVAR FASTON™ FLAG RECEIPT |                           | 1217624     |             | CRIMPING DATA    |             |
|---|---------------------------|-------------|-------------|------------------|-------------|
| PAD LTR   | CRIMP HEIGHT              | WIRE SIZE   |             |                  |             |
| A   | .044 ±.002 [1.12 ±0.05mm] | 767-960 CMA |             | 5                |             |
| B   | .042 ±.002 [1.09 ±0.05mm] | 500-650 CMA |             | 6                |             |
| C   | .040 ±.002 [1.02 ±0.05mm] | 400-500 CMA |             | 7                |             |
| CRIMP   | SIZE                      | TYPE        | RANGE       |                  |             |
| WIRE  | .070 [1.78mm]             | F           | 500-960 CMA |                  |             |
| INSUL   | .070 [1.78mm]             | 0           | .020-.040   |                  |             |
| WIRE STRIP LENGTH                                 | TERM APPL                 | SPEC        | FEED        | APPL INSTRUCTION | SET UP GAGE |
| -   | NONE                      |             | .570        | 408-8039         | 458638-1    |
|   |                           |             |             | LAYOUT           | L1810       |

| -1 | LEADMAKER & BENCH MODEL G | AIR FEED |  |  |
|----|---------------------------|----------|--|--|
| -2 | BENCH MODEL K             | AIR FEED |  |  |

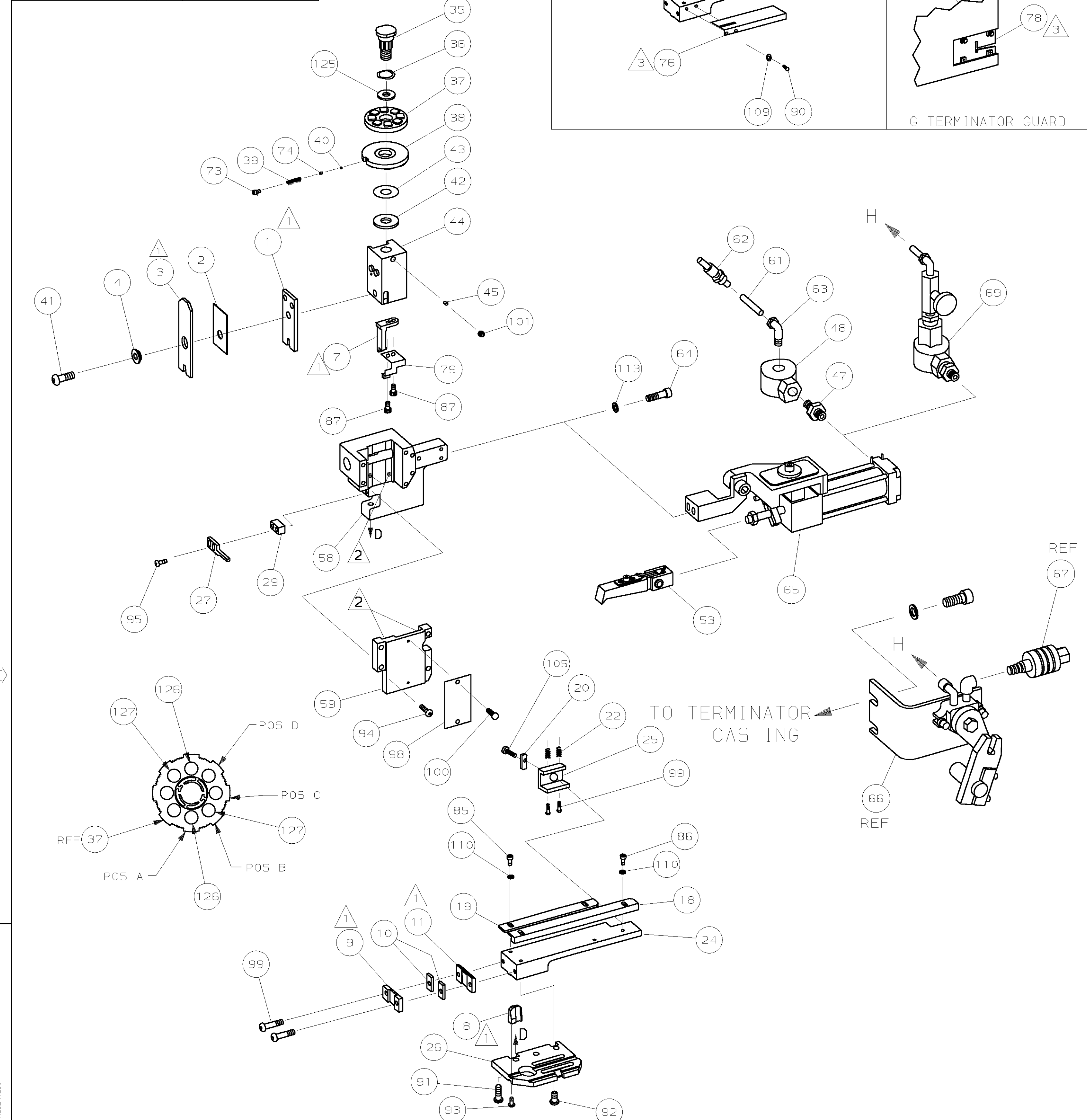

- 1 RECOMMENDED SPARE PARTS.
- 2 GREASE LIGHTLY.
- 3 GUARD MUST BE IN PLACE WHEN OPERATING APPLICATOR IN A BENCH MACHINE.
- 4 SEE DRAWING FOR COMPONENTS
- 5 SET-UP ONLY (2) #24 MAGWIRE
- 6 SET-UP ONLY (1) #25 + (1) #26 MAGWIRE
- 7 SET-UP ONLY (2) #26 MAGWIRE

| QTY | REQD PER ASSY | PART NO | DESCRIPTION | ITEM NO    |                                  |         |
|-----|---------------|---------|-------------|------------|----------------------------------|---------|
| 2   | 2             | -       | C           | 4-354779-4 | PIN, WIRE DISC (.3210)B          | 129     |
| 2   | 2             | -       | C           | 4-354779-0 | PIN, WIRE DISC (.3190)B          | 128     |
| 2   | 2             | -       | C           | 3-354779-6 | PIN, WIRE DISC (.3170)A          | 126     |
| 1   | 1             | -       | A           | 986950-1   | WASHER, FLAT PRECISION           | 125     |
| 1   | 1             | -       | A           | 217238-1   | GENERAL INSTRUCTION PACKAGE      | 124     |
| 1   | 1             | -       | -           | 4088039    | EF APPL INST 408-8039            | 123     |
|     |               |         |             |            |                                  | 122     |
|     |               |         |             |            |                                  | 121     |
|     |               |         |             |            |                                  | 120     |
|     |               |         |             |            |                                  | 119     |
|     |               |         |             |            |                                  | 118     |
|     |               |         |             |            |                                  | 117     |
|     |               |         |             |            |                                  | 116     |
|     |               |         |             |            |                                  | 115     |
|     |               |         |             |            |                                  | 114     |
| 2   | 2             | -       | A           | 21024-5    | WASHER, LOCK (#10) AIR ASSY      | 113     |
|     |               |         |             |            |                                  | 112     |
|     |               |         |             |            |                                  | 111     |
| 5   | 5             | -       | A           | 21024-4    | WASHER, LOCK (NO.6) ST GUIDE     | 110     |
| 2   | 2             | -       | A           | 21055-6    | WASHER, LOCK (NO.8) ST GUIDE     | 109     |
|     |               |         |             |            |                                  | 108     |
|     |               |         |             |            |                                  | 107     |
|     |               |         |             |            |                                  | 106     |
| 1   | 1             | -       | A           | 22353-8    | SCR, SHLD (Ø.187x.25) DRAG LEVER | 105     |
|     |               |         |             |            |                                  | 104     |
|     |               |         |             |            |                                  | 103     |
|     |               |         |             |            |                                  | 102     |
| 1   | 1             | -       | A           | 21009-2    | SCR, SKT SET (1/4-20x.25 )RAM    | 101     |
| 2   | 2             | -       | A           | 21017-2    | SCR, DRIVE (#2x.19) ID PLATE     | 100     |
| 4   | 4             | -       | A           | 3-21002-0  | SCR, BHC (10-32x.88) DRAG        | 99      |
| 1   | 1             | -       | B           | 461264-1   | PLATE, IDENTIFICATION            | 98      |
|     |               |         |             |            |                                  | 97      |
|     |               |         |             |            |                                  | 96      |
| 2   | 2             | -       | A           | 2-21002-2  | SCR, BHC (8-32x.50) STRIPPER     | 95      |
| 4   | 4             | -       | A           | 2-21002-9  | SCR, BHC (10-32x.75) CAP         | 94      |
| 1   | 1             | -       | A           | 22733-8    | SCR, BHC (8-32x.38 LW) ANVIL     | 93      |
| 4   | 4             | -       | A           | 3-21002-3  | SCR, BHC (1/4-20x.50) ST 6D PL   | 92      |
| 3   | 3             | -       | A           | 2-22733-8  | SCR, BHC (1/4-20x.62) H5G        | 91      |
| 1   | 1             | -       | A           | 2-21002-0  | SCR, BHC (6-32x.50) STRIP GUIDE  | 90      |
|     |               |         |             |            |                                  | 89      |
|     |               |         |             |            |                                  | 88      |
| 2   | 2             | -       | A           | 2-21000-7  | SCR, SHC (8-32x.50) SLUG BLADE   | 87      |
| 3   | 3             | -       | A           | 1-21002-7  | SCR, BHC (6-32x.50) STRIP GUIDE  | 86      |
| 2   | 2             | -       | A           | 1-21000-6  | SCR, SHC (8-32x.25)              | 85      |
|     |               |         |             |            |                                  | 84      |
|     |               |         |             |            |                                  | 83      |
|     |               |         |             |            |                                  | 82      |
|     |               |         |             |            |                                  | 81      |
|     |               |         |             |            |                                  | 80      |
| 1   | 1             | -       | A3          | 1320560-1  | DEPRESSOR, TERMINAL              | 79      |
| -   | REF           | -       | A           | 679532-1   | INSERT, GUARD                    | 78      |
| REF | -             | -       | A           | 455745-1   | GUARD, WINDOW                    | 77      |
| 1   | 1             | -       | A3          | 662434-1   | GUARD, TERMINAL                  | 76      |
|     |               |         |             |            |                                  | 75      |
| 1   | 1             | -       | A           | 690603-1   | SPRING, ASSIST                   | 74      |
| 1   | 1             | -       | A           | 23030-1    | SCR, SKT CAP (6-32x.25) CP DSC   | 73      |
|     |               |         |             |            |                                  | 72      |
|     |               |         |             |            |                                  | 71      |
|     |               |         |             |            |                                  | 70      |
| -2  | -1            | U/M     | DWG SIZE    | PART NO    | DESCRIPTION                      | ITEM NO |
|     |               |         |             |            |                                  |         |

| QTY | REQD PER ASSY | PART NO | DESCRIPTION | ITEM NO    |                             |    |
|-----|---------------|---------|-------------|------------|-----------------------------|----|
|     |               |         |             | 60         |                             |    |
| 1   | 1             | -       | C           | 454220-1   | CAP, RAM                    | 59 |
| 1   | 1             | -       | D           | 453736-1   | HOUSING                     | 58 |
|     |               |         |             |            |                             | 57 |
|     |               |         |             |            |                             | 56 |
|     |               |         |             |            |                             | 55 |
|     |               |         |             |            |                             | 54 |
| 1   | 1             | -       | B           | 2-460680-0 | FEED FINGER ASSY            | 53 |
|     |               |         |             |            |                             | 52 |
|     |               |         |             |            |                             | 51 |
|     |               |         |             |            |                             | 50 |
|     |               |         |             |            |                             | 49 |
| 1   | 1             | -       | A           | 22374-7    | VALVE, QUICK EXHAUST        | 48 |
| 1   | 1             | -       | A           | 22304-1    | NIPPLE, HEX 1/8 NPT         | 47 |
|     |               |         |             |            |                             | 46 |
| 1   | 1             | -       | A           | 690191-1   | PLUG, NYLON                 | 45 |
| 1   | 1             | -       | C           | 679275-1   | RAM                         | 44 |
| 1   | 1             | -       | A           | 690125-1   | WASHER, LAMINATED           | 43 |
| 1   | 1             | -       | A           | 690124-1   | WASHER, RAM                 | 42 |
| 1   | 1             | -       | A           | 7-21002-7  | BOLT, CRIMPER (5/16-24x.75) | 41 |
| 1   | 1             | -       | A           | 23241-6    | BALL, STEEL                 | 40 |
| 1   | 1             | -       | A           | 690170-1   | SPRING, COMPRESSION         | 39 |
| 1   | 1             | -       | C           | 690142-5   | DISC, INSULATION            | 38 |
| 1   | 1             | -       | D           | 354777-1   | WIRE DISC, PLASTIC          | 37 |
| 1   | 1             | -       | A           | 22480-5    | WASHER, SPRING              | 36 |
| 1   | 1             | -       | B           | 690212-1   | POST, RAM                   | 35 |
|     |               |         |             |            |                             | 34 |
|     |               |         |             |            |                             | 33 |
|     |               |         |             |            |                             | 32 |
|     |               |         |             |            |                             | 31 |
|     |               |         |             |            |                             | 30 |
| 1   | 1             | -       | B           | 2-690451-4 | SPACER, STRIPPER            | 29 |
|     |               |         |             |            |                             | 28 |
| 1   | 1             | -       | A           | 240639-4   | STRIPPER                    | 27 |
| 1   | 1             | -       | A3          | 662489-1   | BASE PLATE, MODIFIED        | 26 |
| 1   | 1             | -       | A           | 240792-7   | DRAG, TERMINAL              | 25 |
| 1   | 1             | -       | B           | 662383-1   | PLATE, STRIP GUIDE          | 24 |
|     |               |         |             |            |                             | 23 |
| 2   | 2             | -       | A           | 1-22284-0  | SPRING, DRAG                | 22 |
|     |               |         |             |            |                             | 21 |
| 1   | 1             | -       | A           | 240793-1   | LEVER, DRAG RELEASE         | 20 |
| 1   | 1             | -       | C           | 662388-1   | GUIDE, STRIP (REAR)         | 19 |
| 1   | 1             | -       | B           | 662387-1   | GUIDE, STRIP (FRONT)        | 18 |
|     |               |         |             |            |                             | 17 |
|     |               |         |             |            |                             | 16 |
|     |               |         |             |            |                             | 15 |
|     |               |         |             |            |                             | 14 |
|     |               |         |             |            |                             | 13 |
|     |               |         |             |            |                             | 12 |
| 1   | 1             | -       | B           | 240644-5   | PLATE, REAR SHEAR           | 11 |
| 2   | 2             | -       | C           | 1-240645-6 | SPACER, SHEAR PLATE         | 10 |
| 1   | 1             | -       | B           | 318704-1   | PLATE, FRONT SHEAR          | 9  |
| 1   | 1             | -       | D           | 2-456537-4 | ANVIL                       | 8  |
| 1   | 1             | -       | B           | 679272-4   | BLADE, SLUG                 | 7  |
|     |               |         |             |            |                             | 6  |
|     |               |         |             |            |                             | 5  |
| 1   | 1             | -       | B           | 238009-8   | SPACER, BLOCK CRIMPER       | 4  |
| 1   | 1             | -       | C           | 5-456135-1 | CRIMPER, INSULATION         | 3  |
| 1   | 1             | -       | B           | 2-455888-7 | SPACER, CRIMPER             | 2  |
| 1   | 1             | -       | C           | 318702-4   | CRIMPER, WIRE               | 1  |

| QTY | REQD PER ASSY | PART NO | DESCRIPTION | ITEM NO |             |         |
|-----|---------------|---------|-------------|---------|-------------|---------|
| -2  | -1            | U/M     | DWG SIZE    | PART NO | DESCRIPTION | ITEM NO |
|     |               |         |             |         |             |         |

REVISION OF EACH ASSY NO (WHEN BLANK, USE DWG REVISION)

| QTY | REQD PER ASSY | PART NO | DESCRIPTION | ITEM NO |
|-----|---------------|---------|-------------|---------|
|     |               |         |             |         |

DIMENSIONS IN INCHES. DO NOT SCALE PRINT. TOLERANCES UNLESS OTHERWISE SPECIFIED:

|          |          |            |          |
|----------|----------|------------|----------|
| DR       | 10-23-01 | APP        | 10-23-01 |
| B.HIGMAN |          | T.BENCHOFF |          |
| CHK      | 10-23-01 | REL        |          |
| B.HIGMAN |          |            |          |

NAME: END FEED HDM APPLICATOR MACHINE REF: MINI APPL

SCALE: - DWG NO: 1385337 SHEET: 1 OF 1 REV: A

CUSTOMER AND ASSEMBLY DRAWING

THIS DRAWING IS A CONTROLLED DOCUMENT.

THIS DRAWING IS UNRELEASABLE - RELEASED FOR PUBLICATION 23 JUL 1999 BY AMP INCORPORATED. ALL RIGHTS RESERVED.

LOC A  
DIST 66

# Mouser Electronics

Authorized Distributor

Click to View Pricing, Inventory, Delivery & Lifecycle Information:

[TE Connectivity:](#)

[1385337-2](#)