

THIS DRAWING IS UNPUBLISHED. RELEASED FOR PUBLICATION .19
 © COPYRIGHT 19 BY AMP INCORPORATED. ALL RIGHTS RESERVED.

LOC	DIST	REVISIONS					
		P	LTR	DESCRIPTION	DATE	DWN	APVD
HM	00		C	REV; ECO-13-016163	16OCT13	GG	RA

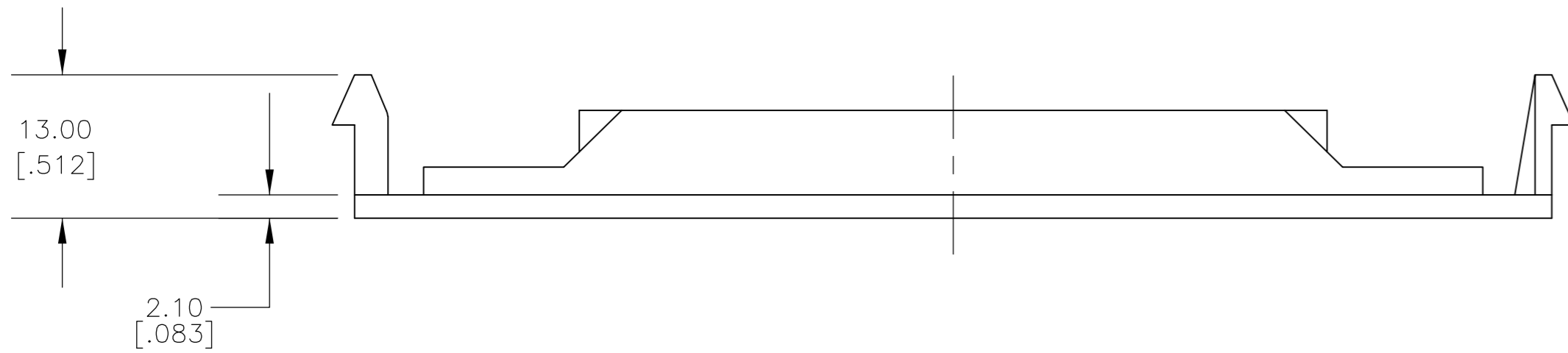

1. WILL MOUNT INTO OPENINGS DESIGNED FOR WIREMOLD 5507 SERIES FACEPLATES.
2. DIMENSIONS ARE SHOWN FOR REFERENCE ONLY.
3. MATERIAL: FACEPLATE - ABS MOLDING COMPOUND, 94V-0 RATED, LIGHT ALMOND.
LABEL COVER - POLYCARBONATE MOLDING COMPOUND, CLEAR.
LABEL - WHITE INDEX PAPER.
4. OPENINGS WILL ACCEPT AMP 110CONNECT, TOOLLESS, MT-RJ JACKS AND 110 CONNECT SL SERIES MULTIMEDIA INSERTS.
5. MOLD OVER SLOTS WILL ACCEPT AMP COLOR CODED ICONS.
6. THIS KIT SHIPPED NOT ASSEMBLED.
7. GRAY COLOR MATCHES WIREMOLD GRAY STEEL RACEWAYS.

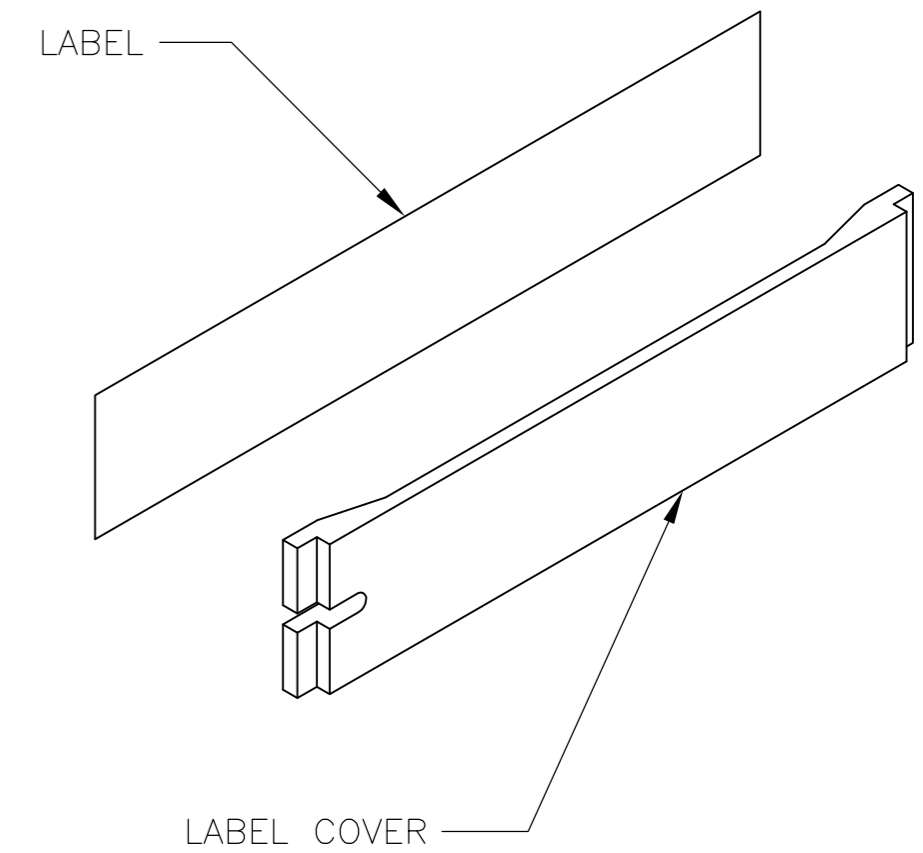
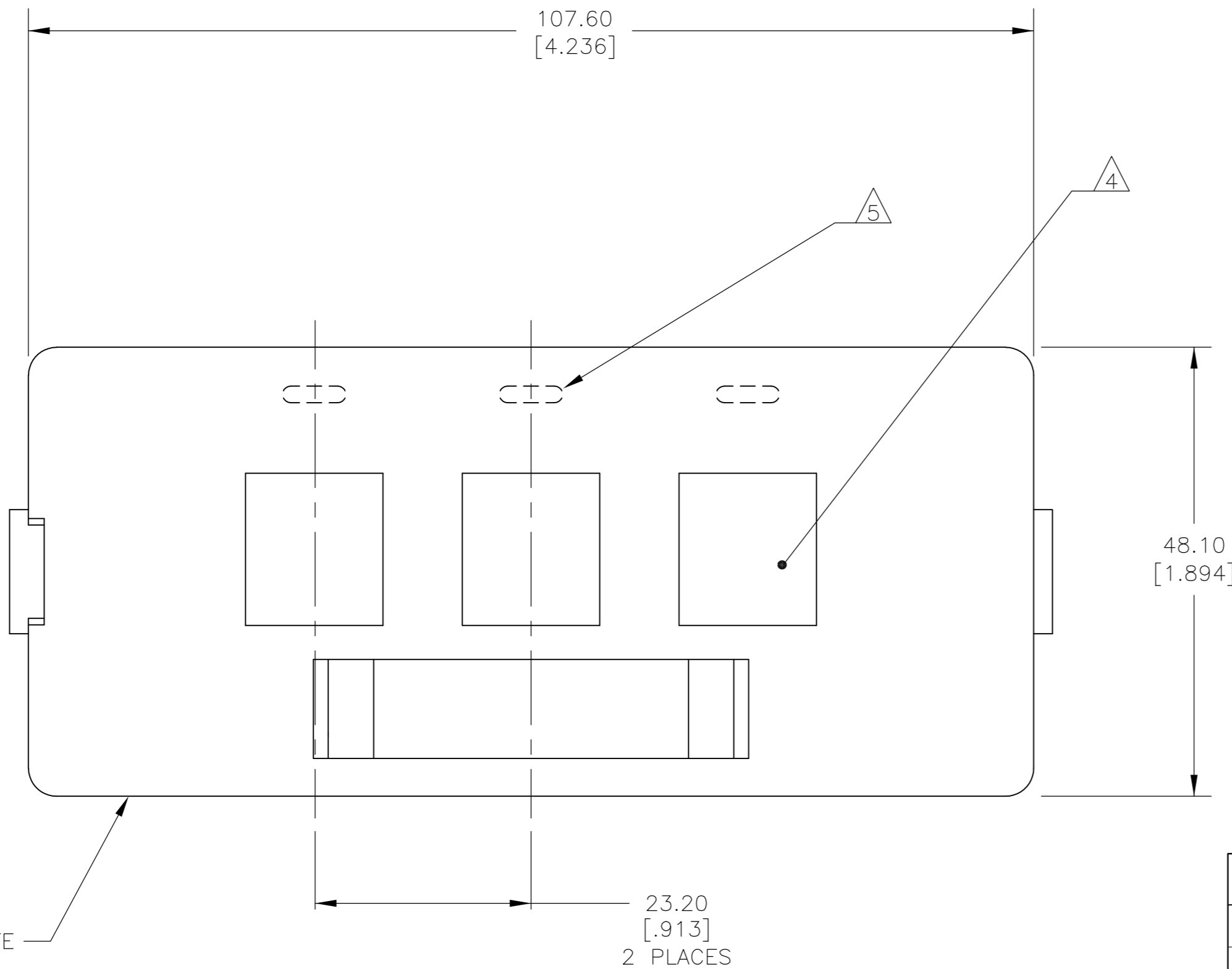

SUPERSEDED BY: 1375049-4	7. GRAY	1375050-4
	LIGHT ALMOND	1375050-1
	COLOR	PART NUMBER

THIS DRAWING IS A CONTROLLED DOCUMENT.		DWN	G. GARRETT	08MAY00	AMP
DIMENSIONS:		CHK	G. BOWMAN	10JAN00	
MM [INCHES]		APVD	G. BOWMAN	10JAN00	
TOLERANCES UNLESS OTHERWISE SPECIFIED:		PRODUCT SPEC		NAME	
0 PLC	± -	APPLICATION SPEC		SIZE	KIT, FACEPLATE, 3 PORT, SURFACE RACEWAY
1 PLC	± -	WEIGHT		CAGE CODE	
2 PLC	± -	CUSTOMER DRAWING		DRAWING NO	
3 PLC	± -	SCALE		2:1	RESTRICTED TO
4 PLC	± -	SHEET		1 OF 1	
ANGLES	± -	REV		C	
FINISH	-	SCALE		2:1	
		SHEET		1 OF 1	
		REV		C	

FACEPLATE

23.20 [.913]
2 PLACES

1375050

Mouser Electronics

Authorized Distributor

Click to View Pricing, Inventory, Delivery & Lifecycle Information:

[TE Connectivity Divested:](#)

[1375050-1](#)