

REVISIONS					
REV	DATE	DESCRIPTION	BY	CHK	APPV
A6	REVISED	ECR-23-185274			AG RK

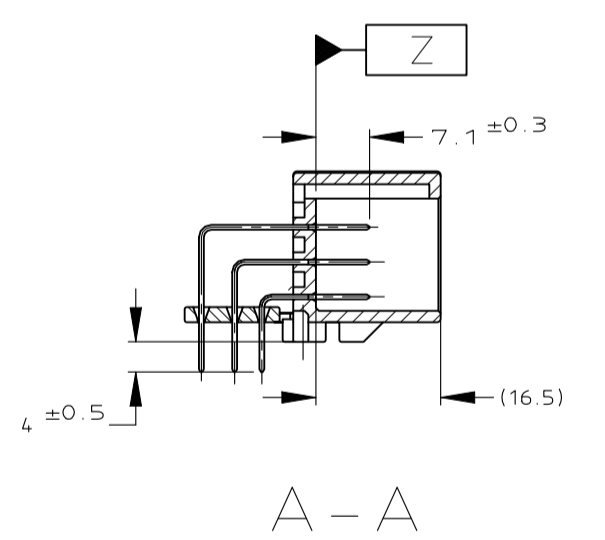

- △ Z面より7.5mmの位置で測定
- △ パワー回路(24番): FIG 1 参照
- △ 回路番号: FIG 1 参照
- 4. 接合相手ハウジング型番  
17P: 353027  
22P: 353028  
24P: 353029  
28P: 353030  
31P: 353031
- 5. 推奨取付ねじ: JIS B 1115、B1122タイプ  
ねじ、なべ2種、呼び径3、長さ6以下
- 6. ねじ締付トルク: 0.392N・m MAX
- △ タイン プレートの色は、自然色
- △ 外箱/内装ボーム種別
- △ コンタクト位上装印用マーク: 表参照

- △ MEASURED AT THE SECTION 7.5mm FROM Z
- △ POWER CIRCUITS (24) : SEE FIG 1
- △ CIRCUIT NUMBERS : SEE FIG 1
- 4. PART NO OF PLUG HOUSINGS TO BE MATED  
17P: 353027  
22P: 353028  
24P: 353029  
28P: 353030  
31P: 353031
- 5. RECOMMENDED SCREW: PAN-HEADED, TYPE 2 TAPPING SCREW OF 3DIA X 6LEN(MAX) (JIS B1115, B1122)
- 6. FASTENING TORQUE FOR SCREW: 0.392N・m MAX.
- △ TINE PLATE COLOR : NATURAL
- △ OUTER PACKING CARTON BOX
- △ MARKING FOR DISCERNMENT OF THE CONTACTS FINISH. SEE TABLE

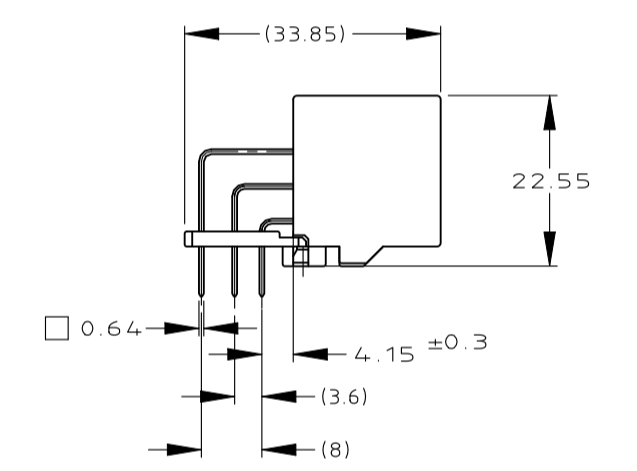
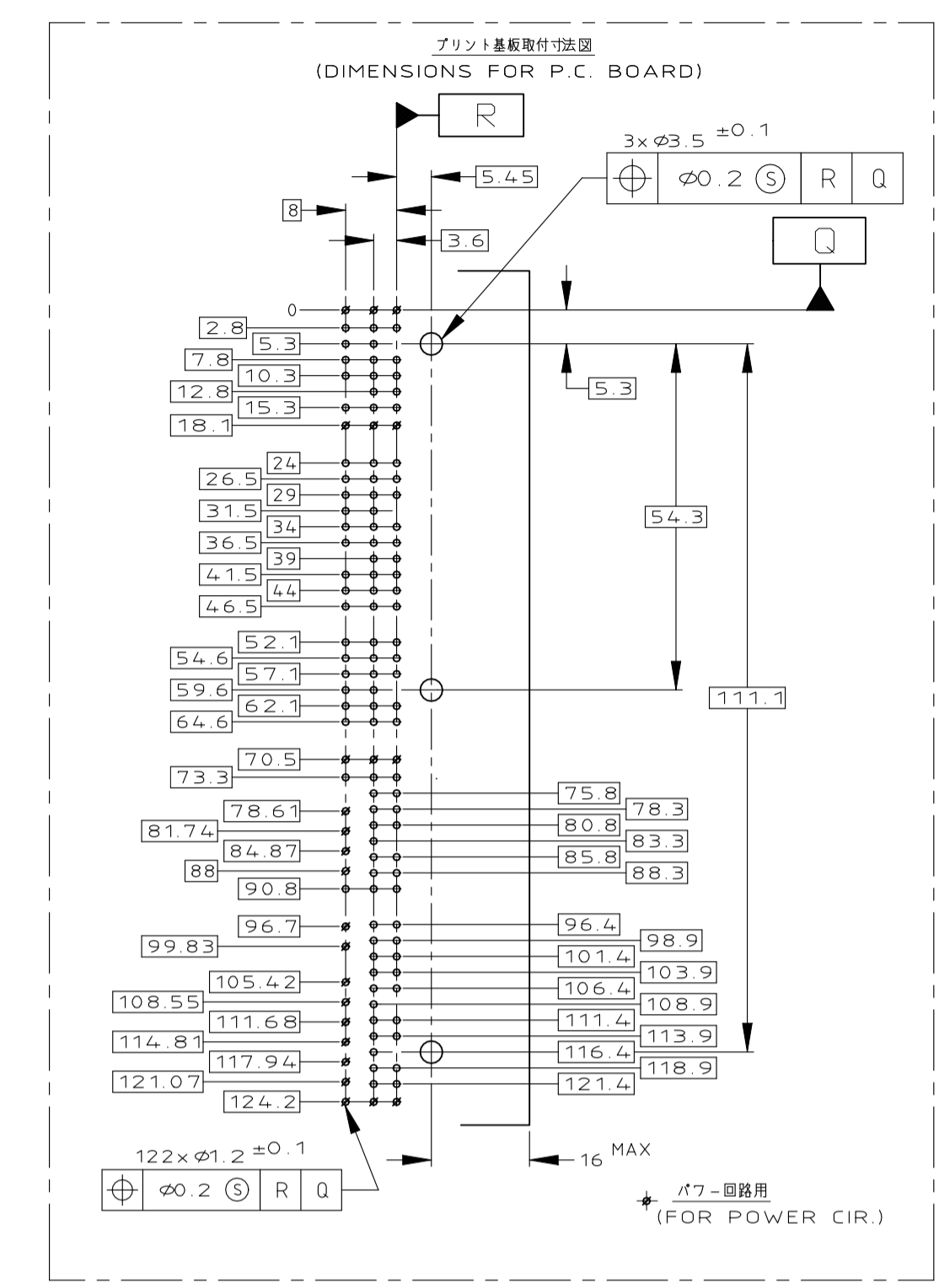
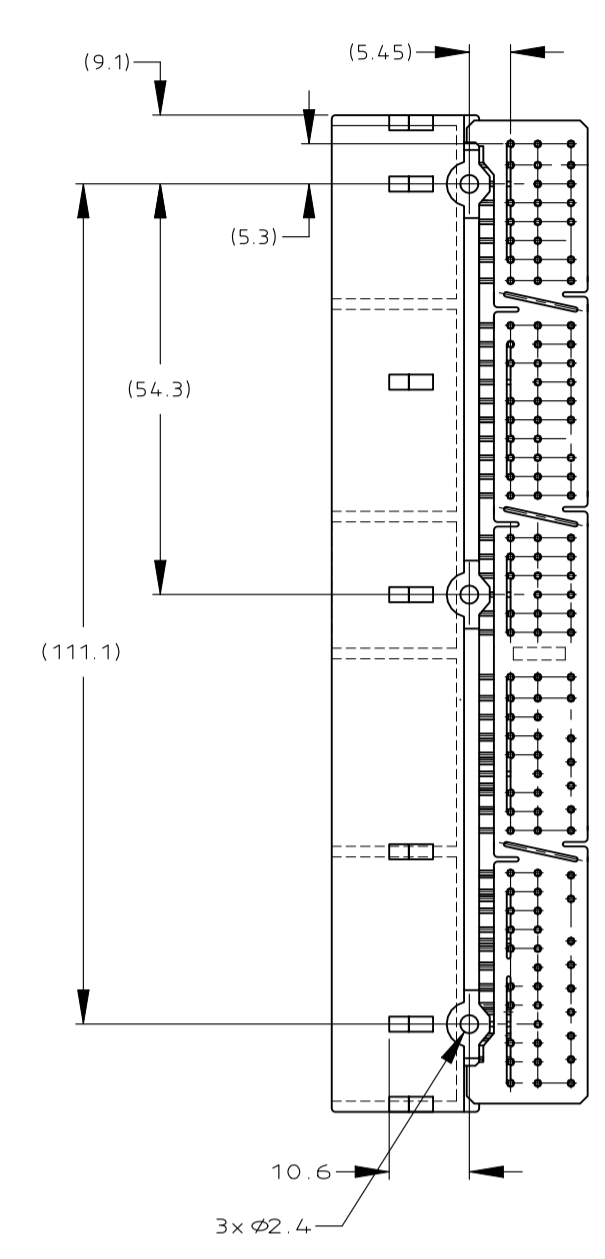
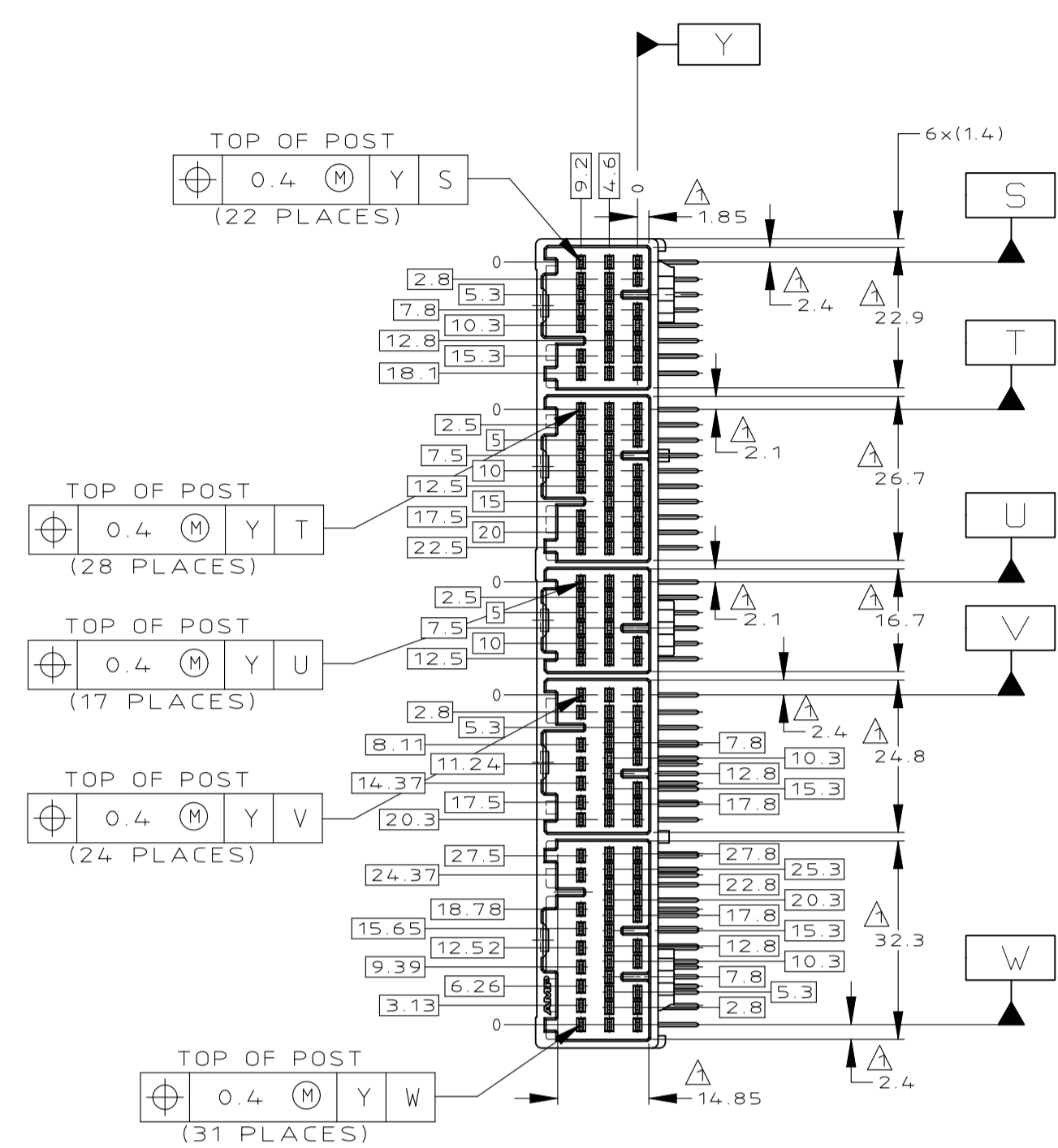
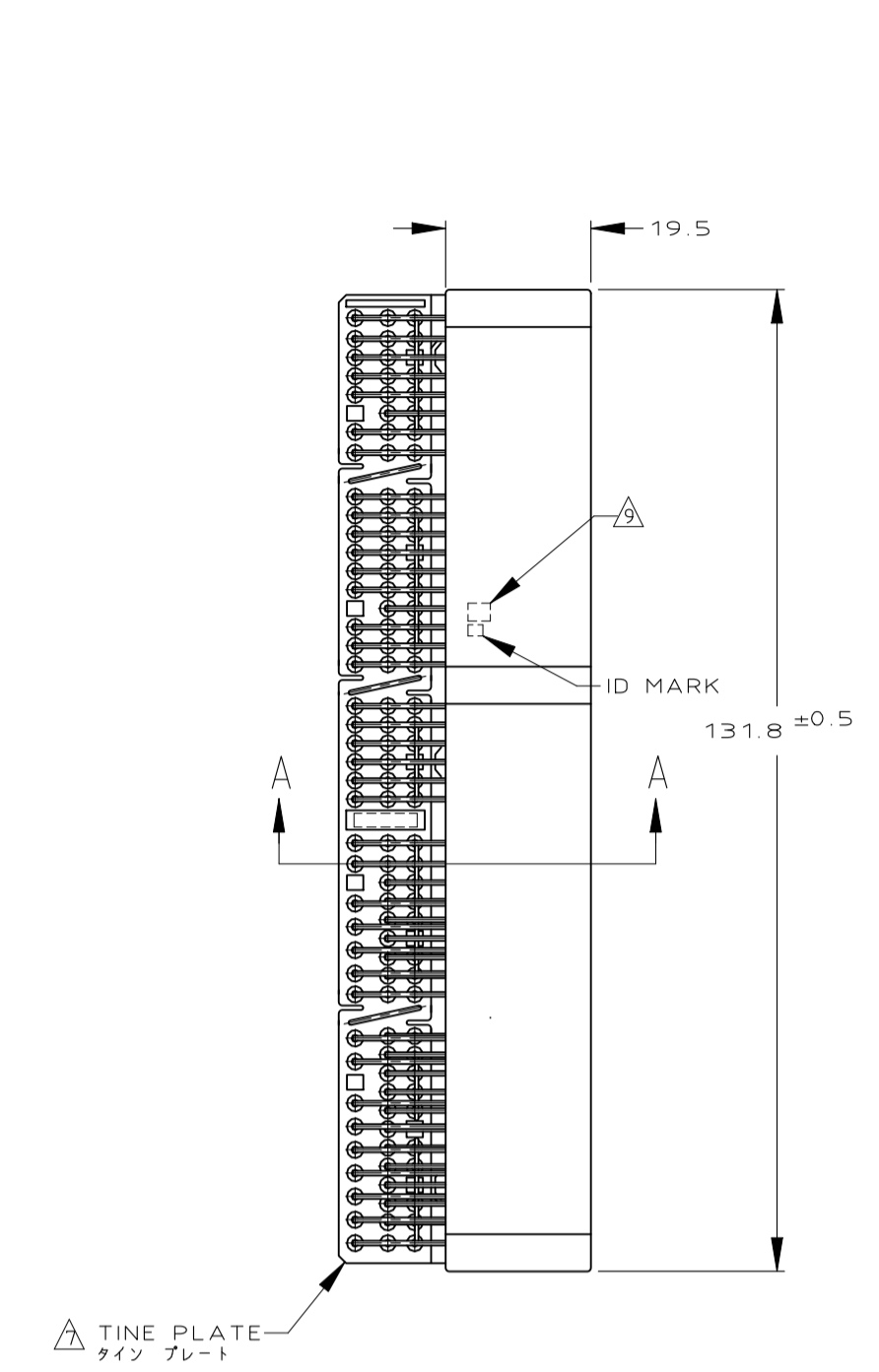
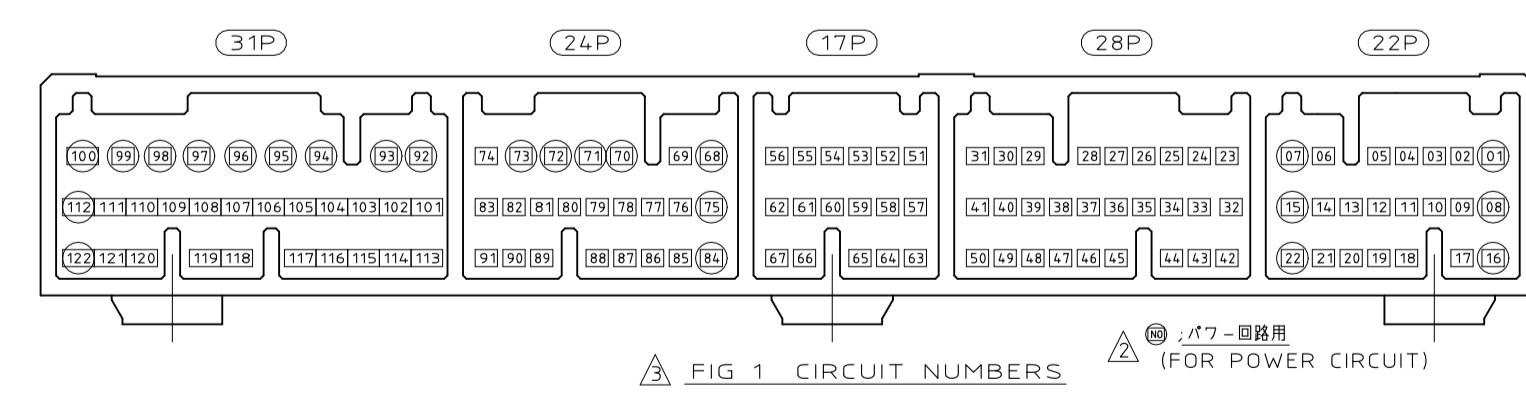

PLASTIC BOX 通い箱	PLASTIC TUBE プラスチックチューブ	55	SELECTIVE TIN (MATTE) PRE-TIN x 117	SELECTIVE GOLD x 5	63-67	NATURAL	6318429-3
PLASTIC BOX 通い箱	PLASTIC TUBE プラスチックチューブ	53	SELECTIVE TIN (MATTE) PRE-TIN x 95	SELECTIVE GOLD x 27	30,32,36,40,41,43-45,47,49,50,101-109,113-119	NATURAL	3-6318429-1
PLASTIC BOX 通い箱	PLASTIC TUBE プラスチックチューブ	91	SELECTIVE TIN (MATTE)	SELECTIVE GOLD x 17 SELECTIVE TIN (BRIGHT) x 105	4,5,11,14,17,20,32,37,42,47,48,57,107,113,114,117,119	NATURAL	6318429-6
OBSELETE PAPER BOX ダンボール箱	PLASTIC TUBE プラスチックチューブ	1	PRE-TIN x 122		//	NATURAL	1318429-7
PLASTIC BOX 通い箱	PLASTIC TUBE プラスチックチューブ	71	SELECTIVE TIN (MATTE)	SELECTIVE GOLD x 8 SELECTIVE TIN (BRIGHT) x 114	30-31,40-41,52-53,58-59	NATURAL	1318429-5
PLASTIC BOX 通い箱	PLASTIC TUBE プラスチックチューブ	61	SELECTIVE TIN (MATTE)	SELECTIVE GOLD x 24 SELECTIVE TIN (BRIGHT) x 98	23,24,26,29-33,39-41,45,48	NATURAL	1318429-4
OBSELETE PLASTIC BOX 通い箱	PLASTIC TUBE プラスチックチューブ	3	TIN-LEAD PRE-TIN x 95	SELECTIVE GOLD x 27	30,32,36,40,41,43-45,47,49,50,101-109,113-119	NATURAL	3-1318429-1
PLASTIC BOX 通い箱	PLASTIC TUBE プラスチックチューブ	5	TIN-LEAD PRE-TIN x 117	SELECTIVE GOLD x 5	63-67	NATURAL	1318429-3
PLASTIC BOX 通い箱	PLASTIC TUBE プラスチックチューブ	41	SELECTIVE TIN (MATTE)	SELECTIVE GOLD x 15 SELECTIVE TIN (BRIGHT) x 107	23,24,26,29-33,39,40,41,57,63,110,120	NATURAL	1318429-2
PLASTIC BOX 通い箱	PLASTIC TUBE プラスチックチューブ	1	PRE-TIN x 122		//	NATURAL	1318429-1
OUTER 外装	INNER 内装	マーキング MARKING	半田付け部 SOLDERING SIDE	接触部側 CONTACT SIDE	金めっき回路NO. AU CIRCUIT NO.	色 (COLOR)	番 (P/N)
梱包形態 PACKING STYLE			コンタクト位上装印用マーク MARKING FOR DISCERNMENT OF THE CONTACTS FINISH				

THIS DRAWING IS A CONTROLLED DOCUMENT.

DIN: K. EURUYAMA 17APR01  
CHK: N.SAI 17APR01  
NAME: N.SAI 17APR01

040 III HIGH DENSITY CONNECTOR  
122POSITION CAP HOUSING ASSEMBLY

00779 1318429

WEIGHT: 40.91 g

CUSTOMER DRAWING

SCALE: 1:1

SHEET: 1 of 1

REV: A6

# Mouser Electronics

Authorized Distributor

Click to View Pricing, Inventory, Delivery & Lifecycle Information:

[TE Connectivity:](#)

[1318429-1](#)