

REVISIONS					
P	LTR	DESCRIPTION	DATE	DWN	APVD
	A	GTP PER ECN-24-292365	07NOV2024	ED	WH

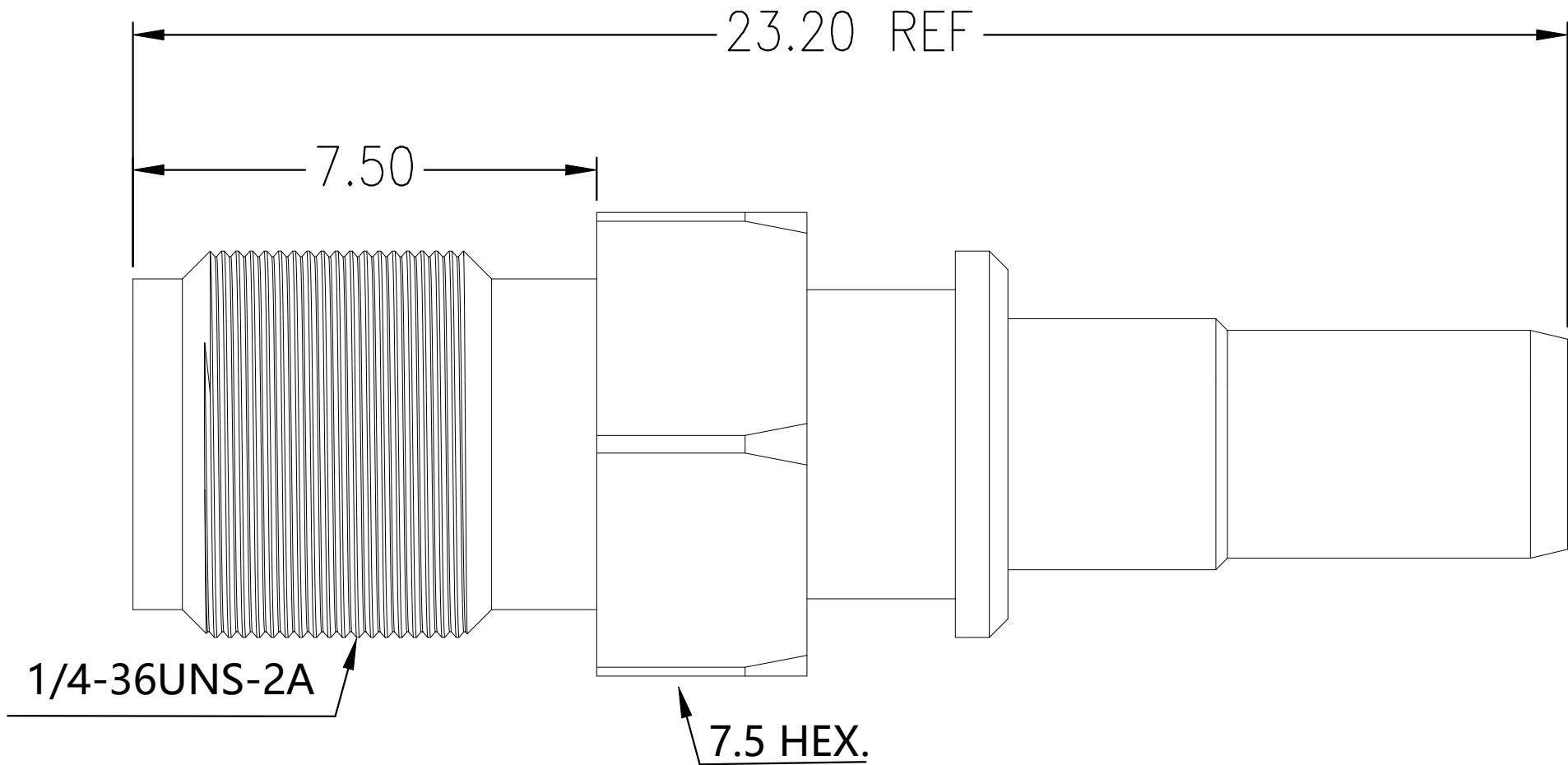
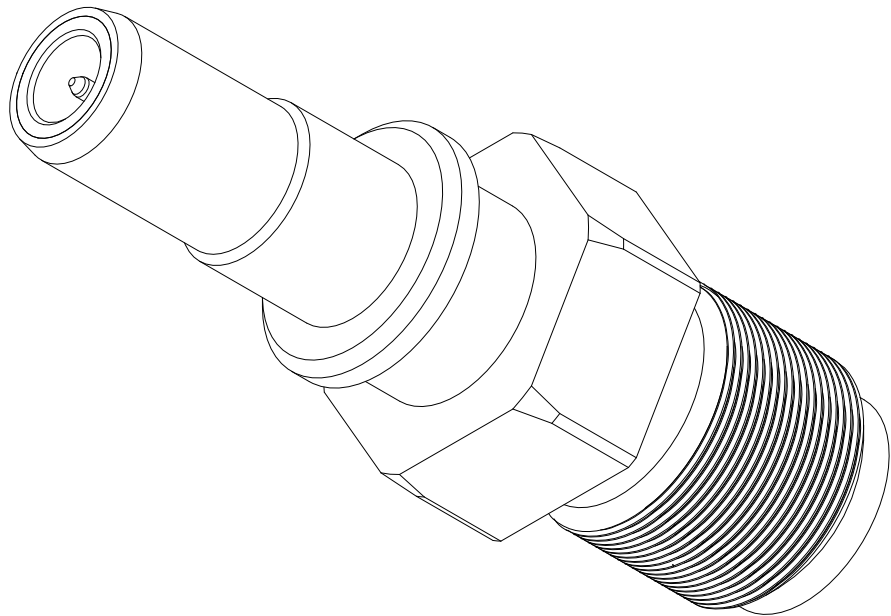

NOTES:

- 1 PACK IN ACCORDANCE WITH TE SPEC 107-3275;
- 2 ALL DIMENSIONS ARE NOMINAL FOR REFERENCE ONLY UNLESS OTHERWISE STATED;
- 3 ELECTRICAL CHARACTERISTICS :  
FREQUENCY RANGE : DC-10GHz  
NOMINAL IMPEDANCE : 50 OHMS  
INSULATION RESISTANCE : 1000 MOHMS  
WORKING VOLTAGE : 250 VRMS MAX  
DIELECTRIC WITHSTANDING VOLTAGE : 800 VOLTS MAX  
VSWR : 1.15(DC-6GHz)  
CONTACT RESISTANCE :  
    CENTER CONTACT : 10 mOHMS MAX  
    OUTER CONTACT : 7.5 mOHMS MAX;
- 4 MECHANICAL CHARACTERISTICS :  
DURABILITY : 500 CYCLES  
MATING FORCE : 25N MAX;  
DISENGAGEMENT FORCE : 2N MIN;  
CONNECTOR DISENGAGEMENT FORCE WITH LOCK : 110N MIN;  
UNMATING FORCE WITH DISENGAGED : 75N MAX;
- 5 TEMPERATURE RANGE: -40°-+105°;
- 6 RoHS: COMPLIANT.

	1	GOLD 3u"/NICKEL/COPPER	BeCu	CONTACT PIN	3
	1	NATURAL	PTFE	INSULATOR	2
	1	NICKEL 100u"	BRASS	BODY	1
	2474532-1	PLATING	MATERIAL	DESCRIPTION	ITEM
QUANTITY PER ASSY		PARTS LIST			

THIS DRAWING IS A CONTROLLED DOCUMENT.		DWN ED 16OCT2023	TE Connectivity		
DIMENSIONS: mm		CHK ED 16OCT2023			
	TOLERANCES UNLESS OTHERWISE SPECIFIED:		NAME		
	0 PLC ± -		ADAPTER,SMA F TO FAKRA SMB M, STRAIGHT,NO HOUSING,6GHz		
	1 PLC ± 0.3		-		
	2 PLC ± 0.2		-		
	3 PLC ± 0.1		-		
	4 PLC ± -		-		
MATERIAL		APVD WH 16OCT2023	RESTRICTED TO		
SEE TABLE		PRODUCT SPEC	-		
		APPLICATION SPEC	-		
		WEIGHT	-		
		FINISH	-		
		CUSTOMER DRAWING	-		
		SCALE	8:1	SHEET	1 OF 1
		REV	A		

# Mouser Electronics

Authorized Distributor

Click to View Pricing, Inventory, Delivery & Lifecycle Information:

[TE Connectivity:](#)

[2474532-1](#)