

REVISIONS					
P	LTR	DESCRIPTION	DATE	DWN	APVD
	T2	REVISED PER ECR-23-177264	10AUG2023	SA	DM

SPECIFICATIONS:

MATERIAL  
BASE, PPS, UL94V-0, BLACK  
COVER, PPS, UL94V-0, BLACK  
ACTUATOR, PA6T, UL94V-0, WHITE  
FIXED CONTACT/TERMINAL, CU ALLOY-GOLD FLASH OVER NICKEL  
MOVING CONTACT, CU ALLOY, PLATE-GOLD FLASH/NICKEL

ELECTRICAL  
MAX CONTACT RATING SWITCHING, -100mA @5VDC (Ampere max)  
- 25mA@24VDC (Voltage max).  
MIN CONTACT RATING SWITCHING, .1MICROAMP @ 1 MILLIVOLT  
MAX CONTACT NON-SWITCHING, 1AMP @ 5 VDC  
INITIAL CONTACT RESISTANCE, 50 MILLIOHMS MAX.  
CONTACT RESISTANCE (AFTER ENVIRONMENTAL TEST), 100 MILLIOHMS  
CONTACT RESISTANCE (AFTER GAS TEST), 300 MILLIOHMS  
INSULATION RESISTANCE, 100MΩ MIN@ 100VDC BETWEEN THE SAME POLES  
DIELECTRIC STRENGTH, 300V AC FOR 1 MINUTE.  
ELECTRICAL LIFE, 1,000 CYCLES (10mA@5VDC)  
WITHSTAND VOLTAGE, 300VAC FOR 1 MIN BETWEEN THE SAME POLES

MECHANICAL  
OPERATING FORCE, LESS THAN 800 GRAMS  
CONTACT PRESSURE, 2.9N MIN.

ENVIRONMENTAL  
OPERATING TEMPERATURE, -30 TO +85 DEGREES C  
STORAGE TEMPERATURE, -40 to 85 DEGREES C  
CLEANING, AQUEOUS OR SOLVENT  
SOLDER HEAT RESISTANCE, PER 109-201,COND B, SWITCH "OFF".  
SOLDERABILITY PER JIS C 0050 & JIS C 0053

- 1 SWITCHES TO BE RECEIVED IN THE "OFF" POSITION AND PACKAGED IN CLEAR TUBES TO ACCOMMODATE AUTO-INSERTION.
- 2 TOP SURFACE TO BE CLEARLY MARKED AS SHOWN.
- 3 SWITCHES TO BE BLACK WITH WHITE ACTUATORS AND MARKINGS.
- 4 TERMINAL OPTION: OLD T&B P/N ADExxS, SA OR SB  
S= OUTSIDE "L" TERMINALS; SA= INSIDE "L" TERMINALS;  
SB= BUTT TERMINALS.
- 5 ALL MATERIALS AND FINISHES SHALL COMPLY WITH EU DIRECTIVE 2002/95/EC OF 27JAN2003 (ROHS).

- 6 OBSOLETE PARTS: OBSOLETE CIS STREAMLINING PER D.RENAUD/D.SINISI.
- 7 TAPE AND REEL PACKING PER PAGE 3 SPECIFICATIONS.

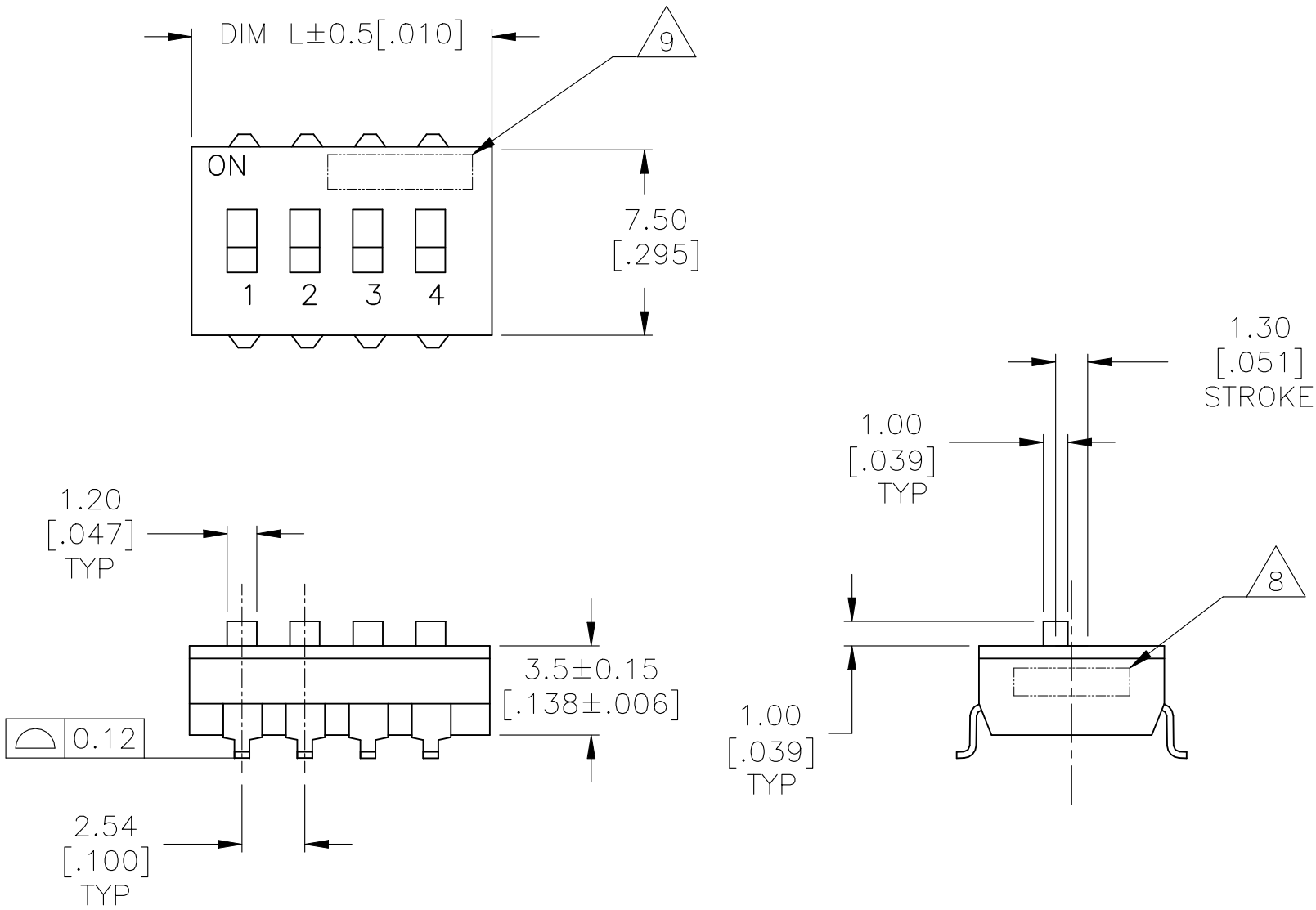

8 MARK ALCO PLUS FIRST 5 DIGITS PER T&B P/N.2 AND 3 POSITION SUPPLIED WITHOUT ALCO

15 5 8 A1  
SPACE INTERNAL CONTROL No. (2-digit)

YEAR OF PRODUCTION WITH 1-DIGIT FIGURE(4TH DIGIT OF CALENDAR YEAR)  
(EXAMPLE: Y2018: 8; Y2019: 9)

MONTH OF PRODUCTION WITH 1-DIGIT FIGURE OR ALPHABET  
(EXAMPLE: 1~9, X(10), Y(11), Z(12))

DATE OF PRODUCTION WITH 2-DIGIT FIGURES(01-31)

9 MARK ALCO PLUS FIRST 5 DIGITS PER T&B P/N.2 AND 3 POSITION SUPPLIED WITHOUT ALCO

SEE SHEET 2 FOR PART NUMBER TABLE  
AND MOUNTING OPTIONS

THIS DRAWING IS A CONTROLLED DOCUMENT.		DWN B.S.VISWESWARA 10FEB05	TE Connectivity			
DIMENSIONS: mm [INCHES]	TOLERANCES UNLESS OTHERWISE SPECIFIED:	CHK M.SARVER	NAME			
		APVD M.SARVER				
	0 PLC ± - 1 PLC ± - 2 PLC ± 0.30[.012] 3 PLC ± - 4 PLC ± - ANGLES ± -	PRODUCT SPEC	DIP SWITCH, ADE-SMT SERIES			
		APPLICATION SPEC				
MATERIAL -	FINISH -	WEIGHT	SIZE A2	CAGE CODE -	DRAWING NO C=1825058	RESTRICTED TO -
CUSTOMER DRAWING			SCALE 4:1	SHEET 1 OF 3	REV T2	

REVISIONS					
P	LTR	DESCRIPTION	DATE	DWN	APVD
	-	SEE SHEET 1	-	-	-

D

C

B

A

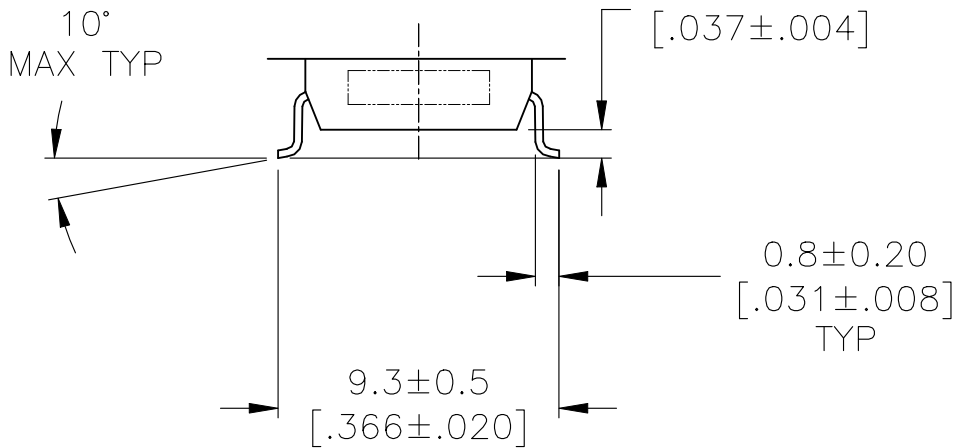
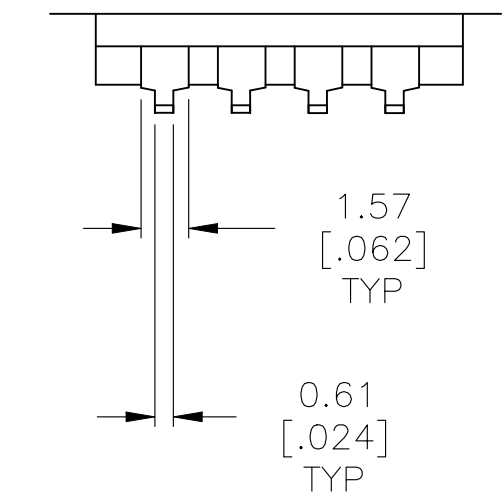

SURFACE MOUNT  
S (OUTSIDE "L")

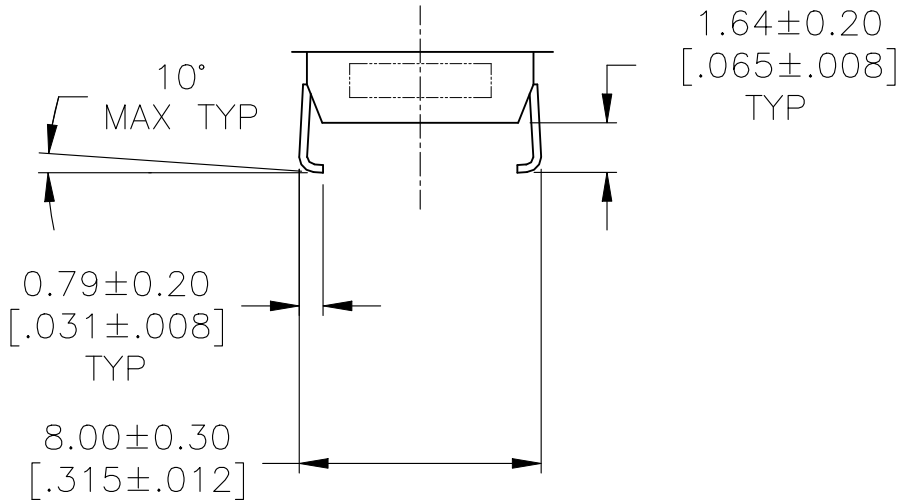
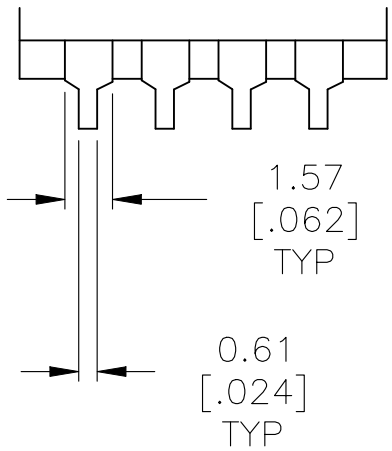

SURFACE MOUNT  
SA (INSIDE "L")

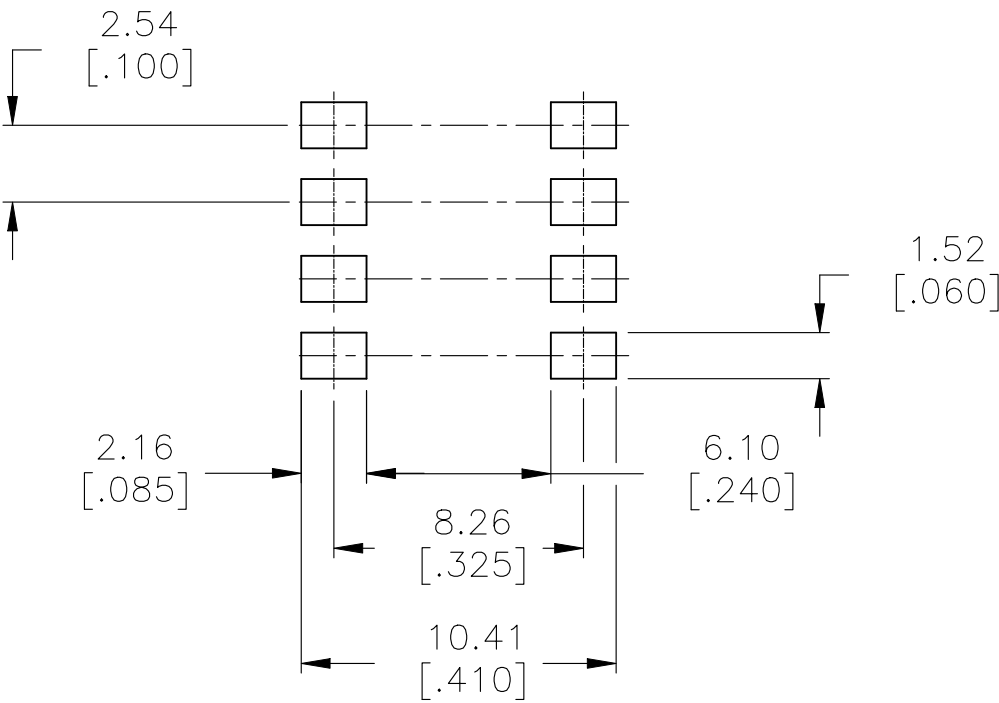

RECOMMENDED PAD LAYOUT

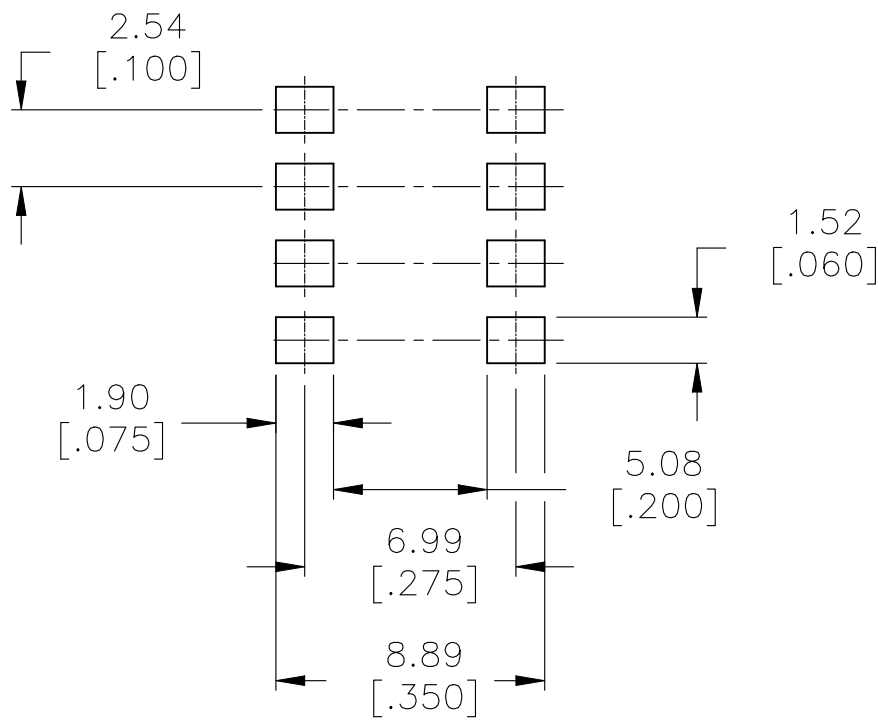

RECOMMENDED PAD LAYOUT

	ADE12STR04	32.51[1.280]	12	4-1825058-1
	ADE10STR04	27.30[1.075]	10	4-1825058-0
	ADE09STR04	24.54[.978]	9	3-1825058-9
	ADE08STR04	22.30[.878]	8	3-1825058-8
	ADE07STR04	19.76[.778]	7	3-1825058-7
	ADE06STR04	17.22[.678]	6	3-1825058-6
	ADE05STR04	14.68[.578]	5	3-1825058-5
	ADE04STR04	12.14[.478]	4	3-1825058-4
	ADE03STR04	9.60[.378]	3	3-1825058-3
	ADE02STR04	7.00[.276]	2	3-1825058-2
	ADE04SATR04	12.14[.478]	4	3-1825058-1
<div>7</div>	ADE12SB04	32.51[1.280]	12	3-1825058-0
	ADE12SA04	32.51[1.280]	12	2-1825058-9
	ADE12S04	32.51[1.280]	12	2-1825058-8
<div>OBSOLETE</div>	ADE10SB04	27.30[1.075]	10	2-1825058-7
	ADE10SA04	27.30[1.075]	10	2-1825058-6
	ADE10S04	27.30[1.075]	10	2-1825058-5
<div>OBSOLETE</div>	ADE09SB04	24.54[.978]	9	2-1825058-4
	ADE09SA04	24.54[.978]	9	2-1825058-3
	ADE09S04	24.54[.978]	9	2-1825058-2
<div>OBSOLETE</div>	ADE08SB04	22.30[.878]	8	2-1825058-1
	ADE08SA04	22.30[.878]	8	2-1825058-0
	ADE08S04	22.30[.878]	8	1-1825058-9
	ADE07SB04	19.76[.778]	7	1-1825058-8
	ADE07SA04	19.76[.778]	7	1-1825058-7
	ADE07S04	19.76[.778]	7	1-1825058-6
<div>OBSOLETE</div>	ADE06SB04	17.22[.678]	6	1-1825058-5
	ADE06SA04	17.22[.678]	6	1-1825058-4
	ADE06S04	17.22[.678]	6	1-1825058-3
	ADE05SB04	14.68[.578]	5	1-1825058-2
	ADE05SA04	14.68[.578]	5	1-1825058-1
	ADE05S04	14.68[.578]	5	1-1825058-0
	ADE04SB04	12.14[.478]	4	1825058-9
	ADE04SA04	12.14[.478]	4	1825058-8
	ADE04S04	12.14[.478]	4	1825058-7
<div>6</div>	<div>OBSOLETE</div> ADE03SB04	9.60[.378]	3	1825058-6
	ADE03SA04	9.60[.378]	3	1825058-5
	ADE03S04	9.60[.378]	3	1825058-4
<div>OBSOLETE</div>	ADE02SB04	7.00[.276]	2	1825058-3
	ADE02SA04	7.00[.276]	2	1825058-2
	ADE02S04	7.00[.276]	2	1825058-1
	T&B P/N	DIM L	POSITION	PART NO.

THIS DRAWING IS A CONTROLLED DOCUMENT.		DWN B.S.VISWESWARA 10FEB05	TE Connectivity	
DIMENSIONS: mm [INCHES]		CHK M.SARVER		
		APVD M.SARVER	NAME  DIP SWITCH, ADE-SMT SERIES	
		PRODUCT SPEC		
TOLERANCES UNLESS OTHERWISE SPECIFIED:		APPLICATION SPEC	SIZE A2	CAGE CODE -
MATERIAL -		WEIGHT	DRAWING NO C=1825058	RESTRICTED TO -
FINISH -		CUSTOMER DRAWING	SCALE 4:1	SHEET 2 OF 3
			REV T2	

REVISIONS					
P	LTR	DESCRIPTION	DATE	DWN	APVD
	-	SEE SHEET 1	-	-	-

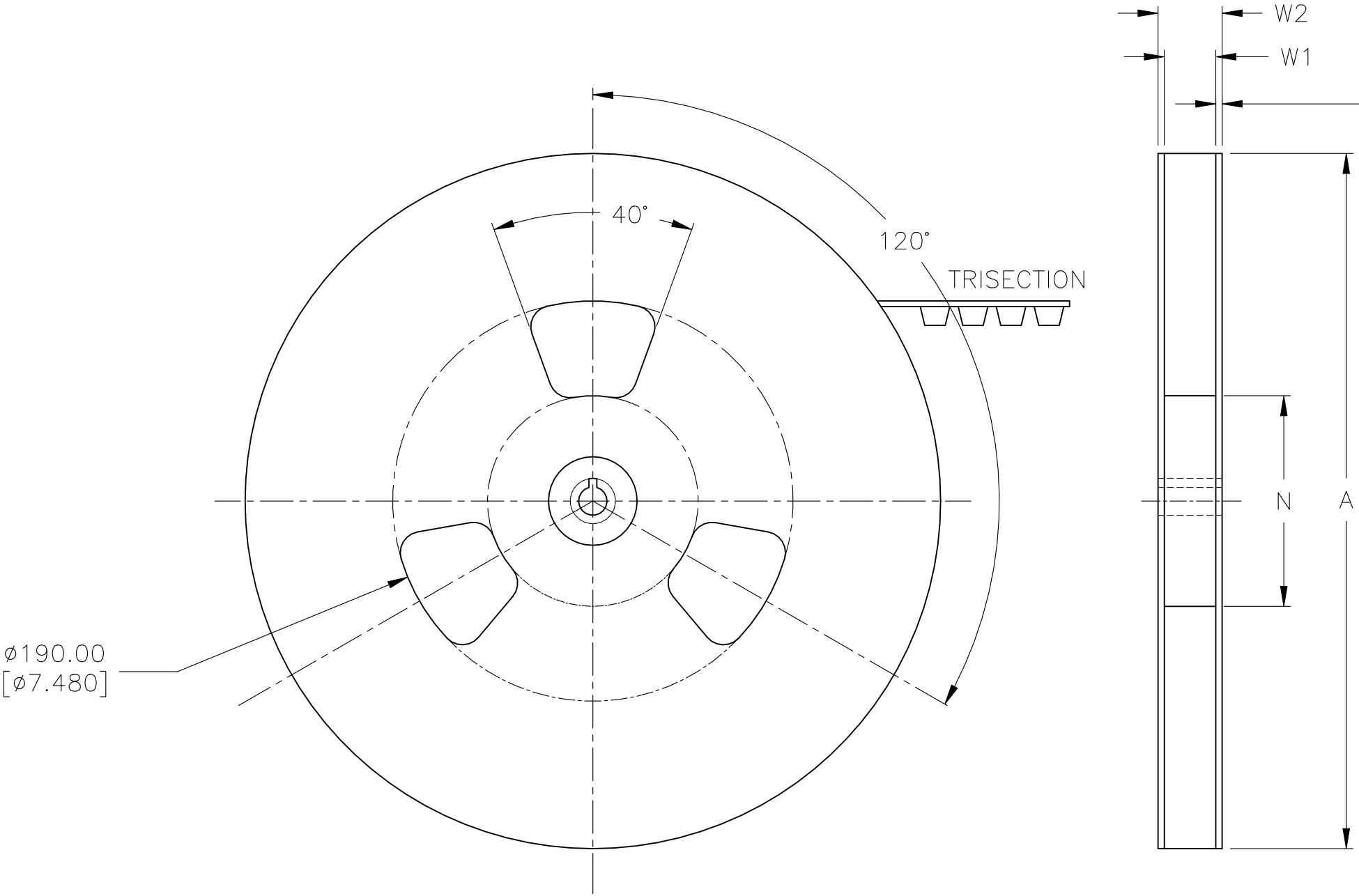
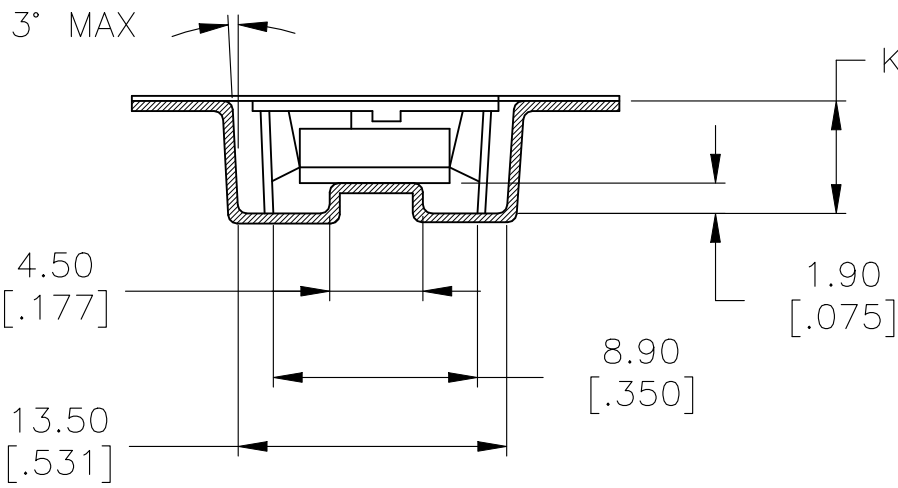
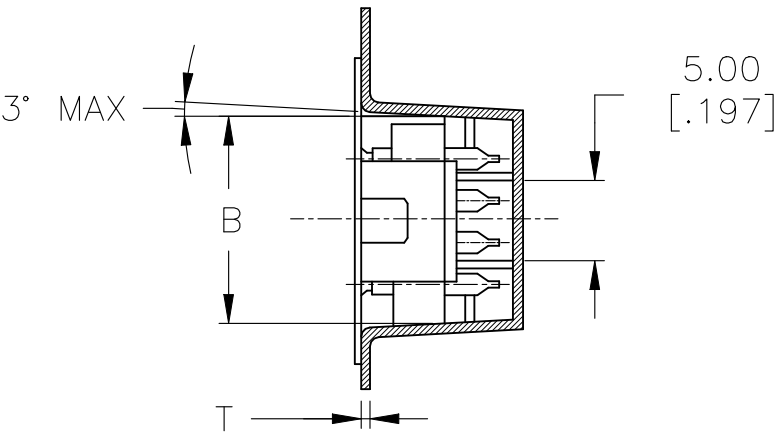
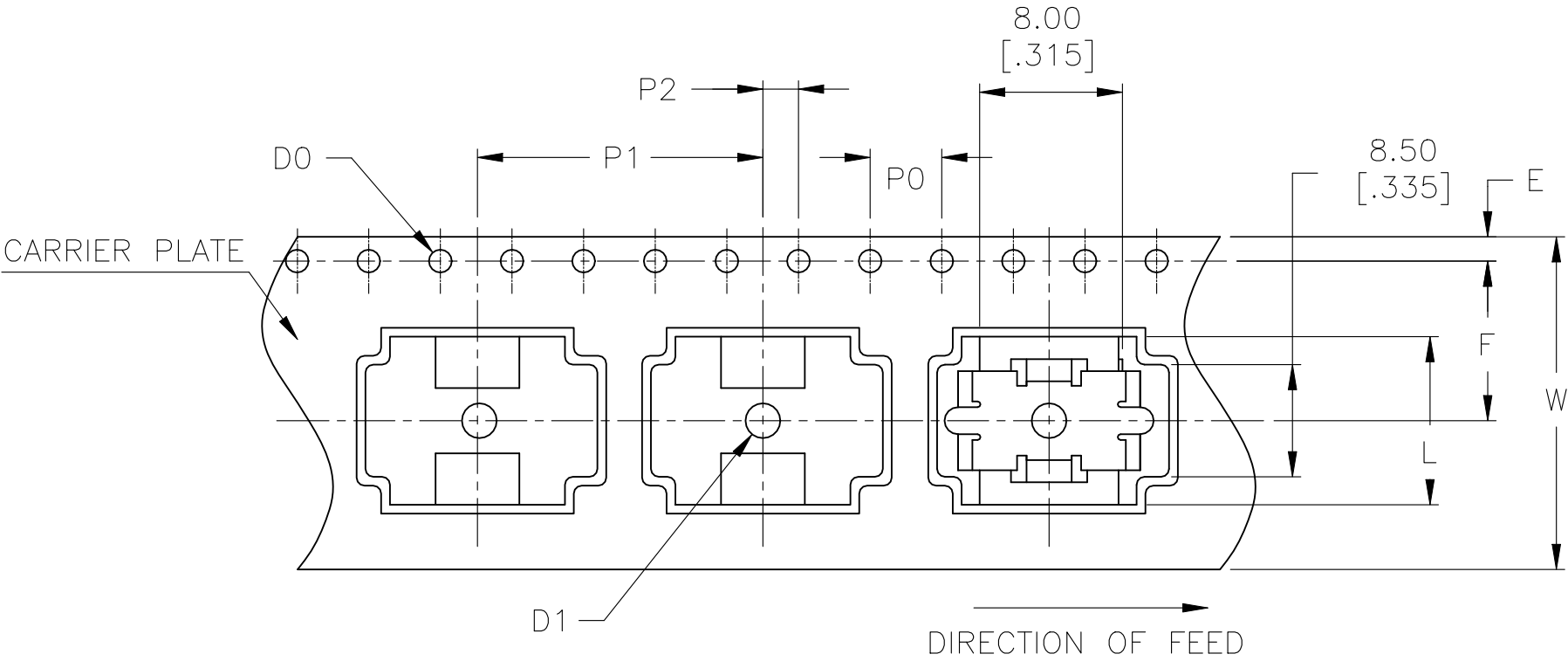

	DESCRIPTION	MATERIAL	DIMENSION	FINISH	REMARKS
1	REEL	SIDE: CARDBOARD CORE: STYLOFOAM	MENTIONED BELOW		
2	EMBOSSED TAPE	-	MENTIONED BELOW	ANTISTATIC	BLACK
3	TOP COVER TAPE	-	MENTIONED BELOW	ANTISTATIC	TRANSPARENT

4P	ø330.00±2.10 [12.992±.082]	ø100 [3.940]	24.40 <sup>+2.00</sup> <sub>0</sub> [.960 <sup>+7.98</sup> <sub>.000</sub> ]	30.40 [1.997]
NO OF POSITION	A	N (MIN)	W1	W2 (MAX)

4P	ø1.50 <sup>+0.10</sup> <sub>0</sub> [ø.059 <sup>+.003</sup> <sub>.000</sub> ]	4.00±0.10 [.157±.003]	16.00±0.10 [.629±.003]	2.00±0.15 [.078±.005]	11.50±0.10 [.453±.003]	7.40±0.10 [.291±.003]
NO OF POSITION	D1	P0	P1	P2	F	K

4P	24.00±0.30 [.944±.011]	12.90±0.10 [.507±.003]	1.75±0.10 [.068±.003]	0.50±0.05 [.020±.001]	12.14±0.50 [.477±.020]	ø1.50 <sup>+0.10</sup> <sub>0</sub> [ø.059 <sup>+.003</sup> <sub>.000</sub> ]
NO OF POSITION	W	B	E	T	L	DO

THIS DRAWING IS A CONTROLLED DOCUMENT.		DWN B.S.VISWESWARA 10FEB05	TE Connectivity			
DIMENSIONS: mm [INCHES]		CHK M.SARVER				
		APVD M.SARVER	NAME DIP SWITCH, ADE-SMT SERIES			
		PRODUCT SPEC				
TOLERANCES UNLESS OTHERWISE SPECIFIED:		APPLICATION SPEC	SIZE A2			
0 PLC ± - 1 PLC ± - 2 PLC ± 0.30[.012] 3 PLC ± - 4 PLC ± - ANGLES ± -		FINISH	CAGE CODE -			
MATERIAL -		WEIGHT	DRAWING NO C=1825058			
		CUSTOMER DRAWING	RESTRICTED TO -			
		SCALE 4:1	SHEET 3 OF 3			
			REV T2			

# Mouser Electronics

Authorized Distributor

Click to View Pricing, Inventory, Delivery & Lifecycle Information:

[TE Connectivity:](#)

[ADE12S04](#)