

THIS DRAWING IS UNPUBLISHED. RELEASED FOR PUBLICATION
 © COPYRIGHT - By - ALL RIGHTS RESERVED.

| LOC | DIST | REVISIONS | | | | | |
|-----|------|-----------|-----|---------------------------|---------|-----|------|
| FT | 0 | P | LTR | DESCRIPTION | DATE | DWN | APVD |
| | | | D2 | REVISED PER ECO-11-004917 | 11MAR11 | RK | HMR |

MATERIAL:
 HOUSING: THERMOPLASTIC, UL94V-0 BLACK.
 TERMINALS: BRIGHT TIN PLATED, COPPER ALLOY.
 SCREWS: #6-32, STEEL, ZINC PLATED WITH CLEAR CHROMATE.

ELECTRICAL:
 CURRENT RATING UL/CSA:
 CLASS C: 25A, 300V.
 CLASS D: 5A, 600V.
 WIRE RANGE: 12-22 AWG

MECHANICAL:
 RECOMMENDED TORQUE: 7 IN-LB.
 OPERATING TEMP.: 105°C MAX.

- 1 SCREWS ARE NICKEL PLATED BRASS.
- 2 SEE FIGURE.
- 3 MARK WITH WHITE PERMANENT INK.
- 4 ALL SCREWS BOTTOMED.
- 5 OBSOLETE PARTS: OBSOLETE CIS STREAMLINING PER D.RENAUD/D.SINISI

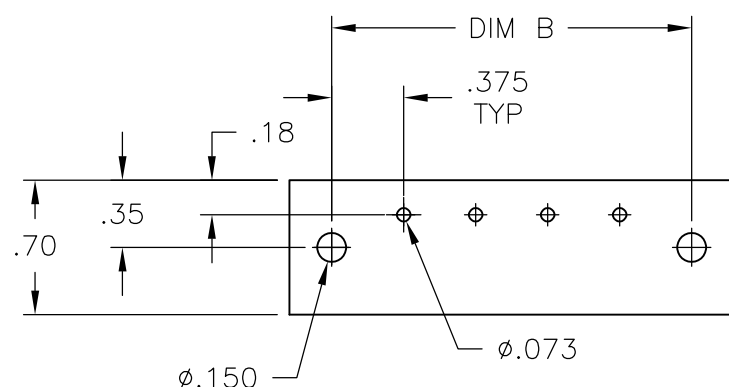
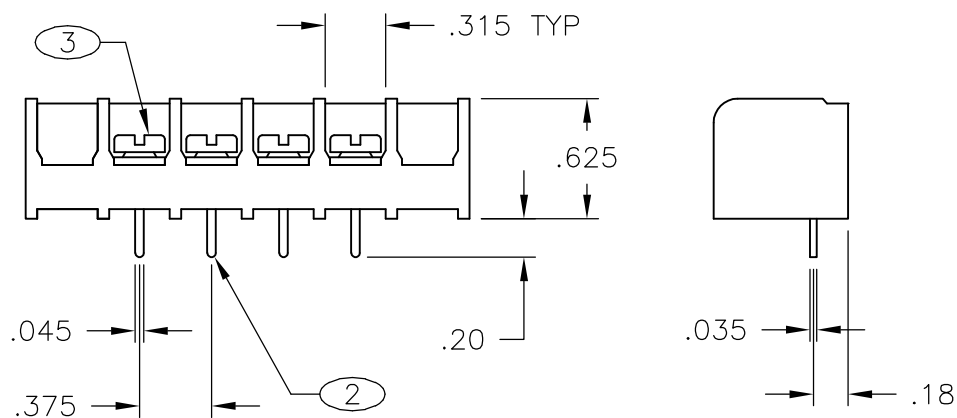
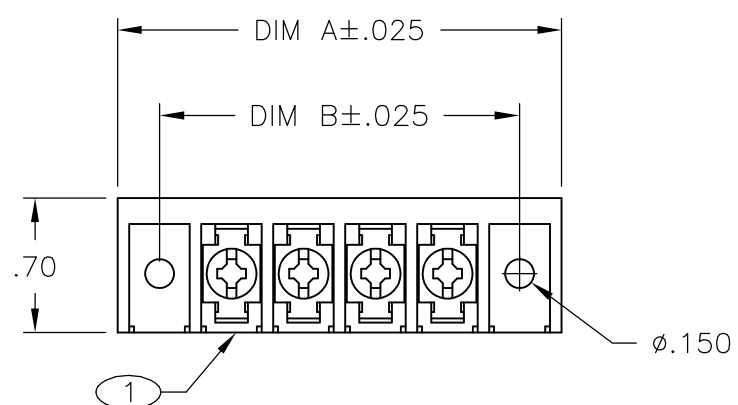

RECOMMENDED PCB LAYOUT

| | | | | |
|--------|--------|------------|----------------|-------------|
| 10.875 | 11.311 | 28 | 6PCV-28-009 | 4-1546686-2 |
| 10.500 | 10.936 | 27 | 6PCV-27-009 | 4-1546686-1 |
| 10.125 | 10.561 | 26 | 6PCV-26-009 | 4-1546686-0 |
| 9.750 | 10.186 | 25 | 6PCV-25-009 | 3-1546686-9 |
| 9.375 | 9.811 | 24 | 6PCV-24-009 | 3-1546686-8 |
| 9.000 | 9.436 | 23 | 6PCV-23-009 | 3-1546686-7 |
| 8.625 | 9.061 | 22 | 6PCV-22-009 | 3-1546686-6 |
| 8.250 | 8.686 | 21 | 6PCV-21-009 | 3-1546686-5 |
| 7.875 | 8.311 | 20 | 6PCV-20-1362 | 7-1546158-9 |
| 7.875 | 8.311 | 20 | 6PCV-20-1361 | 7-1546158-8 |
| 7.875 | 8.311 | 20 | 6PCV-20-009 | 3-1546686-4 |
| 7.500 | 7.936 | 19 | 6PCV-19-009 | 3-1546686-3 |
| 7.125 | 7.561 | 18 | 6PCV-18-009 | 3-1546686-2 |
| 6.750 | 7.186 | 17 | 6PCV-17-009 | 3-1546686-1 |
| 6.375 | 6.811 | 16 | 6PCV-16-009 | 3-1546686-0 |
| 6.000 | 6.436 | 15 | 6PCV-15-009 | 2-1546686-9 |
| 5.625 | 6.061 | 14 | 6PCV-14-009 | 2-1546686-8 |
| 5.250 | 5.686 | 13 | 6PCV-13-009 | 2-1546686-7 |
| 4.875 | 5.311 | 12 | 6PCV-12-009 | 6-1546158-6 |
| 4.500 | 4.936 | 11 | 6PCV-11-009 | 2-1546686-6 |
| 4.125 | 4.561 | 10 | 6PCV-10-009 | 2-1546686-5 |
| 3.750 | 4.186 | 9 | 6PCV-09-009 | 2-1546686-4 |
| 3.375 | 3.811 | 8 | 6PCV-08-1188 | 1-1437653-6 |
| 3.375 | 3.811 | 8 | 6PCV-08-009 | 1-1437653-2 |
| 3.000 | 3.436 | 7 | 6PCV-07-009 | 5-1546158-8 |
| 2.625 | 3.061 | 6 | 6PCV-06-009 | 1-796988-1 |
| 2.250 | 2.686 | 5 | 6PCV-05-009 | 5-1546158-2 |
| 1.875 | 2.311 | 4 | 6PCV-04-009 | 7-1437652-0 |
| 1.500 | 1.936 | 3 | 6PCV-03-009 | 796988-5 |
| 1.125 | 1.561 | 2 | 6PCV-02-009 | 3-1437652-8 |
| DIM B | DIM A | NO OF POS. | CATALOG NUMBER | PART NUMBER |

| | | | | |
|--|--------------|------------------------|----------------------------|---------------|
| THIS DRAWING IS A CONTROLLED DOCUMENT. | | DWN S SCHLEGEL 8/19/03 | STE TE Connectivity | |
| DIMENSIONS: INCHES | | CHK S YODER 8/19/03 | | |
| TOLERANCES UNLESS OTHERWISE SPECIFIED: | | APVD S YODER 8/19/03 | NAME | |
| 0 PLC ± - | 1 PLC ± - | PRODUCT SPEC | 6PCV-XX-009 ASSEMBLY | |
| 2 PLC ± .02 | 3 PLC ± .010 | APPLICATION SPEC | SIZE | CAGE CODE |
| 4 PLC ± - | ANGLES ± 1° | WEIGHT - | A3 | 00779 |
| MATERIAL - | FINISH - | CUSTOMER DRAWING | DRAWING NO | RESTRICTED TO |
| | | | G-796988-5 | - |
| | | | SCALE NTS | SHEET 1 OF 2 |
| | | | REV D2 | |

THIS DRAWING IS UNPUBLISHED.

RELEASED FOR PUBLICATION

-. - .

© COPYRIGHT - By -

ALL RIGHTS RESERVED.

LOC FT DIST 0

REVISIONS

| P | LTR | DESCRIPTION | DATE | DWN | APVD |
|---|-----|-------------|------|-----|------|
| - | - | SEE SHEET 1 | - | - | - |

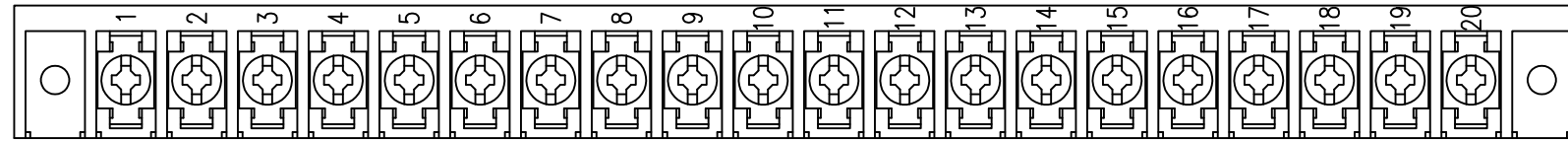

7-1546158-8

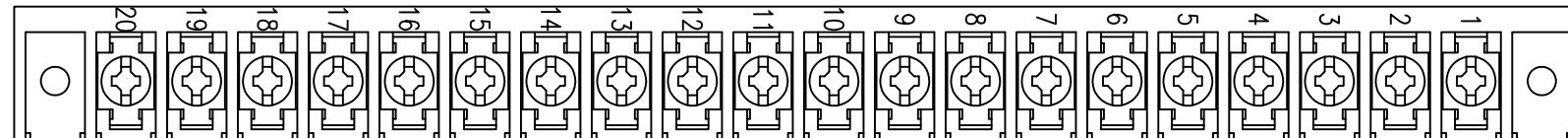

7-1546158-9

THIS DRAWING IS A CONTROLLED DOCUMENT.

DIMENSIONS:
INCHES

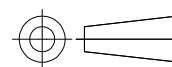

TOLERANCES UNLESS OTHERWISE SPECIFIED:

| | |
|--------|--------|
| 0 PLC | ± - |
| 1 PLC | ± - |
| 2 PLC | ± .02 |
| 3 PLC | ± .010 |
| 4 PLC | ± - |
| ANGLES | ± 1° |

MATERIAL

FINISH

DWN S SCHLEGEL 8/19/03

CHK S YODER 8/19/03

APVD S YODER 8/19/03

PRODUCT SPEC

APPLICATION SPEC

WEIGHT -

CUSTOMER DRAWING



NAME 6PCV-XX-009 ASSEMBLY

| | | | |
|------|-----------|------------|---------------|
| SIZE | CAGE CODE | DRAWING NO | RESTRICTED TO |
| A3 | 00779 | C-796988-5 | - |

| | | |
|-------|--------|-----|
| SCALE | SHEET | REV |
| NTS | 2 OF 2 | D2 |

Mouser Electronics

Authorized Distributor

Click to View Pricing, Inventory, Delivery & Lifecycle Information:

[TE Connectivity:](#)

[2-1546686-7](#)