

PART NUMBER	REV	FIRST USED
567915-1	C	854040-3

TERMINAL NAME: DOUBLE LOCK POWER CONNECTOR		VISIBLE CRIMPING DATA	
WIRE STRIP LENGTH	TERM APPL SPEC	FEED	APPL INSTRUCTION
-	114-5175	.429	NONE
WIRE		SIZE	TYPE
INSUL		RANGE	
A	.051 ±.002 [1.29 ±0.05mm]	1.25mm ²	
B	.045 ±.002 [1.15 ±0.05mm]	0.85mm ²	
C	.041 ±.002 [1.05 ±0.05mm]	0.5mm ²	
D	NOT	USED	
WIRE		SIZE	TYPE
INSUL		RANGE	
WIRE		.080 [2.03mm]	F
INSUL		.130 [3.3mm]	F
WIRE		SIZE	TYPE
INSUL		RANGE	
WIRE		.080 [2.03mm]	F
INSUL		.130 [3.3mm]	F
WIRE		SIZE	TYPE
INSUL		RANGE	
WIRE		.080 [2.03mm]	F
INSUL		.130 [3.3mm]	F

QTY	REV	U/M	DWG SIZE	PART NO	DESCRIPTION	ITEM NO
2	-	C		3-354779-2	PIN, WIRE DISC (.3150)D	129
2	-	C		2-354779-0	PIN, WIRE DISC (.3090)C	128
2	-	C		4-354779-0	PIN, WIRE DISC (.3190)A	126
1	-	A		986950-1	WASHER, FLAT PRECISION	125
1	-	B		690701-2	PLATE, SERIAL NO.	122
1	-	A		4-21028-0	PIN, SLT SPR (Ø.093x.75) ST GDE PL	121
2	-	A		21899-2	WASHER, FLAT (#10) S G ADJ BLK	119
2	-	A		21024-5	WASHER, LOCK (#10) ADJ BLOCK	117
2	-	A		21024-2	WASHER, LOCK (#4) FRONT STP GUIDE	114
REF	-	A		21024-4	WASHER, LOCK (#8) FEED FINGER	113
2	-	A		21024-4	WASHER, LOCK (#8) DEP-HOLD	112
REF	-	A		21024-4	WASHER, LOCK (#8) STRIPPER	111
4	-	A		21017-2	SCR, DRIVE (#2x.19) ID PLATE	101
1	-	B		819347-1	PLATE, IDENTIFICATION	100
2	-	A		3-21002-0	SCR, BHC (10-32x.88) DRAG	99
1	-	A		22733-8	SCR, BHC (8-32x.38 LW) ANVIL	98
1	-	A		3-21000-8	SCR, SHC (10-32x.88) MOUNTING	96
1	-	A		2-21002-7	SCR, BHC (10-32x.50) 5G ADJ BLK	95
6	-	A		2-21002-2	SCR, BHC (8-32x.50) SHEAR-TERM SUP	94
1	-	A		1-21002-7	SCR, SHC (6-32x.50) CAM	91
2	-	A		2-21000-7	SCR, SHC (8-32x.50) SCR BLK	90
REF	-	A		9-21002-6	SCR, SHC (8-32x.86) DEP-HOLD DOWN	87
REF	-	A		2-22603-0	SCR, HEX HD (8-32x.31) FEED FINGER	86
2	-	A		1-21000-3	SCR, SHC (4-40x.25) F ST GUIDE	85
REF	-	A		22733-9	SCR, BHC (8-32x.50 SL) STRIPPER	84
1	-	A		3-22603-1	SCR, HEX (10-32x.38) 5G ADJ BL	81
2	-	B		463310-4	BLADE, STRIPPING (#18)	77
1	-	A		690603-1	SPRING, ASSIST	74
1	-	A		23030-1	SCR, 5KT CAP (6-32x.25) CP DSC	73

QTY	REV	U/M	DWG SIZE	PART NO	DESCRIPTION	ITEM NO
-1	U/M					

QTY	REV	U/M	DWG SIZE	PART NO	DESCRIPTION	ITEM NO
-1	U/M					

QTY	REV	U/M	DWG SIZE	PART NO	DESCRIPTION	ITEM NO
70						
69						
68						
67						
66						
65						
64						
63						
62						
61						
60						
59						
58						
57						
56						
55						
54						
53						
52						
51						
50						
49						
48						
47						
46						
45						
44						
43						
42						
41						
40						
39						
38						
37						
36						
35						
34						
33						
32						
31						
30						
29						
28						
27						
26						
25						
24						
23						
22						
21						
20						
19						
18						
17						
16						
15						
14						
13						
12						
11						
10						
9						
8						
7						
6						
5						
4						
3						
2						
1						

QTY	REV	U/M	DWG SIZE	PART NO	DESCRIPTION	ITEM NO
-1	U/M					

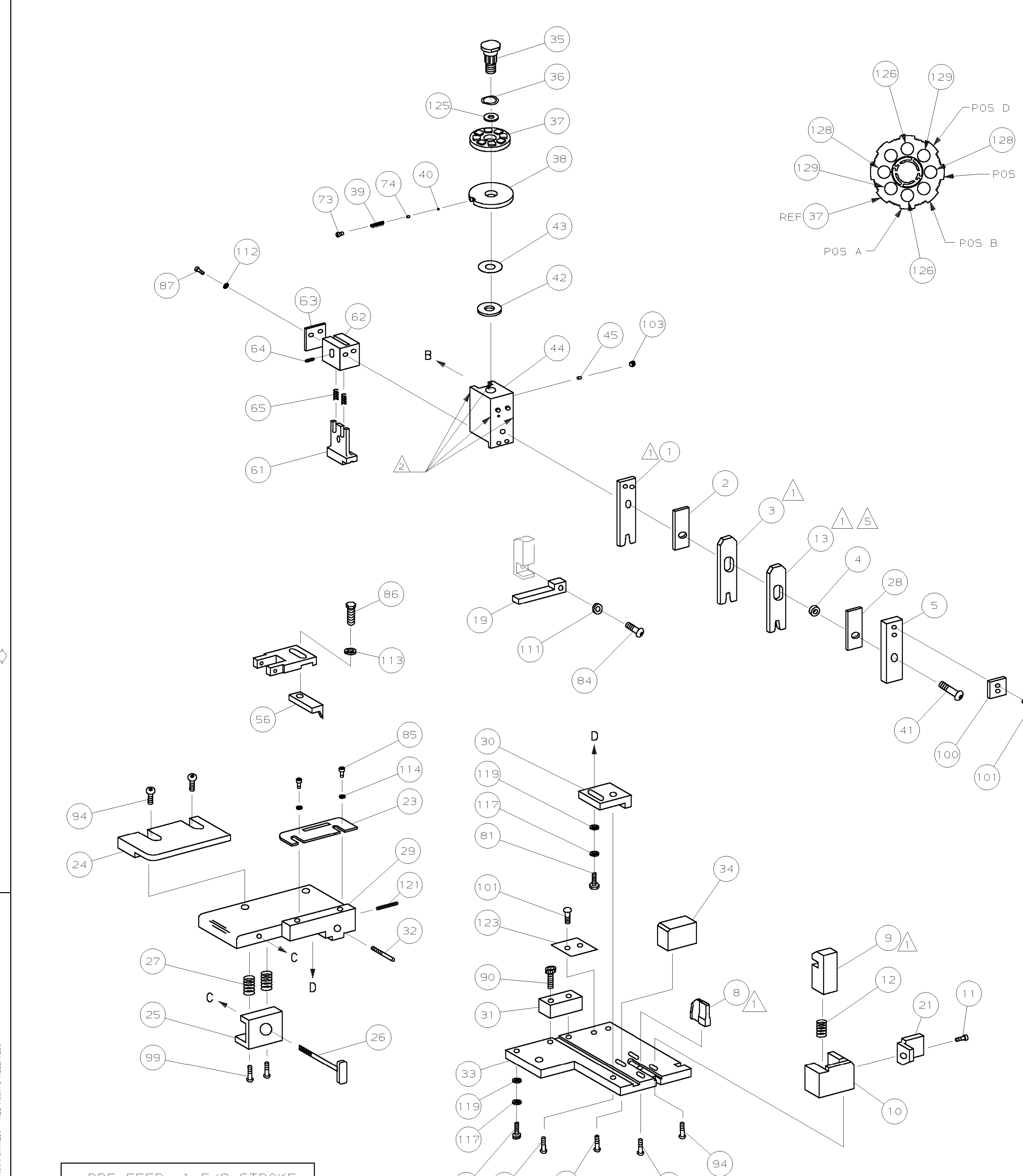

PRE-FEED 1 5/8 STROKE

ROTATED 180°

RECOMMENDED SPARE PARTS.

GREASE LIGHTLY.

ITEM NOT SHOWN

CUT TO LENGTH AT ASSEMBLY.

RADIUS REF TOWARD OPERATOR

INSTALL ITEM 13 WITH RADIUS SIDE FACING WIRE CRIMPER.

Mouser Electronics

Authorized Distributor

Click to View Pricing, Inventory, Delivery & Lifecycle Information:

[TE Connectivity:](#)

[567915-1](#)