

| LOC | | DIST | | REVISIONS | | | |
|-----|-----|---------------------------|---------|-----------|------|--|--|
| P | LTR | DESCRIPTION | DATE | DMN | APVD | | |
| B1 | | REVISED PER ECO-11-004835 | 11MAR11 | RK | HMR | | |

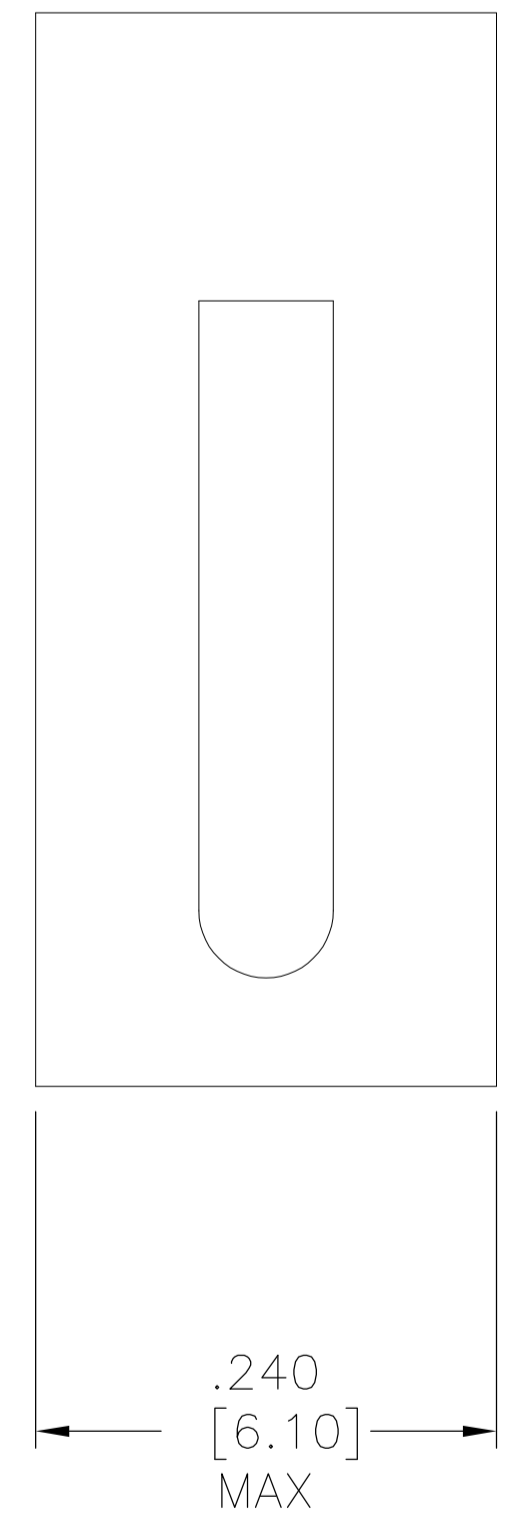
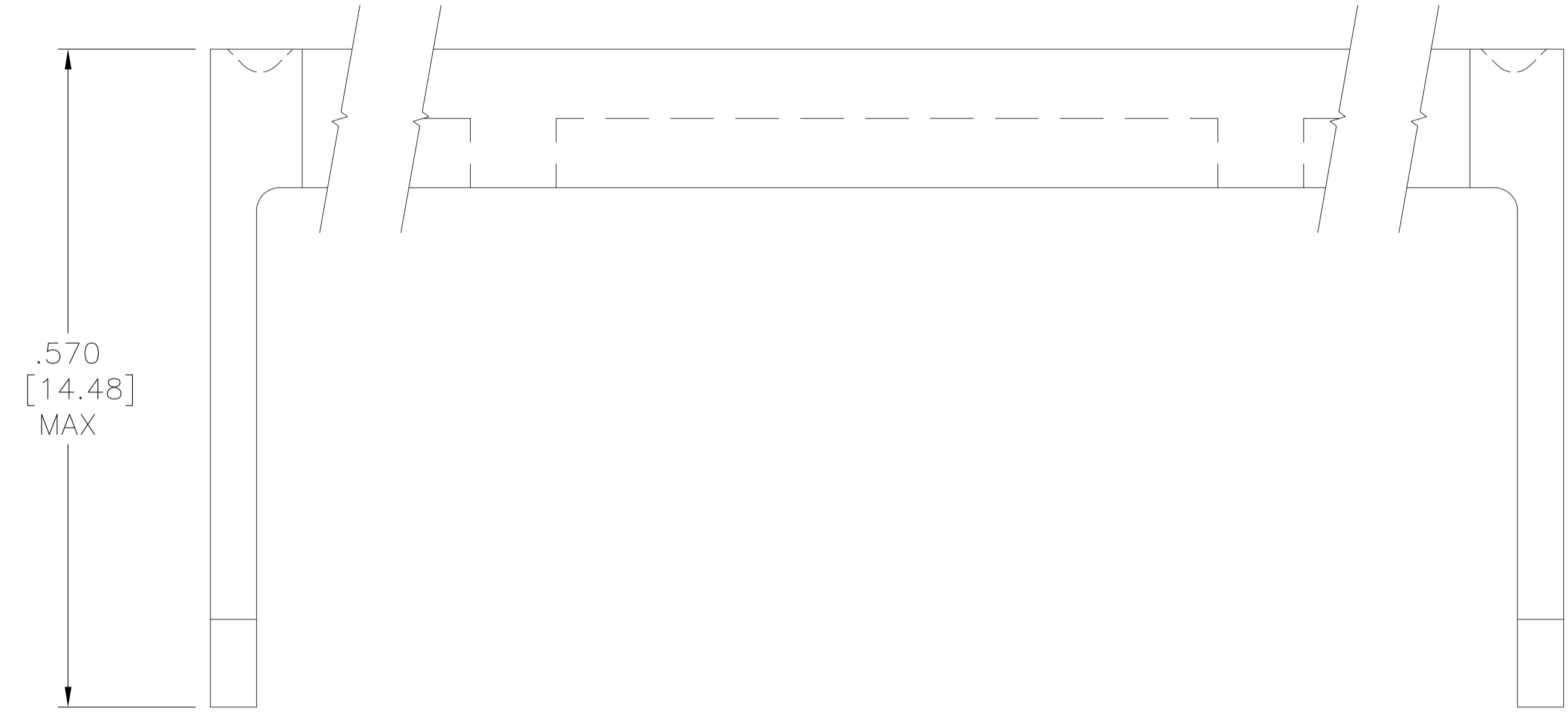
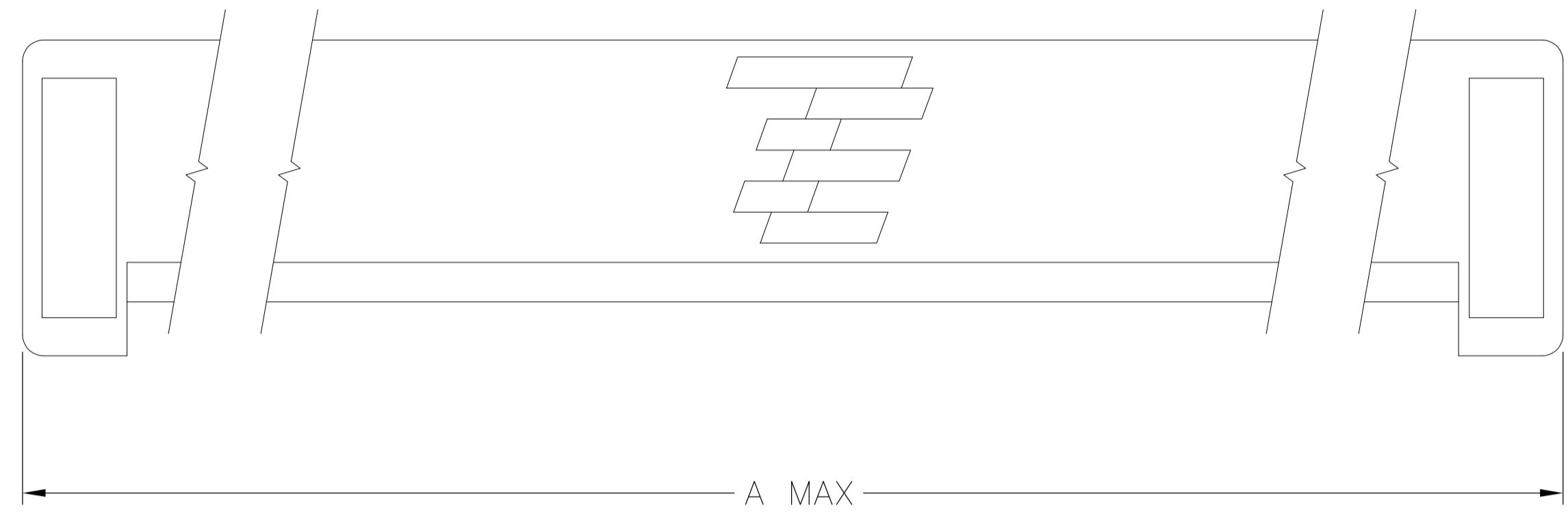

MATERIAL: GLASS REINFORCED THERMOPLASTIC RATED 94V-0.

2. COLOR: BLUE

| | | | | |
|------------------------------|----------|-------------------|----------------|-------------|
| 609-6431HD | 85.95 | (3.384) | 64 | 1-1437022-3 |
| 609-5031HD | 68.17 | (2.684) | 50 | 8-1437021-1 |
| 609-4031HD | 55.47 | (2.184) | 40 | 5-1437021-5 |
| 609-3431HD | 47.85 | (1.884) | 34 | 3-1437021-2 |
| 609-2631HD | 37.69 | (1.484) | 26 | 1-1437021-2 |
| 609-2031HD | 30.07 | (1.184) | 20 | 8-1437020-6 |
| 609-1631HD | 24.99 | (0.984) | 16 | 6-1437020-6 |
| 609-1431HD | 22.45 | (0.884) | 14 | 5-1437020-1 |
| 609-1031HD | 17.37 | (0.684) | 10 | 3-1437020-7 |
| T&B PART NO (REF) | A | NO OF POSN | PART NO | |

THIS DRAWING IS A CONTROLLED DOCUMENT.

| | | | |
|----------------------------|--|--|---|
| DIMENSIONS: mm [INCHES] | TOLERANCES UNLESS OTHERWISE SPECIFIED: 0. PLC ± .01 1. PLC ± .01 2. PLC ± .01 3. PLC ± .01 4. PLC ± .01 ANGLES ± .01 | DWG: W. DABULAS 3/25/83 CHK: G. KLEMM 3/25/83 APVD: R.R. 3/31/83 | NAME: HEAVY DUTY STRAIN RELIEF FEMALE SOCKET CONNECTOR PRODUCT SPEC: - APPLICATION SPEC: - SIZE: A1 CAGE CODE: 00779 DRAWING NO: 3-1437020-7 RESTRICTED TO: - |
| MATERIAL: FINISH: - | | WEIGHT: - CUSTOMER DRAWING | SCALE: 10:1 SHEET: 1 OF 1 REV: B1 |

4805 (3/11)

Mouser Electronics

Authorized Distributor

Click to View Pricing, Inventory, Delivery & Lifecycle Information:

[TE Connectivity:](#)

[6-1437020-6](#)