

THIS DRAWING IS UNPUBLISHED. RELEASED FOR PUBLICATION
 © COPYRIGHT - By - ALL RIGHTS RESERVED.

REVISIONS					
P	LTR	DESCRIPTION	DATE	DWN	APVD
U1		REVISED PER ECO-17-007400	05DEC2017	RS	DR
U2		REVISED PER ECO-19-007720	21MAY2020	KR	DR

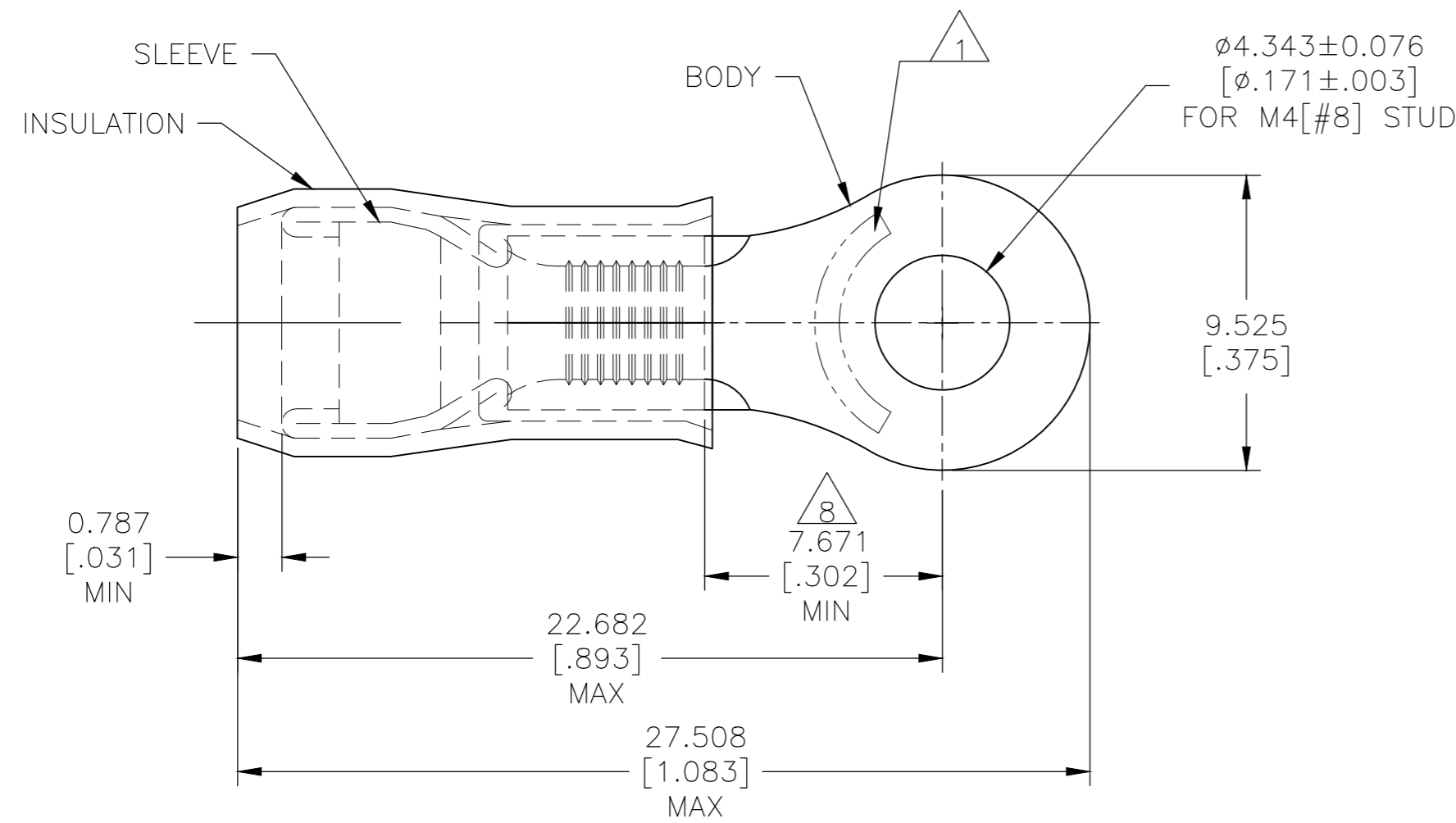

STYLE "A"

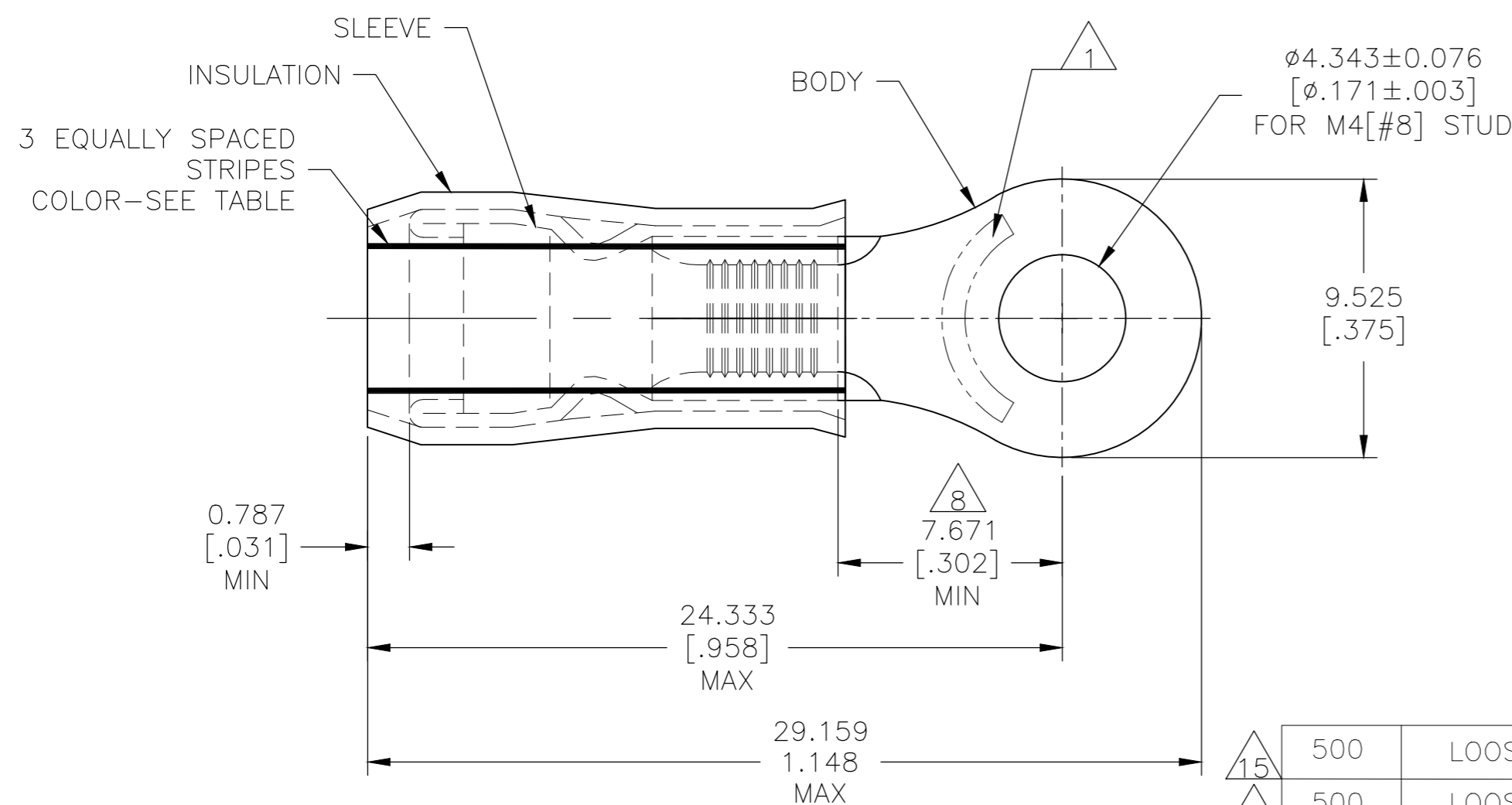

STYLE "B"
INSULATION RESTRICTING

AMP WIRE RANGE	E13288 Listed	LR7189 Certified
12-10 AWG SOLID OR STRANDED IR: STRANDED	12-10 AWG STRANDED $\Delta 14$	12-10 AWG $\Delta 15$ SOLID OR STRANDED IR: STRANDED

- $\Delta 1$ STAMP "AMP - SEE TABLE" APPROX AS SHOWN.
- 2 WIRE INSULATION DIA: SEE TABLE .
- 3 BODY MATERIAL THK: 1.016±0.051[.040±.002].
- $\Delta 4$ FINISH:
BODY: TIN PLATE 0.00254[.000100] MIN EXT THK PER ASTM B545.
INSULATION: COLOR-YELLOW
- $\Delta 5$ FINISH:
SLEEVE: TIN PLATE 0.00254[.000100] MIN EXT THK PER ASTM B545.
INSULATION: COLOR-YELLOW
- $\Delta 6$ FINISH:
SLEEVE: NICKEL PLATE PER SAE AMS QQ-N-290.
INSULATION: COLOR-YELLOW
- $\Delta 7$ MATERIAL:
BODY & SLEEVE- CU PER ASTM B152
INSULATION - NYLON PER ASTM D4066
- $\Delta 8$ APPLIES FROM EDGE OF METAL WIRE BARREL TO CENTER OF STUD HOLE.
- $\Delta 9$ MEETS MS25036-156, CLASS 1 & 2.
- $\Delta 10$ MEETS MS25036-156, CLASS 2.
- $\Delta 11$ MEETS M7928/1-57, CLASS 1 & 2.
- $\Delta 12$ MEETS M7928/1-64, CLASS 1 & 2.
- 13 NOTE DELETED.
- $\Delta 14$ UL LISTED
- $\Delta 15$ CSA CERTIFIED

$\Delta 15$	500	LOOSE PIECE	10*	3.023-5.080[.119-.200]	10	BROWN	B	$\Delta 4$	$\Delta 6$	$\Delta 12$	2-320568-3
$\Delta 15$	500	LOOSE PIECE	12*	2.413-5.080[.095-.200]	12	YELLOW	B	$\Delta 4$	$\Delta 6$	$\Delta 11$	2-320568-2
$\Delta 14$ $\Delta 15$	2500	ON TAPE & REEL	12-10*	3.810-5.842[.150-.230]	12-10	--	A	$\Delta 4$	$\Delta 5$	$\Delta 10$	2-320568-1
$\Delta 14$ $\Delta 15$	500	LOOSE PIECE	12-10*	3.810-5.842[.150-.230]	12-10	--	A	$\Delta 4$	$\Delta 5$	$\Delta 9$	320568
QTY	PACKAGE TYPE	STAMPING	WIRE INSUL DIA	WIRE SIZE	STRIPE COLOR	STYLE	BODY FINISH	SLEEVE FINISH	PART NO		

CUSTOMER SERVICE SYSTEMS		MAX RECOMMENDED OPERATING TEMPERATURE: 105°C[221°F] MAX	THIS DRAWING IS A CONTROLLED DOCUMENT.		DWN JR RUTH 17DEC09		TE Connectivity			
FOR ADDITIONAL PRODUCT INFORMATION OR COPIES OF DRAWINGS AND TECHNICAL DOCUMENTS	PRODUCT INFORMATION CENTER 1-800-522-6752	VOLTAGE RATING: 300 VOLT MAX	DIMENSIONS: mm [INCHES]	TOLERANCES UNLESS OTHERWISE SPECIFIED: 0 PLC ± - 1 PLC ± - 2 PLC ± - 3 PLC ± 0.127[.005] 4 PLC ± - ANGLES ± -	CHK T MICHIELUTTI 17DEC09		NAME	TERMINAL, RING TONGUE, PIDG 12-10 AWG, PIDG IR 12 & 10 AWG		
FOR APPLICATION TOOLING INFORMATION	TOOLING ASSISTANCE CENTER 1-800-722-1111	CIRCULAR MIL AREA: 2.62-6.64mm²[5,180-13,100] STRANDED OR SOLID		MATERIAL $\Delta 7$	APVD T MICHIELUTTI 17DEC09	PRODUCT SPEC UL 486 A-B $\Delta 14$	SIZE	CAGE CODE	DRAWING NO	RESTRICTED TO
FOR ORDER ENTRY	1-800-526-5142				114-2157	114-2157	A2	00779	C=320568	-
						WEIGHT	SCALE	SHEET	REV	
						CUSTOMER DRAWING	5:1	1 of 1	U2	

Mouser Electronics

Authorized Distributor

Click to View Pricing, Inventory, Delivery & Lifecycle Information:

[TE Connectivity:](#)

[2-320568-2](#)