

P	LTR	DESCRIPTION	DATE	DWN	APVD
A		PRODUCTION RELEASE	30AUG2019	SS	PS
A1		REMOVED TOLERANCE FROM DIM F	18DEC2019	AY	PS

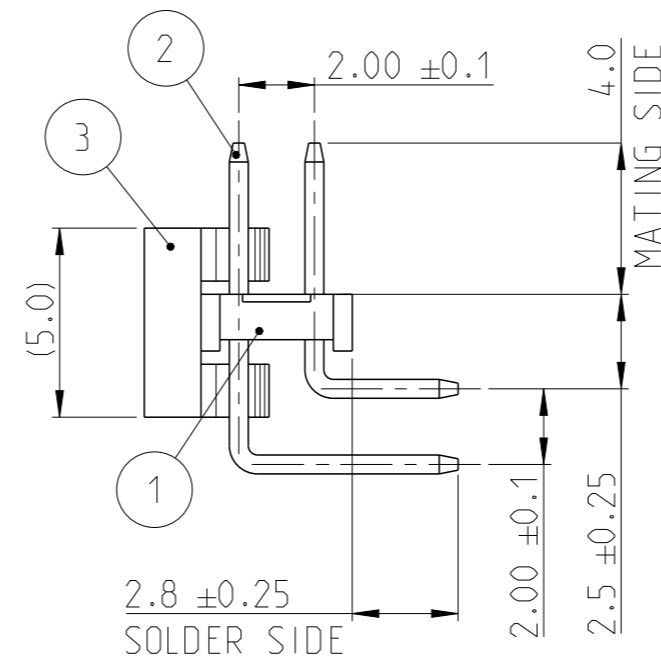

NOTES:

- MATERIAL HOUSING & P&P CAP : HIGH TEMPERATURE THERMOPLASTIC, UL94-V0; COLOR- BLACK  
CONTACT PIN : COPPER ALLOY  
FINISH :  
MATING SIDE : MIN. 0.1 μm GOLD OVER NICKEL UNDER PLATING.  
SOLDER SIDE : MIN. 2.0 μm BRIGHT TIN OVER NICKEL UNDER PLATING.
- PACKAGING: TUBE (WITH PICK AND PLACE CAP).
- TOLERANCE NOT CUMULATIVE.
- CUTTING BURR MAX. 0.25 mm

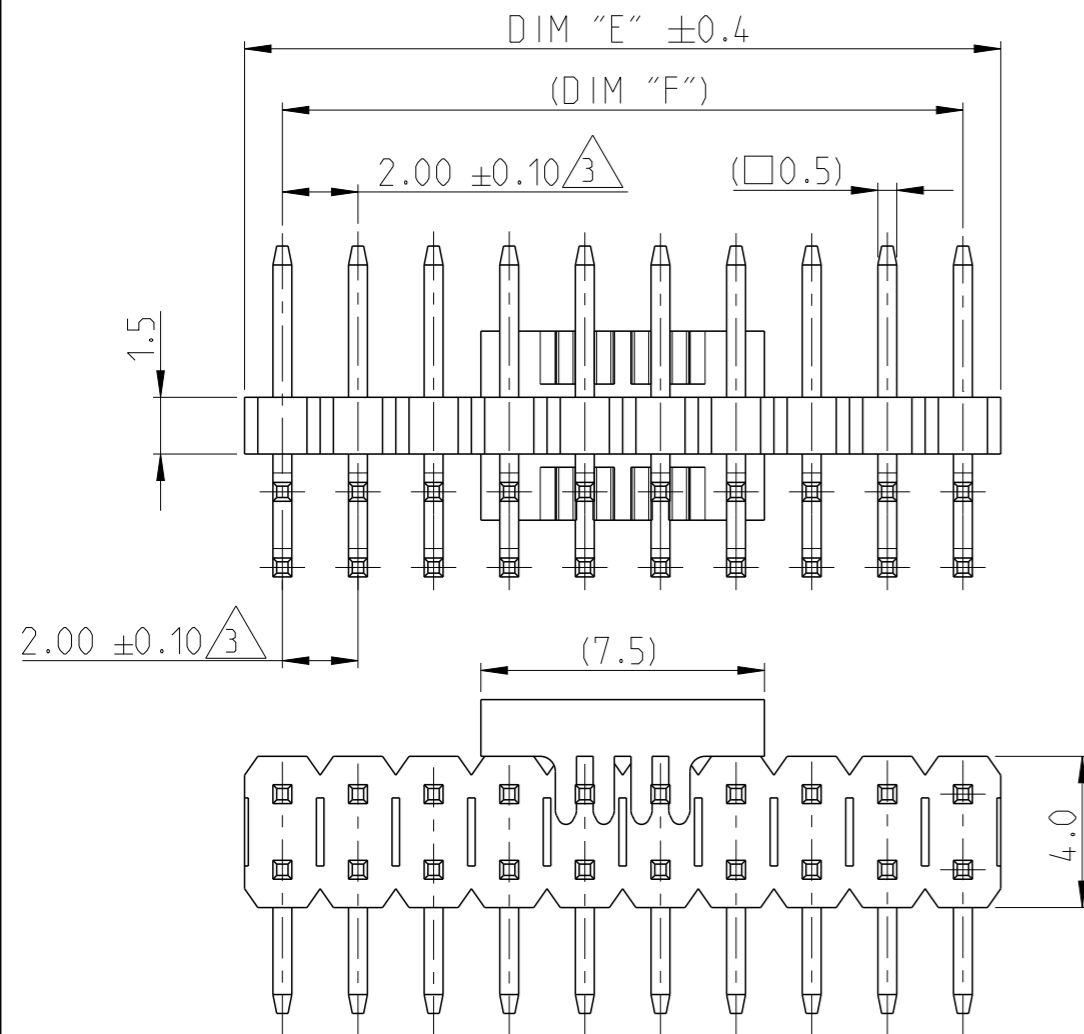
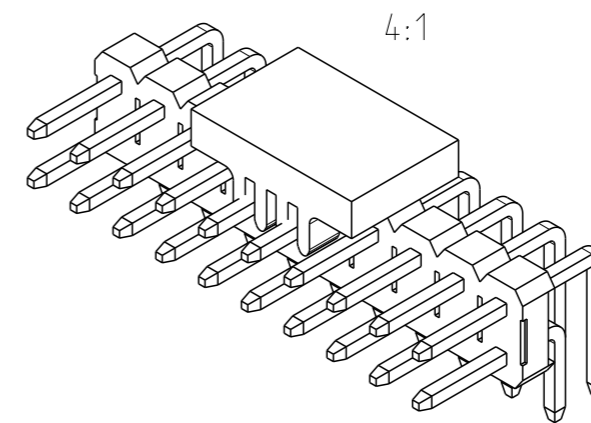

48.0	50.0	25	2-2842154-5
46.0	48.0	24	2-2842154-4
44.0	46.0	23	2-2842154-3
42.0	44.0	22	2-2842154-2
40.0	42.0	21	2-2842154-1
38.0	40.0	20	2-2842154-0
36.0	38.0	19	1-2842154-9
34.0	36.0	18	1-2842154-8
32.0	34.0	17	1-2842154-7
30.0	32.0	16	1-2842154-6
28.0	30.0	15	1-2842154-5
26.0	28.0	14	1-2842154-4
24.0	26.0	13	1-2842154-3
22.0	24.0	12	1-2842154-2
20.0	22.0	11	1-2842154-1
18.0	20.0	10	1-2842154-0
16.0	18.0	9	2842154-9
14.0	16.0	8	2842154-8
12.0	14.0	7	2842154-7
10.0	12.0	6	2842154-6
8.0	10.0	5	2842154-5
6.0	8.0	4	2842154-4

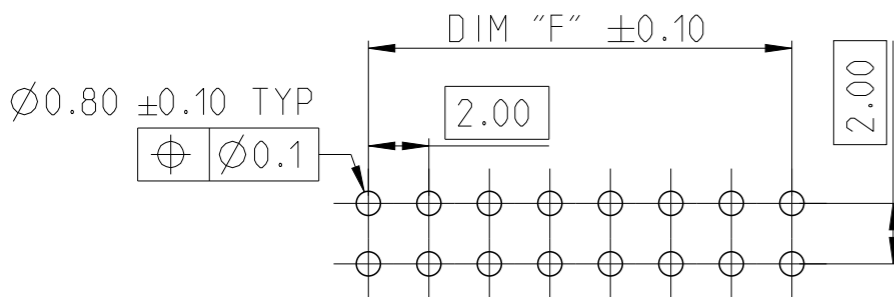

RECOMMENDED PCB HOLE PATTERN FOR THROUGH HOLE WAVE

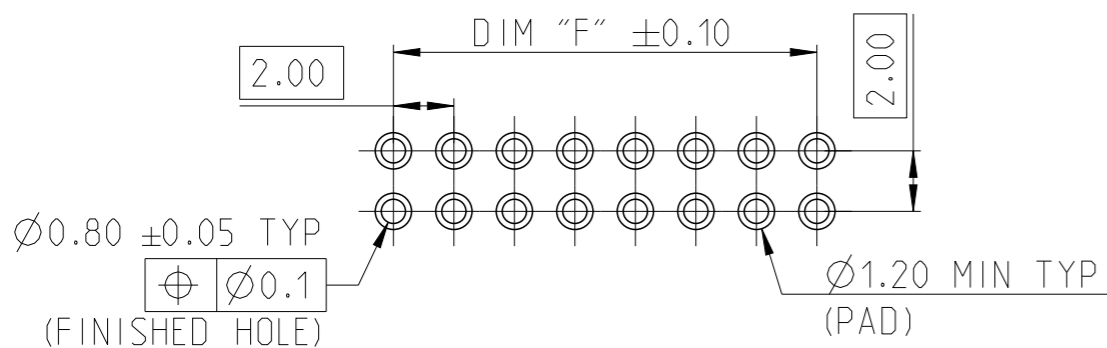

RECOMMENDED PCB HOLE PATTERN FOR THROUGH HOLE REFLOW/PIN-IN-PASTE

1-2842154-0 AS SHOWN

PICK AND PLACE CAP	3
CONTACT PIN	2
HOUSING	1
DESCRIPTION	ITEM NO.

THIS DRAWING IS A CONTROLLED DOCUMENT.		DWN 07AUG2019 SUBHASREE S														
DIMENSIONS: mm		CHK 13AUG2019 KARTHIK JK														
TOLERANCES UNLESS OTHERWISE SPECIFIED:		APVD 14AUG2019 PRASHANTH S														
<table border="1"> <tr><td>0 PLC</td><td>±</td></tr> <tr><td>1 PLC</td><td>±0.2</td></tr> <tr><td>2 PLC</td><td>±0.15</td></tr> <tr><td>3 PLC</td><td>±</td></tr> <tr><td>4 PLC</td><td>±</td></tr> <tr><td>ANGLES</td><td>±2°</td></tr> </table>		0 PLC	±	1 PLC	±0.2	2 PLC	±0.15	3 PLC	±	4 PLC	±	ANGLES	±2°	PRODUCT SPEC 108-64040	NAME AMPMODU 2mm BREAKAWAY HEADER, DUAL ROW, RIGHT ANGLE, 0.1 Au, TUBE, WITH PICK AND PLACE CAP	
0 PLC	±															
1 PLC	±0.2															
2 PLC	±0.15															
3 PLC	±															
4 PLC	±															
ANGLES	±2°															
MATERIAL SEE NOTES		APPLICATION SPEC 114-32259	SIZE A3	CAGE CODE 00779	DRAWING NO C=2842154											
FINISH SEE NOTES		WEIGHT -	RESTRICTED TO -													
CUSTOMER DRAWING			SCALE 5:1	SHEET 1 OF 1	REV A1											

# Mouser Electronics

Authorized Distributor

Click to View Pricing, Inventory, Delivery & Lifecycle Information:

[TE Connectivity:](#)

[2842154-4](#)