

THIS DRAWING IS UNPUBLISHED.
VERTRAULICHE UNVEROEFFENTLICHTE ZEICHNUNG

RELEASED FOR PUBLICATION
FREI FUER VEROEFFENTLICHUNG

2013

MATED WITH:
PASSEND ZU:

2141616

PROJEKT NR.:
PRJ-13-000000345

REVISIONS
AENDERUNGEN

© COPYRIGHT 2013 BY -

ALL RIGHTS RESERVED.
ALLE RECHTE VORBEHALTEN.

P	LTR	DESCRIPTION BESCHREIBUNG	DATE	DWN	APVD
	A	NEW DRAWING	20DEC2013	MKP	FW I
	B	Geometry without collar introduced	18DEC2015	RSC	AKE
	B1	VARIANT 1-2141617-1 ADDED	05MAR2018	RSC	RSC
	B2	VIEW 1-2141617-1 ADDED	25APR2018	RSC	RSC

1-2141617-1	SHIELD CRIMP FERRULE 5+2 POS. HV CONNECTOR	DEEP DRAWN PART Tiefziehteil	STAINLESS STEEL Edelstahl
0-2141617-1		TURNED PART Drehteil	
TE- ORDER-NO.	DESCRIPTION	PRODUCTION PROCESS	MATERIAL

0-2141617-1
AS SHOWN
wie gezeigt

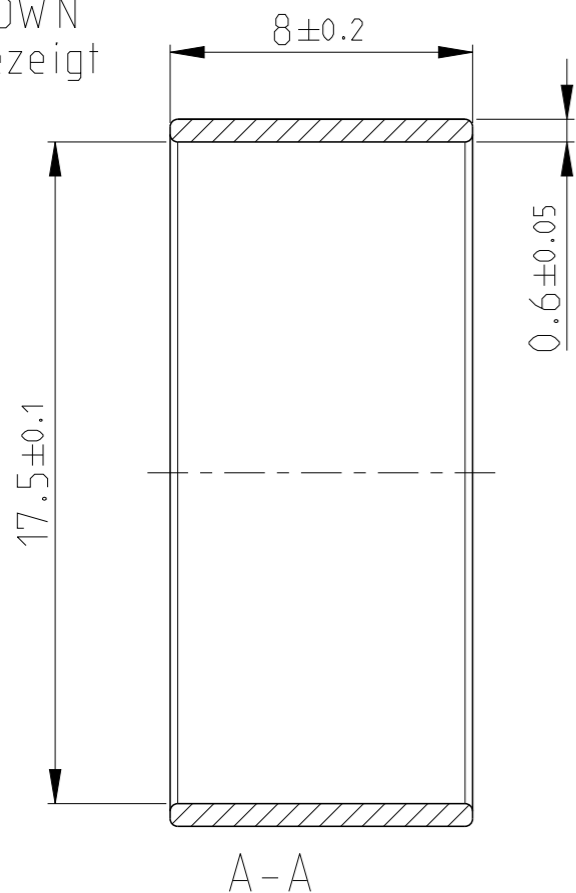

A-A



1:1

1-2141617-1
AS SHOWN
wie gezeigt

(B2)

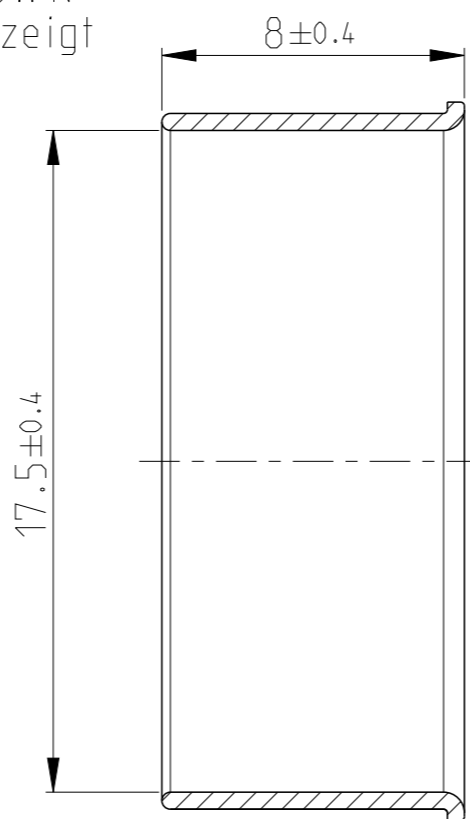

A-A



1:1

NOTES:
Bemerkungen:

- ONLY THE GERMAN LANGUAGE VERSION IS AUTHORITATIVE
Massgebend ist nur der deutsche Text
- PACKAGING: LOOSE PIECES IN TO PLASTIC BAG AND CARTON
Verpackung: Schuettgutverpackung in PE-Beutel und Karton
- ALL EDGE: FREE OF BURR
Alle Kanten: Graffrei

DIESE ZEICHNUNG IST EIN KONTROLLIERTES DOKUMENT.
BEMASSUNGEN UND TOLERANZEN GEMAESS GPS (ISO STANDARDS).

THIS DRAWING IS A CONTROLLED DOCUMENT.
DIMENSIONING AND TOLERANCING PER GPS (ISO STANDARDS).

DIMENSIONS: MASSEINHEITEN: mm	TOLERANCES UNLESS OTHERWISE SPECIFIED: ALLGEMEINTOLERANZEN
0 PLC	±
1 PLC	±
2 PLC	±
3 PLC	±
4 PLC	±
ANGLES/WINKEL	±

MATERIAL
SEE TABLE

FINISH/OBERFLAECHE/FARBE
SEE TABLE

DWN	03OCT2013
CHK	Maithreya K.P
APVD	F. Wittrock
APVD	A. Ketteler
PRODUCT SPEC	108-94235
APPLICATION SPEC	114-94114
WEIGHT	2.14g

NAME		OUTER CRIMP FERRULE, HV-CONNECTOR Aussere Crimphulse, HV-Stecker	
SIZE	CAGE CODE	DRAWING NO ZEICHNUNGS-NR.	RESTRICTED TO NUR FUER
A3	00779	G=2141617	-



Customer Drawing /KUNDENZEICHNUNG SCALE MASSSTAB 5:1 SHEET BLATT 1 OF 1 REV B2

Mouser Electronics

Authorized Distributor

Click to View Pricing, Inventory, Delivery & Lifecycle Information:

[TE Connectivity:](#)

[2141617-1](#)