

Thermofit<sup>®</sup> Molded Parts  
 Specification Control Drawing  
 Limited Distribution

Part Number : 207W223-X-A18  
 Description : Feedthrough, Seal

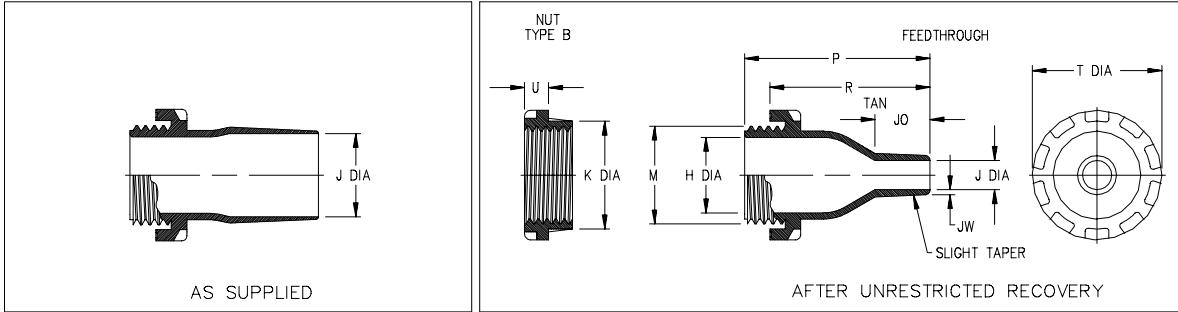

- NOTES
- All dimensions are in  $\frac{\text{inches}}{\text{[millimeters]}}$
  - Dimensions appearing in table are as follows:
    - a - As Supplied
    - b - After Unrestricted Recovery
  - Nut type is optional. Type "A" nut is supplied with part unless type "B" is specified (see ordering information)
  - Coating is optional. As supplied dimensions appearing in table are for uncoated parts. "J" entry diameter shown will be reduced by .06 max when coating is added (see ordering information)
  - "O" ring is supplied with each part.

TABLE OF DIMENSIONS

PART NUMBER	H	J		P	R	S	T	U	JO	JW	HOLE DIA
	Ref b	Min a	Max b	$\pm 10\%$ b	$\pm 10\%$ b	$\pm 10\%$ b	Ref b	$\pm 10\%$ b	Max b	$\pm 20\%$ b	DIA $\pm .02$
207W223-X-A18	.79 [20,1]	.83 [21,1]	.28 [7,1]	2.83 [71,9]	2.32 [58,9]	.63 [16,0]	1.65 [42,0]	.39 [9,9]	.76 [19,3]	.06 [1,5]	1.34 [34,0]

**Raychem**

RAYCHEM CORPORATION  
 300 CONSTITUTION DRIVE  
 MENLO PARK, CALIFORNIA 94025

Revision : A  
 Date : 4/14/94

Part Number : 207W223-X-A18  
 Description : Feedthrough, Seal

Thermofit<sup>®</sup> Molded Parts  
 Specification Control Drawing  
 Limited Distribution

Part Number : 207W223-X-A18  
 Description : Feedthrough, Seal

COMPATABILITY CHART

MATERIAL DASH NO.	MATERIAL DESCRIPTION	RT SPEC	COATING SLASH NO.	COATING S NO.	COATING DESCRIPTION
-3	Polyolefin, Semi-rigid	RT-301	N/A		

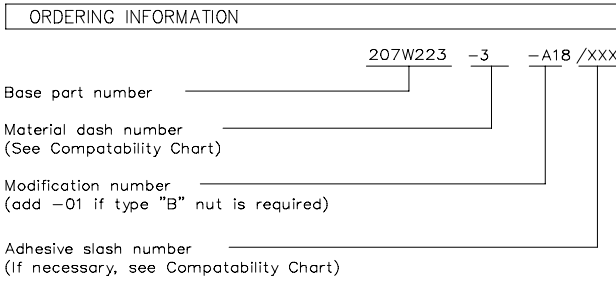

THIS DRAWING IS SUBJECT TO CHANGE WITHOUT NOTICE; CONSULT YOUR  
 NEAREST FIELD REPRESENTATIVE FOR CURRENT REVISION

**Raychem**

RAYCHEM CORPORATION  
 300 CONSTITUTION DRIVE  
 MENLO PARK, CALIFORNIA 94025

Revision : A  
 Date : 4/14/94

Part Number : 207W223-X-A18  
 Description : Feedthrough, Seal

If this document is printed it becomes uncontrolled.  
 Check for the latest revision.

CAD FILE MP94132

# Mouser Electronics

Authorized Distributor

Click to View Pricing, Inventory, Delivery & Lifecycle Information:

[TE Connectivity:](#)

[323233-000](#)