

THIS IS A CONTROLLED DOCUMENT.

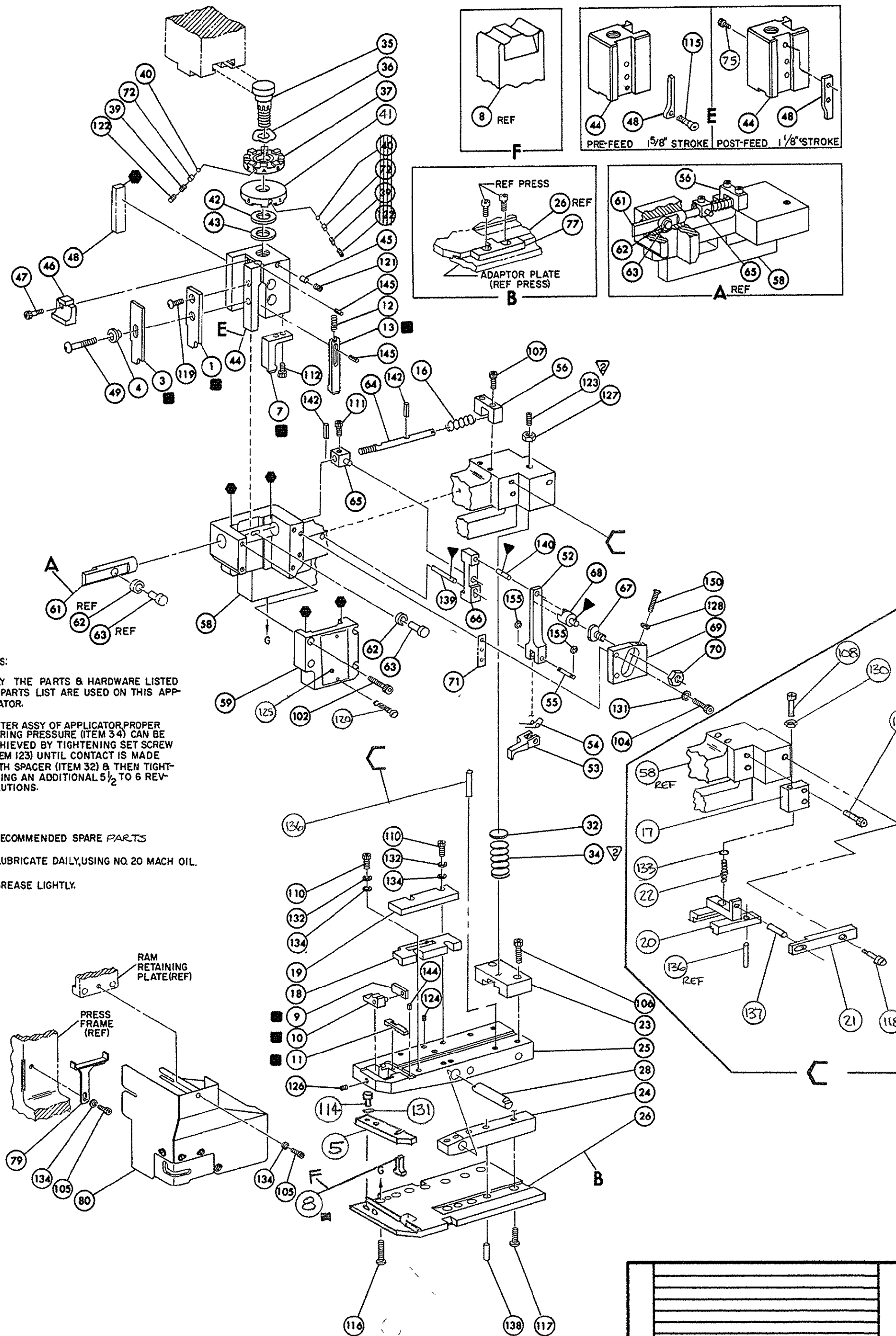

NOTES:
 1. ONLY THE PARTS & HARDWARE LISTED ON PARTS LIST ARE USED ON THIS APPLICATOR.

2. AFTER ASSY OF APPLICATOR PROPER SPRING PRESSURE (ITEM 3 & 4) CAN BE ACHIEVED BY TIGHTENING SET SCREW (ITEM 123) UNTIL CONTACT IS MADE WITH SPACER (ITEM 32) & THEN TIGHTENING AN ADDITIONAL 5/2 TO 6 REVOLUTIONS.

KEY:
 ■ - RECOMMENDED SPARE PARTS
 ▼ - LUBRICATE DAILY, USING NO. 20 MACH OIL.
 ● - GREASE LIGHTLY.

THIS INFORMATION IS CONFIDENTIAL AND IS LOANED TO YOU ON THE CONDITION THAT YOU WILL NOT DISSEMINATE IT TO OTHERS WITHOUT THE WRITTEN AUTHORIZATION OF AMP INCORPORATED. ALL RIGHTS RESERVED. COPYRIGHT 2000.

REQ.	PART NO.	DESCRIPTION	NO.	REQ.	PART NO.	DESCRIPTION	NO.
			162	1	690517-1	SPACER	71
			161	1	22594-8	NUT, HEX	70
			160	1	240628-1	PLATE, ADJUSTMENT	69
			159	1	240626-1	SHAFT, PIVOT	68
			158	1	240633-1	BUSHING	67
			157	1	240630-1	LEVER, INTERMEDIATE	66
			156	1	240629-1	BLOCK, PIVOT	65
2	21045-3	RING RET "C" (3/16 DIA) FEED PIN	155	1	240632-2	SCREW, ADJUSTMENT	64
			154	1	240659-3	PIN, CAM ROLLER	63
			153	1	240658-1	ROLLER, CAM	62
			152	1	240631-1	ROD, FEED	61
			151				60
1	3-21064-1	SCREW RD. HD. MACH. (6-32 X 1.25) FEED ADJ.	150	1	455164-1	CAP, HOUSING	59
			149	1	458984-1	HOUSING	58
			148				57
			147	1	458961-1	GUIDE, FEED ROD	56
			146	1	240624-1	PIN, FEED FINGER	55
2	4-21028-9	PIN SLOTTED SPRING (1/8 DIA X .38) RAM	145	1	691499-1	SPRING, FEED FINGER	54
1	3-21028-2	PIN, SLOTTED SPRING (3/32 DIA X .25) REAR SHEAR PLATE	144	1	690584-5	FINGER, FEED	53
			143	1	240634-1	LEVER, TERMINAL	52
2	5-21028-1	PIN, SLOTTED SPRING (1/8 DIA X .50) SCREW ADJ. ROD	142				51
			141				50
1	1-21030-2	PIN, DOWEL (3/16 DIA X .62) LEVER	140	1	3-21002-5	BOLT, CRIMPER	49
1	1-21030-6	PIN, DOWEL (3/16 DIA X 1.25) HOUSING	139	1	690696-1	CAM FEED 1/8 STROKE	48
1	21029-5	PIN, SLOTTED (3/16 DIA X .75) BASE PLATE	138				47
1	21029-3	PIN, SLOTTED SPRING (.187 X .62 LG) DRAG	137				46
2	1-21030-6	PIN, DOWEL (.187 X 1.25 DIA) DRAG	136	1	690191-1	PLUG, NYLON	45
			135	1	691533-1	RAM	44
			134	1	690125-1	WASHER, LAMINATED	43
1	21899-3	WASHER, FLAT 1/4 GUARD	133	1	690124-4	WASHER, RAM	42
4	21024-4	WASHER, LOCK (#8) STRIP GUIDE	132	1	690223-1	DISC, SPACER	41
4	21024-5	WASHER, LOCK (#10) FEED ADJ. PLATE & RET PLATE	131	1	23241-6	BALL, STEEL	40
1	21018-7	NUT, HEX (#10) DRAG	130	1	690170-1	SPRING, DISC.	39
1	21022-3	NUT, HEX (SELF-LOCKING) (#10-32) DRAG STUD	129				38
1	21018-5	NUT, HEX MACH (6-32) FEED ADJ.	128	1	3-690141-1	DISC., WIRE	37
1	1-22202-7	NUT HEX MACH (5/16-24) SPRING HOUSING	127	1	22480-5	WASHER, SPRING	36
			126	1	690212-1	POST, RAM	35
1	21061-9	SCREW SKT. SET (8-32 X .25) ANVIL INSERT	125	1	3-23846-5	SPRING, HINGE BAR	34
1	461264-1	PLATE, ID	124				33
2	4-21006-0	SCREW SKT. SET (8-32 X .25) HINGE PIN	123	1	690573-1	SPACER, SPRING	32
1	8-21007-5	SCREW SKT. SET (5/16-24 X .75) SPRING HOUSING	122	1	458582-1	MOUNT, DRAG	31
1	2-23030-1	SCREW, SKT. HD. CAP. (NYLON) (6-32 X .25) C. P. DISC.	121	1	3-23354-8	STUD, DRAG	30
1	21009-2	SCREW SKT. SET (1/4-20 X .25) C. P. RAM	120	1	21030-7	MOUNT, PIN, DRAG	29
2	21017-2	SCR, DRIVE (#2 X .19) ID PLATE	119	1	690582-1	PIN, HINGE	28
1	2-21002-3	SCREW BTN HD. SKT. CAP (8-32 X .62) CRIMPER	118				27
1	1-22853-9	SCR SHLD. SLT. HD. (.250 X .250) DRAG	117	1	463873-1	PLATE, BASE	26
3	2-22733-8	SCREW BTN HD. SKT. CAP (1/4-20 X .62) BLOCK, STABILIZER	116	1	691535-2	BAR, HINGE	25
4	2-22733-8	SCREW BTN HD. SKT. CAP (1/4-20 X .62) HOUSING	115	1	690571-1	BLOCK, STABILIZER	24
1	3-21000-4	SCREW FL HD. SKT. CAP (6-32 X .38) CAM	114	1	814222-2	BLOCK, PRESSURE	23
2	7-21000-6	SCREW SKT. HD. CAP (10-32 X .31) ANVIL MTG. PL.	113	1	7-22282-5	SPRING, DRAG	22
2	2-21000-8	SCREW SKT. HD CAP (8-32 X .62) DRAG MOUNT	112	1	458968-1	LEVER, DRAG	21
2	23030-4	SCREW SKT. HD CAP (6-32 X .50) NYLON, SL BLADE	111	1	458960-2	DRAG, STOCK	20
1	3-21000-4	SCREW SKT. HD CAP (10-32 X .38) PIVOT BLOCK	110	1	691530-1	GUIDE, STRIP, REAR	19
4	2-22603-3	SCREW HEX HD CAP (8-32 X .62) FR STRIP GUIDE	109	1	691529-1	GUIDE, STRIP, FRONT	18
2	2-21000-8	SCREW SKT. HD CAP (8-32 X .62) REAR STRIP GUIDE	108	1	458978-1	BLOCK, SPRING	17
1	3-21000-9	SCREW SKT. HD CAP (10-32 X 1.00) DRAG	107	1	4-22284-9	SPRING, FEED RETURN	16
1	3-21000-0	SCREW SKT. HD CAP (8-32 X .37) FEED ROD GUIDE	106				15
2	2-21000-9	SCREW SKT. HD CAP (8-32 X .75) PRESS BLOCK	105				14
			104	1	692134-5	POSITIONER, TERMINAL	13
2	3-21000-6	SCREW SKT. HD CAP (10-32 X .62) FEED PLATE	103	1	5-22280-5	SPRING, TERM, POSITIONER	12
2	2-21000-9	SCREW SKT. HD CAP (8-32 X .75) DRAG	102	1	691525-1	PLATE, REAR SHEAR	11
4	3-21000-8	SCREW SKT. HD CAP (10-32 X .88) HSG. CAP	101	1	691524-1	INSERT, ANVIL	10
3	21000-9	SCREW SKT. HD. CAP (10-32 X 1.00) CAM	100	1	690569-4	PLATE, FRONT SHEAR	9
1	457244-2	GUARD ASSEMBLY	79	1	691523-1	ANVIL	8
		BRACKET, GUARD	78	1	691522-1	BLADE, SLUG	7
1	694427-1	PLATE, APPLICATOR, MOUNTING	77	1	458608-1	SPACER, SLUG BLADE	6
		AIR FEED ASSEMBLY	76	1	463874-1	PLATE, ANVIL MOUNTING	5
1	1-21002-7	SCR, BAC, 6-32 X .38	75			SPACER TUBULAR, INSUL CRIMPER	4
			74			CRIMPER, INSULATION	3
			73				2
1	690603-1	SPRING, ASSIST	72	1	691531-1	CRIMPER, WIRE	1

TERM APPL SPEC 114-2078

CRIMPING DATA				THIS APPLICATOR WILL APPLY
PAD LETTER	CRIMP HEIGHT	WIRE SIZE	WIRE STRIP LENGTH	61177-1
A	.072	12		61177-2
B	.062	14		
C	.056	16		
D	.052	18		
CRIMP	SIZE	TYPE	FEED	PRESS REF.
WIRE	.160	T.L.	.620	56S435-5
INSULATION	++	++		
INSULATION RANGE		WIRE RANGE	APPLICATOR INSTRUCTION	M
		18-12		
REMARKS AMP-O-LECTRIC PRE-FEED				

REV	DATE	DESCRIPTION	BY	CHK
M1	3/7/19	ECR-19-003701		
M	5-06	ECR-26-611777		
L	9-04	ECN 0150-1267-04		
K	7-92	ECN A-377392		
J	5-91	ECN A-304991		
H	11-26	REV PER ECN A-5616		
G	11-26	REV PER ECN		
F	2-8-77	REV PER ECN		
E	7-74	REV PER ECN		
D	8-17	REV PER ECN		
C	10-18-74	REV PER ECN		
B	2-23	REV PER ECN		
A	8-23-73	REV PER ECN		

SET UP GAGE LAYOUT NO.

DRAWN 5-9-73 APPROVED [Signature]

CHECKED 5-10-73 [Signature]

SCALE NONE NAME

APPLICATOR, MINIATURE QUICK CHANGE HINGE BAR, E.F. (TAB LOK (RIGHT HAND))

AMP INCORPORATED HARRISBURG, PENNA.

LOC A C NO. 1-686961-1

Mouser Electronics

Authorized Distributor

Click to View Pricing, Inventory, Delivery & Lifecycle Information:

[TE Connectivity:](#)

[1-686961-1](#)