

THIS DRAWING IS UNPUBLISHED. RELEASED FOR PUBLICATION. ALL RIGHTS RESERVED.

PART NUMBER	REV	FIRST USED
1852016-1	C	122500-1
1852016-2	C	565435-5
1852016-3	C	354500-1

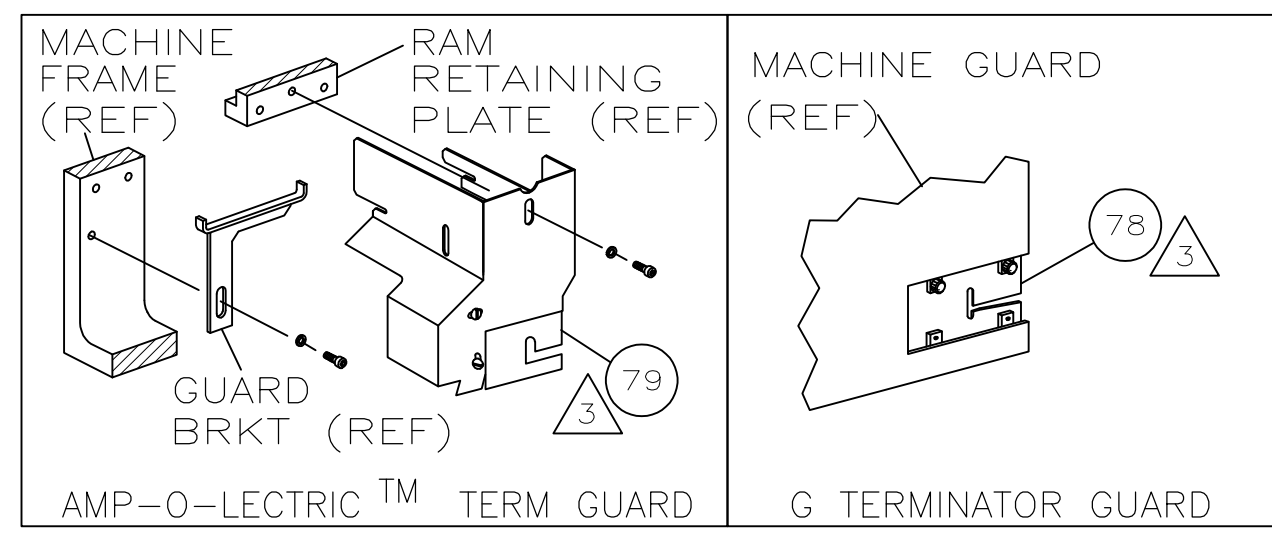

TERMINAL NAME: VERTICAL BULKHEAD CABLE RECP

AMP TERMINAL	AMP CRIMP SPECS
PAD LTR	CRIMP HEIGHT WIRE SIZE
A	.092 ±.002 [2.34 ±0.05mm] 12
B	.084 ±.002 [2.13 ±0.05mm] 14
C	NOT USED
D	NOT USED
CRIMP	SIZE TYPE RANGE
WIRE	.136 [3.45mm] F 12-14
INSUL	.170 [4.32mm] 0 .120-.156

WIRE STRIP LENGTH	TERM APPL	SPEC	FEED	APPL INSTRUCTION	SET UP GAGE	LAYOUT
.235-.265	NONE		.900	408-8040	458637-1	L2862

LOC	DIST	REV	DESCRIPTION	DATE	DN	APVD
A	66	C	ECR-08-023780	9-2008	MY	GB

REV	BY	DESCRIPTION
-1	LEADMAKER	AIRFEED
-2	BENCH MODEL K	AIRFEED
-3	BENCH MODEL G	AIRFEED

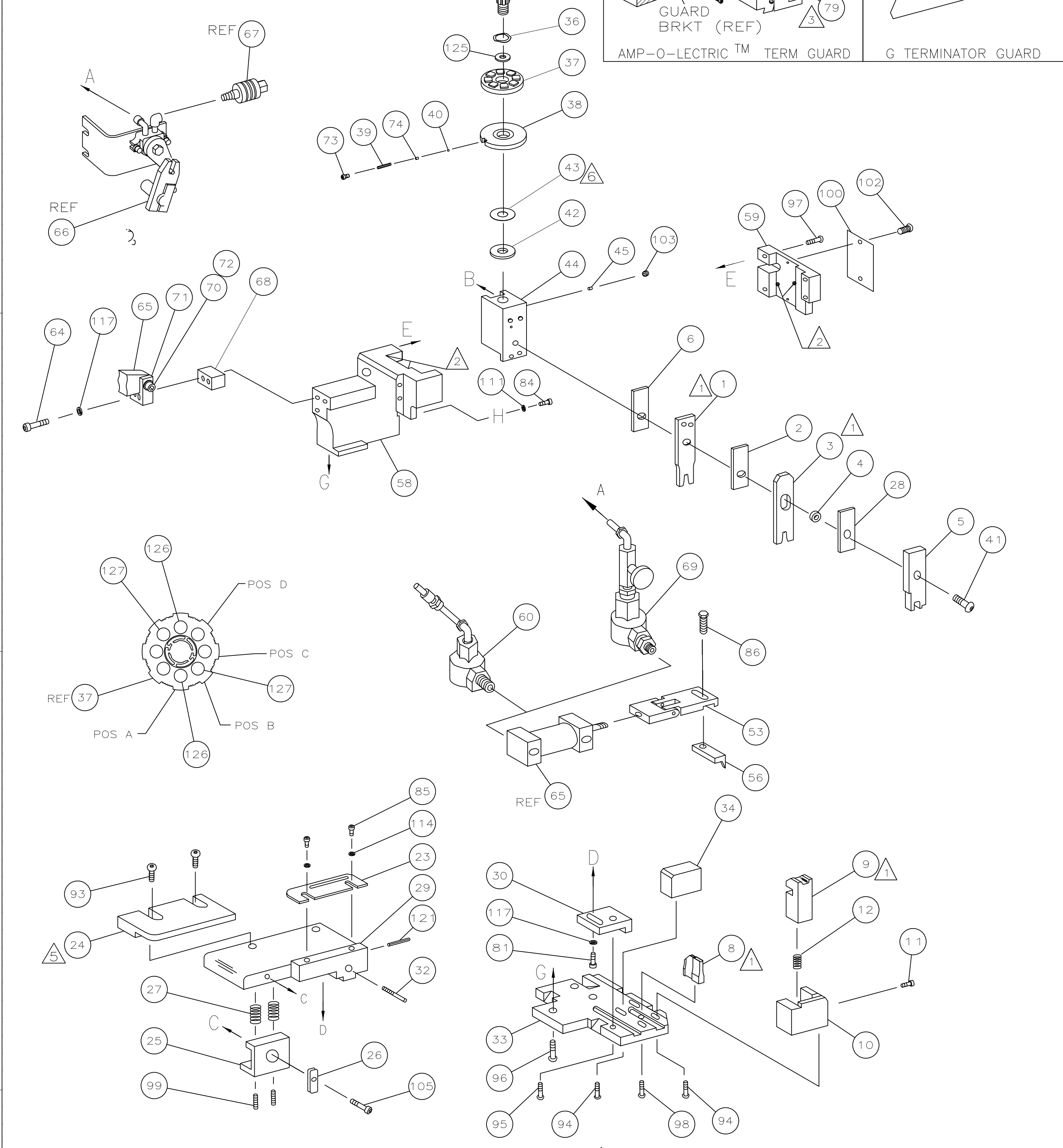

QTY	REQD	PER	ASSY	PART NO	DESCRIPTION	ITEM NO
1	1	1				129
						128
2	2	2	-	8-354778-6	PIN, WIRE DISC (.2925)B	127
2	2	2	-	7-354778-0	PIN, WIRE DISC (.2845)A	126
1	1	1	-	986950-1	WASHER, FLAT PRECISION	125
1	1	1	-	217238-1	GENERAL INSTRUCTION PACKAGE	124
1	1	1	-	4088040	SF APPL INST 408-8040	123
						122
1	1	1	-	4-21028-0	PIN,SLT SPR(Ø.093x.75)ST GDE PL	121
						120
						119
						118
3	3	3	-	21024-5	WASHER, LOCK(#10)ADJ BLOCK	117
						116
						115
2	2	2	-	21024-2	WASHER,LOCK(#4)FRONT STP GUIDE	114
						113
						112
1	1	1	-	21024-4	WASHER,LOCK(#8)STRIPPER	111
						110
						109
						108
						107
						106
1	1	1	-	22353-8	SCR,SHLD(Ø.187x.25)DRAG LEVER	105
						104
1	1	1	-	21009-2	SCR,SKT SET(1/4-20x.25 LW)RAM	103
2	2	2	-	21017-2	SCR,DRIVE(#2x.19)ID PLATE	102
						101
1	1	1	-	461264-1	PLATE, IDENTIFICATION	100
2	2	2	-	5-21006-6	SCR,SET(10-32x.75)DRAG	99
1	1	1	-	22733-8	SCR,BHC(8-32x.38 LW)ANVIL	98
4	4	4	-	2-21002-9	SCR,BHC(10-32x.50)CAP	97
3	3	3	-	2-22733-8	SCR,BHC(1/4-20x.62)HSG	96
1	1	1	-	2-21002-7	SCR,BHC(10-32x.50)SG ADJ BLK	95
4	4	4	-	2-21002-2	SCR,BHC(8-32x.50)TERM H DWN	94
2	2	2	-	2-21002-4	SCR,BHC(8-32x.75)R STP GDE	93
						92
						91
						90
						89
						88
						87
1	1	1	-	2-21002-0	SCR,BHC(8-32x.25)FEED FINGER	86
2	2	2	-	1-21000-3	SCR,SHC(4-40x.25)FR ST GUIDE	85
1	1	1	-	2-21000-7	SCR,SHC(8-32x.50)STRIPPER	84
						83
						82
1	1	1	-	3-21000-4	SCR,SHC(10-32x.38)SG ADJ BL	81
						80
						79
						78
						77
						76
						75
1	1	1	-	690603-1	SPRING, ASSIST	74
1	1	1	-	23030-1	SCR,SHC(6-32x.25 SL)INS DISC	73
1	1	1	-	3-21001-4	SCR,SHC(3/8x.88)FEED MT	72
1	1	1	-	459610-3	MOUNT, FEED BRACKET	71
-3	-2	-1	U/M	PART NO	DESCRIPTION	ITEM NO
						70
						69
						68
						67
						66
						65
						64
						63
						62
						61
						60
						59
						58
						57
						56
						55
						54
1	1	1	-	461062-1	FEED FINGER ASSY	53
						52
						51
						50
						49
						48
						47
						46
						45
1	1	1	-	690191-1	PLUG, NYLON	44
1	1	1	-	1-819307-0	RAM	43
1	1	1	-	690125-1	WASHER, LAMINATED	42
1	1	1	-	690124-6	WASHER, RAM	41
1	1	1	-	7-21002-9	BOLT, CRIMPER(5/16x1.00)	40
1	1	1	-	23241-6	BALL, STEEL	39
1	1	1	-	690170-1	SPRING, COMPRESSION	38
1	1	1	-	1-690142-1	DISC, INSULATION	37
1	1	1	-	354777-1	WIRE DISC, PLASTIC	36
1	1	1	-	22480-5	WASHER, SPRING	35
1	1	1	-	690212-1	POST, RAM	34
1	1	1	-	690786-3	SUPPORT, TERMINAL	33
1	1	1	-	455675-1	PLATE, BASE	32
1	1	1	-	690432-3	SCREW, ADJUSTMENT	31
						30
1	1	1	-	455689-1	BLOCK, STRIP GUIDE ADJ	29
1	1	1	-	458144-1	PLATE, STRIP GUIDE	28
1	1	1	-	1-455888-6	SPACER, FRONT SHEAR DEP	27
2	2	2	-	1-22284-0	SPRING, DRAG	26
1	1	1	-	356835-1	LEVER, DRAG RELEASE	25
1	1	1	-	240792-1	DRAG, TERMINAL	24
1	1	1	-	4-90765-5	GUIDE, STRIP (REAR)	23
1	1	1	-	693855-8	GUIDE, STRIP (FRONT)	22
1	1	1	-	1-456468-0	STRIPPER	21
						20
						19
						18
						17
						16
						15
						14
						13
1	1	1	-	3-22280-3	SPRING, SHEAR	12
1	1	1	-	690461-1	STOP, SHEAR	11
1	1	1	-	690459-9	HOLDER, SHEAR (FRONT)	10
1	1	1	-	454276-4	SHEAR, FLOAT (FRONT)	9
1	1	1	-	9-662520-5	ANVIL	8
						7
						6
1	1	1	-	1-455888-6	SPACER, CRIMPER	5
1	1	1	-	2-455889-1	DEPRESSOR, SHEAR (FRONT)	4
1	1	1	-	1-238011-2	SPACER, BLOCK CRIMPER	3
1	1	1	-	4-683454-0	CRIMPER, INSULATION	2
1	1	1	-	455888-6	SPACER, CRIMPER	1
						0

QTY	REQD	PER	ASSY	PART NO	DESCRIPTION	ITEM NO
						129
						128
						127
						126
						125
						124
						123
						122
						121
						120
						119
						118
						117
						116
						115
						114
						113
						112
						111
						110
						109
						108
						107
						106
						105
						104
						103
						102
						101
						100
						99
						98
						97
						96
						95
						94
						93
						92
						91
						90
						89
						88
						87
						86
						85
						84
						83
						82
						81
						80
						79
						78
						77
						76
						75
						74
						73
						72
						71
						70
						69
						68
						67
						66
						65
						64
						63
						62
						61
						60
						59
						58
						57
						56
						55
						54
						53
						52
						51
						50
						49
						48
						47
						46
						45
						44
						43
						42
						41
						40
						39
						38
						37
						36
						35
						34
						33
						32
						31
						30
						29
						28
						27
						26
						25
						24
						23
						22
						21
						20
						19
						18

Mouser Electronics

Authorized Distributor

Click to View Pricing, Inventory, Delivery & Lifecycle Information:

[TE Connectivity:](#)

[1852016-1](#)