

NUMBER C-179464

三角度 (3-ANGLE PROJECTION)

METRIC

PRINT DIM. DIMENSIONS IN MM. DO NOT SCALE PRINT

PRINT DIST.

- 注:
1. 通用製品規格: 108-5410
  2. 通用コンタクト型番  
タブ・コンタクト: 177917-□ (#20-#16AWG)  
177916-□ (#26-#22AWG)
  3. 嵌合相手側製品型番  
プラグ・ハウジング: 177899-□  
リセ・コンタクト: 177915-□ (#20-#16AWG)  
177914-□ (#26-#22AWG)
  4. 通用プレート型番: 177919-□
  5. 取扱説明書: 411-5638
- 表1参照
8. PART 5-179464-1 COMPLY WITH GLOW WIRE REQUIREMENT FOR PARTS OF NON-METALLIC MATERIAL SUPPORTING A CURRENT-CARRYING CONNECTION DETAILED IN IEC 60335-1, SECTION 30 (GWT)
  9. APPLICATION SPEC: 114-5175



表1 (TABLE 1)

トレードマーク (TRADE MARK)	生産場所 (MANUFACTURING PLACE)
— AMP OR AMP	日本 (JAPAN)
—+ AMP OR AMP	中国 (CHINA(PO))
· AMP OR AMP	韓国 (KOREA)



断面 "A"- "A"  
(SECT)

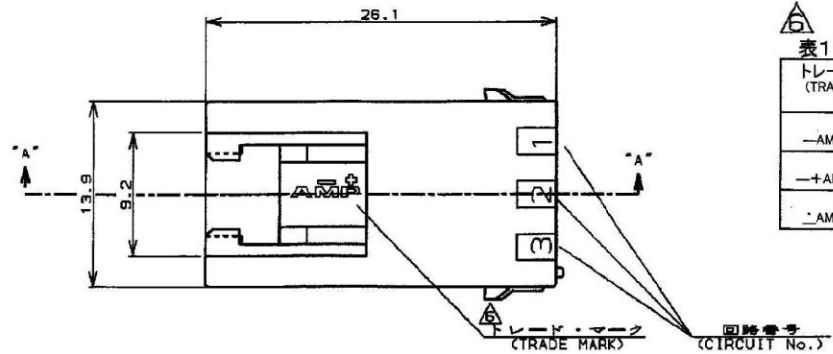
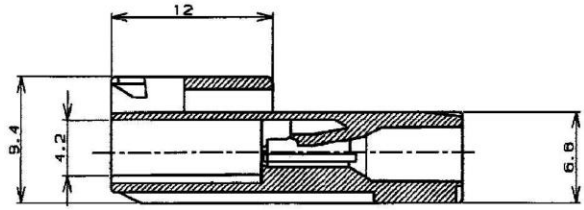
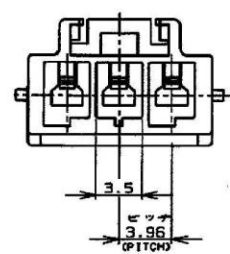
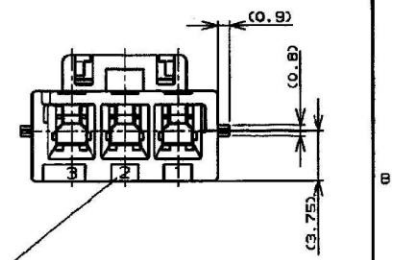

回路番号  
(CIRCUIT No.)

- NOTES,
1. PRODUCT SPEC, 108-5410
  2. APPLICABLE CONTACT P/N  
TAB CONTACT: 177917-□ (#20-#16AWG)  
177916-□ (#26-#22AWG)
  3. MATING CONN. P/N  
PLUG H56: 177899-□  
REC CONTACT: 177915-□ (#20-#16AWG)  
177914-□ (#26-#22AWG)
  4. APPLICABLE PLATE P/N: 177919-□
  5. INSTRUCTION SHEET: 411-5638
  6. SEE TABLE 1
  7. ALL PARTS MEET RTI ELECTRICAL RATING OF 105C ACCORDING TO UL 1977

自然色 (NATURAL)	3	5-179464-1
黒 (BLACK)	↑	↑ -9
青 (BLUE)	↑	↑ -6
黄 (YELLOW)	↑	↑ -4
赤 (RED)	↓	↓ -2
自然色 (NATURAL)	3	179464-1
ハウジング色調 係数 (HOUSING COLOR) [Pos.]		型番 (P/N)

適合電線範囲 (WIRE RANGE)		絶縁径 (INSULATION DIA.)		名称 (NAME)	
— 絶径 (AWG) —		— 絶径 (mm) —		アンパ パワー ダブルロック コネクタ	
C4 REVISED PER ECR-19-017851 SM DZ 21NOV 2019		C3 REVISED PER ECR-14-001994 A.Z D.Z 11FEB '14		3極 3.96mmピッチ キャップ ハウジング (直吊りタイプ)	
C3 REVISED PER ECR-12-013854 A.Z F.M 02AUG '12		C2 REVISED PER ECR-12-013854 A.Z F.M 02AUG '12		AMP POWER DOUBLE LOCK CONN. 3.96mm PITCH CAP HOUSING 3 Pos OF RES HANGING	
C1 REVISED PER ECO-11-005140 RK HMR 01MAR '11		LTR 変更 (REVISION RECORD) DR CHK DATE		一般公衆	
DR. 23.MAR.'94 M. SUZUKI		CHK. 25.MAR.'94 M. SHINDO		SIZE LOC 番号 (No.)	
DE. 23.MAR.'94 M. SUZUKI		APP. 25.MAR.'94 Y. KASHIWA		A3 J C-179464	
				10mm: ±0.2 10mm以下: ±0.25 30mm以下: ±0.3 30mm以上: ±0.5	
				尺度 (SCALE) REV. C4 SHEET 1 OF 1	

CUSTOMER DRAWING

# Mouser Electronics

Authorized Distributor

Click to View Pricing, Inventory, Delivery & Lifecycle Information:

[TE Connectivity:](#)

[179464-6](#)