

DO NOT SCALE

DIMENSIONS IN mm

METRIC

THIRD ANGLE  
PROJECTION

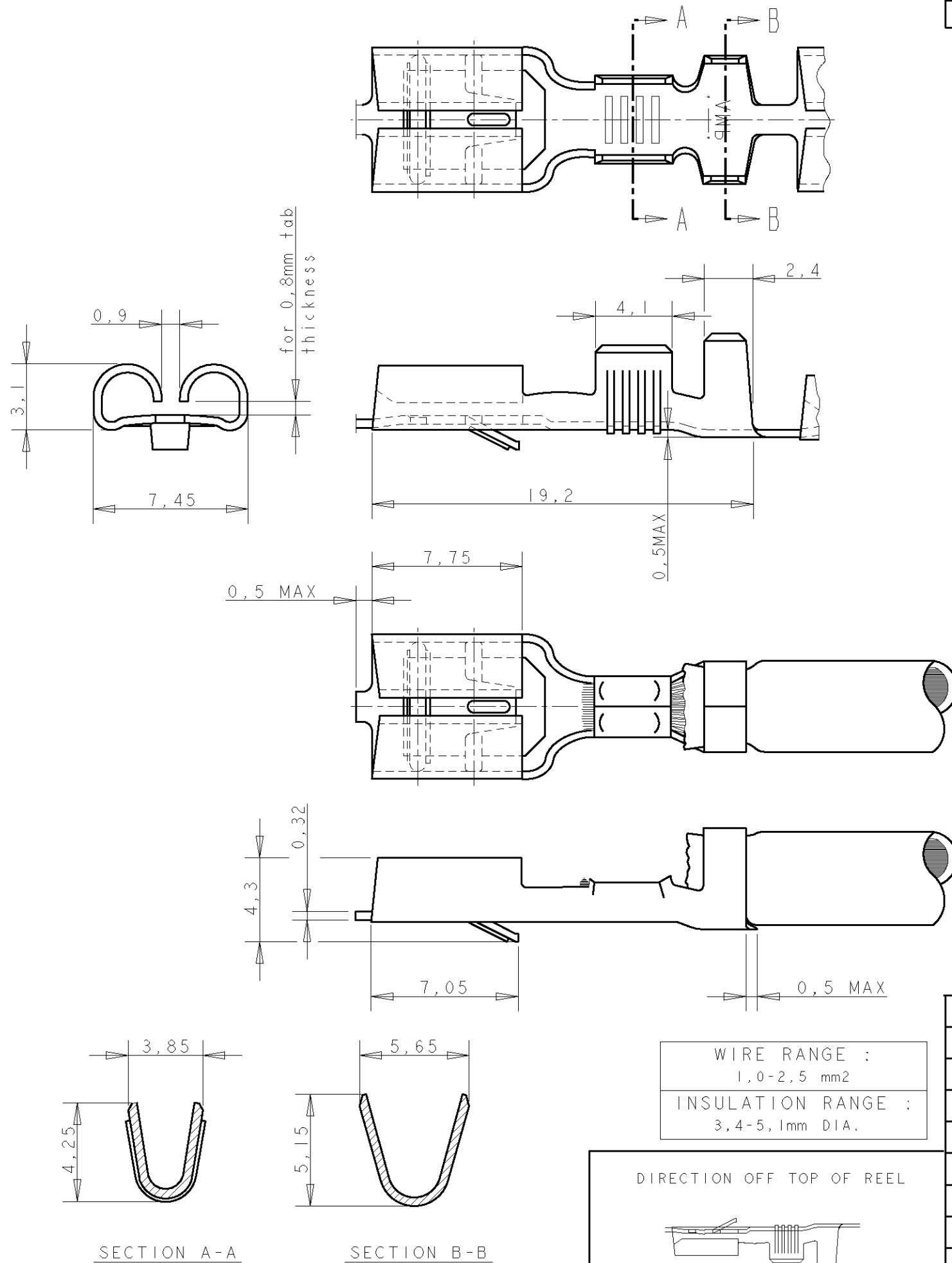
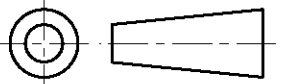

NOTES

- 1 FOR USE ON MINIATURE APPLICATORS ( LEFT-RIGHT FEED ) AND STANDARD APPLICATORS ( RIGHT-LEFT FEED ).
- 2 FOR USE ON MINIATURE APPLICATORS ( AMP-O-MATOR APPLICATION ). ( LEFT-RIGHT FEED ).
- 3 OBSOLETE PARTS: OBSOLETE CIS STREAMLINING PER D.RENAUD/D.SINISI

GENERAL TOLERANCES  $\pm 0.3$

NOTES	FINISH	MATERIAL	PARTNUMBER
1	PRE-TINPLATED	PH.BRONZE	6-160448-8
1	PRE-TINPLATED	BRASS	6-160448-7
1/2	SILVERPLATED	BRASS	6-160448-6
1	TINPLATED	BRASS	6-160448-5
1	SILVERPLATED	PH.BRONZE	6-160448-3
1	TINPLATED	PH.BRONZE	6-160448-2
1	UNPLATED	PH.BRONZE	6-160448-1
1	UNPLATED	BRASS	6-160448-0

CUSTOMER DRAWING				FOR REFERENCE ONLY WILL NOT BE UPDATED	
THIS DRAWING IS UNPUBLISHED RELEASED FOR PUBLICATION					
<b>STE</b> TE Connectivity					
NAME .250 SRS FASTIN-ON RECEPTACLE.					
K2	REVISED PER ECO-11-005140	RK	HMR	19APR11	
LTR.	REVISION RECORD	DR.	CHK.	DATE	
DR.:	J.v.LIEMPT.	CHK.:	A.BIJNEN.	APP.:	L.v.SOEST.
DATE:	23 MAR 1992	DATE:	-	DATE:	-
DWG.No. C-160448			REV.LTR. K2	SHEET 1 OF 1	A3

# Mouser Electronics

Authorized Distributor

Click to View Pricing, Inventory, Delivery & Lifecycle Information:

[TE Connectivity:](#)

[6-160448-3](#)