

PART NUMBER	REV	FIRST USED
1385033-1	B	122500-1
1385033-2	B	565435-5

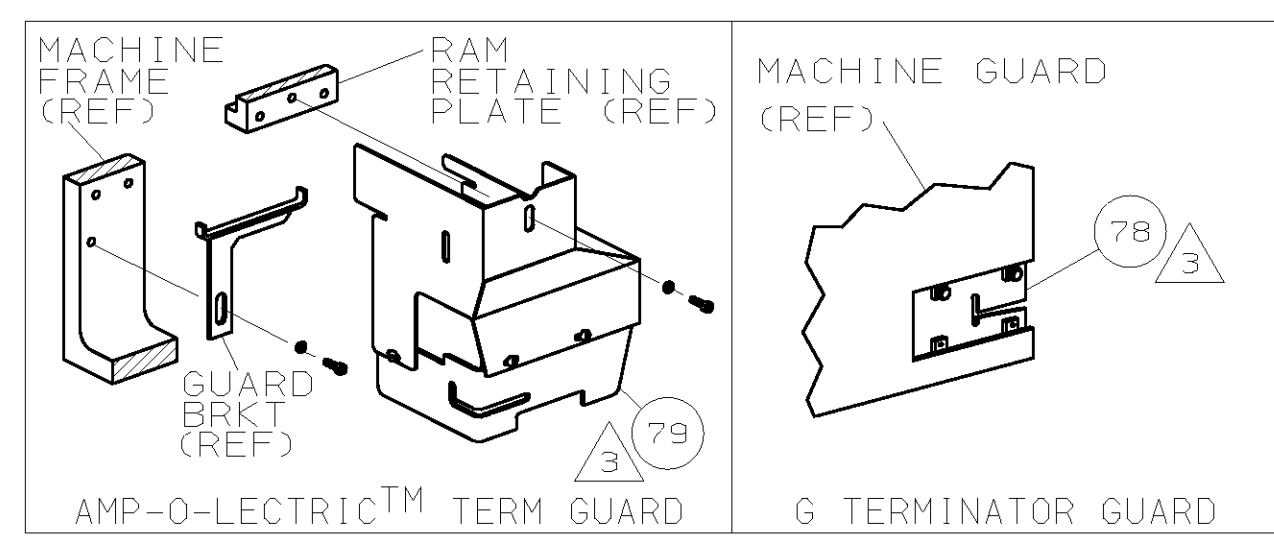

TERMINAL NAME: .250 SERIES FLAG FASTON RECEPTACLE			
60960-3			
PAD LTR	CRIMP HEIGHT	WIRE SIZE	
A	.101 ±.002 [2.57 ±0.05mm]	10	
B	NOT	USED	
C	NOT	USED	
D	NOT	USED	
CRIMP	SIZE	TYPE	RANGE
WIRE	.155 [3.94mm]	F	10
INSUL	-	-	-
WIRE STRIP LENGTH	TERM APPL SPEC	FEED	APPL INSTRUCTION
.190-.219	114-2079	.685	408-8039
			SET UP GAGE
			458638-1
			LAYOUT
			L2344

REV	LEADMAKER & BENCH MODEL	AIR FEED	ITEM NO
-1	BENCH MODEL G		
-2	BENCH MODEL K	AIR FEED	

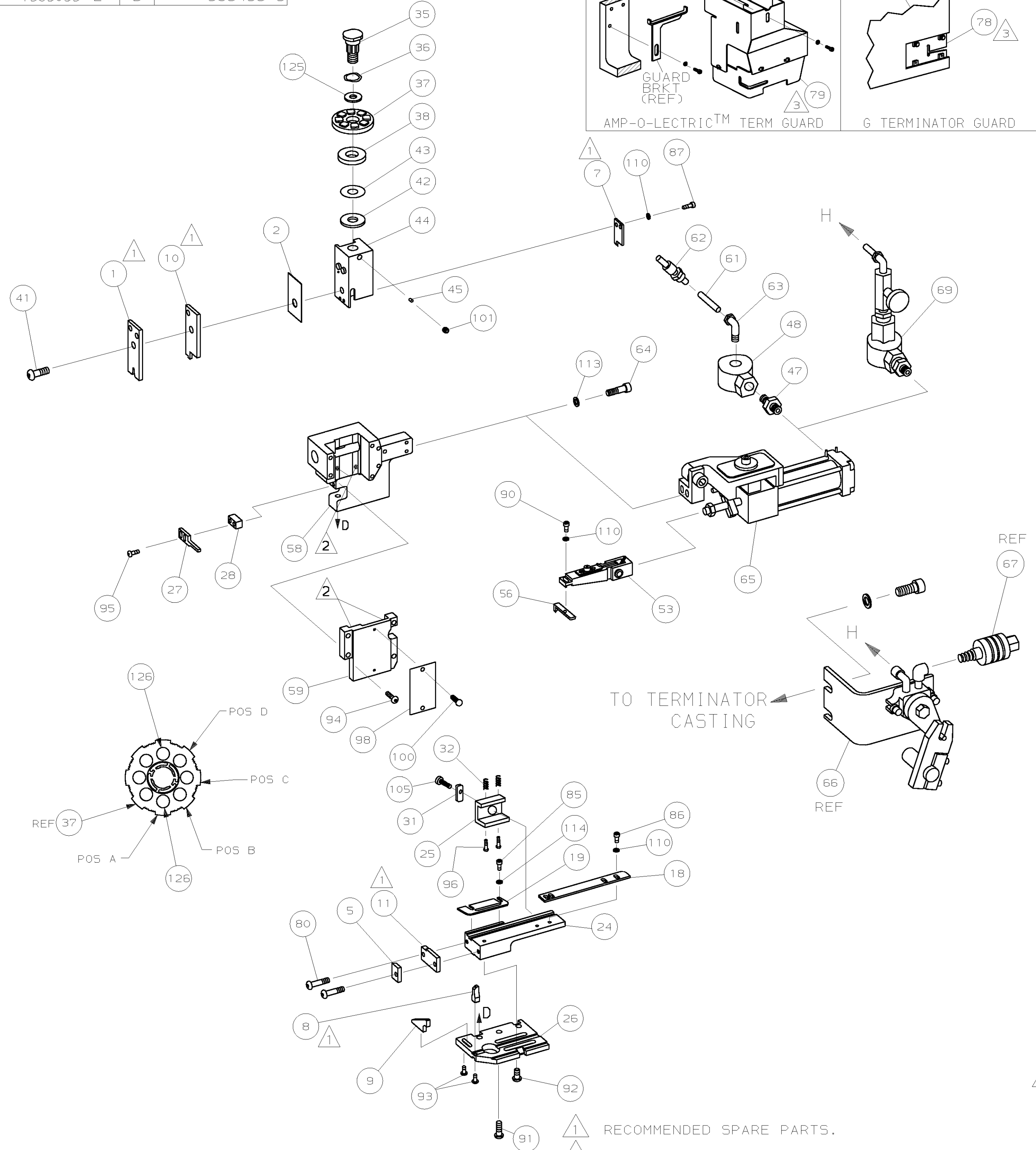

- 1 RECOMMENDED SPARE PARTS.
- 2 GREASE LIGHTLY.
- 3 GUARD MUST BE IN PLACE WHEN OPERATING APPLICATOR IN A BENCH MACHINE.
- 4 SEE DRAWING FOR COMPONENTS.
- 5 ITEM 78 USED WITH G TERMINATOR ONLY.
- 6 FEED FINGER TO GUIDE OFF OF SIDE OF ITEM 19.

QTY	REV	U/M	DWG SIZE	PART NO	DESCRIPTION	ITEM NO
129						129
128						128
127						127
2	2	-	C	3-354778-1	PIN, WIRE DISC (.2660)A	126
1	1	-	A	986950-1	WASHER, FLAT PRECISION	125
1	1	-	A	217238-1	GENERAL INSTRUCTION PACKAGE	124
1	1	-	-	4088039	EF APPL INST 408-8039	123
						122
						121
						120
						119
						118
						117
						116
						115
2	2	-	A	21024-2	WASHER, LOCK (#4) RR STR GUIDE	114
2	2	-	A	21024-5	WASHER, LOCK (#10) AIR ASSY	113
						112
						111
2	2	-	A	21024-4	WASHER, LOCK (NO. 8) FR STR GUIDE	110
						109
						108
						107
						106
1	1	-	A	22353-8	SCR, SHLD (Ø.187x.25) DRAG LEVER	105
						104
						103
						102
1	1	-	A	21009-2	SCR, SKT SET (1/4-20x.25) RAM	101
2	2	-	A	21017-2	SCR, DRIVE (#2x.19) ID PLATE	100
						99
1	1	-	B	461264-1	PLATE, IDENTIFICATION	98
						97
2	2	-	A	3-21002-0	SCR, BHC (10-32x.88) DRAG	96
2	2	-	A	2-21002-4	SCR, BHC (8-32x.75) STRIPPER	95
4	4	-	A	2-21002-9	SCR, BHC (10-32x.75) H5G CAP	94
3	3	-	A	22733-8	SCR, BHC (8-32x.38 LW) ANVIL	93
4	4	-	A	3-21002-3	SCR, BHC (1/4-20x.50) ST 6D PL	92
3	3	-	A	2-22733-8	SCR, BHC (1/4-20x.62) BASE PL	91
1	1	-	A	2-22603-1	SCR, HEX HD (8-32x.38) FEED FINGER	90
						89
						88
2	2	-	A	2-21000-5	SCR, SHC (8-32x.25) SLUG BLADE	87
2	2	-	A	2-21000-7	SCR, SHC (8-32x.50) STRIP GUIDE	86
2	2	-	A	1-21000-3	SCR, SHC (4-40x.25) STRIP GUIDE	85
						84
						83
						82
						81
2	2	-	A	2-21002-8	SCR, BHC (10-32x.62) SHEAR PL	80
REF	-	-	A	455745-8	GUARD, WINDOW	79
-	REF	-	A	679532-1	INSERT, GUARD	78
						77
						76
						75
						74
						73
						72
						71

REV	LEADMAKER & BENCH MODEL	AIR FEED	ITEM NO
70			70
69			69
68			68
67			67
66			66
65			65
64			64
63			63
62			62
61			61
60			60
59			59
58			58
57			57
56			56
55			55
54			54
53			53
52			52
51			51
50			50
49			49
48			48
47			47
46			46
45			45
44			44
43			43
42			42
41			41
40			40
39			39
38			38
37			37
36			36
35			35
34			34
33			33
32			32
31			31
30			30
29			29
28			28
27			27
26			26
25			25
24			24
23			23
22			22
21			21
20			20
19			19
18			18
17			17
16			16
15			15
14			14
13			13
12			12
11			11
10			10
9			9
8			8
7			7
6			6
5			5
4			4
3			3
2			2
1			1

QTY	REV	U/M	DWG SIZE	PART NO	DESCRIPTION	ITEM NO
-2	-1	U/M	DWG SIZE	PART NO	DESCRIPTION	ITEM NO

QTY	REV	U/M	DWG SIZE	PART NO	DESCRIPTION	ITEM NO
-2	-1	U/M	DWG SIZE	PART NO	DESCRIPTION	ITEM NO

THIS DRAWING IS A CONTROLLED DOCUMENT.
 RELEASED FOR PUBLICATION APR 5, 2000
 BY AMP INCORPORATED. ALL RIGHTS RESERVED.
 AMP 1756 REV 3-92
 LOC A
 DIST 66
 AMP 1756 REV 3-92

DIMENSIONS IN INCHES. DO NOT SCALE PRINT.
 TOLERANCES UNLESS OTHERWISE SPECIFIED:
 2 PLC DEC ±
 3 PLC DEC ±
 4 PLC DEC ±
 ANGLES ±
 SURF TEXTURE: ✓
 REMOVE BURRS, BREAK SHARP EDGES R.015 MAX

MATL - HT TR - FIN -
 DR M.HERR APP O3MAROO T.ELBIN
 CHK O3MAROO REL -
 B.HIGMAN
AMP AMP Incorporated Harrisburg, PA 17105-3608
 NAME END FEED HDM APPLICATOR MACHINE REF MINI APPL
 SCALE - DWG NO 1385033 SHEET 1 OF 1 REV B
 CASE CODE 00779 CUSTOMER AND ASSEMBLY DRAWING RESTRICTED TO

Mouser Electronics

Authorized Distributor

Click to View Pricing, Inventory, Delivery & Lifecycle Information:

[TE Connectivity:](#)

[1385033-1](#)