

 <p>WIRE RANGE</p>	 <p>Listed FILE E13288</p>	 <p>LR7189 Certified</p>
<p>16-14HD AWG SOLID OR STRANDED</p>	<p>16-14HD AWG SOLID OR STRANDED</p>	<p>16-14HD AWG SOLID OR STRANDED</p>

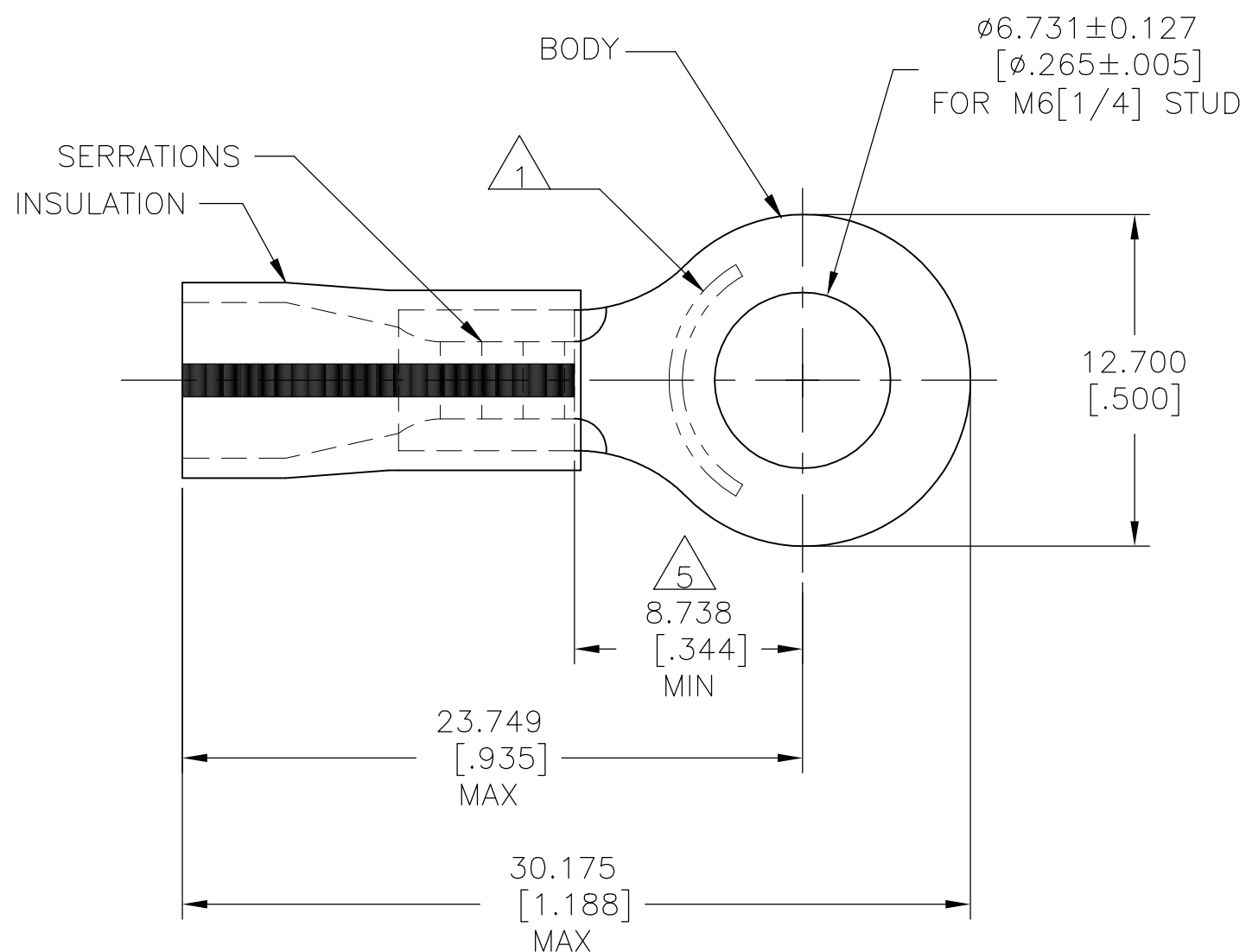

- 1 STAMP AMP 16-14HD\* APPROX AS SHOWN
- 2 WIRE INSULATION DIA:  $\phi 3.810 - \phi 6.350 [\phi .150 - \phi .250]$
- 3 BODY MATERIAL THK:  $1.219 \pm 0.051 [.048 \pm .002]$
- 4 MATERIAL:  
BODY - CU PER ASTM B152  
SLEEVE - PVC
- 5 APPLIES FROM CENTER OF STUD HOLE TO EDGE  
OF METAL WIRE BARREL

500	LOOSE PIECE	35349
QTY	PACKAGE TYPE	PART NO.

AMP INCORPORATED CUSTOMER SERVICE SYSTEMS		MAX RECOMMENDED OPERATING TEMPERATURE:  105°C[221°F]		THIS DRAWING IS A CONTROLLED DOCUMENT.		<div> <div>DWN</div> <div>DK SCHRUM</div> <div>09/29/92</div> </div> <div> <div>CHK</div> <div>RE HERSEY</div> <div>11/10/92</div> </div> <div> <div>APVD</div> <div>M BARNABA</div> <div>11/10/92</div> </div> <div> <div>PRODUCT SPEC</div> <div>UL 486 A-B</div> </div> <div> <div>APPLICATION SPEC</div> <div>114-2161</div> </div> <div> <div>WEIGHT</div> </div>		<div> <div>TE</div> <div>TE Connectivity Ltd.</div> </div>			
FOR ADDITIONAL PRODUCT INFORMATION OR COPIES OF DRAWINGS AND TECHNICAL DOCUMENTS	PRODUCT INFORMATION CENTER  1-800-522-6752		VOLTAGE RATING: N/A	<div>DIMENSIONS:</div> <div>mm [INCHES]</div>		<div>TOLERANCES UNLESS OTHERWISE SPECIFIED:</div> <div> <div>0 PLC ± -</div> <div>1 PLC ± -</div> <div>2 PLC ± -</div> <div>3 PLC ± 0.127[.005]</div> <div>4 PLC ± -</div> <div>ANGLES ± -</div> </div>		<div>NAME</div> <div> <div>TERMINAL, RING TONGUE,</div> <div>PLASTIC-GRIP,</div> <div>16-14 HD AWG</div> </div>			
FOR APPLICATION  TOOLING INFORMATION	TOOLING ASSISTANCE CENTER  1-800-722-1111		CIRCULAR MIL AREA:  1.04-2.62mm²[2,050-5,180] SOLID OR STRANDED	<div> </div>		<div>SIZE</div> <div>CAGE CODE</div> <div>DRAWING NO</div> <div>RESTRICTED TO</div>					
FOR ORDER ENTRY	1-800-526-5142	THIS DRAWING IS A CONTROLLED DOCUMENT FOR AMP INCORPORATED. IT IS SUBJECT TO CHANGE AND THE CONTROLLING ENGINEERING ORGANIZATION SHOULD BE CONTACTED FOR THE LATEST REVISION.		<div>MATERIAL</div> <div> </div>		<div>FINISH</div> <div> <div>BODY:</div> <div>TIN PER ASTM B545</div> <div>INSULATION:</div> <div>COLOR- YELLOW</div> <div>W/BLACK STRIPE</div> </div>		<div>A300779</div> <div>C-35349</div>		<div>CUSTOMER DRAWING</div> <div>SCALE</div> <div>4:1</div> <div>SHEET</div> <div>1 OF 1</div> <div>REV</div> <div>G1</div>	

# Mouser Electronics

Authorized Distributor

Click to View Pricing, Inventory, Delivery & Lifecycle Information:

[TE Connectivity:](#)

[2-35349-1](#)