

THIS DRAWING IS UNPUBLISHED. RELEASED FOR PUBLICATION
 © COPYRIGHT - By - ALL RIGHTS RESERVED.

LOC	DIST	REVISIONS					
FT	0	P	LTR	DESCRIPTION	DATE	DWN	APVD
		B2		REVISED PER ECO-13-001940	01OCT2013	KH	MB

NOTES:

MATERIAL:
 TERMINAL BLOCK: POLYAMIDE 66, UL94V-0, BLACK.
 TERMINAL: BRASS, TIN PLATED.
 SCREW: M3 STEEL, NICKEL PLATED W/ WIRE CLAMP.

ELECTRICAL:
 CURRENT RATING: 10A, 300V
 INSULATION WITHSTANDS: 2000V, MIN
 INSULATION RESISTANCE: >2000MEGA OHM, 500V

MECHANICAL:
 WIRE RANGE: 16-30AWG
 RECOMMENDED TORQUE: 10 IN-LB
 OPERATION TEMP: -40°C TO 105°C

UL RECOGNIZED PER US & CANADIAN STANDARDS.

1 PRELIMINARY NUMBER

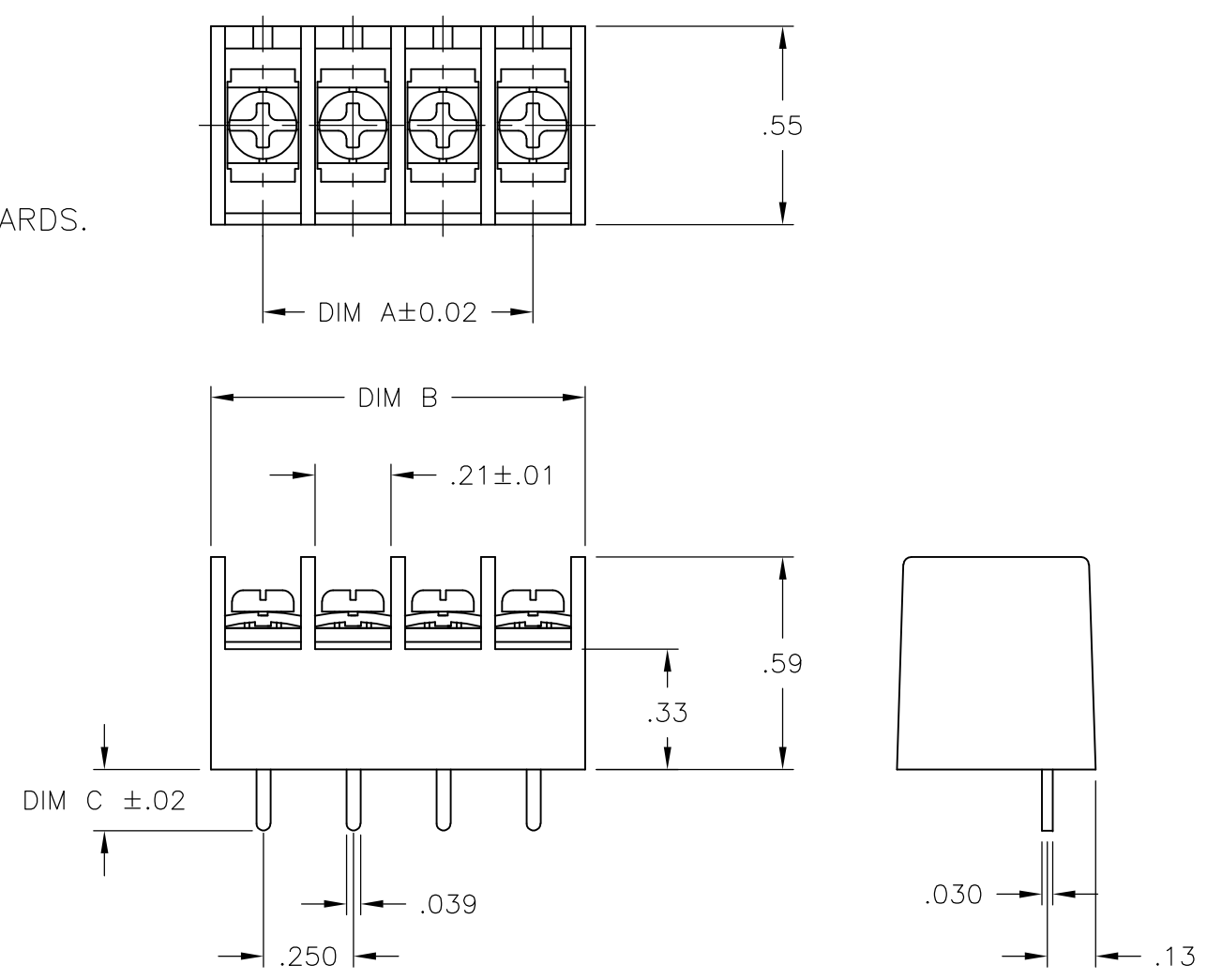

DIM C	DIM B	DIM A	# POS	PART NUMBER
.12	.54	.250	2	3-1546657-1
.17	7.54	7.250	30	3-1546657-0
.17	7.29	7.000	29	2-1546657-9
.17	7.04	6.750	28	2-1546657-8
.17	6.79	6.500	27	2-1546657-7
.17	6.54	6.250	26	2-1546657-6
.17	6.29	6.000	25	2-1546657-5
.17	6.04	5.750	24	2-1546657-4
.17	5.79	5.500	23	2-1546657-3
.17	5.54	5.250	22	2-1546657-2
.17	5.29	5.000	21	2-1546657-1
.17	5.04	4.750	20	2-1546657-0
.17	4.79	4.500	19	1-1546657-9
.17	4.54	4.250	18	1-1546657-8
.17	4.29	4.000	17	1-1546657-7
.17	4.04	3.750	16	1-1546657-6
.17	3.79	3.500	15	1-1546657-5
.17	3.54	3.250	14	1-1546657-4
.17	3.29	3.000	13	1-1546657-3
.17	3.04	2.750	12	1-1546657-2
.17	2.79	2.500	11	1-1546657-1
.17	2.54	2.250	10	1-1546657-0
.17	2.29	2.000	9	1546657-9
.17	2.04	1.750	8	1546657-8
.17	1.79	1.500	7	1546657-7
.17	1.54	1.250	6	1546657-6
.17	1.29	1.000	5	1546657-5
.17	1.04	.750	4	1546657-4
.17	.79	.500	3	1546657-3
.17	.54	.250	2	1546657-2

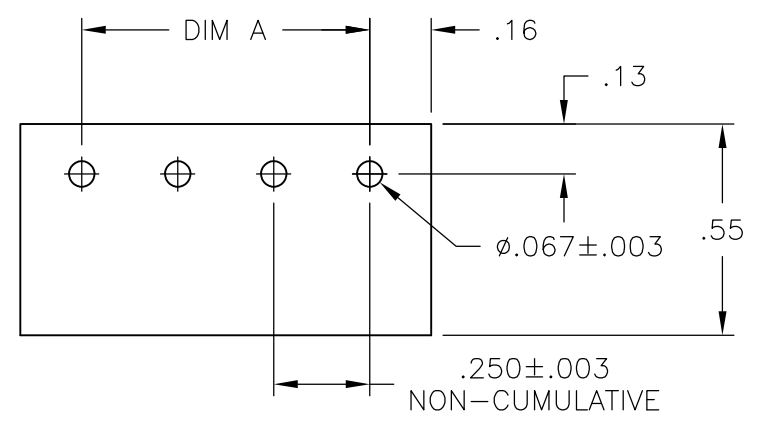

THIS DRAWING IS A CONTROLLED DOCUMENT.

DIMENSIONS: INCHES	TOLERANCES UNLESS OTHERWISE SPECIFIED:	DWN S SCHLEGEL 30MAY03	 TE Connectivity NAME TERMINAL BLOCK, .250 PITCH, DUAL BARRIER PCV STYLE				
	0 PLC ± -	CHK S YODER 5/30/03					
	1 PLC ± -	APVD S YODER 5/30/03					
	2 PLC ± .02	PRODUCT SPEC					
MATERIAL	FINISH	APPLICATION SPEC	SIZE A3	CAGE CODE 00779	DRAWING NO C-1546657	RESTRICTED TO	
		WEIGHT -	CUSTOMER DRAWING		SCALE 2:1	SHEET 1 OF 1	REV B2

Mouser Electronics

Authorized Distributor

Click to View Pricing, Inventory, Delivery & Lifecycle Information:

[TE Connectivity:](#)

[1-1546657-2](#)