

REVISIONS					
P	LTN	DESCRIPTION	DATE	DWN	APVD
A11		REVISED PER ECO-10-020914	22NOV2010	DLD	DCM
A12		REVISED PER ECO-20-012415	10SEP2020	AP	CM

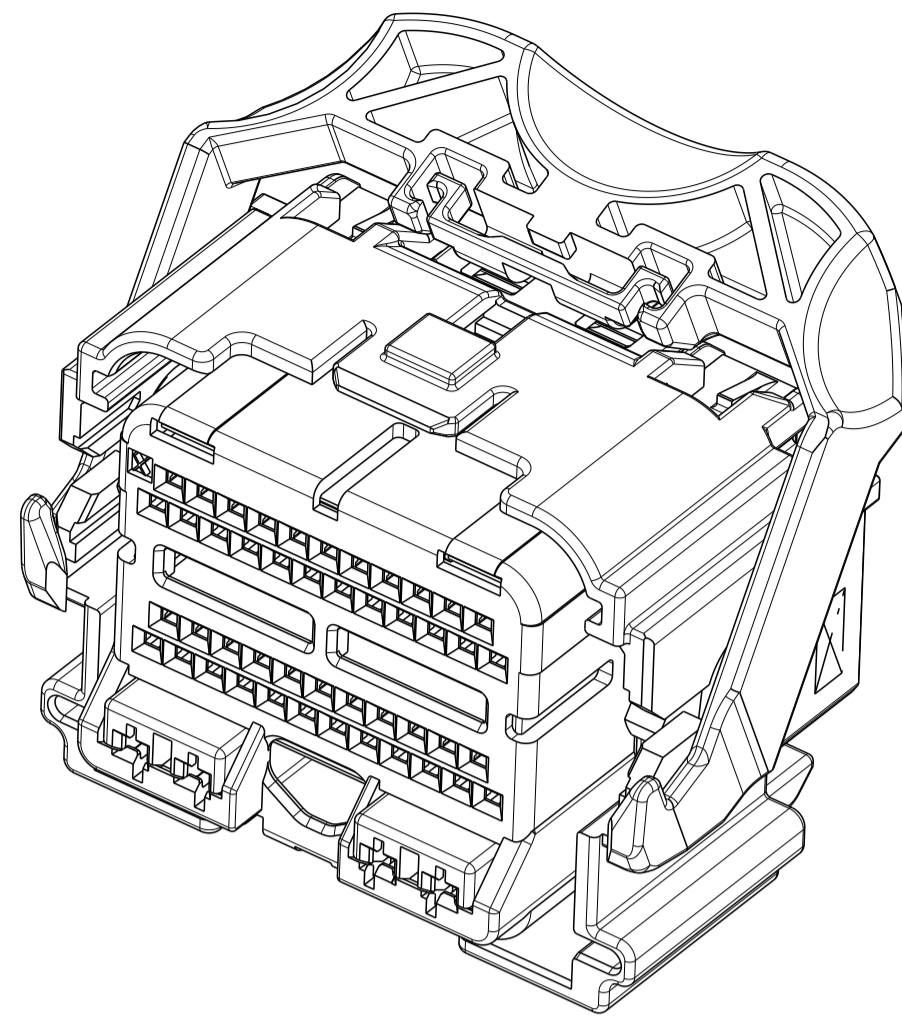

PART NUMBER:
1438693-1
SHOWN WITH SPACER
IN SEATED POSITION
SCALE 2:1

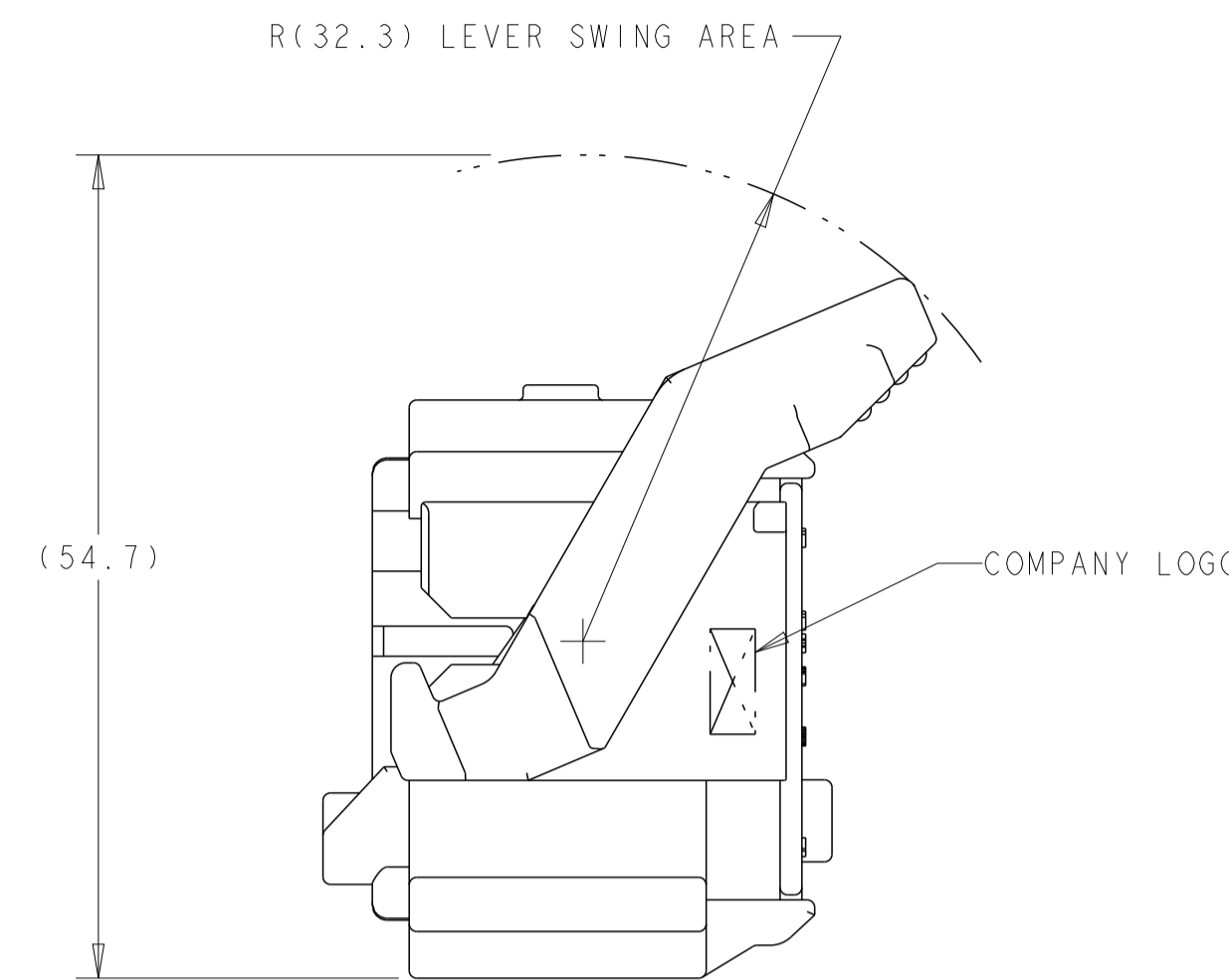
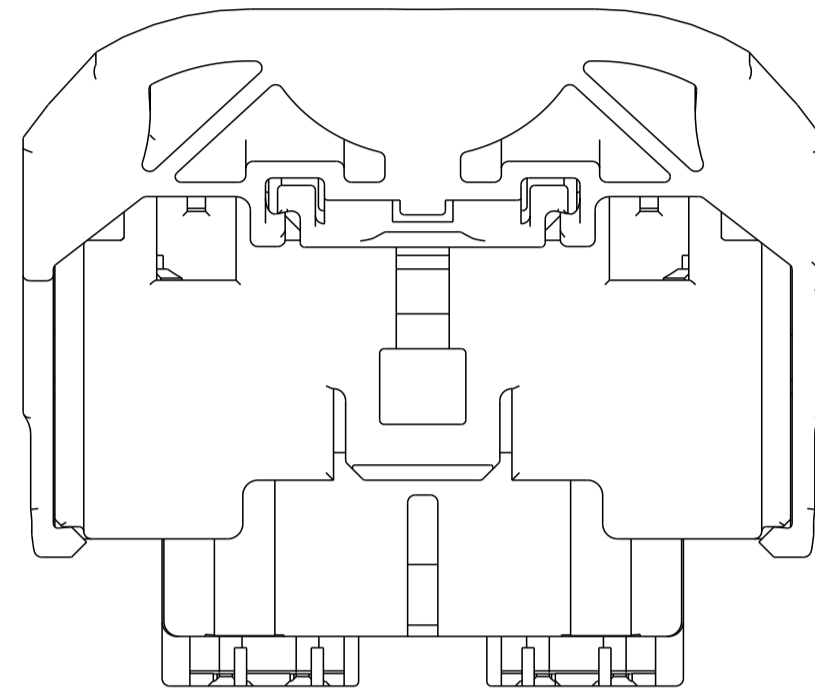

SHOWN WITH SPACER IN SEATED POSITION

PRINT TYCO ELECTRONICS PART NUMBER AND TRACEABILITY (YY : 2 DIGIT YEAR, JJJ = JULIAN DATE, HH = 2 DIGIT MILITARY HOUR CODE) IN THE LOCATION AT ASSEMBLY.

OPTIONAL WIRE SHIELD PART NUMBERS (SOLD SEPARATELY) 1438126, 1438180, 1488373, AND 1488572. CONTACT TYCO ELECTRONICS ENGINEER FOR MINIMUM FEED THRU CONDITION.

3. APPLICABLE TERMINAL PART NUMBERS (SOLD SEPARATELY)
FOR TIN APPLICATIONS: 1393367 AND 1393366.
FOR GOLD APPLICATIONS: 1393365 AND 1393364
FOR TERMINATION AND REELING OPTIONS SEE DRAWINGS 1393367, 1393366, 1393365, AND 1393364.

4. APPLICABLE MOLEX (1.5) POWER TERMINAL PART NUMBERS:
33012-0002 TIN 0.50-1.50mm²

5. CAM LEVER AND SPACER ARE SHIPPED IN THEIR PRE-ASSEMBLED POSITIONS.

OBsolete PART

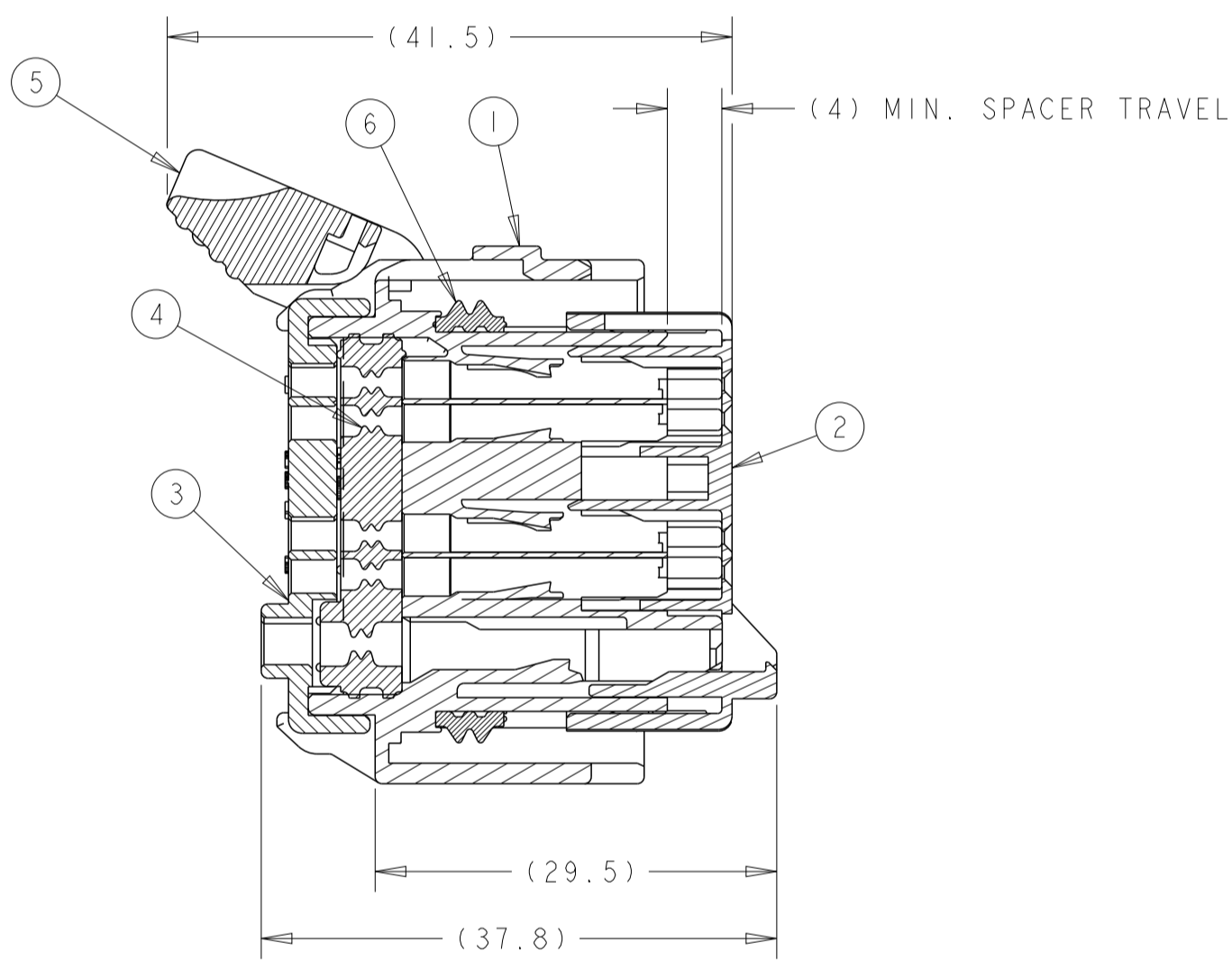

SECTION A-A
SPACER AND LEVER IN
PRE-SEATED POSITION
(DELIVERY CONDITION)

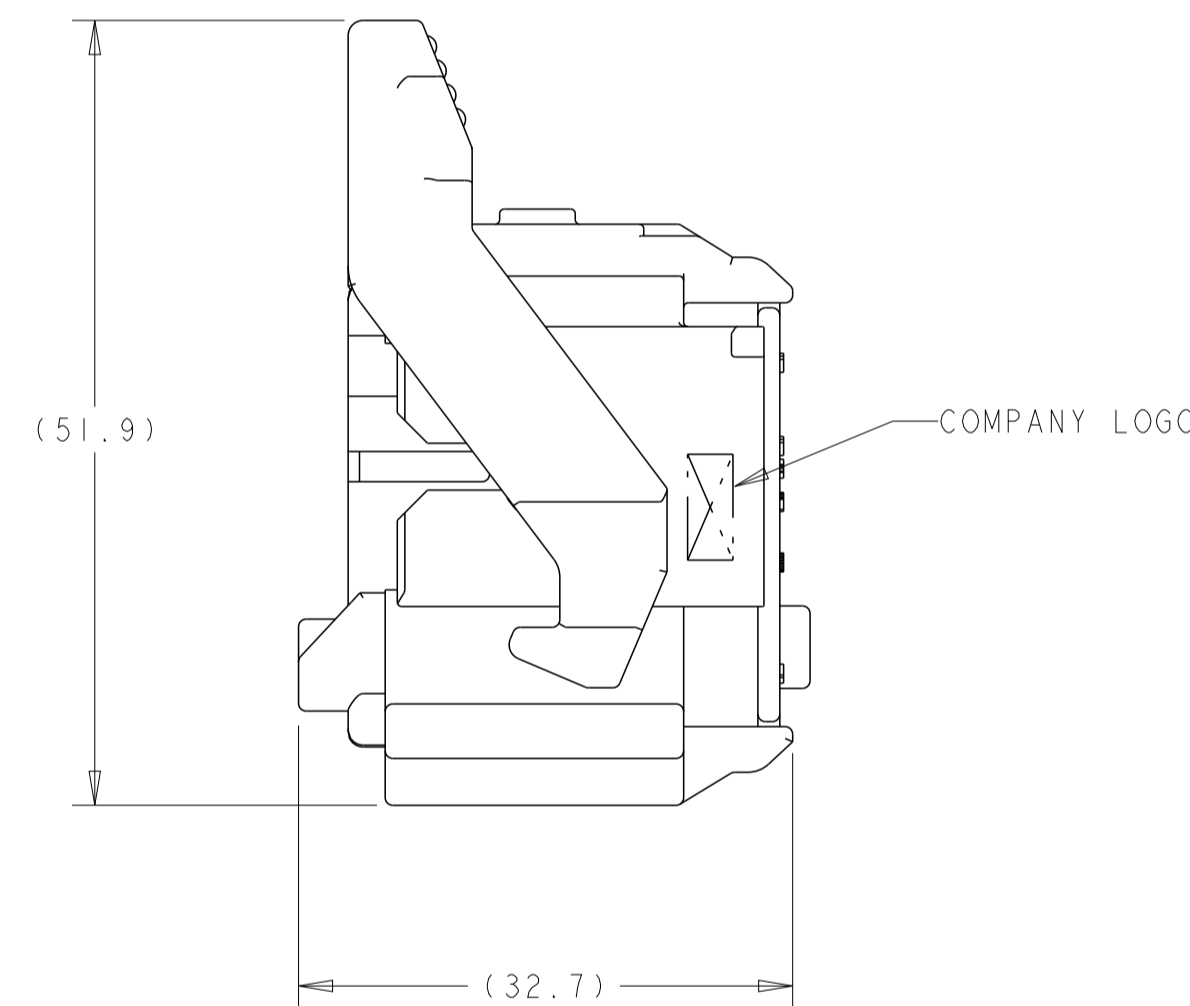
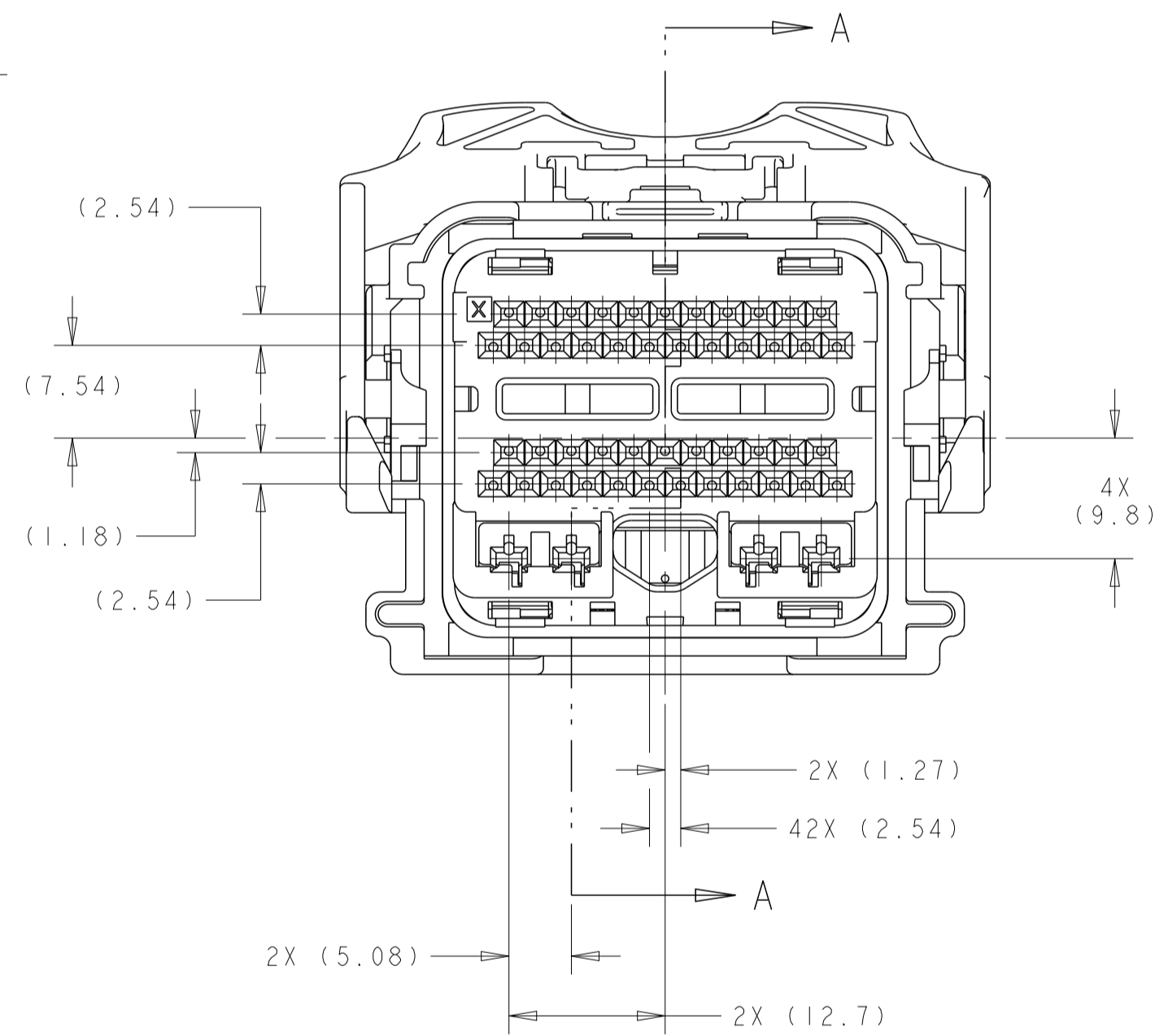

SHOWN WITH CAM
LEVER AND SPACER
IN LOADED POSITION

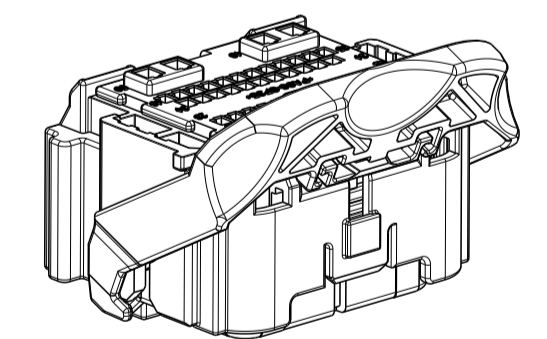
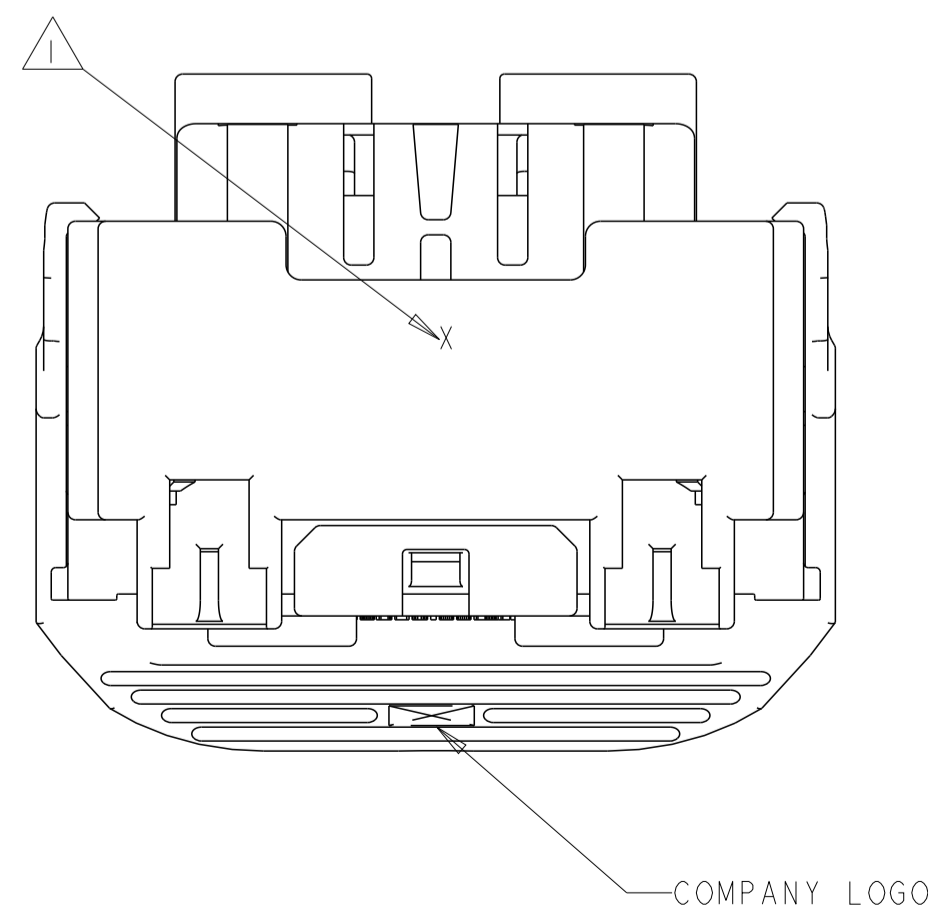

SCALE 1:1

PART COLOR	DESCRIPTION	ITEM NO.
GREEN	PERIMETER SEAL	6
GRAY	LEVER	5
BROWN	GROMMET SEAL	4
BLACK	COVER	3
NATURAL	SPACER	2
BLACK	HARNESS, KEY "C"	1

THIS DRAWING IS A CONTROLLED DOCUMENT.		DWN B. CRISAMORE 21 JUL 2004	NAME PCM
DIMENSIONS:		CHK M. HITCHCOCK 21 JUL 2004	PRODUCT SPEC
TOLERANCES UNLESS OTHERWISE SPECIFIED:		APVD C. MARTIN 21 JUL 2004	APPLICATION SPEC
mm	0 PLC ±0.3	SIZE	CAGE CODE DRAWING NO
	1 PLC ±0.10	RESTRICTED TO	
	2 PLC ±0.10	APVD	
	3 PLC ±0.10	APVD	
	4 PLC ±0.10	APVD	
	ANGLES ±1°	WEIGHT	
MATERIAL	FINISH	CUSTOMER DRAWING	SCALE 2:1 SHEET 1 OF 4 REV A12

APPLICABLE HEADER INTERFACE SPECIFICATION SHOWN WITHOUT KEYING OPTIONS

REVISIONS				
P.	LTN.	DESCRIPTION	DATE	OWN. APVD.
-	-	SEE SHEET 1	-	-

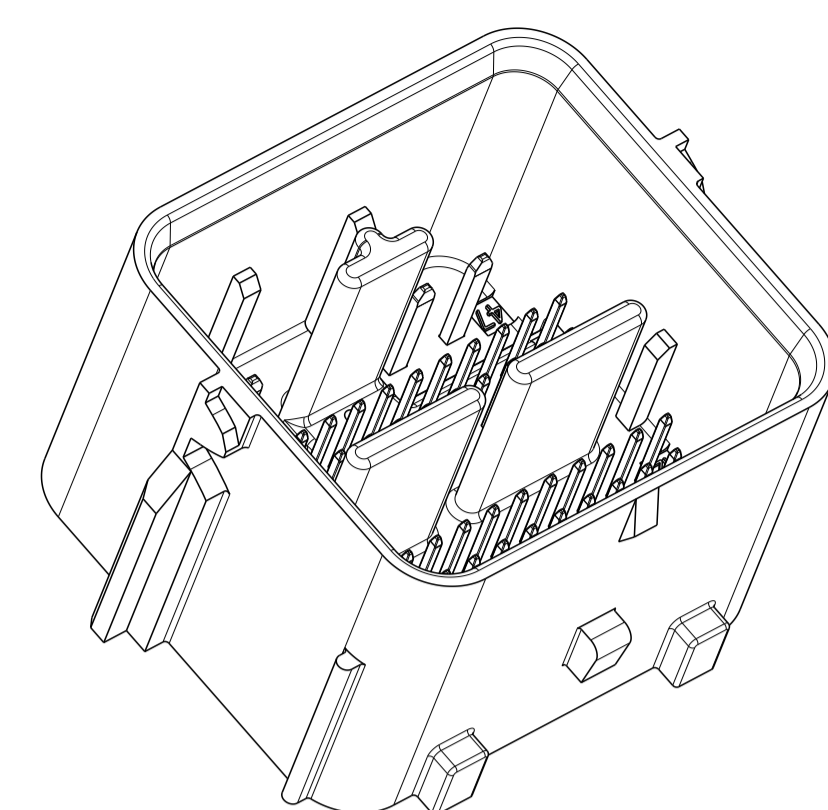
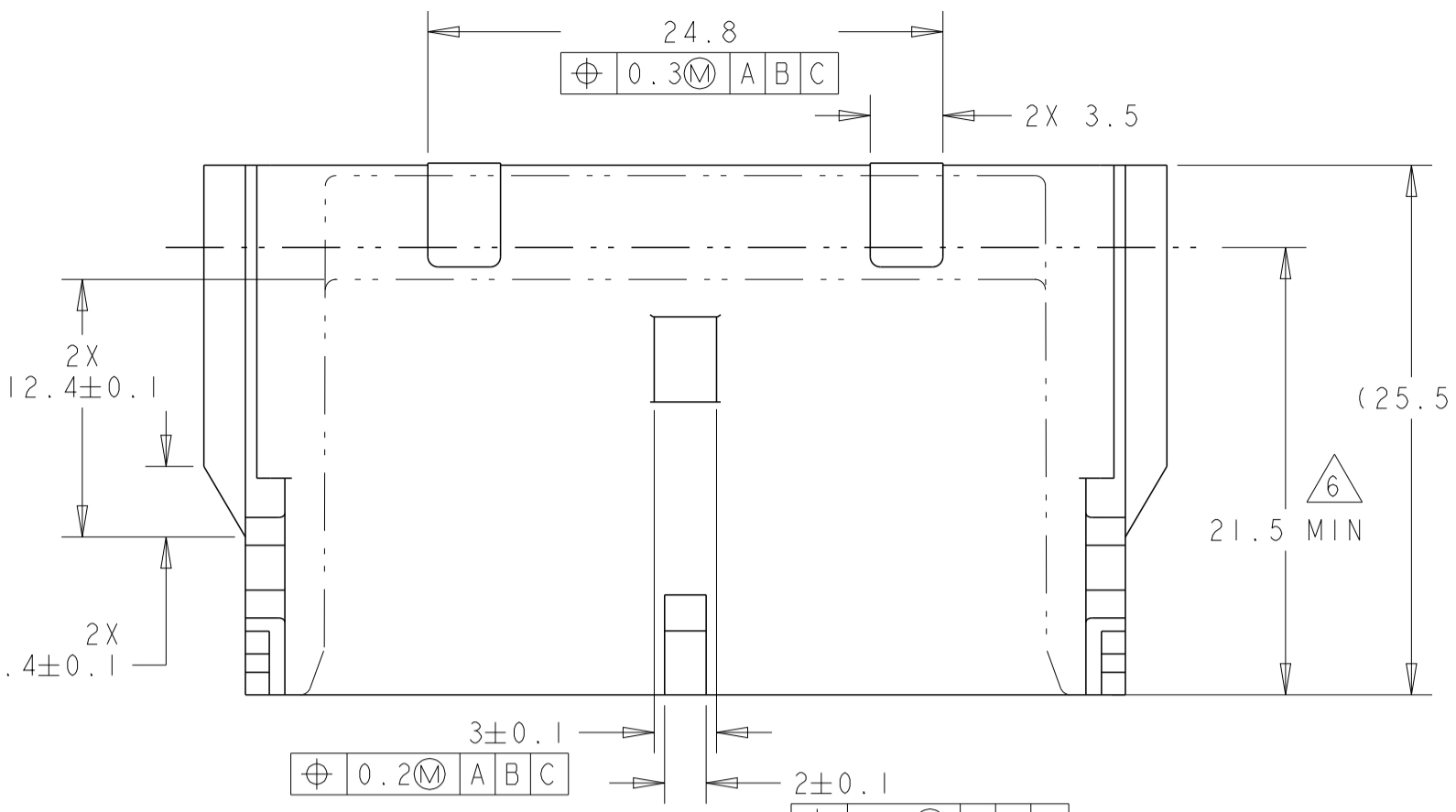
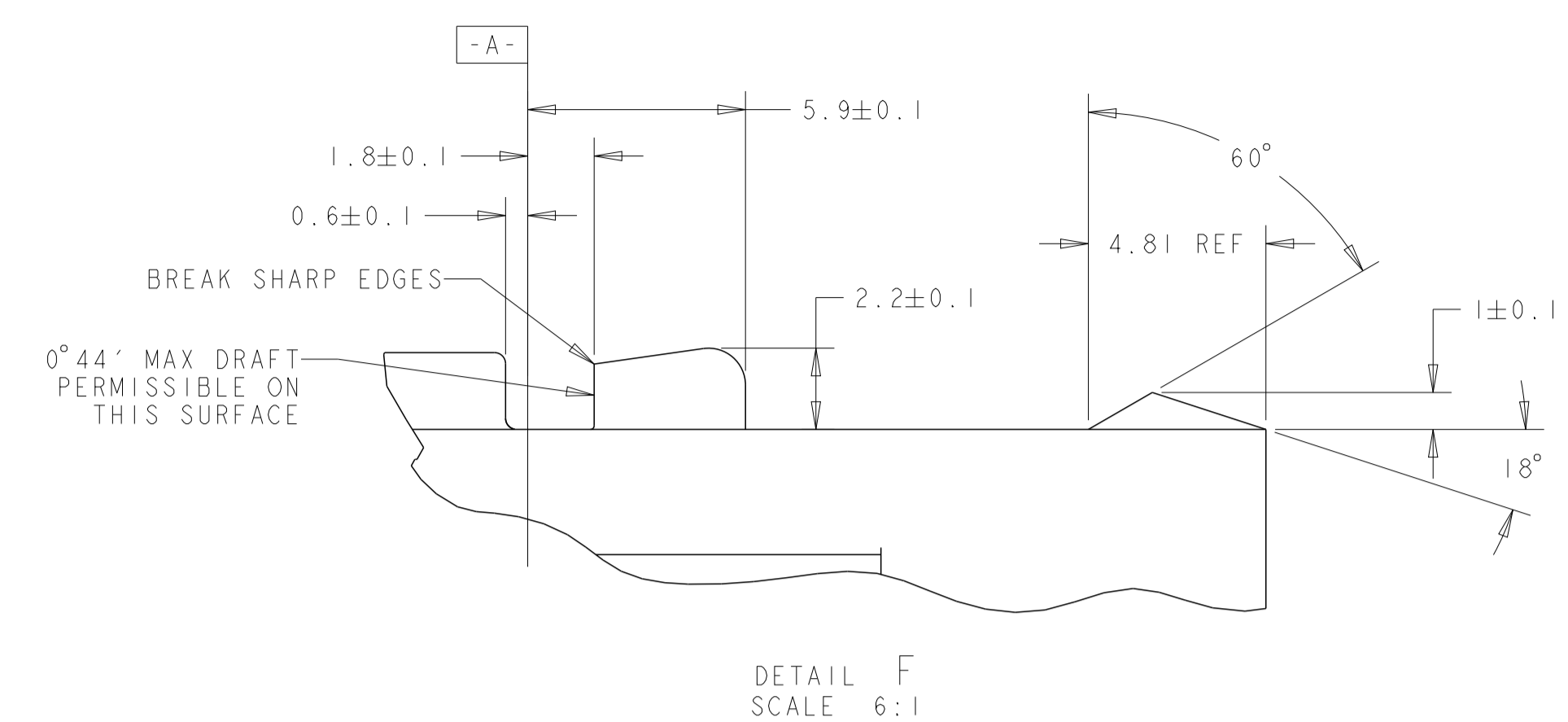

- NOTES: UNLESS OTHERWISE SPECIFIED
1. GENERAL TOLERANCE:
 ±0.3 ALL ONE PLACE DIMENSIONS
 ±0.10 ALL TWO PLACE DIMENSIONS
 ±1°00' ALL ANGULAR DIMENSIONS
 2. DRAFT ANGLE PERMISSIBLE ONLY WITHIN DRAWING TOLERANCE.
 3. SEALING SURFACE, NO WITNESS LINES OR DAMAGE PERMITTED.
 4. ALL UNMARKED RADII TO BE 0.5 MAX., UNLESS OTHERWISE SPECIFIED.
 5. VENT HOLE SIZE AND LOCATION IS OPTIONAL.
 6. THIS AREA TO REMAIN CLEAR FOR THE HARNESS ASSEMBLY.
 7. TERMINAL POSITION IDENTIFICATION.

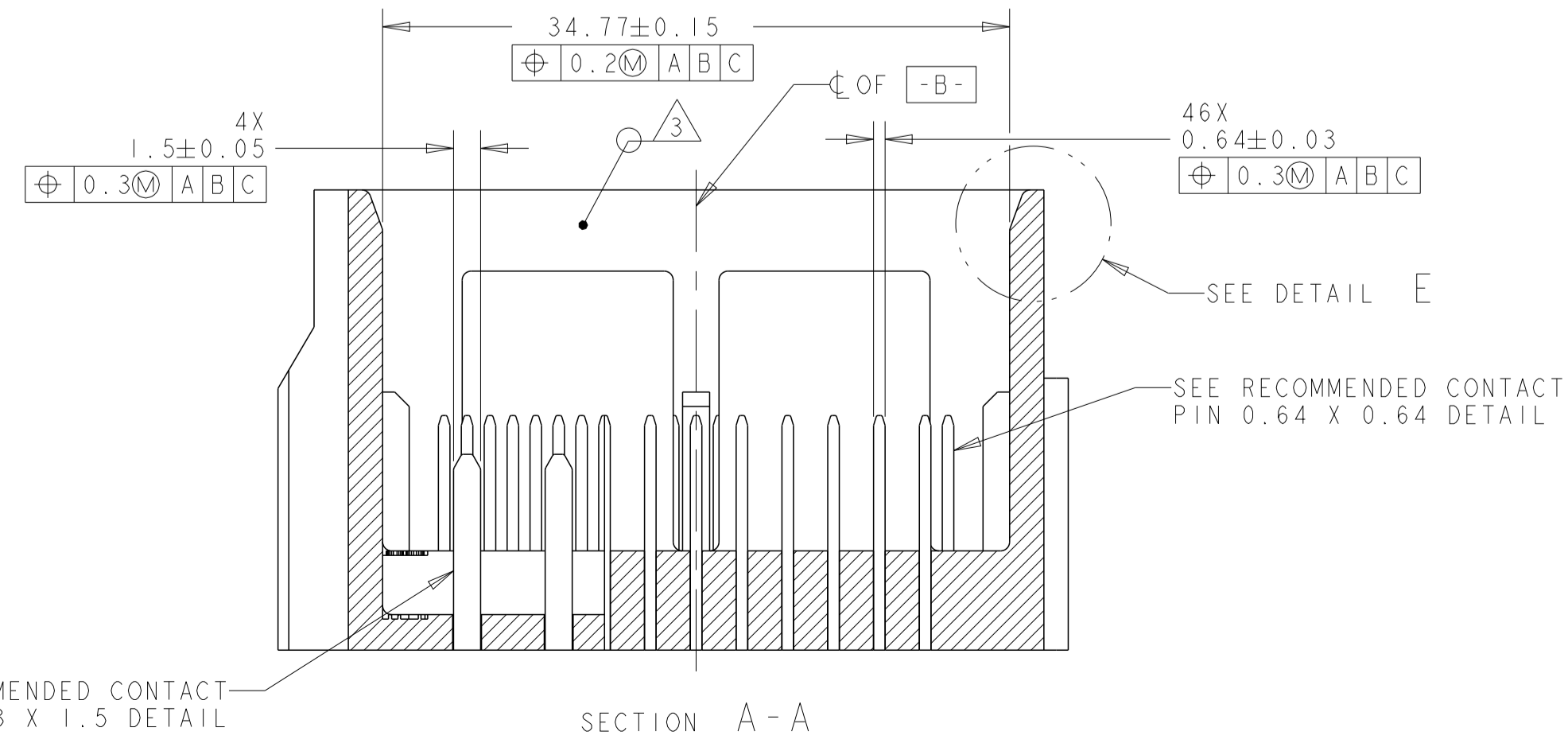
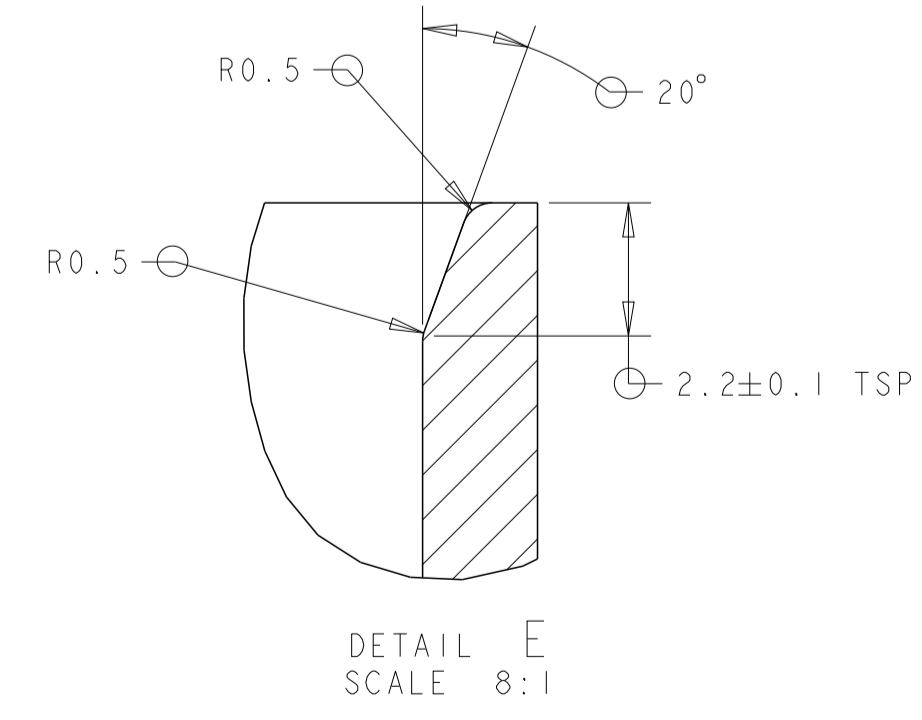
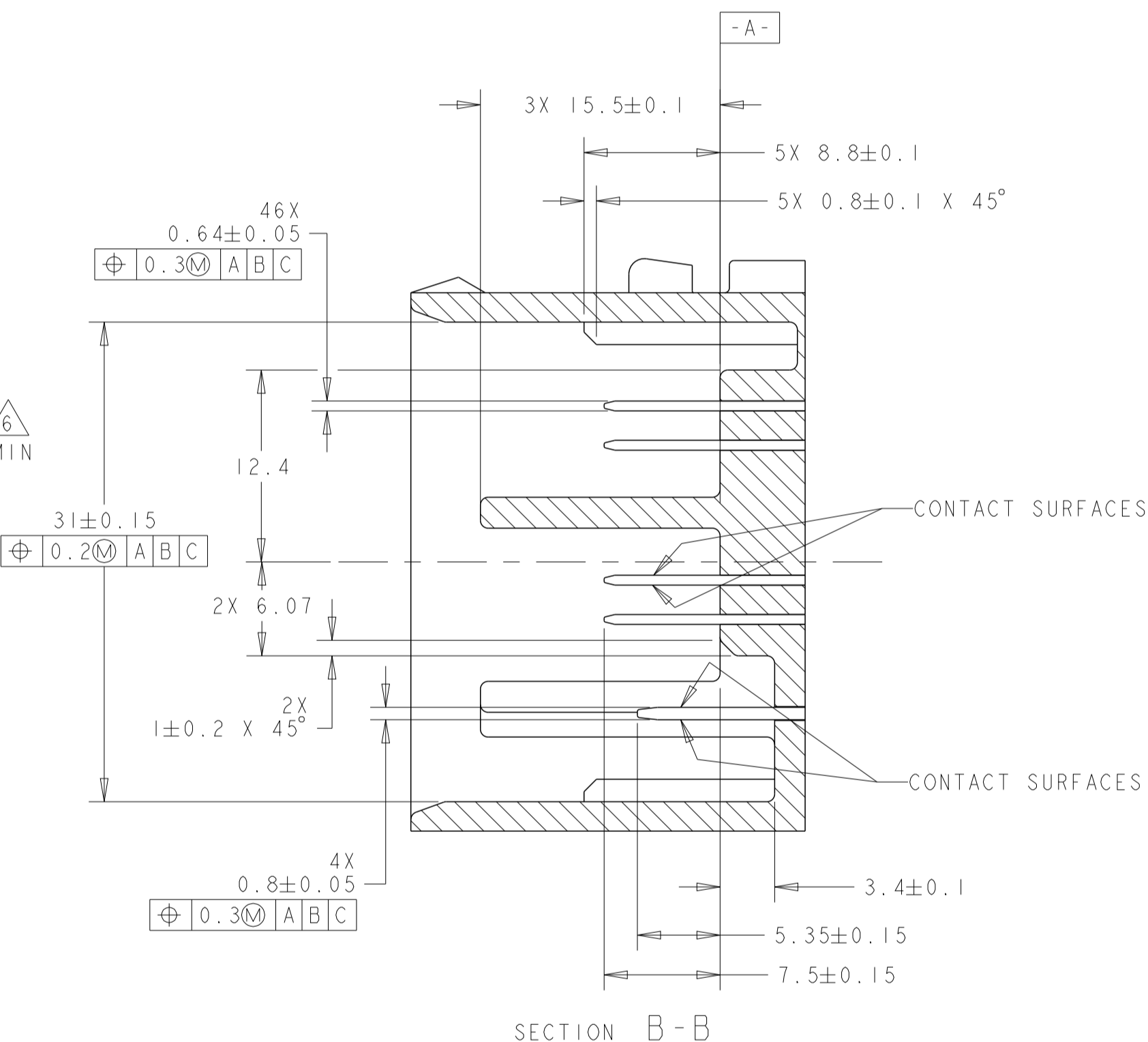
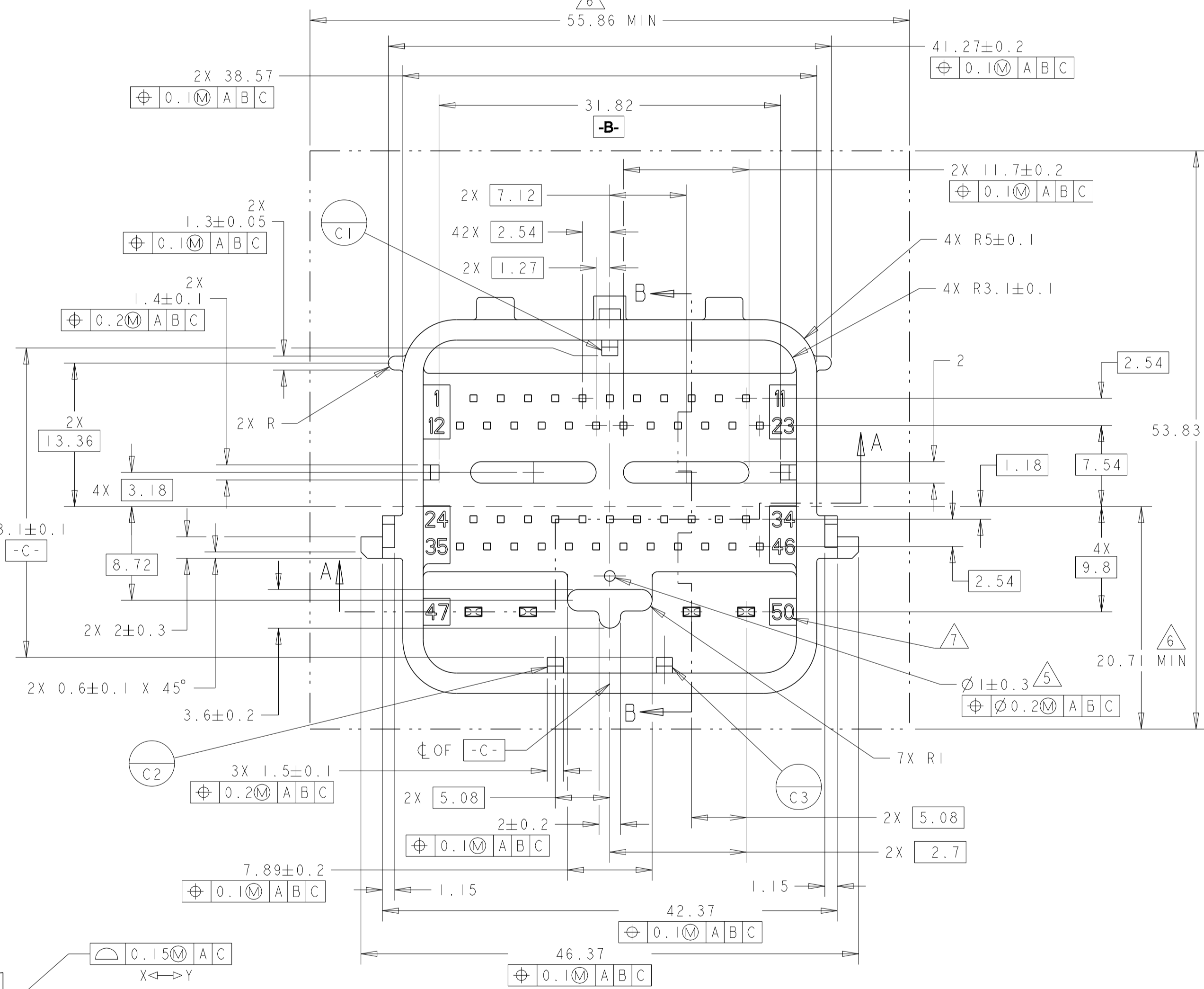
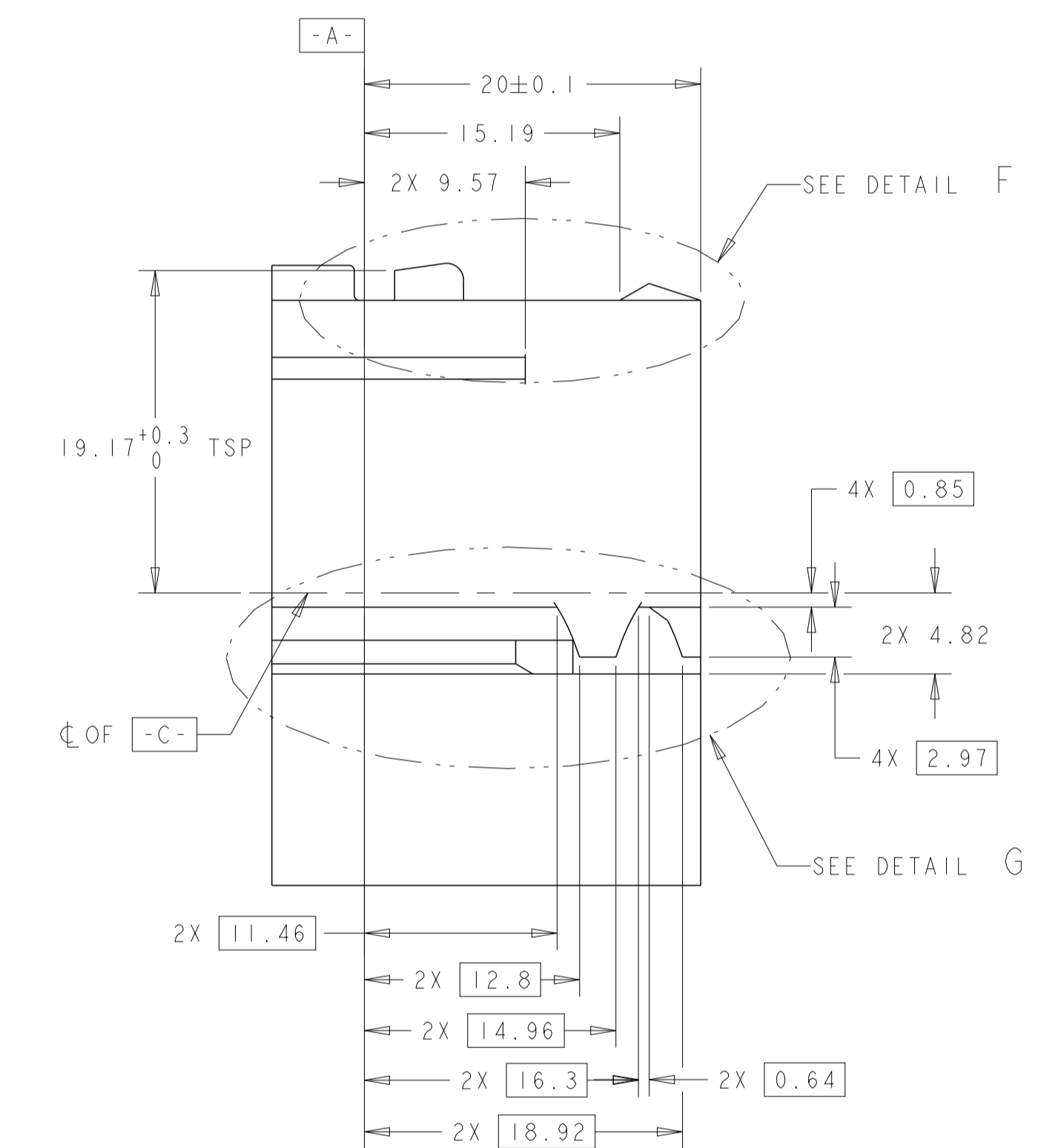

THIS DRAWING IS A CONTROLLED DOCUMENT.		OWN: B. CRISAMORE 21 JUL 2004	NAME: PCM 50-WAY HARNESS ASSEMBLY KEY C
DIMENSIONS:		CHK: M. HITCHCOCK 21 JUL 2004	
mm	TOLERANCES UNLESS OTHERWISE SPECIFIED:	APVD: C. MARTIN 21 JUL 2004	SIZE: CAGE CODE: DRAWING NO: A100779C=1438693
Ø	0 PLC ±0.3	PRODUCT SPEC:	RESTRICTED TO:
	1 PLC ±0.3	APPLICATION SPEC:	
	2 PLC ±0.10		
	3 PLC ±0.10		
	4 PLC ±0.10		
	ANGLES ±1*		
MATERIAL:	FINISH:	WEIGHT:	CUSTOMER DRAWING
			SCALE 2:1 SHEET 2 OF 4 REV A12

REVISIONS				
P. LTR.	DESCRIPTION	DATE	OWN	APVD
-	SEE SHEET 1	-	-	-

		48	47	46	45	44	43	42	41		39	38	37	36	35		33	32	31	30	29	28		26	25	24	23	22	21	20	19	18				14	13	12			9	8	7		5	4	3		1	3-1438693-2
		48			45	44	43	42	41		39	38	37	36	35		33	32	31	30	29	28		26	25	24	23	22	21	20	19	18				14	13	12			9	8	7		5	4	3		1	3-1438693-1
		48	47	46	45	44	43	42	41		39	38	37	36	35		33	32	31	30	29	28		26	25	24	23	22	21	20	19	18				14	13	12		10	9	8		5	4	3		1	3-1438693-0 $\frac{8}{\Delta}$	
		48	47	46	45	44	43		41		39	38	37	36	35		33	32	31	30	29		26				22	21	20	19	18				14	13	12		10	9			5	4			1	2-1438693-9		
		48	47	46	45	44	43		41		39	38	37	36	35		33	32	31	30	29		26				22	21	20	19	18				14	13	12		9		7		5	4			1	2-1438693-8		
		48	47	46	45	44	43	42	41		39	38	37	36	35		33	32	31	30	29		26				22	21	20	19	18				14	13	12		9	8			5	4	3		1	2-1438693-7 $\frac{8}{\Delta}$		
		48	47	46	45	44	43	42	41		39	38	37	36	35		33	32	31	30	29	28		26				22	21	20	19	18				14	13	12		9	8	7		5	4	3		1	2-1438693-6	
	49	48			45	44	43	42	41		39	38	37	36	35		33	32	31	30	29	28		26				22	21	20	19	18				14	13	12		10	9	8		5	4	3		1	2-1438693-5 $\frac{8}{\Delta}$	
		48			45	44	43	42	41		39	38	37	36	35		33	32	31	30	29	28		26				22	21	20	19	18				14	13	12		9	8	7		5	4	3		1	2-1438693-4 $\frac{8}{\Delta}$	
		48	47	46	45	44	43	42	41		39	38	37	36	35		33	32	31	30	29	28		26				22	21	20	19	18				14	13	12		10	9	8	7		5	4	3		1	2-1438693-3
	49	48	47	46	45	44	43	42	41		39	38	37	36	35		33	32	31	30	29	28		26				22	21	20	19	18				14	13	12		10	9	8		5	4	3		1	2-1438693-2 $\frac{8}{\Delta}$	
		48	47	46	45	44	43				39	38	37	36	35		33	32	31	30	29		26	25	24	23	22	21	20	19	18				14	13	12		10	9			5				1	2-1438693-1		
		48	47	46	45	44	43				39	38	37	36	35		33	32	31	30	29		26	25	24	23	22	21	20	19	18				14	13	12		9		7		5				1	2-1438693-0		
		48	47	46	45	44	43	42	41		39	38	37	36	35		33	32	31	30	29		26	25	24	23	22	21	20	19	18				14	13	12		10	9	8		5	4			1	1-1438693-9		
		48	47	46	45	44	43	42	41		39	38	37	36	35		33	32	31	30	29		26	25	24	23	22	21	20	19	18				14	13	12		9	8	7		5	4			1	1-1438693-8		
		48	47	46	45	44	43				39	38	37	36	35		33	32	31	30	29		26				22	21	20	19	18				14	13	12		10	9			5				1	1-1438693-7		
		48	47	46	45	44	43				39	38	37	36	35		33	32	31	30	29		26				22	21	20	19	18				14	13	12		9		7		5				1	1-1438693-6		
		48	47	46	45	44	43	42	41		39	38	37	36	35		33	32	31	30	29		26				22	21	20	19	18				14	13	12		10	9	8		5	4			1	1-1438693-5		
		48	47	46	45	44	43	42	41		39	38	37	36	35		33	32	31	30	29		26				22	21	20	19	18				14	13	12		9	8	7		5	4			1	1-1438693-4		
		48	47	46	45	44	43	42	41		39	38	37	36	35		33	32	31	30	29		26		24	23	22	21	20	19	18				14	13	12		9	8	7	6	5	4	3		1	1-1438693-3 $\frac{8}{\Delta}$		
		48	47	46	45	44	43	42	41		39	38	37	36	35		33	32	31	30	29		26		24	23	22	21	20	19	18				14	13	12		10	9	8		6	5	4	3		1	1-1438693-2 $\frac{8}{\Delta}$	
		48	47	46	45	44	43	42	41		39	38	37	36	35		33	32	31	30	29		26				22	21	20	19	18				14	13	12		10	9	8	7		5	4	3		1	1-1438693-1 $\frac{8}{\Delta}$	
		48			45	44	43	42	41		39	38	37	36	35		33	32	31	30	29		26		24	23	22	21	20	19	18				14	13	12		10	9	8		6	5	4	3		1	1-1438693-0 $\frac{8}{\Delta}$	
		48	47	46	45	44	43	42	41		39	38	37	36	35		33	32	31	30	29		26	25	24	23	22	21	20	19	18				14	13	12		9	8	7		5	4	3		1	1438693-9		
		48			45	44	43	42	41		39	38	37	36	35		33	32	31	30	29		26	25	24	23	22	21	20	19	18				14	13	12		9	8	7		5	4	3		1	1438693-8		
		48			45	44	43	42	41		39	38	37	36	35		33	32	31	30	29		26	25	24	23	22	21	20	19	18				14	13	12		10	9	8		5	4	3		1	1438693-7 $\frac{8}{\Delta}$		
		48	47	46	45	44	43	42	41		39	38	37	36	35		33	32	31	30	29		26	25	24	23	22	21	20	19	18				14	13	12		10	9	8		5	4	3		1	1438693-6 $\frac{8}{\Delta}$		
	49	48			45	44	43	42	41		39	38	37	36	35		33	32	31	30	29		26				22	21	20	19	18				14	13	12		10	9	8		5	4	3		1	1438693-5		
CAVITIES WITH A NUMERIC SYMBOL INDICATES CLOSED TERMINAL LOCATIONS		48			45	44	43	42	41		39	38	37	36	35		33	32	31	30	29		26				22	21	20	19	18				14	13	12		9	8	7		5	4	3		1	1438693-4 $\frac{8}{\Delta}$		
		48	47	46	45	44	43	42	41		39	38	37	36	35		33	32	31	30	29		26				22	21	20	19	18				14	13	12		9	8	7		5	4	3		1	1438693-3 $\frac{8}{\Delta}$		
BLANK CAVITIES INDICATES OPEN TERMINAL HOLE LOCATIONS	49	48	47	46	45	44	43	42	41		39	38	37	36	35		33	32	31	30	29		26				22	21	20	19	18				14	13	12		10	9	8		5	4	3		1	1438693-2 $\frac{8}{\Delta}$		
																																															1	1438693-1		

KEYING OPTION C

CAVITIES WITH A NUMERIC SYMBOL INDICATES CLOSED TERMINAL LOCATIONS

BLANK CAVITIES INDICATES OPEN TERMINAL HOLE LOCATIONS

TERMINAL HOLE POSITION

50 49 48 47 46 45 44 43 42 41 40 39 38 37 36 35

REVISIONS				
P	LTN	DESCRIPTION	DATE	APVD
-		SEE SHEET 1	-	-

KEYING OPTION C			48	47	46	45	44	43					39	38	37	36	35			33	32	31	30	29			26					22	21	20	19	18			14	13	12			10	9			6	5			1	4-1438693-6				
			48	47	46	45	44	43					39	38	37	36	35			33	32	31	30	29			26					22	21	20	19	18			14	13	12			9	7	6	5			1	4-1438693-5						
			48	47	46	45	44	43	42	41			39	38	37	36	35			33	32	31	30	29			26					22	21	20	19	18			14	13	12			10	9	8			6	5	4			1	4-1438693-4		
			48	47	46	45	44	43	42	41			39	38	37	36	35			33	32	31	30	29			26					22	21	20	19	18			14	13	12			9	8	7	6	5	4			1	4-1438693-3				
			48	47	46	45	44	43	42	41			39	38	37	36	35			33	32	31	30	29	28			26					22	21	20	19	18			14	13	12			9	8	7	6	5	4	3			1	4-1438693-2		
			48	47	46	45	44	43	42	41			39	38	37	36	35			33	32	31	30	29			26					22	21	20	19	18			14	13	12			9	8	7	6	5	4	3			1	4-1438693-1			
		49	48	47	46	45	44	43	42	41			39	38	37	36	35			33	32	31	30	29			26					22	21	20	19	18			14	13	12			10	9	8			6	5	4	3			1	4-1438693-0	
		49	48	47	46	45	44	43	42	41			39	38	37	36	35			33	32	31	30	29	28			26					22	21	20	19	18			14	13	12			10	9	8			6	5	4	3			1	3-1438693-9
			48	47	46	45	44	43	42			39	38	37	36	35			33	32			29	28			26					22	21	20	19	18			14	13	12			10	9	8	7			5	4	3			1	3-1438693-8	
			48	47	46	45	44	43	42			39	38	37	36	35			33	32			29	28			26	25	24	23	22	21	20	19	18			14	13	12			10	9	8	7			5	4	3			1	3-1438693-7		

CAVITIES WITH A NUMERIC SYMBOL INDICATES CLOSED TERMINAL LOCATIONS

BLANK CAVITIES INDICATES OPEN TERMINAL HOLE LOCATIONS

TERMINAL HOLE POSITION

ASSEMBLY PART NUMBER

PIN-OUT CHART

THIS DRAWING IS A CONTROLLED DOCUMENT.		DWN B. CRISAMORE 21 JUL 2004 CHK M. HITCHCOCK 21 JUL 2004 APVD C. MARTIN 21 JUL 2004	
DIMENSIONS: mm 	TOLERANCES UNLESS OTHERWISE SPECIFIED: 0 PLC ±0.3 1 PLC ±0.10 2 PLC ±0.10 3 PLC ±0.10 4 PLC ±0.10 ANGLES ±1° FINISH	NAME PCM PRODUCT SPEC 50-WAY HARNESS ASSEMBLY APPLICATION SPEC KEY C	SIZE A1 CAGE CODE 00779 DRAWING NO. 1438693
MATERIAL	WEIGHT	CUSTOMER DRAWING	SCALE 2:1 SHEET 4 OF 4 REV A12

Mouser Electronics

Authorized Distributor

Click to View Pricing, Inventory, Delivery & Lifecycle Information:

[TE Connectivity:](#)

[2-1438693-7](#)