

REVISIONS					
P	LTR	DESCRIPTION	DATE	DMN	APVD
B		REVISED PER ECR-19-015552	06DEC2019	KD	FL

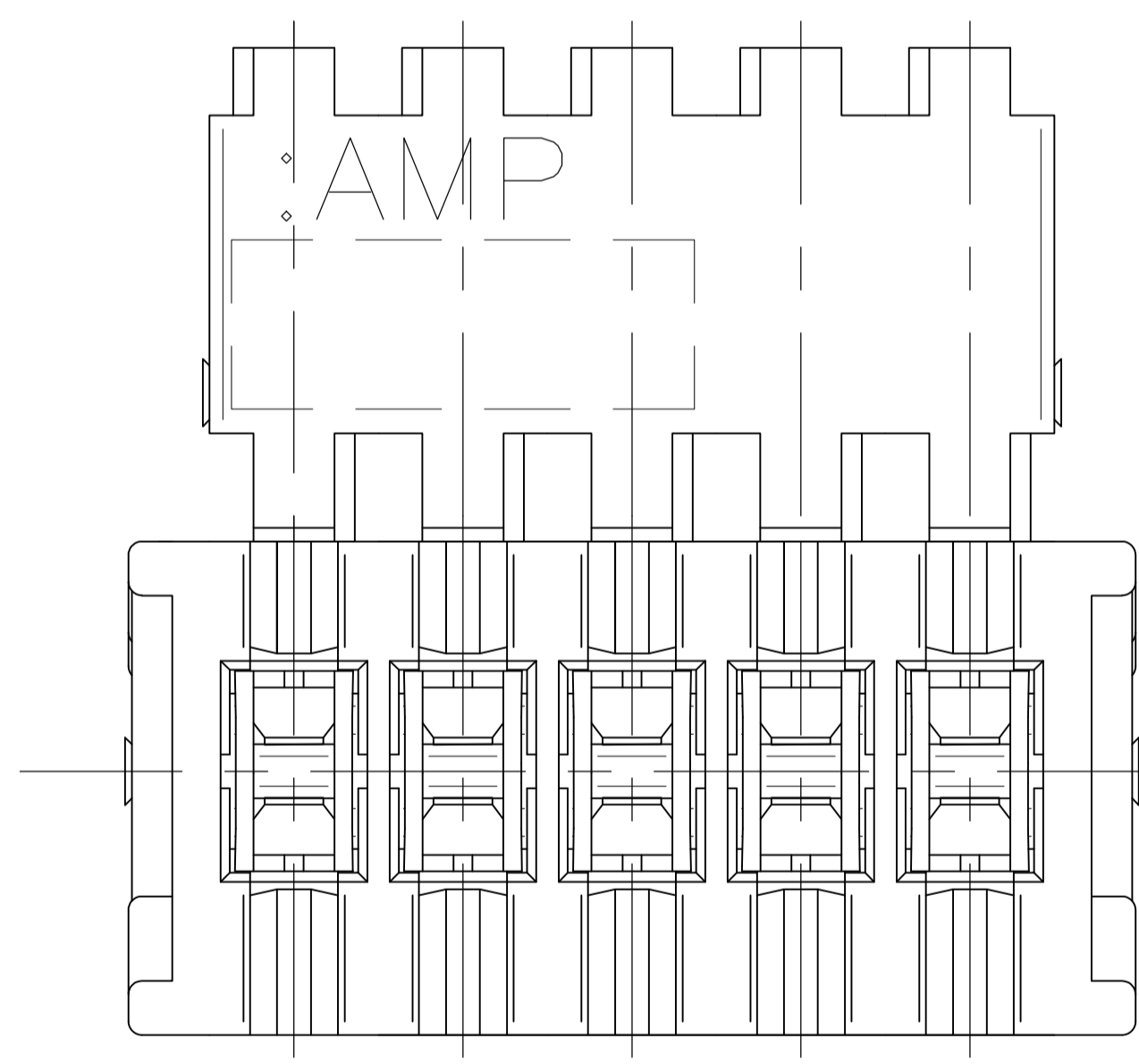
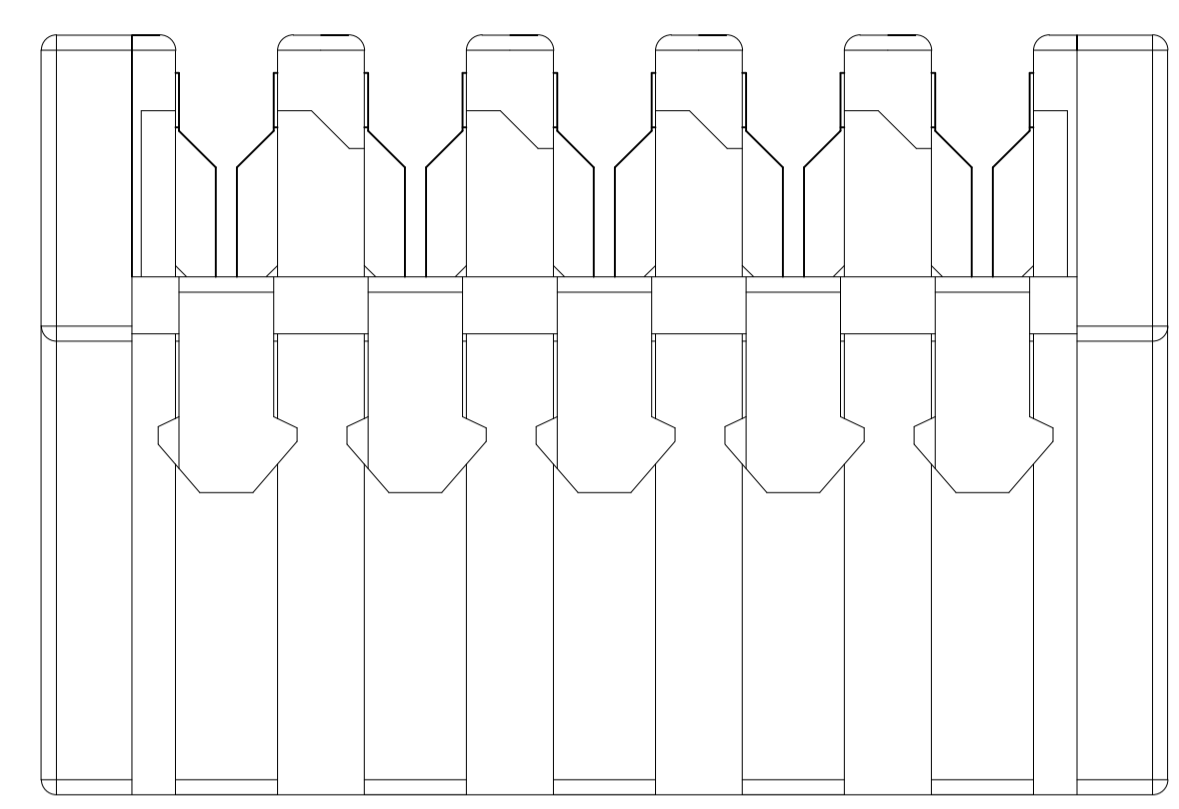
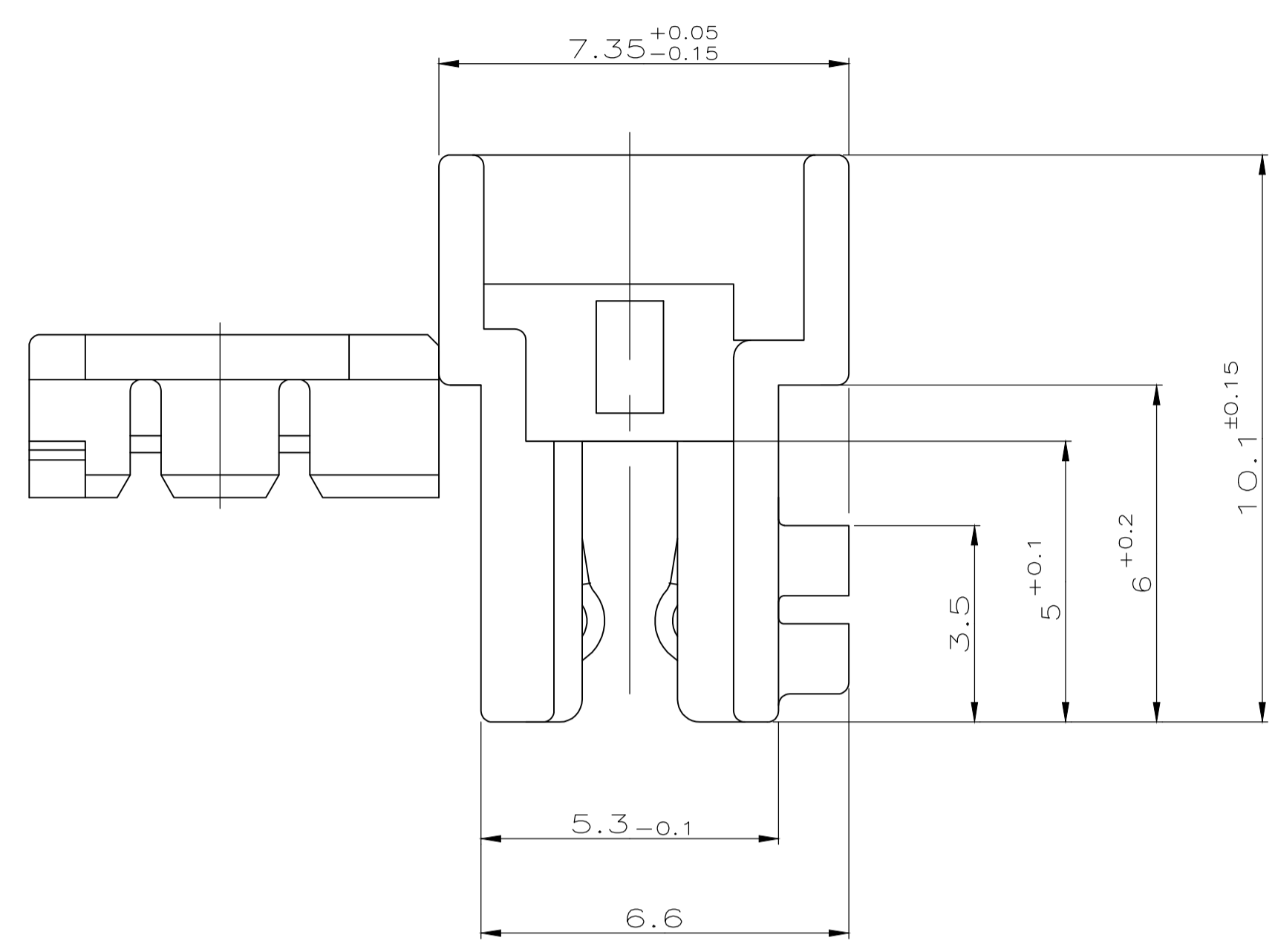
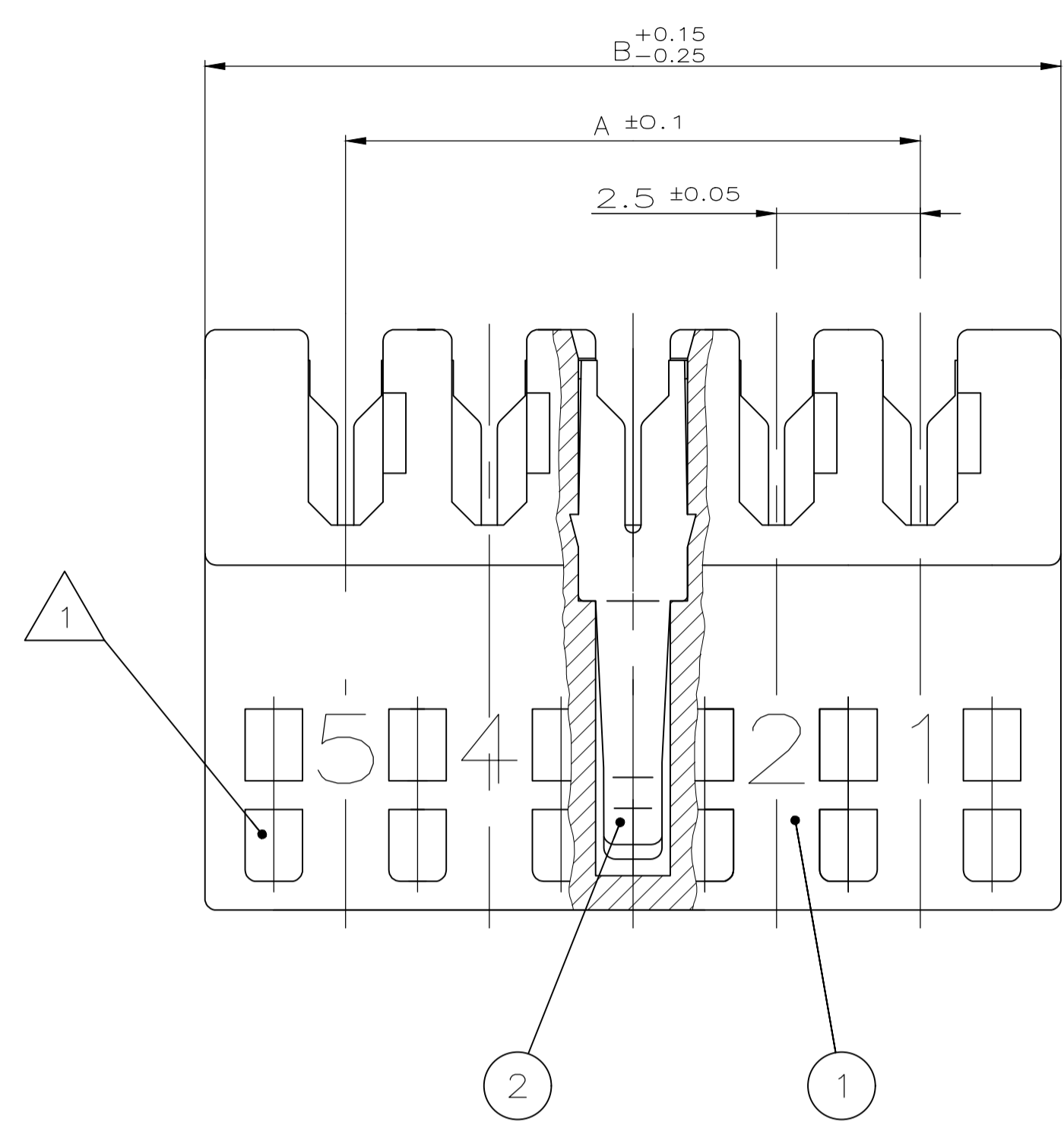

- 4 PBT GF, UL94-V0 & GWEPT 750 NO-FLAME, NATURAL
- 3 PBT GF
- 2 MATING PARTS:
 -TABHEADER SEE DRAWING NO.1971817 AND EQUIVALENT;
 -PCB APPLICATION WITH FRAME SEE DRAWING 964 575
 -PCB APPLICATION WITHOUT FRAME SEE SPECIFICATION 108-18056
- 1 KEYING RIBS; CUTTING WITH THE TERMINATION MACHINE POSSIBLE

POS.	DIM A	DIM B	TE P/N	TE P/N
6	12.5	17.4	1-1241121-6	9-2311500-6
4	7.5	12.4	1-1241121-4	9-2311500-4
3	5.0	9.9	1-1241121-3	-

SIEHE TABELLE	2	-	KONTAKT	CuSn	VORVERZINNT
SEE TABLE	1	-	FEDERLEISTENGEHÄUSE	PBT	GRAU
BESTELL-NR.	POS.	STÜCK	BENENNUNG EINZELTEIL	WERKSTOFF	OBERFLÄCHE FARBE

THIS DRAWING IS A CONTROLLED DOCUMENT.		DIN 26.06.92	
DIMENSIONS: mm		TOLERANCES UNLESS OTHERWISE SPECIFIED:	
		0 PLC ± - 1 PLC ± 0.2 2 PLC ± - 3 PLC ± - 4 PLC ± - ANGLES ± 1°	
SIEHE TABELLE 2 - KONTAKT		DIN 26.06.92	
SEE TABLE 1 - FEDERLEISTENGEHÄUSE		CHK BORMUTH	
BESTELL-NR. POS. STÜCK BENENNUNG EINZELTEIL WERKSTOFF OBERFLÄCHE FARBE		APVD -	
		NAME	
		PRODUCT SPEC	
		APPLICATION SPEC	
		SIZE 114-18049-1	
		WEIGHT 0	
		SCALE 10:1	
		SHEET 1 OF 1	
		REV B	



AMP DUOPLUG 2.5 FEMALE CONNECTOR

AMP DUOPLUG 2.5 Federleiste

114-18049-1

00779 1241121

Mouser Electronics

Authorized Distributor

Click to View Pricing, Inventory, Delivery & Lifecycle Information:

[TE Connectivity:](#)

[1-1241121-6](#)