

REVISIONS					
P.	LTN.	DESCRIPTION	DATE	DWN.	APVD.
G45		REVISED PER ECO-13-011449	16JUL2013	DLD	DCM
G46		REVISED PER ECO-14-007153	19MAY2014	DLD	DCM
G47		REVISED PER ECO-14-014965	09OCT2013	DLD	DCM
G48		REVISED PER ECO-20-012739	05OCT2020	AP	CM

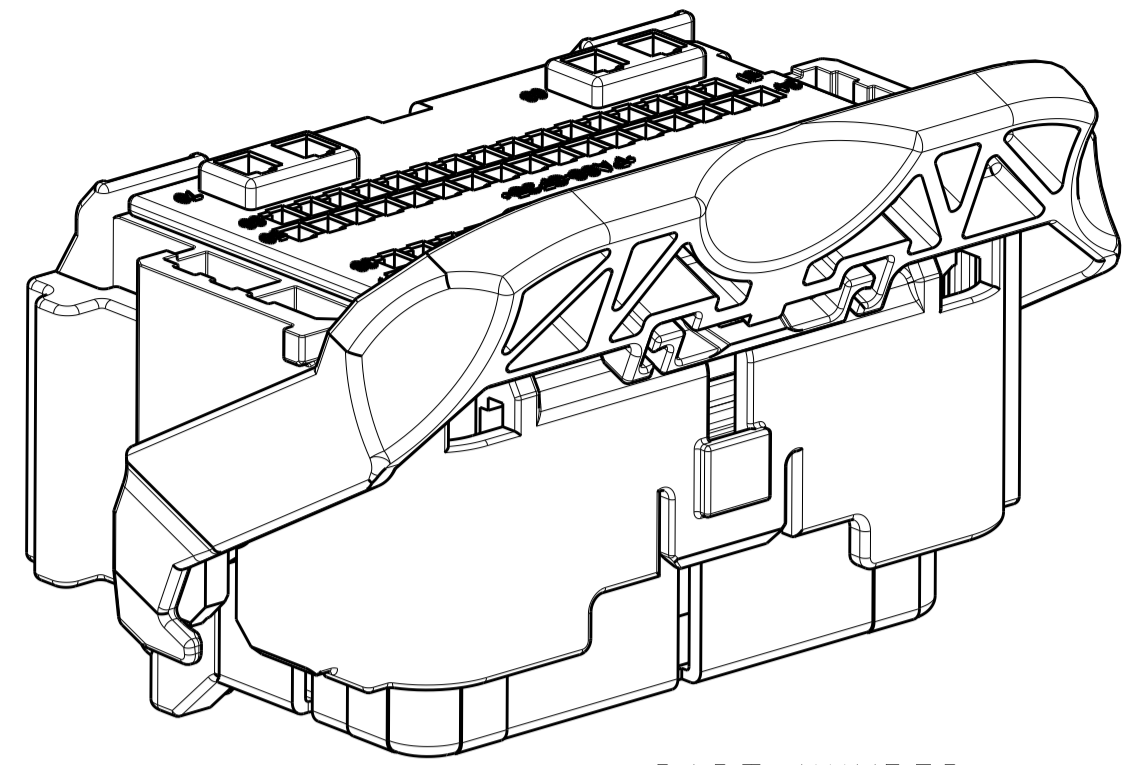

PART NUMBER:  
1438136-1  
SHOWN WITH SPACER  
IN SEATED POSITION

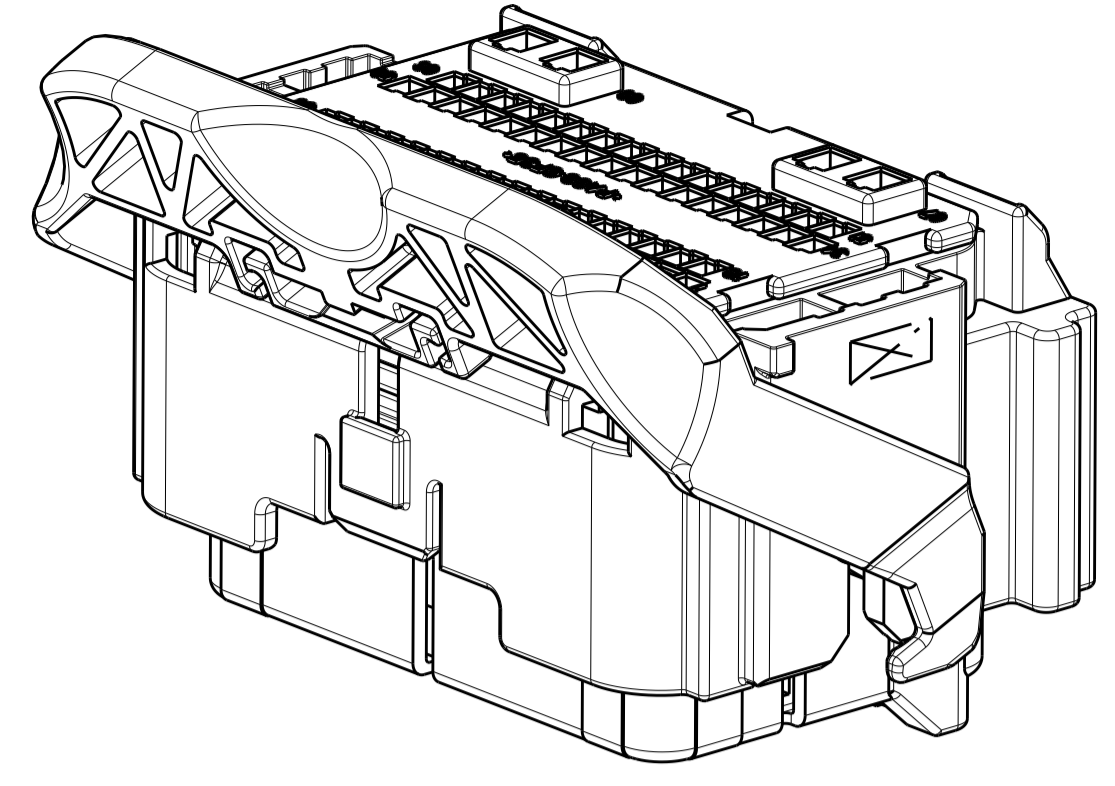
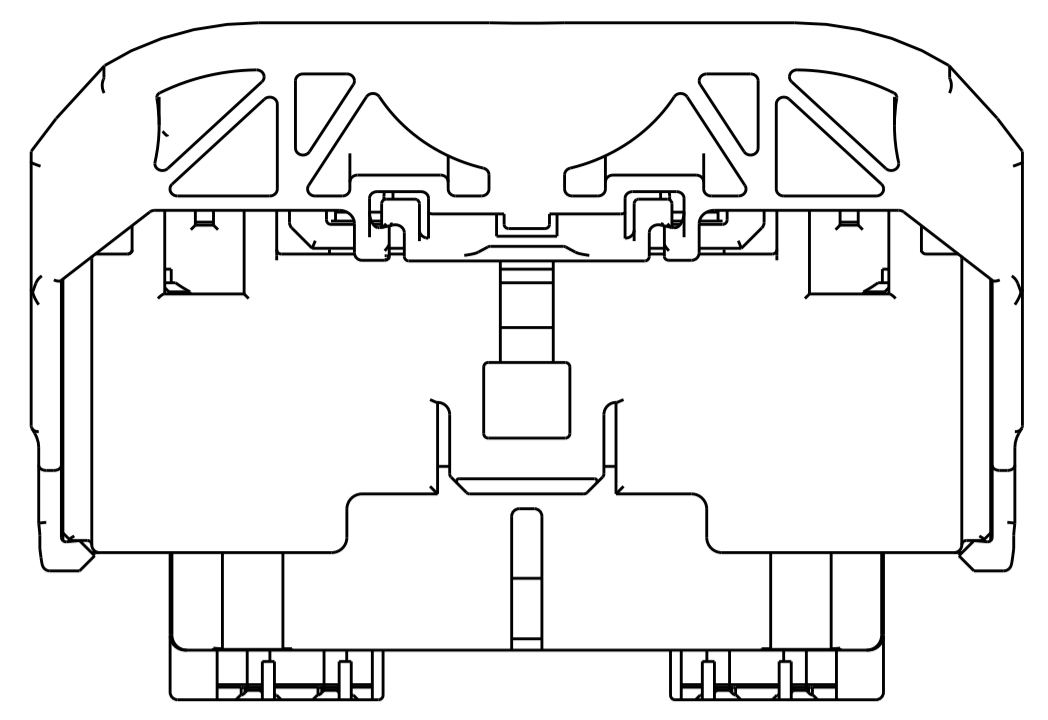

1. PRINT FORD PART NUMBER (SEE ATTACHED CHARTS) AND TRACEABILITY CODE (YY = 2 DIGIT YEAR, JJJ = JULIAN DATE, HH = 2 DIGIT MILITARY HOUR) IN THIS LOCATION AT ASSEMBLY. SEE SHEETS 3, 4 AND 5 (-\*) PART NUMBERS.
  2. APPLICABLE MOLEX (1.5) POWER TERMINAL PART NUMBERS:  
33012-0002 TIN 0.50-1.50mm<sup>2</sup>
  3. CAM LEVER AND SPACER ARE SHIPPED IN THEIR PRE-ASSEMBLED POSITIONS.
  4. REFERENCE TE INSTRUCTION SHEET 408-8893.
- △ COMPANY LOGO.  
△ OBSOLETE PART.

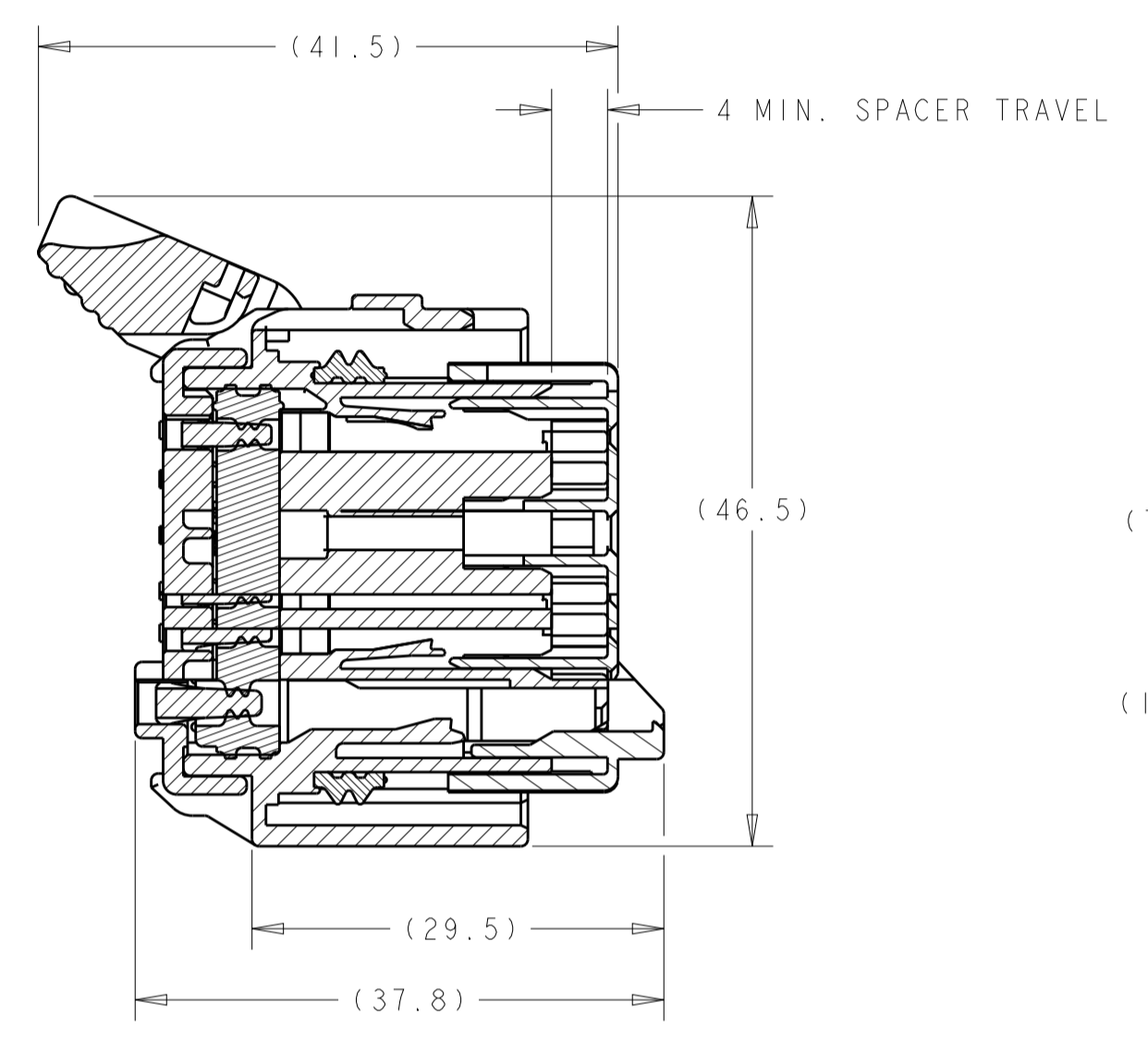

SECTION A-A  
SPACER AND LEVER  
IN PRE-SEATED POSITION  
(DELIVERY POSITION)

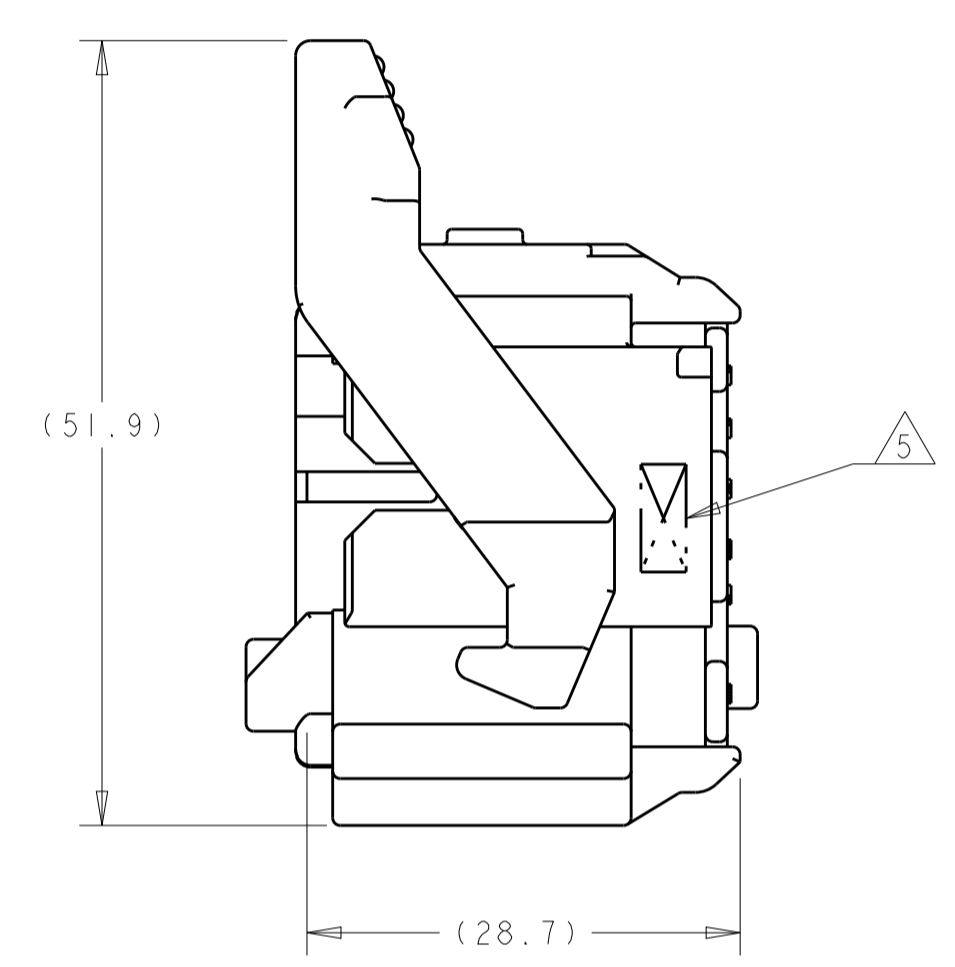
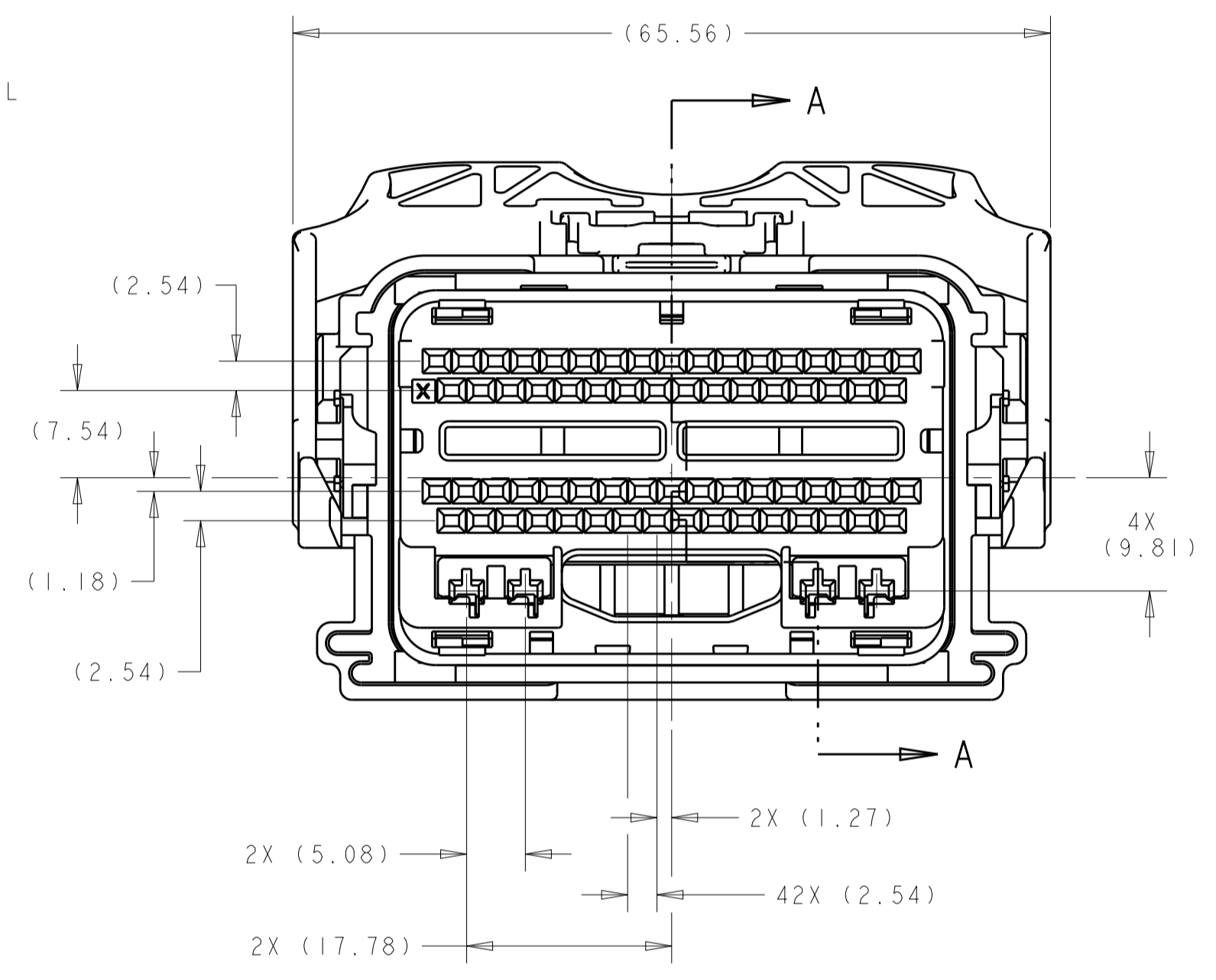

SHOWN WITH CAM  
LEVER AND SPACER  
IN LOADED POSITION

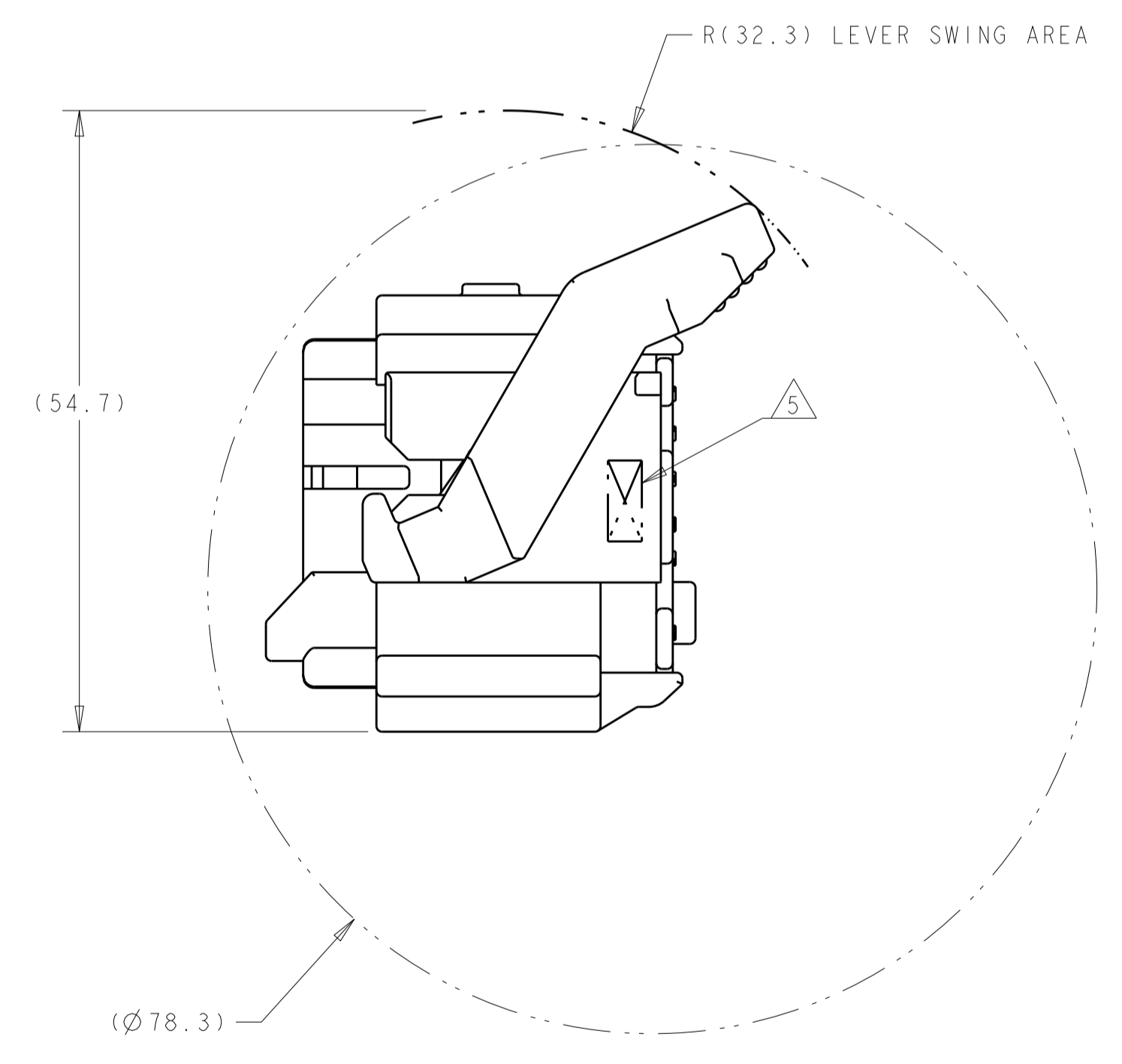
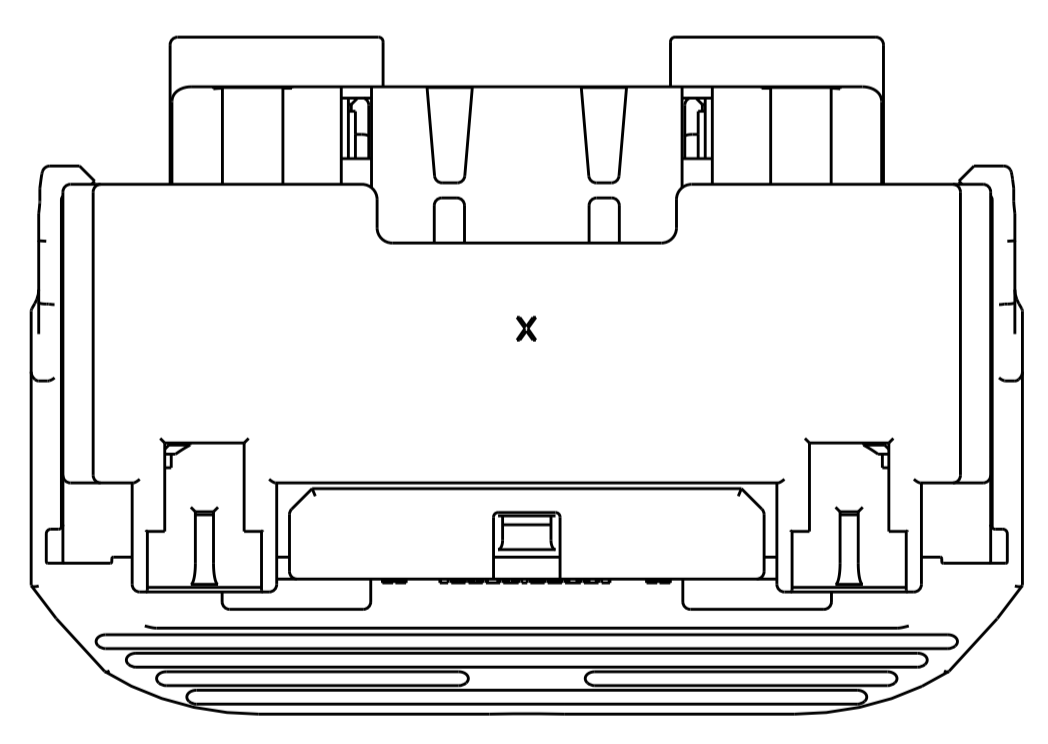

MIN. FEED THRU CONDITION  
WITH 1mm CLEARANCE ALL AROUND  
SHOWN WITH SPACER IN SEATED POSITION

APPLICABLE COMPONENTS (FOR REFERENCE ONLY)						
DESCRIPTION	NOMINAL TERMINAL SIZE	COLOR/PLATING	FORD COMPONENT PART NUMBER	SUPPLIER PART NUMBER	MATERIAL/SPECIFICATION NUMBER	SAE WIRE SIZE
TERMINAL - FEMALE (Ag)	0.64 (CAT. 0)	SILVER	7S4T-14474-AA	1393366-2	COPPER ALLOY/SILVER PLATE	20AWG 18AWG
TERMINAL - FEMALE (Ag)	0.64 (CAT. 0)	SILVER	7S4T-14474-BA	1393367-2	COPPER ALLOY/SILVER PLATE	22AWG
TERMINAL - FEMALE (Sn)	0.64 (CAT. 0)	TIN	1L2T-14474-AA	1393366-1	COPPER ALLOY/TIN PLATE	20AWG 18AWG
TERMINAL - FEMALE (Sn)	0.64 (CAT. 0)	TIN	1L2T-14474-BA	1393367-1	COPPER ALLOY/TIN PLATE	22AWG
TERMINAL - FEMALE (Au)	0.64 (CAT. 0)	GOLD	1L2T-14474-CA	1393365-1	COPPER ALLOY/GOLD PLATE	20AWG 18AWG
TERMINAL - FEMALE (Au)	0.64 (CAT. 0)	GOLD	1L2T-14474-DA	1393364-1	COPPER ALLOY/GOLD PLATE	22AWG

SEE SHEETS 3 THRU 7  
PART NUMBER

THIS DRAWING IS A CONTROLLED DOCUMENT.

DIMENSIONS:	TOLERANCES UNLESS OTHERWISE SPECIFIED:	OWN: R. VESTAL 15APR2005	CHK: T. VALASEK 15APR2005	APVD: T. VALASEK 15APR2005	NAME: T. VALASEK
mm	0 PLC ±0.3 1 PLC ±0.3 2 PLC ±0.10 3 PLC ±0.10 4 PLC ±0.10 ANGLES ±1°	PRODUCT SPEC			
MATERIAL:	FINISH:	APPLICATION SPEC			
CUSTOMER DRAWING		SIZE: A1	CAGE CODE: 100779	DRAWING NO: 1438136	RESTRICTED TO: REV: G48

SCALE: 2:1 SHEET 1 OF 11

REVISIONS				
P.	LTN	DESCRIPTION	DATE	OWN APVD
-	-	SEE SHEET 1	-	-

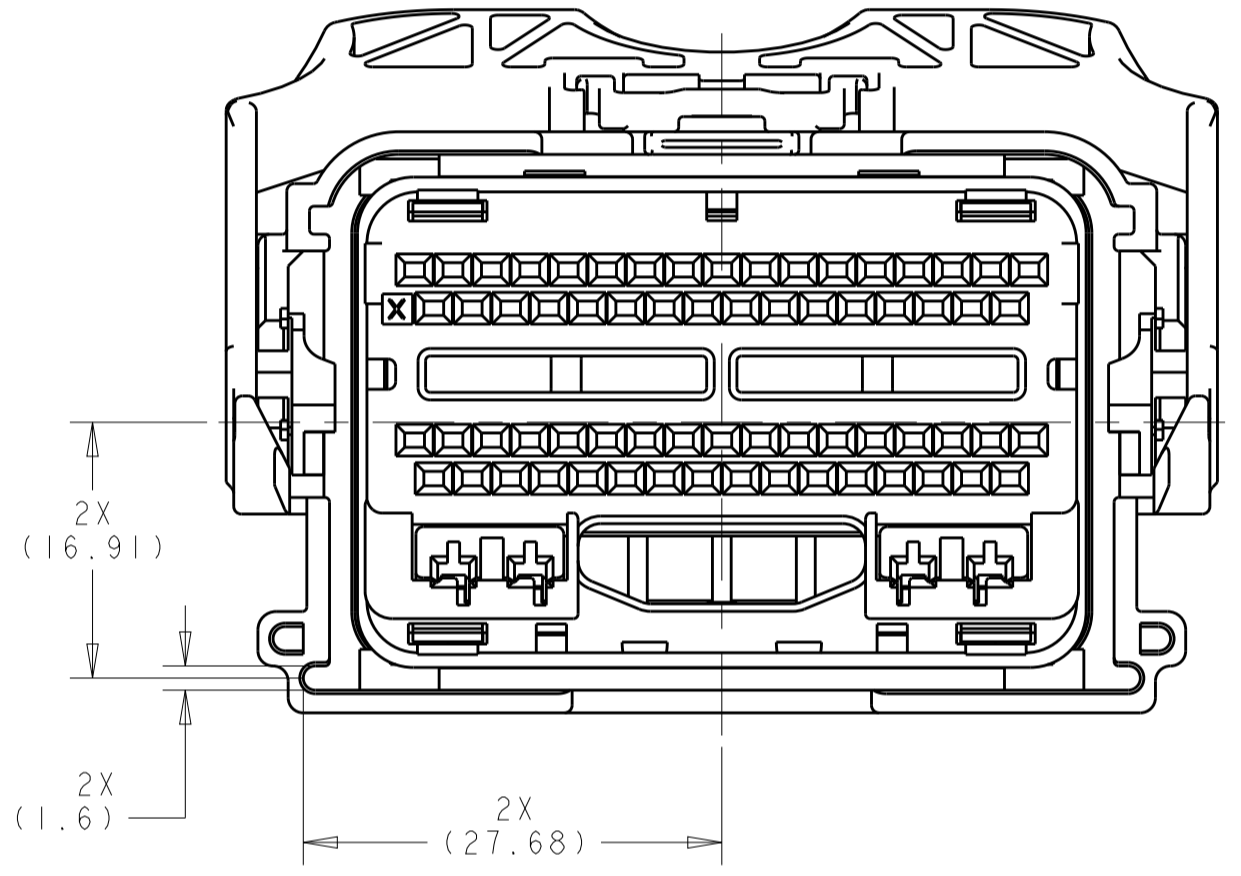
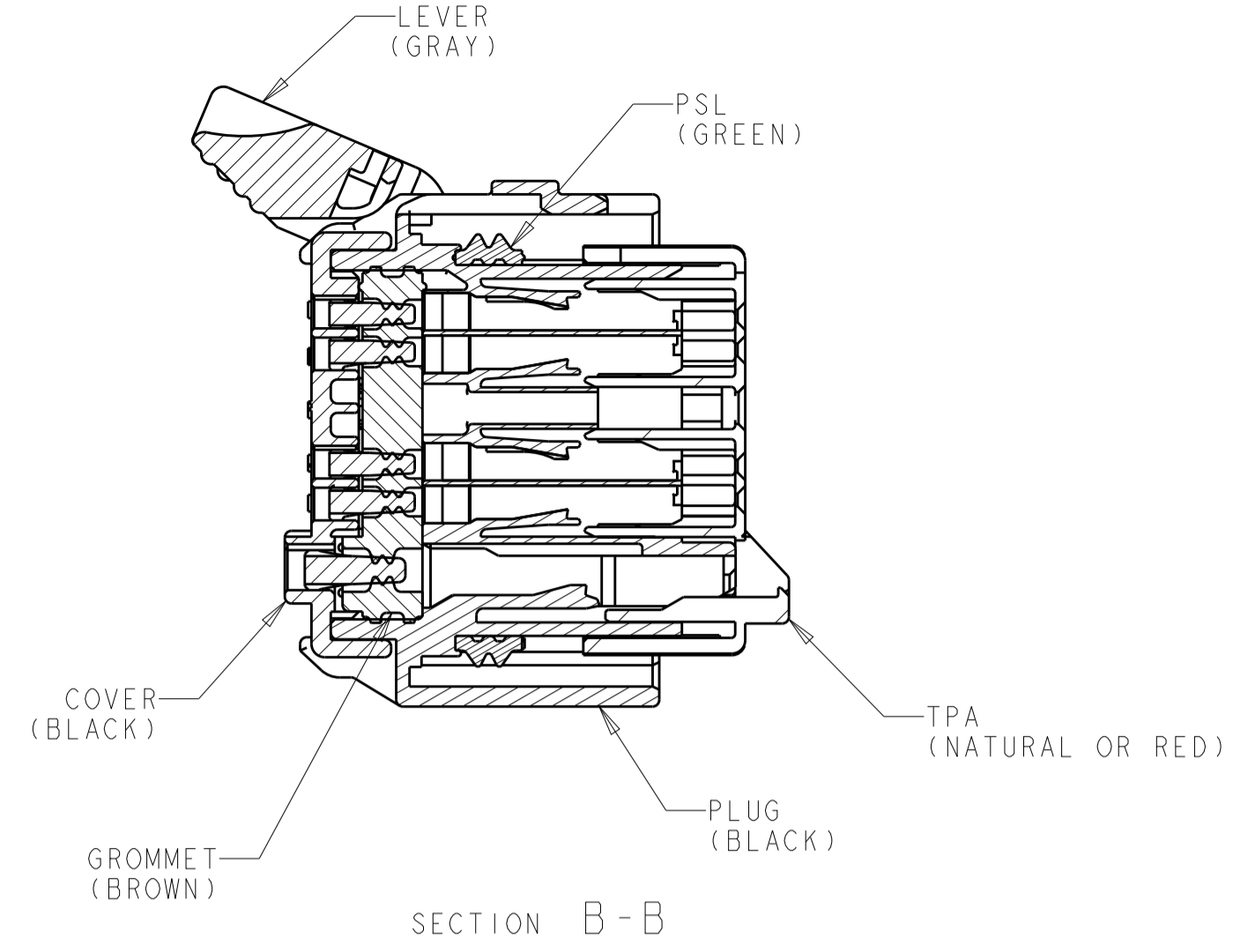
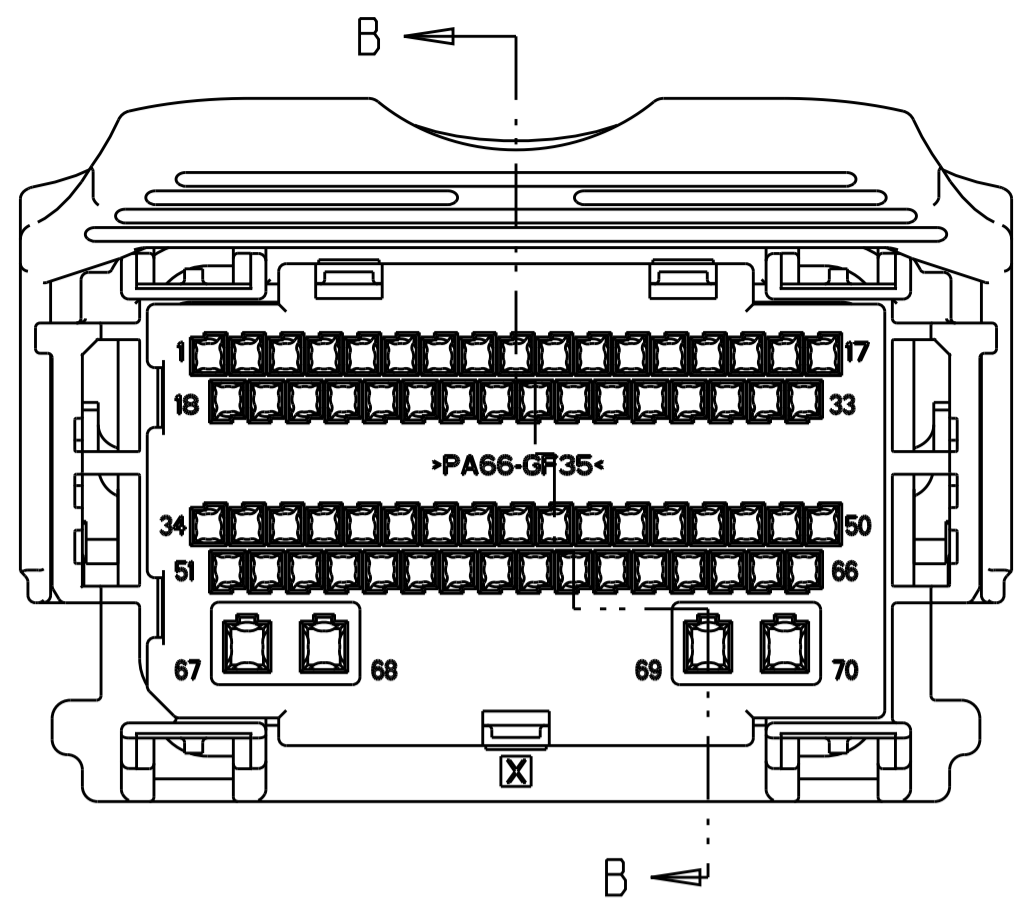

KEYING OPTION "A"

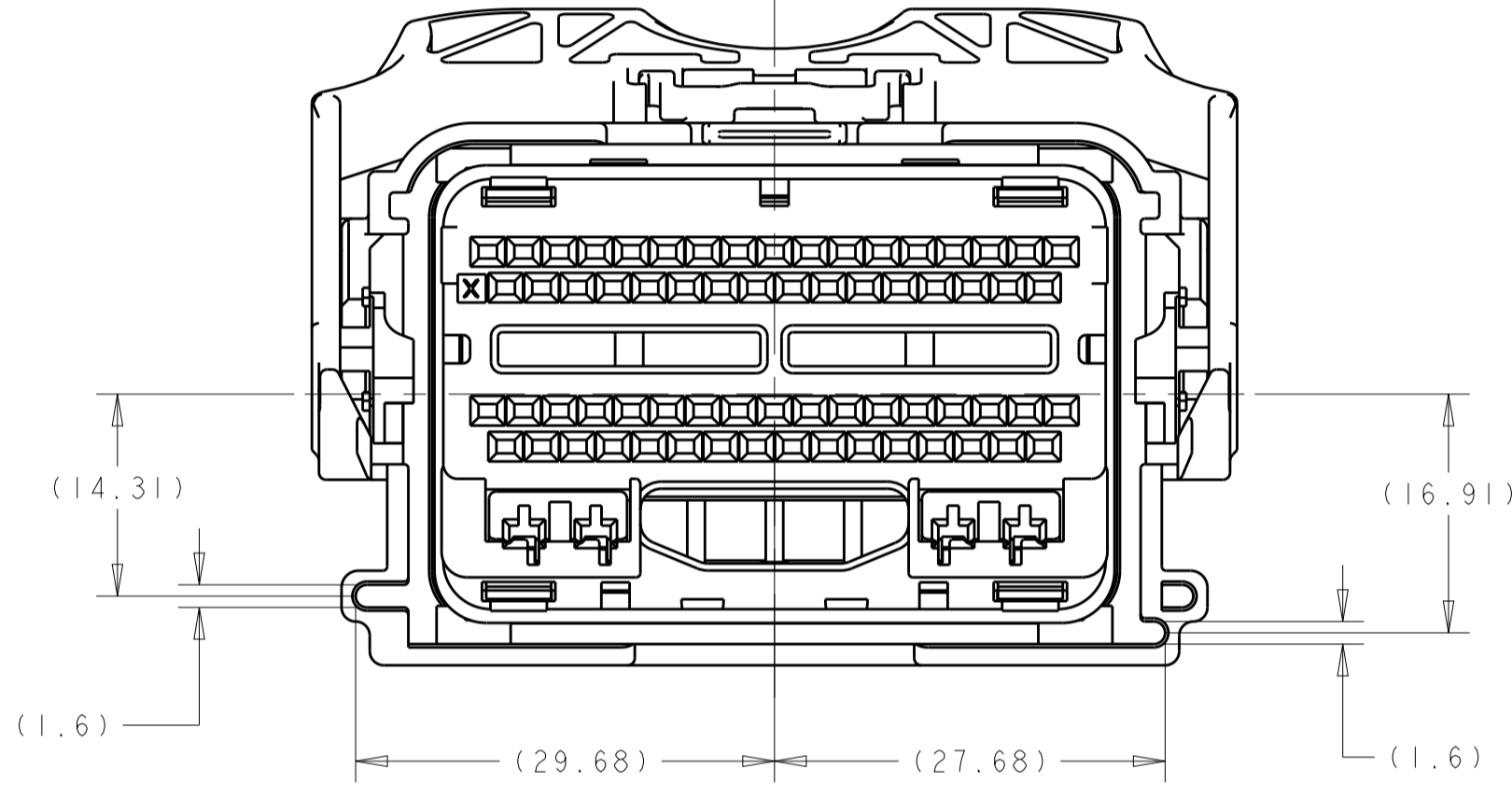

KEYING OPTION "B"

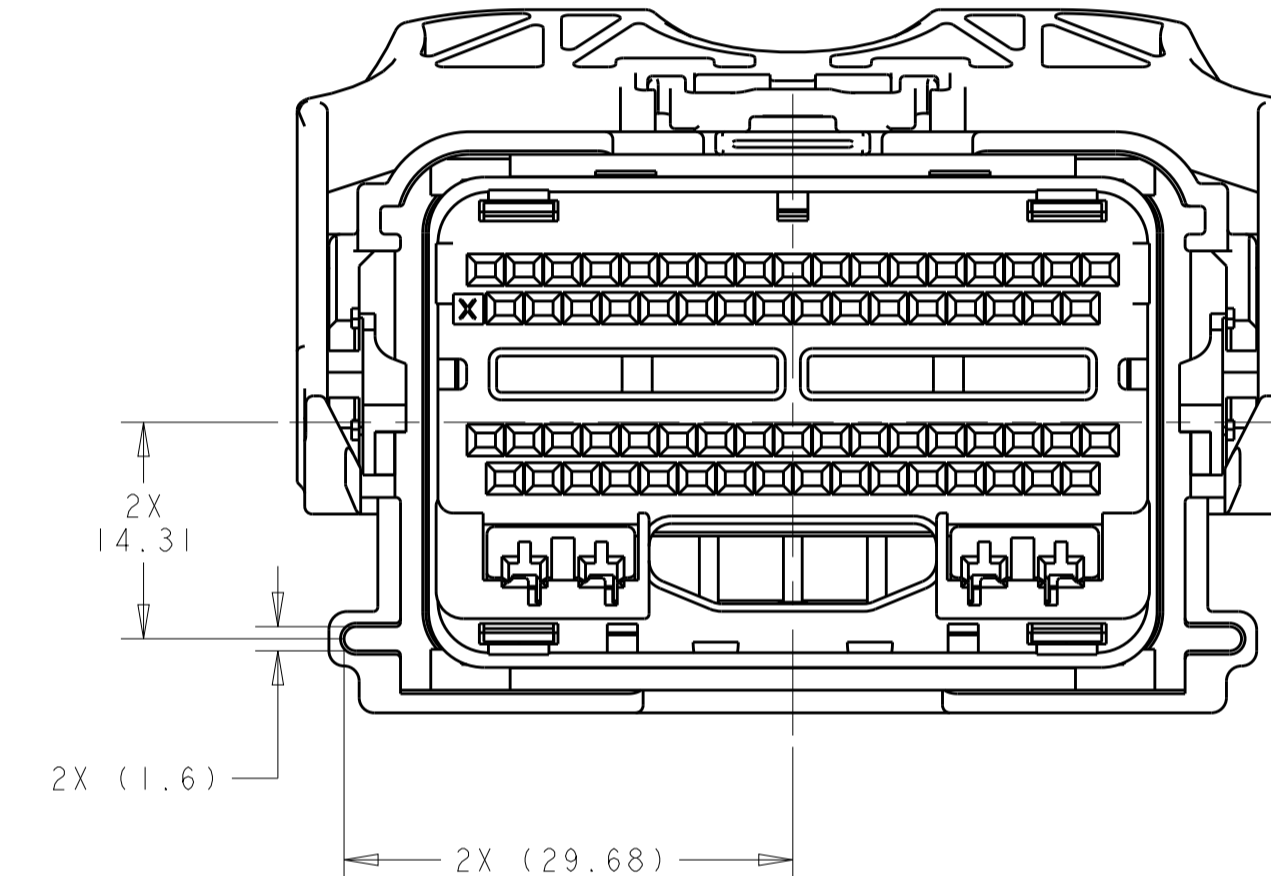

KEYING OPTION "C"

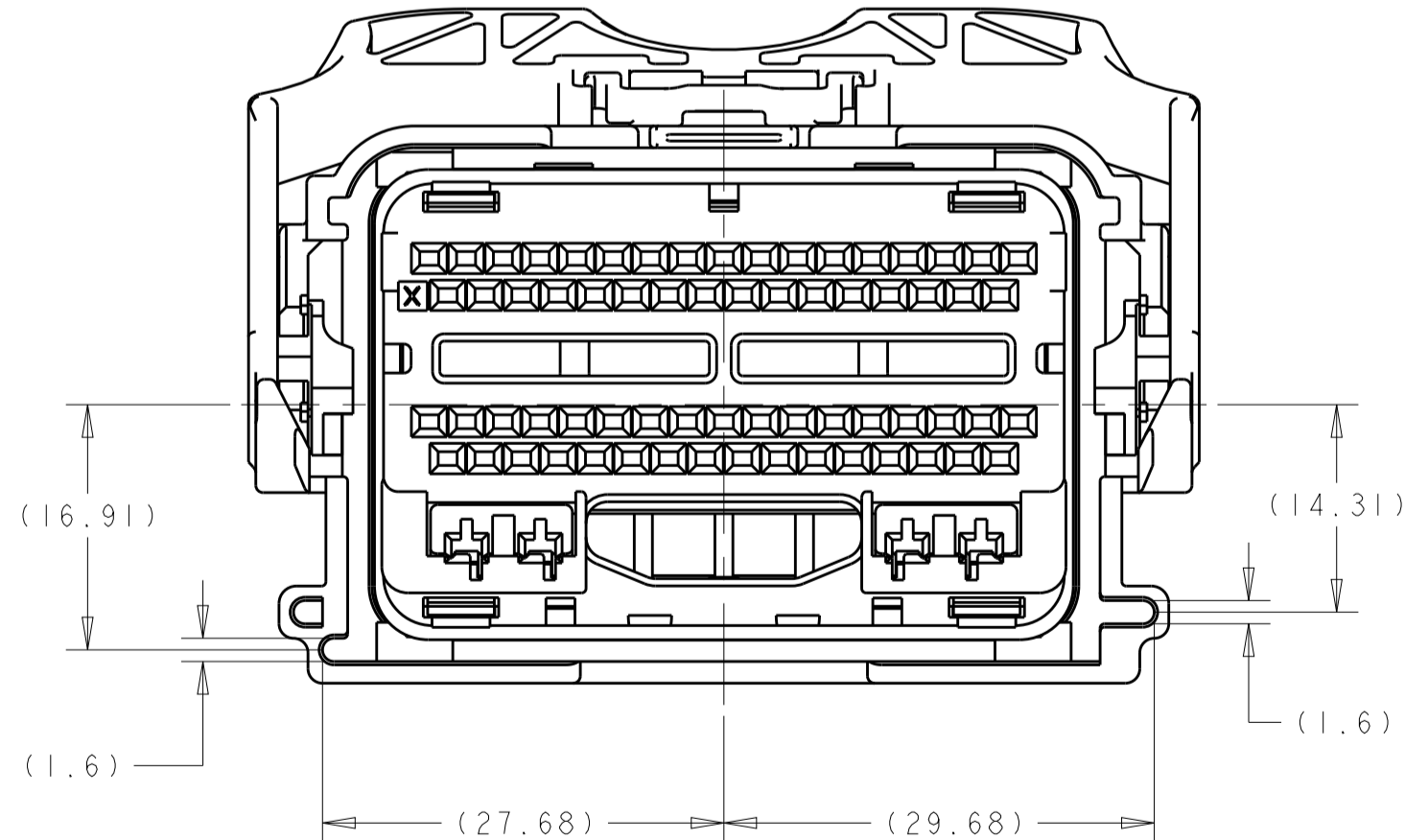

KEYING OPTION "D"

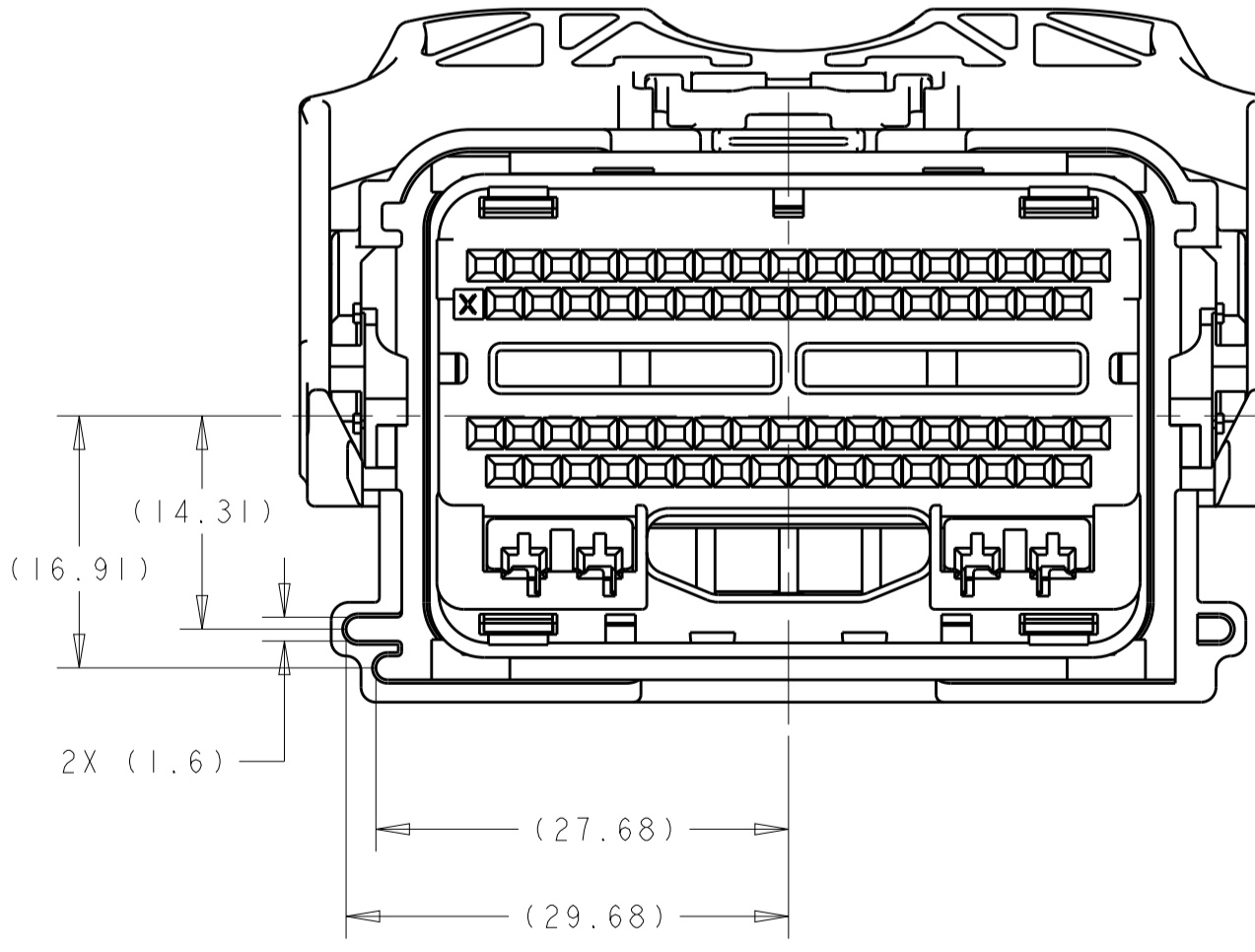

KEYING OPTION "E"

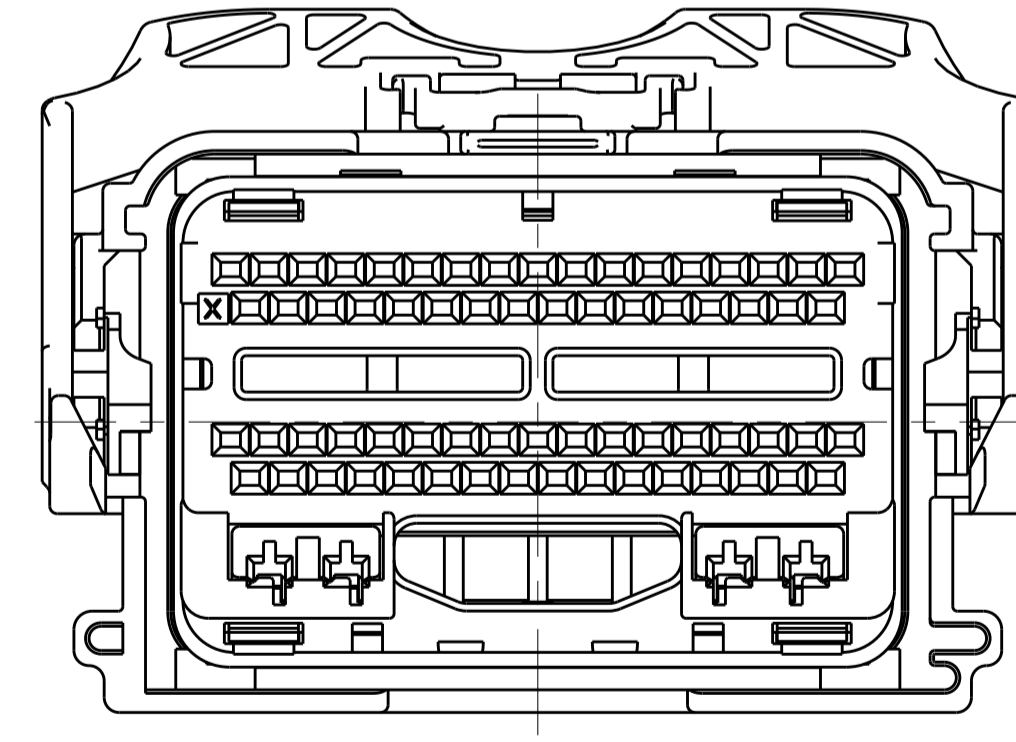

KEYING OPTION "F"

THIS DRAWING IS A CONTROLLED DOCUMENT.		OWN: R. VESTAL 15APR2005	TE Connectivity
DIMENSIONS: mm		CHK: T. VALASEK 15APR2005	
TOLERANCES UNLESS OTHERWISE SPECIFIED:		APVD: T. VALASEK 15APR2005	NAME: 70-WAY HARNESS ASSEMBLY
0 PLC ±	1 PLC ±0.3	PRODUCT SPEC	SIZE: A100779C=1438136
2 PLC ±0.10	3 PLC ±	APPLICATION SPEC	RESTRICTED TO: -
4 PLC ±	ANGLES ±	WEIGHT	SCALE: 2:1 SHEET 2 OF 11 REV: 648
MATERIAL	FINISH	CUSTOMER DRAWING	





Table with columns: P, LTR, DESCRIPTION, DATE, DWN, APVD. Row 1: SEE SHEET 1, -, -, -

Main pin-out chart table with columns for terminal positions (69-70) and pin numbers (1-30). Includes text: KEYING OPTION B, CAVITIES WITH A NUMERIC SYMBOL INDICATES CLOSED TERMINAL LOCATIONS, BLANK CAVITIES INDICATES OPEN TERMINAL HOLE LOCATIONS, TERMINAL HOLE POSITION.

5L3T-14A464-E\* PIN-OUT CHART

ASSEMBLY PART NUMBER FORD PART NUMBER

Engineering data block including: DIMENSIONS: mm, TOLERANCES UNLESS OTHERWISE SPECIFIED: 0 PLC ±0.3, 1 PLC ±0.10, 2-4 PLC ±. MATERIAL, FINISH, THIS DRAWING IS A CONTROLLED DOCUMENT, DWN: R. VESTAL 15APR2005, CHK: T. VALASEK 15APR2005, APVD: T. VALASEK 15APR2005, NAME, PRODUCT SPEC, APPLICATION SPEC, WEIGHT, CUSTOMER DRAWING, SIZE: A100779, CAGE CODE: 1438136, SHEET: 5 OF 11, REV: 648, and TE Connectivity logo.



REVISONS table with columns: P, LTR, DESCRIPTION, DATE, DWN, APVD. Includes revision 1: SEE SHEET 1.

Main pin-out chart table. Columns include terminal positions 70 to 1 and 57 to 49. Rows list part numbers (e.g., 805T-14A464-BA-056) and descriptions. Includes a 'KEYING OPTION D' label and a legend for terminal symbols.

Product specification form. Includes fields for DIMENSIONS (mm), TOLERANCES UNLESS OTHERWISE SPECIFIED (0-5 PLC, ANGLES, FINISH), MATERIAL, CUSTOMER DRAWING, and drawing metadata like A100779 and 1438136.







REVISIONS				
P.	LTH	DESCRIPTION	DATE	APPV
-	-	SEE SHEET 1	-	-

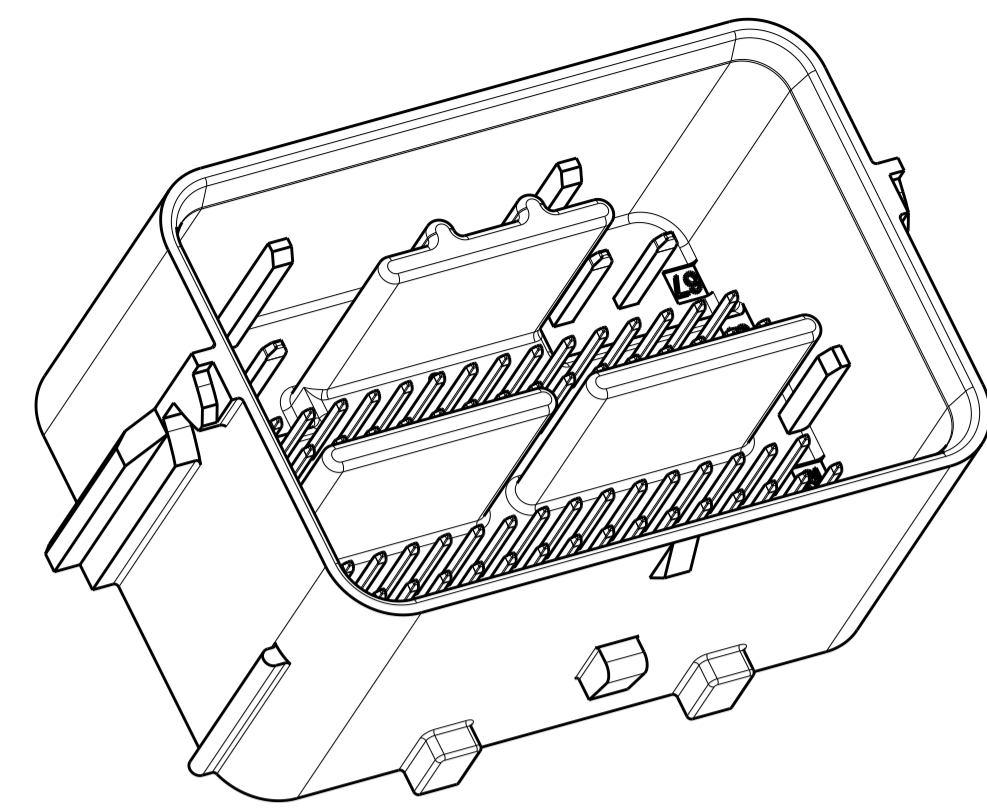

SCALE 2:1

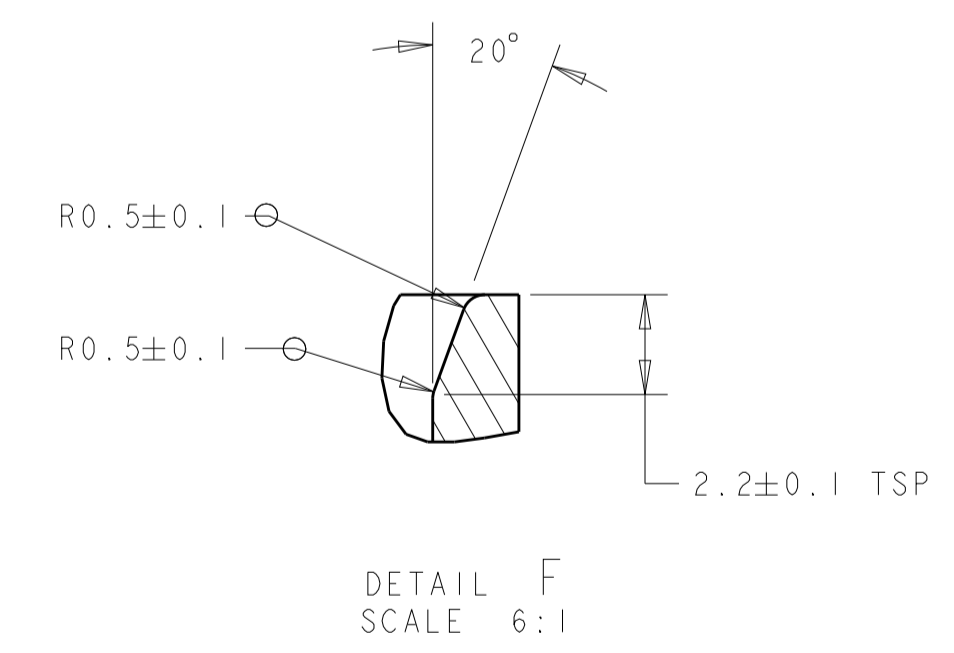
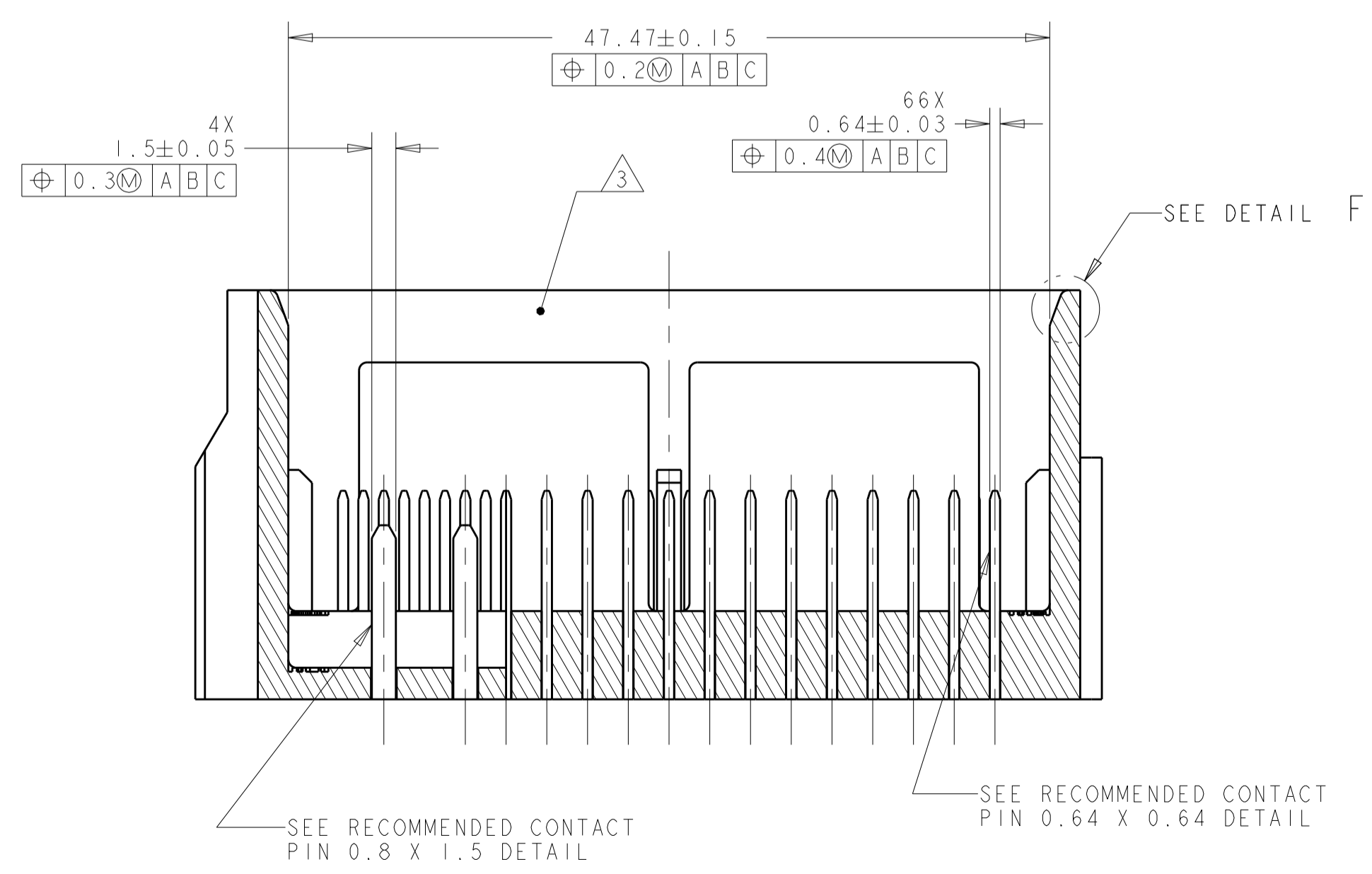
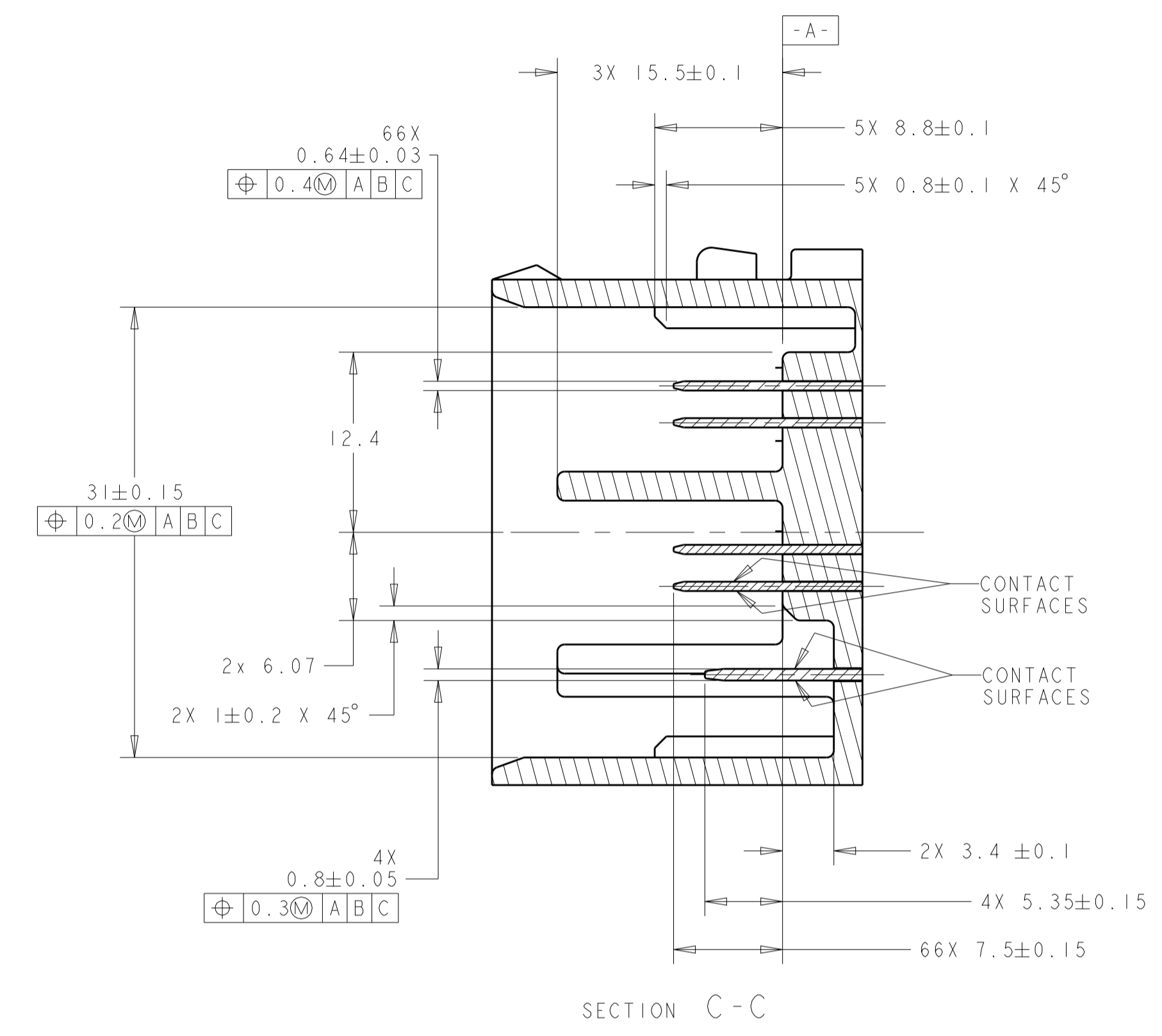
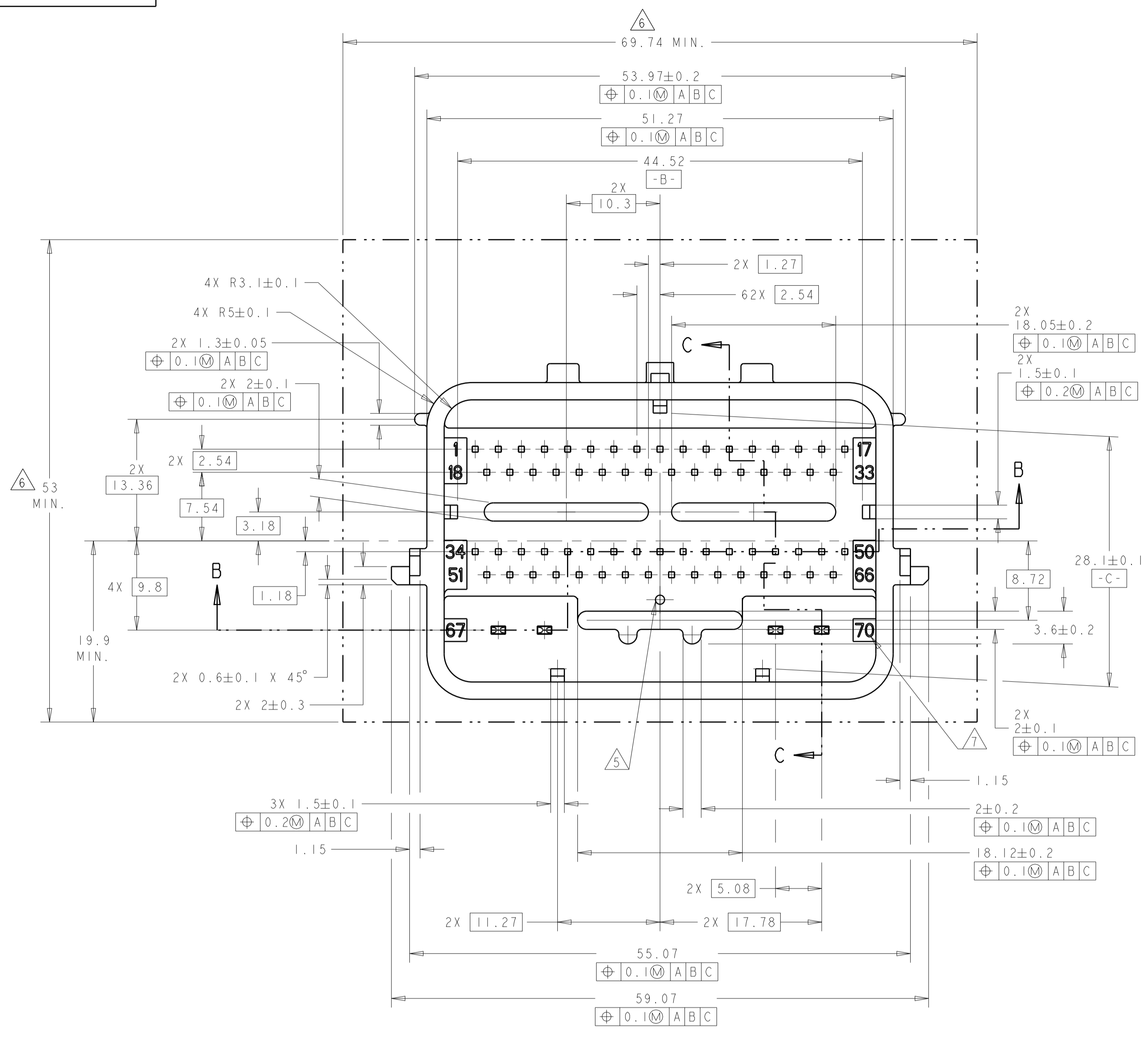

- NOTES: UNLESS OTHERWISE SPECIFIED
- GENERAL TOLERANCE:  
 ±0.3 ALL ONE PLACE DIMENSIONS  
 ±0.10 ALL TWO PLACE DIMENSIONS  
 ±1°00' ALL ANGULAR DIMENSIONS
  - DRAFT ANGLE PERMISSIBLE ONLY WITHIN DRAWING TOLERANCE.
  - SEALING SURFACE, NO WITNESS LINES OF DAMAGE PERMITTED.
  - ALL UNMARKED RADI TO BE 0.5 MAX., UNLESS OTHERWISE SPECIFIED
  - VENT HOLE SIZE AND LOCATION IS OPTIONAL.
  - THIS AREA TO REMAIN CLEAR FOR THE HARNESS ASSEMBLY.
  - TERMINAL POSITION IDENTIFICATION.
  - MATES WITH TYCO ELECTRONICS PART# 1438136-\*

THIS DRAWING IS A CONTROLLED DOCUMENT.		OWN R. VESTAL 15APR2005	TE Connectivity
DIMENSIONS: mm		CHK T. VALASEK 15APR2005	
		APVD T. VALASEK 15APR2005	NAME 70-WAY HARNESS ASSEMBLY
MATERIAL		PRODUCT SPEC	SIZE A100779
FINISH		APPLICATION SPEC	CAGE CODE C=1438136
CUSTOMER DRAWING		RESTRICTED TO	SCALE 2:1
		WEIGHT	SHEET 10 OF 11
		REVISIONS	REV G48

# HEADER INTERFACE KEYING OPTIONS

REVISIONS				
P.	LTN.	DESCRIPTION	DATE	APPD.
-	-	SEE SHEET 1	-	-

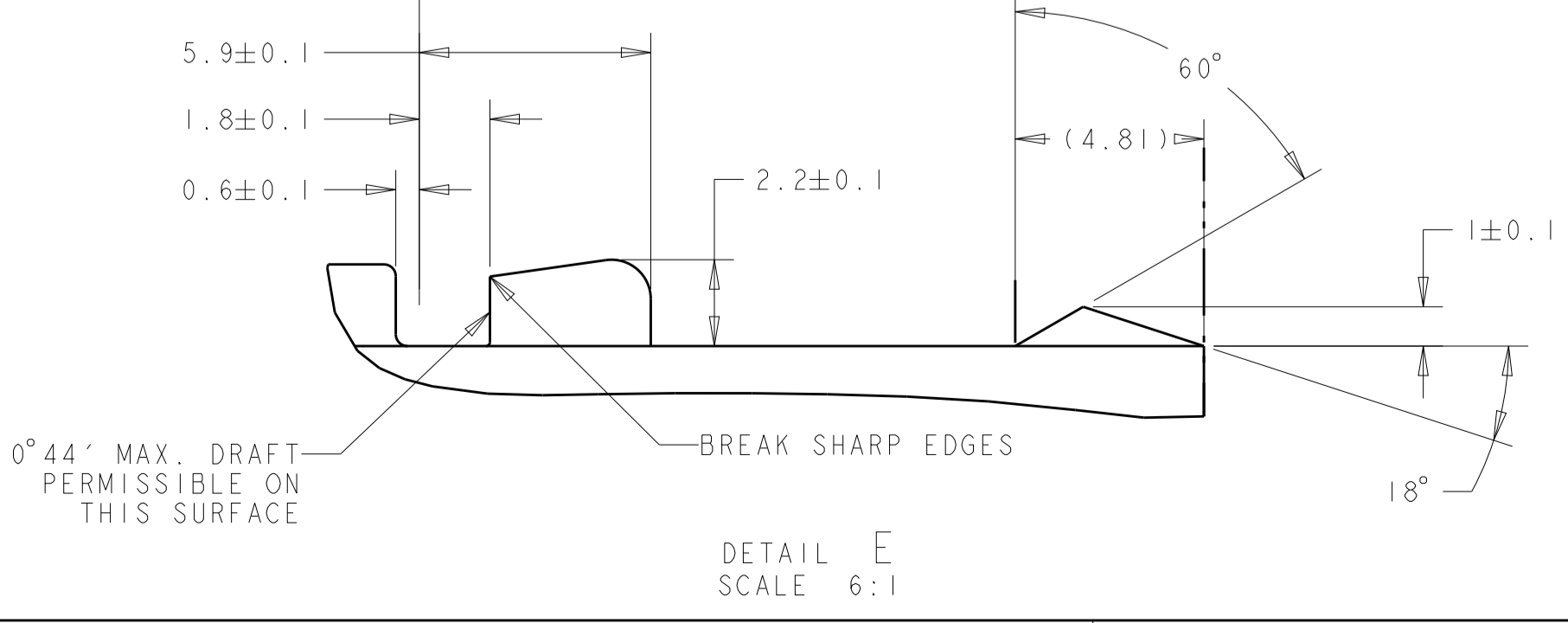
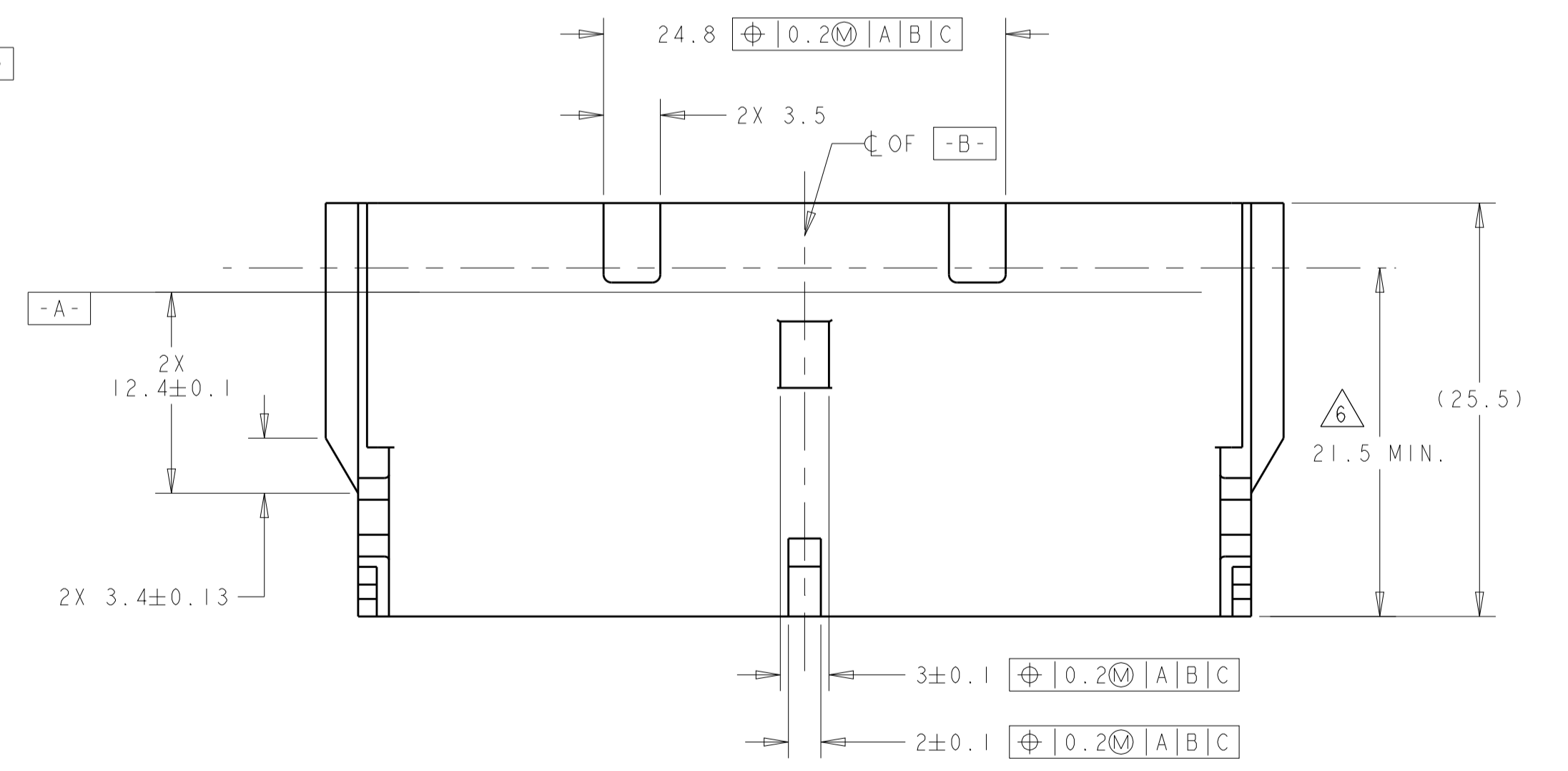
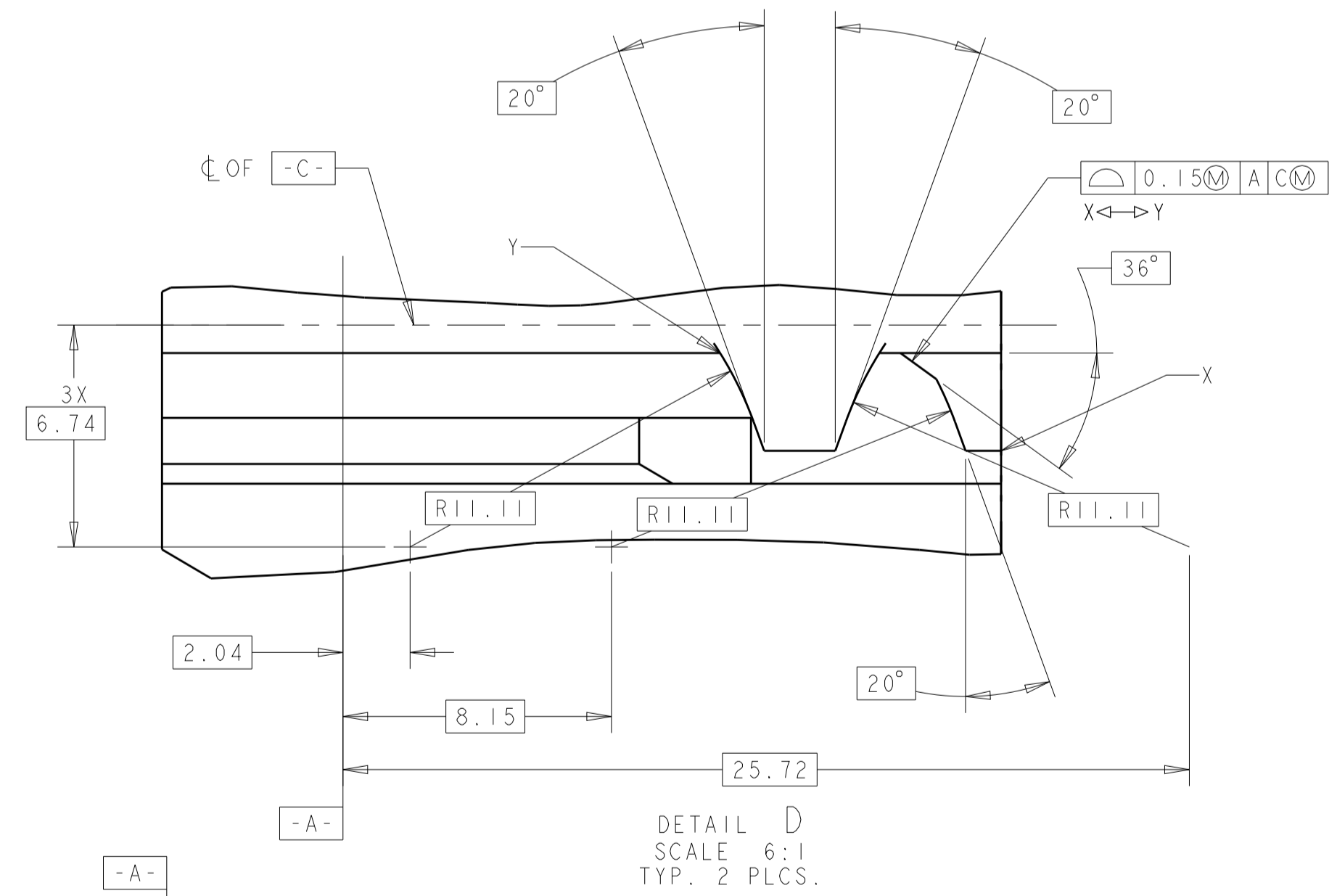
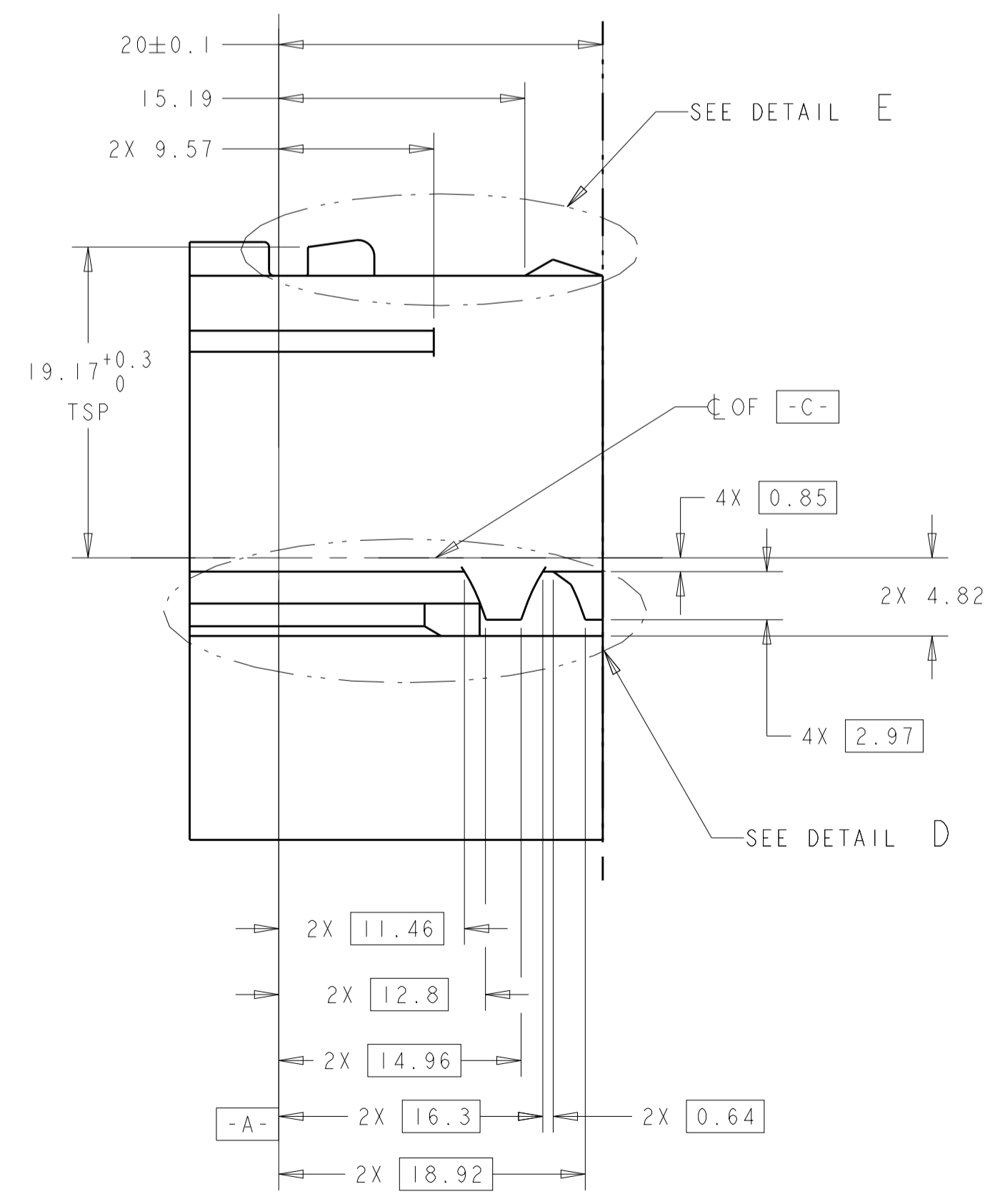
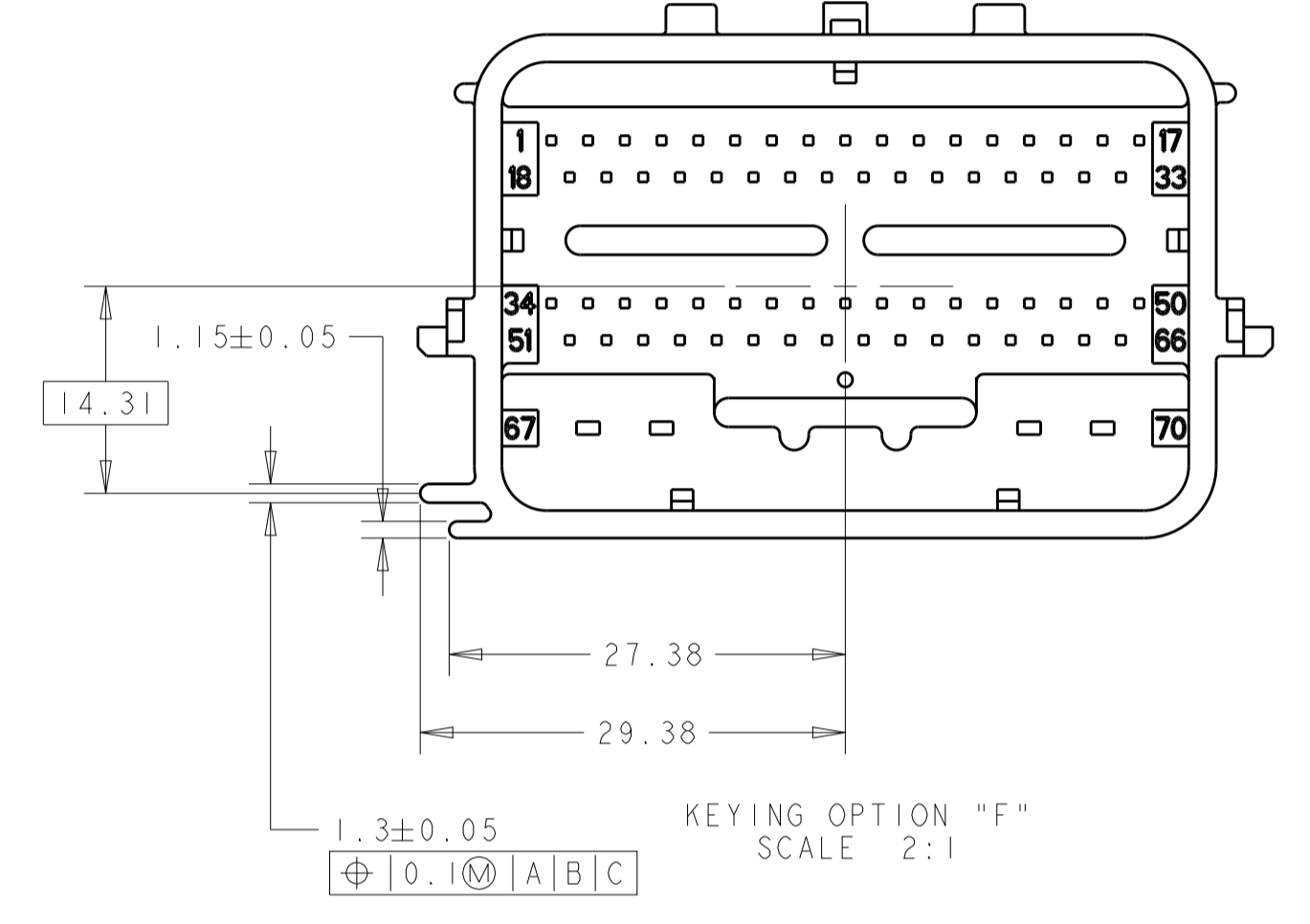
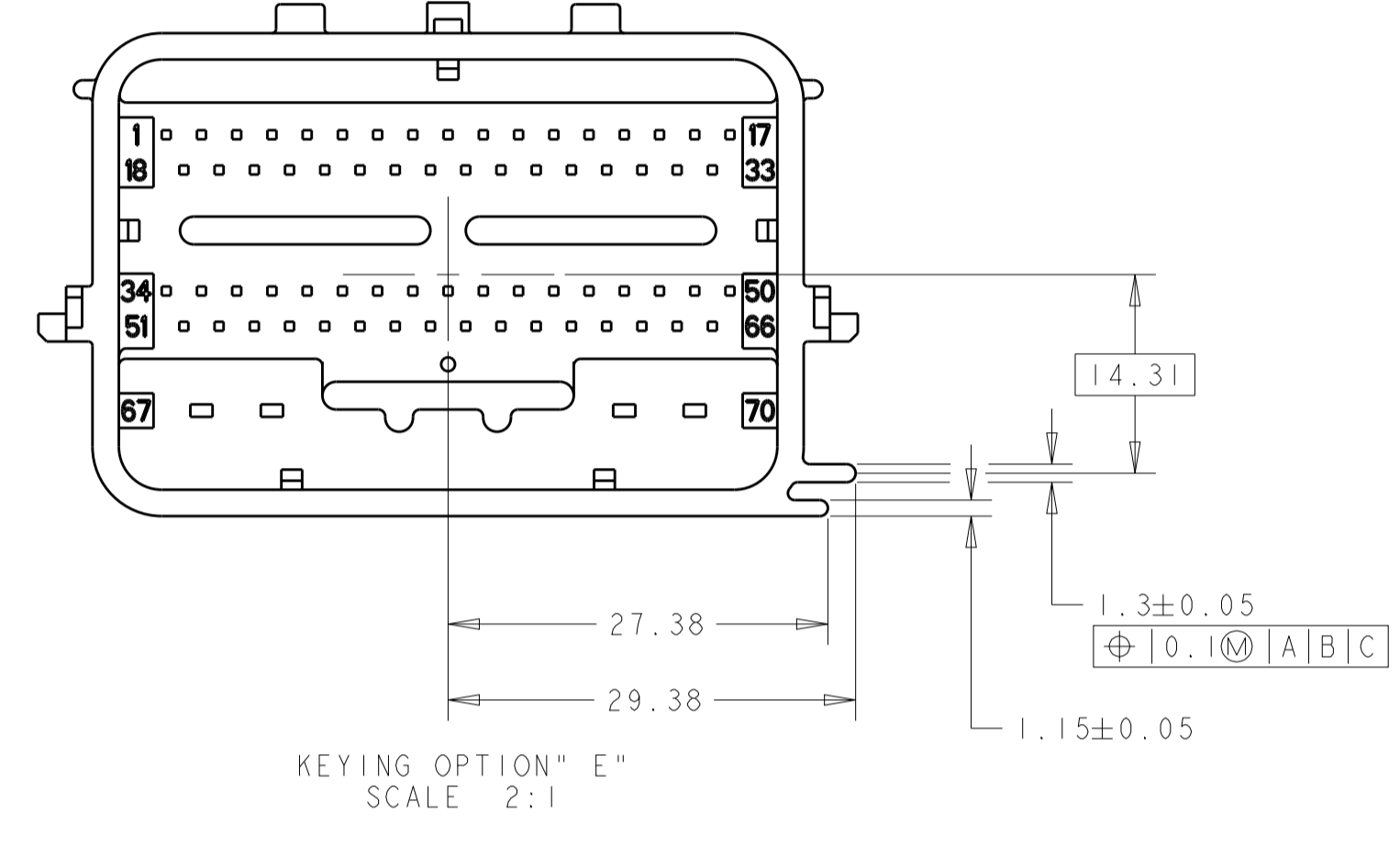
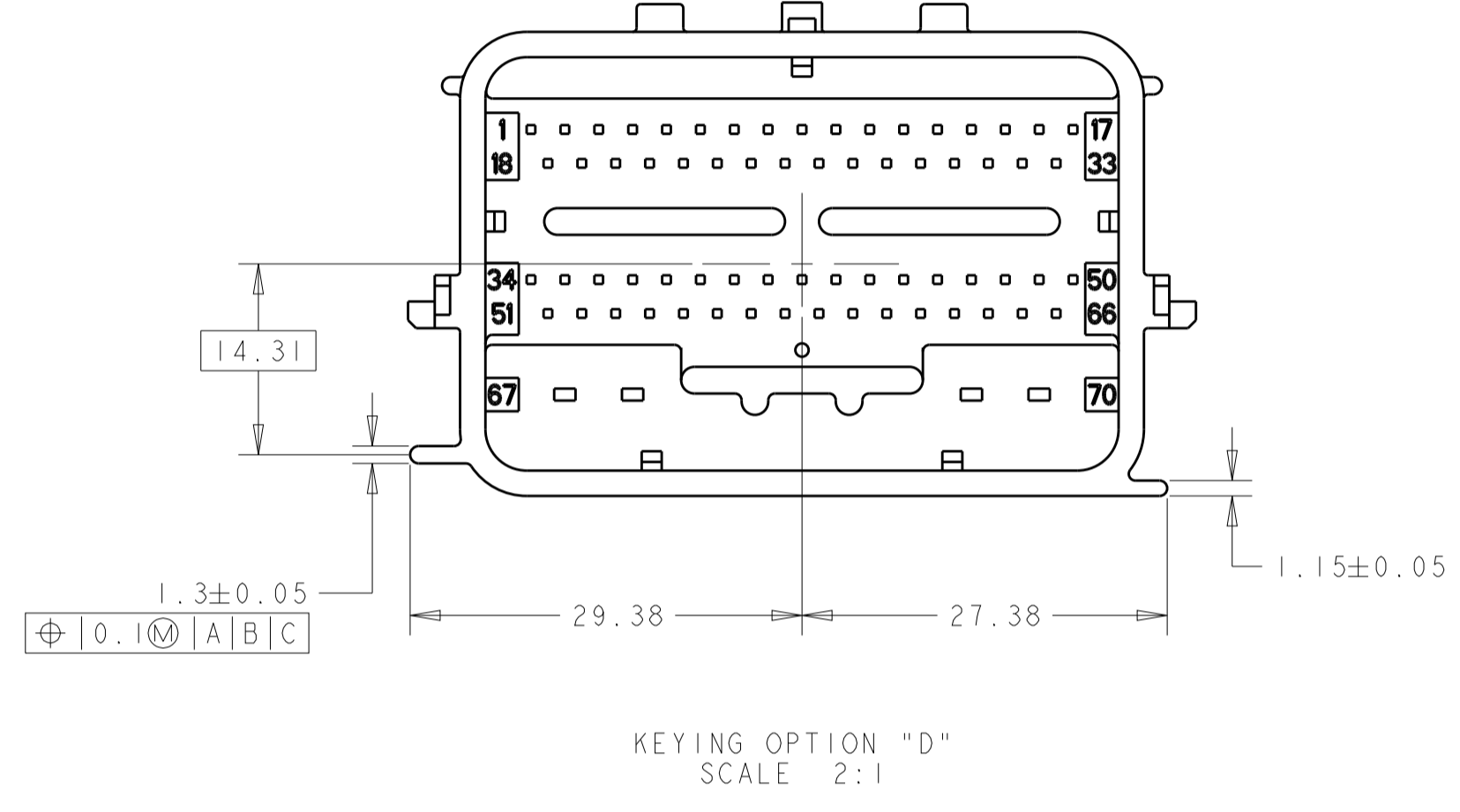
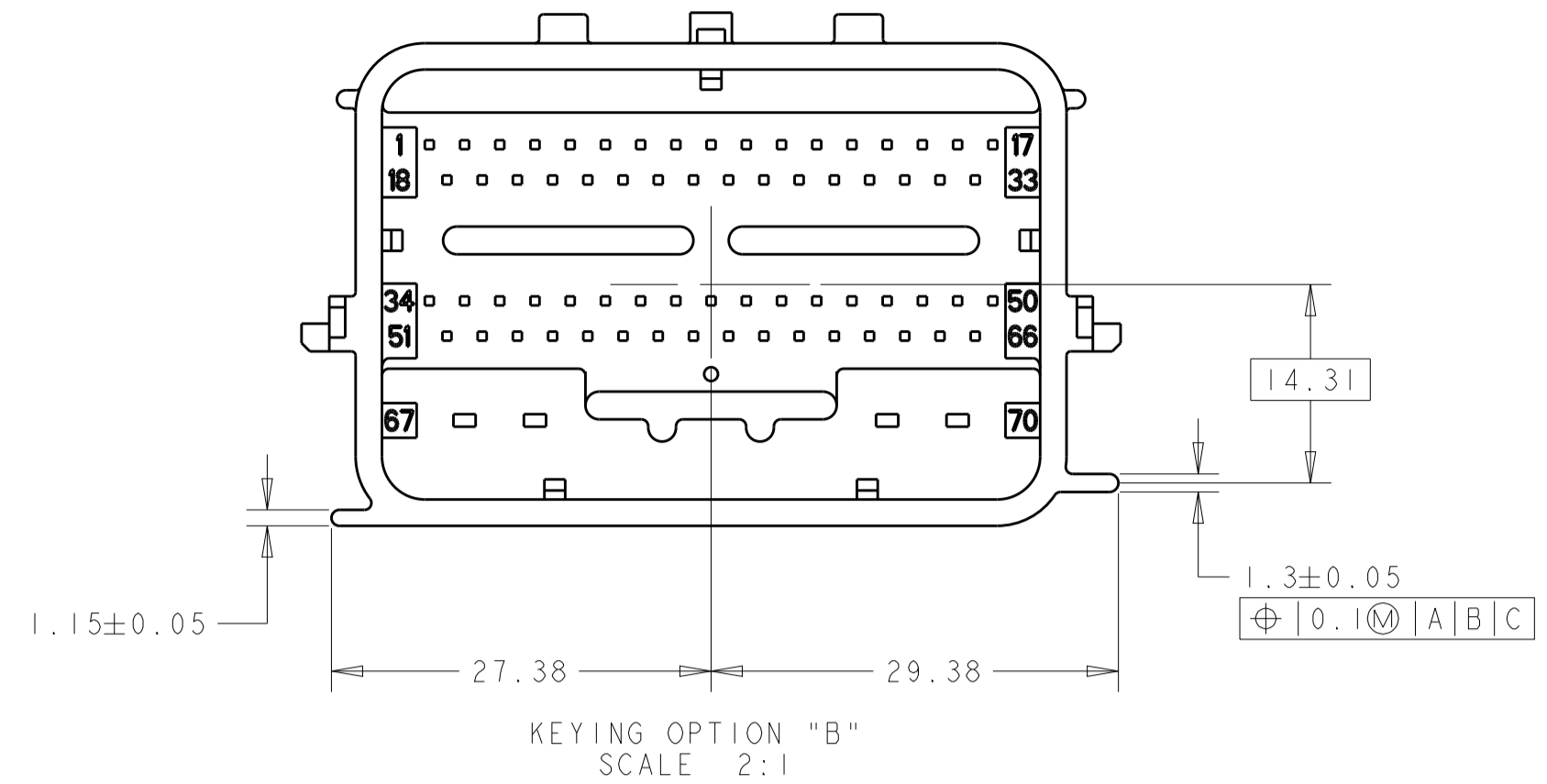
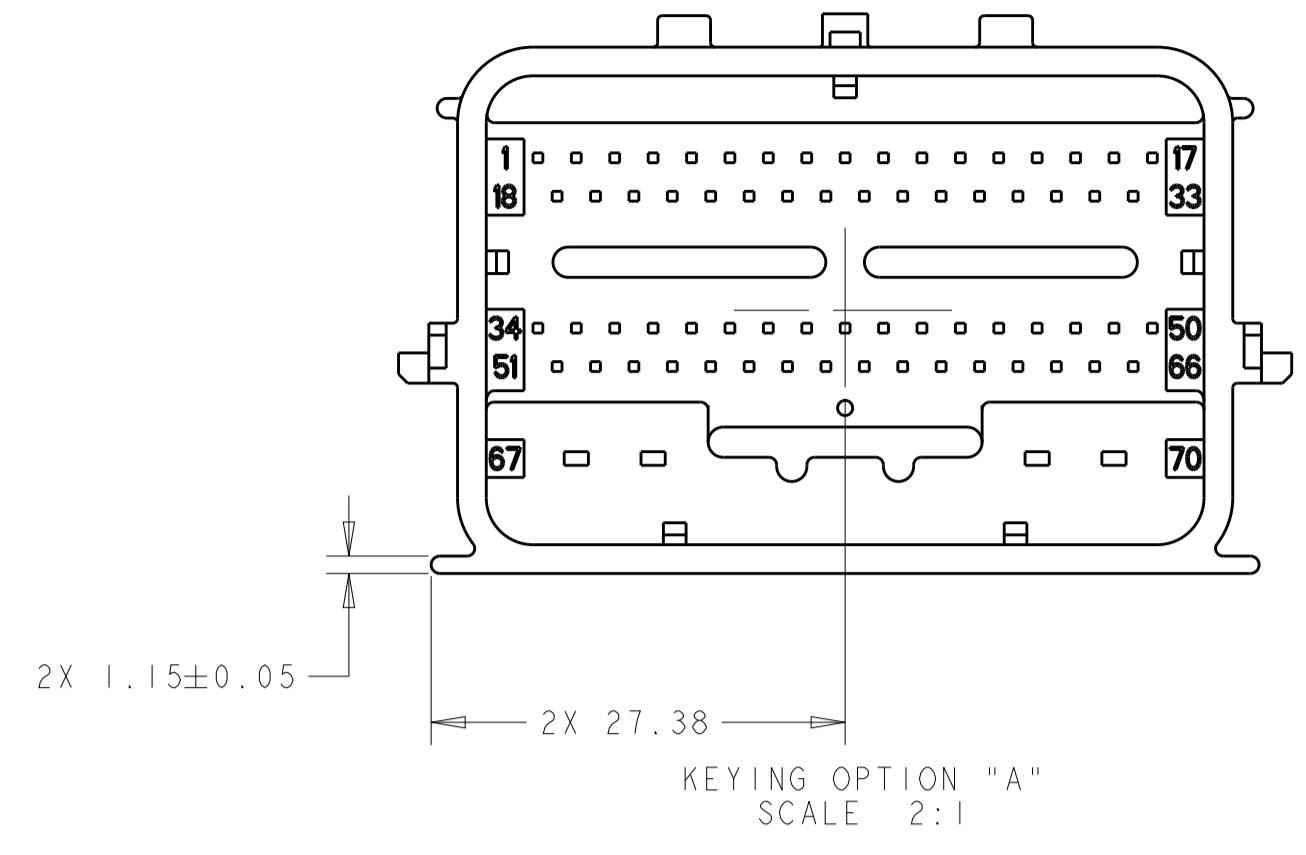

0° 44' MAX. DRAFT PERMISSIBLE ON THIS SURFACE

DETAIL E  
SCALE 6:1

THIS DRAWING IS A CONTROLLED DOCUMENT.		OWN: R. VESTAL 15APR2005	TE Connectivity
DIMENSIONS: mm		CHK: T. VALASEK 15APR2005	
TOLERANCES UNLESS OTHERWISE SPECIFIED:		APVD: T. VALASEK 15APR2005	NAME: 70-WAY HARNESS ASSEMBLY
0 PLC ±0.3	1 PLC ±0.3	PRODUCT SPEC	SIZE: CAGE CODE DRAWING NO
2 PLC ±0.10	3 PLC ±0.10	APPLICATION SPEC	RESTRICTED TO
4 PLC ±0.15	ANGLES ±0.1	WEIGHT	A100779C=1438136
MATERIAL	FINISH	CUSTOMER DRAWING	SCALE 2:1 SHEET 11 OF 11 REV 648

# Mouser Electronics

Authorized Distributor

Click to View Pricing, Inventory, Delivery & Lifecycle Information:

[TE Connectivity:](#)

[1-2035383-4](#)