

CB3MX

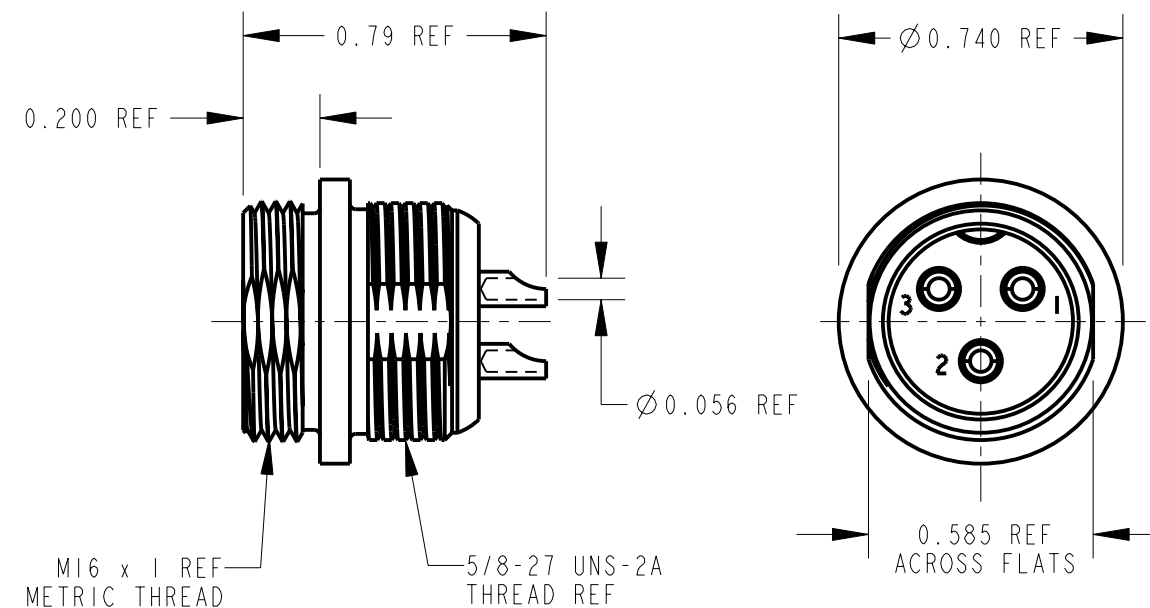

CB4MX

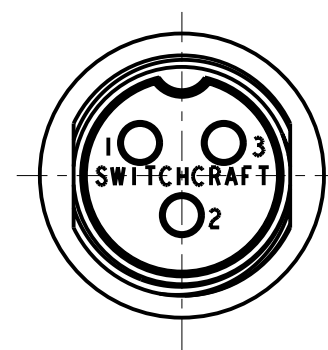
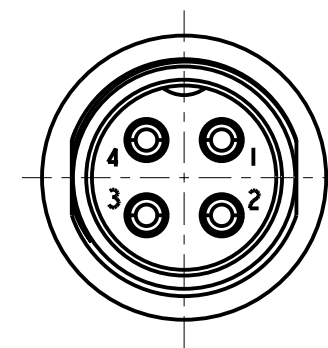
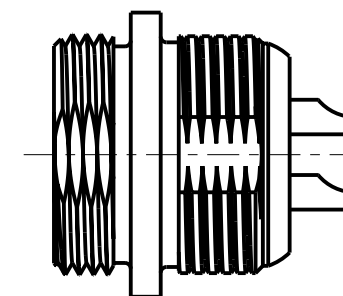
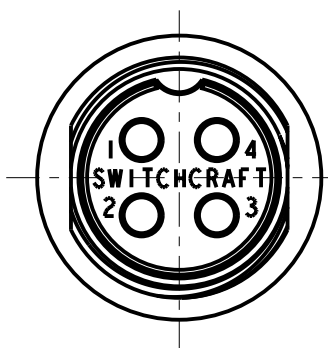

NOTES:

- MATERIALS
 - HOUSING, ZINC, NICKEL PLATED
 - INSULATOR, VALOX, BLACK
 - PINS, BRASS, SILVER PLATED
 - FLAT WASHER, STEEL, NICKEL PLATED
 - LOCK WASHER, SPRING STEEL, NICKEL PLATED
 - HEX NUT, BRASS, NICKEL PLATED
- THESE PRODUCTS ARE RoHS COMPLIANT.

CUSTOMER DRAWING

					<div>★ STAR SYMBOL DENOTES CRITICAL DIMENSION</div> <div>UNLESS OTHERWISE SPECIFIED</div> <div>1. ALL DIMENSIONS IN INCHES -TWO PLACE DECIMALS ±0.01 -THREE PLACE DECIMALS ±0.005 -ANGLES ±1° -ALL DIA. CONCENTRIC WITHIN 0.005 T.I.R.</div> <div>2. FEATURES ON THE SAME CENTERLINE MUST BE ALIGNED WITHIN ±0.002</div> <div>3. REMOVE ALL BURRS</div> <div>DO NOT SCALE DRAWING</div>	THIS DRAWING DESCRIBES A DESIGN CONSIDERED PROPRIETARY IN NATURE, DEVELOPED AND MANUFACTURED BY SWITCHCRAFT INC. AND IS RELEASED ON A CONFIDENTIAL BASIS FOR IDENTIFICATION PURPOSES ONLY.						
						SIZE	WIDTH		MULT	LBS/M	TEMPER	
						FINISH SPEC No.				MATERIAL SPEC No.		
						FIRST USED ON			SCALE 2:1		<div>Switchcraft®</div> <div>SHEET OF REV</div>	
						DATE DRAWN 08-Dec-06	BY TJK	CHKD TJK 12-8-06	APVD TJK 12-8-06	PART No. CB3MX CB4MX		
A	26150	12-8-06	TJK	TJK	NAME CB MALE RECEPTACLE ASSEMBLY, RoHS					A		
REV	ECO NUMBER	DATE	BY	APVD								
REVISIONS												

Mouser Electronics

Authorized Distributor

Click to View Pricing, Inventory, Delivery & Lifecycle Information:

[Switchcraft:](#)

[CB3M](#)