

Electronic housing - ME 22,5 F-UTG KMGY - 2201344

Please be informed that the data shown in this PDF Document is generated from our Online Catalog. Please find the complete data in the user's documentation. Our General Terms of Use for Downloads are valid (<http://phoenixcontact.com/download>)



Component housing, length: 99 mm, without vents, Lower part, Cross connection: without bus connector, color: light gray, width: 22.5 mm, height: 106 mm, number of positions cross connector: not relevant

Your advantages

- Item is from the ME product range
- Tool-free mounting
- Available in overall widths from 12.5 mm to 90 mm, modular extension is possible
- Inflammability class V0 according to UL 94
- Variety of connection technologies
- Can be mounted on the DIN rail
- Optional bus connector that is either integrated or mounted on the DIN rail



Key Commercial Data

Packing unit	10 pc
Minimum order quantity	250 pc
GTIN	 4 046356 768962
GTIN	4046356768962

Technical data

Standards and Regulations

Flammability rating according to UL 94	V0
--	----

Environmental Product Compliance

China RoHS	Environmentally friendly use period: unlimited = EFUP-e
	No hazardous substances above threshold values

Drawings

Electronic housing - ME 22,5 F-UTG KMGY - 2201344

Dimensional drawing

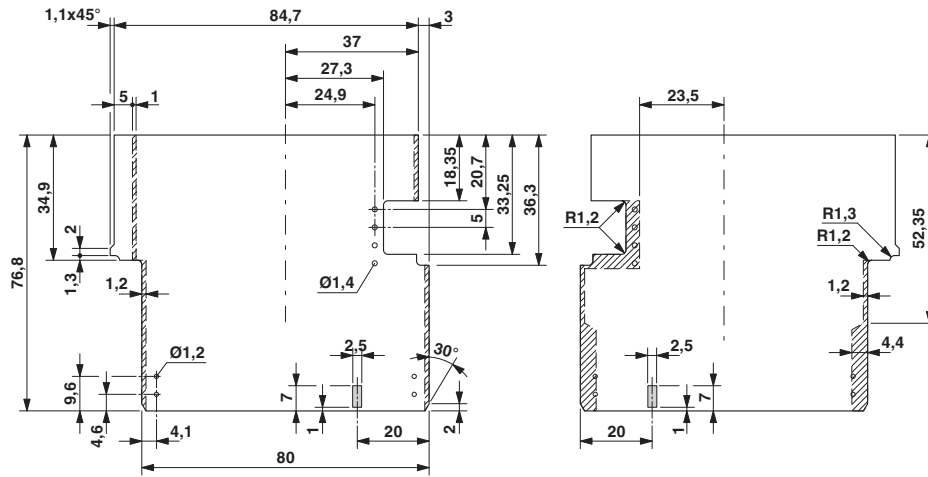

Dimensional drawing of the ME 22.5 flat... printed circuit board if the single-level upper part is used

Dimensional drawing

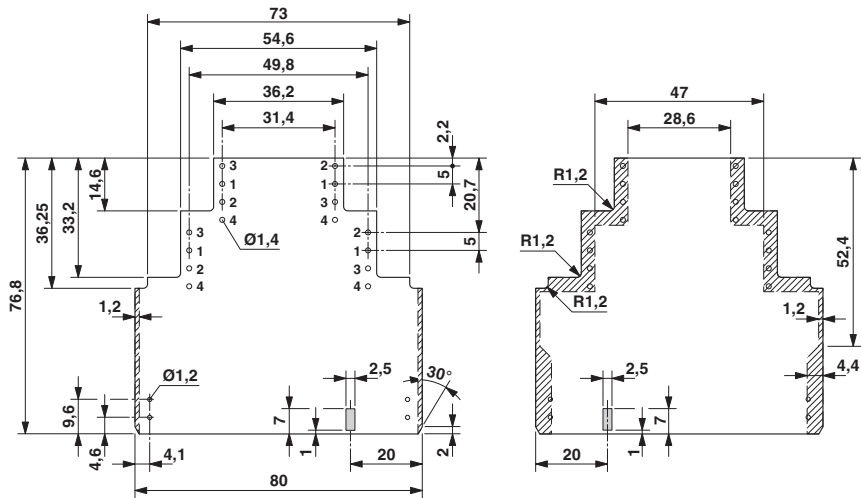

Dimensional drawing of the ME 22.5 flat... printed circuit board if the double level upper part is used

Electronic housing - ME 22,5 F-UTG KMGY - 2201344

Dimensional drawing

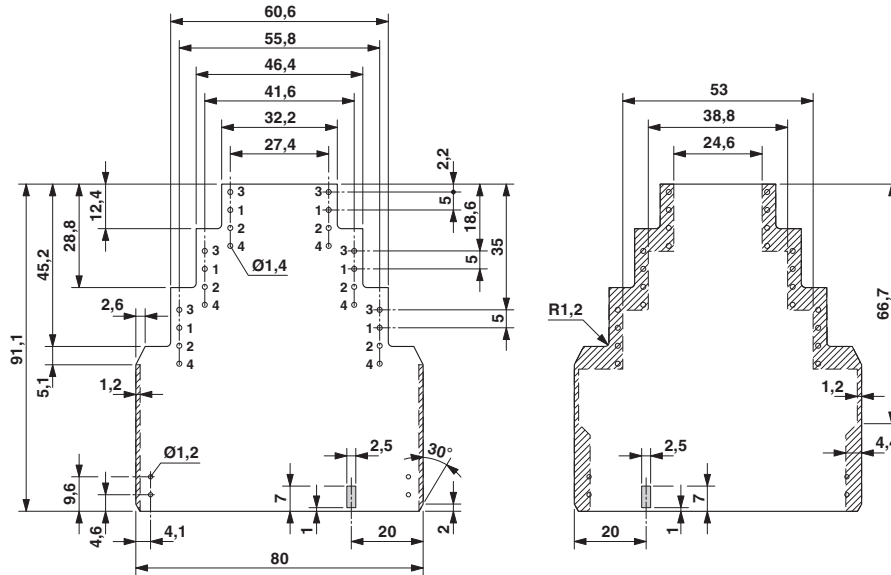

Dimensional drawing of the ME 22.5 flat... printed circuit board if the triple-level upper part is used

Phoenix Contact 2018 © - all rights reserved
<http://www.phoenixcontact.com>

PHOENIX CONTACT GmbH & Co. KG
Flachsmarktstr. 8
32825 Blomberg
Germany
Tel. +49 5235 300
Fax +49 5235 3 41200
<http://www.phoenixcontact.com>

Mouser Electronics

Authorized Distributor

Click to View Pricing, Inventory, Delivery & Lifecycle Information:

[Phoenix Contact:](#)

[2201344](#)