

THIS COPY IS PROVIDED ON A RESTRICTED BASIS AND IS NOT TO BE USED IN ANY WAY DETRIMENTAL TO THE INTERESTS OF PANDUIT CORP.

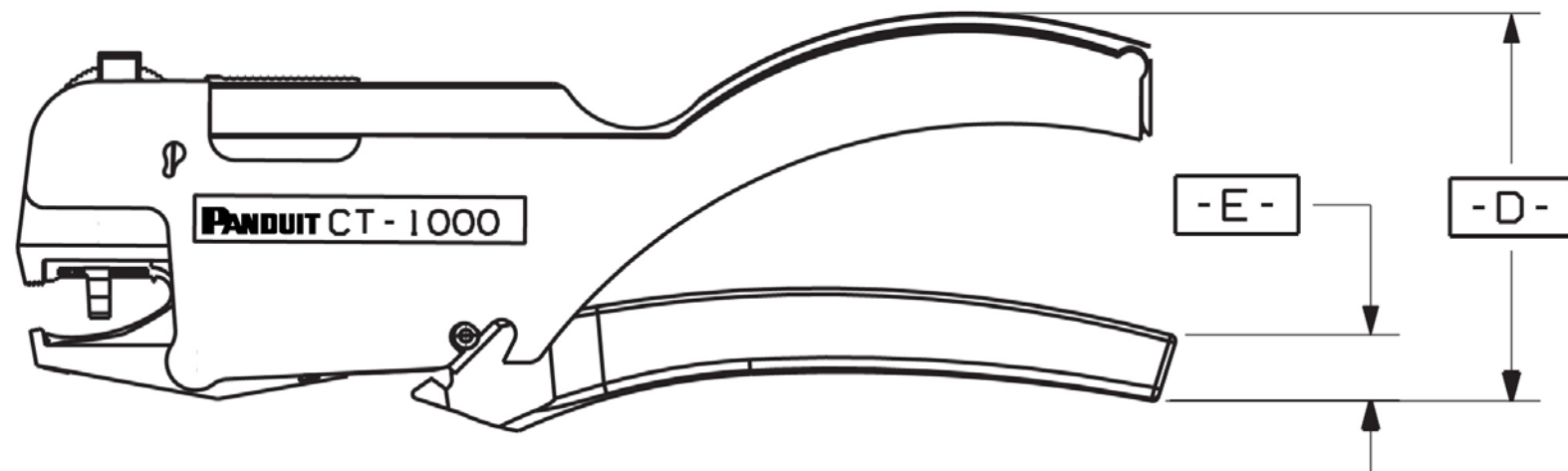
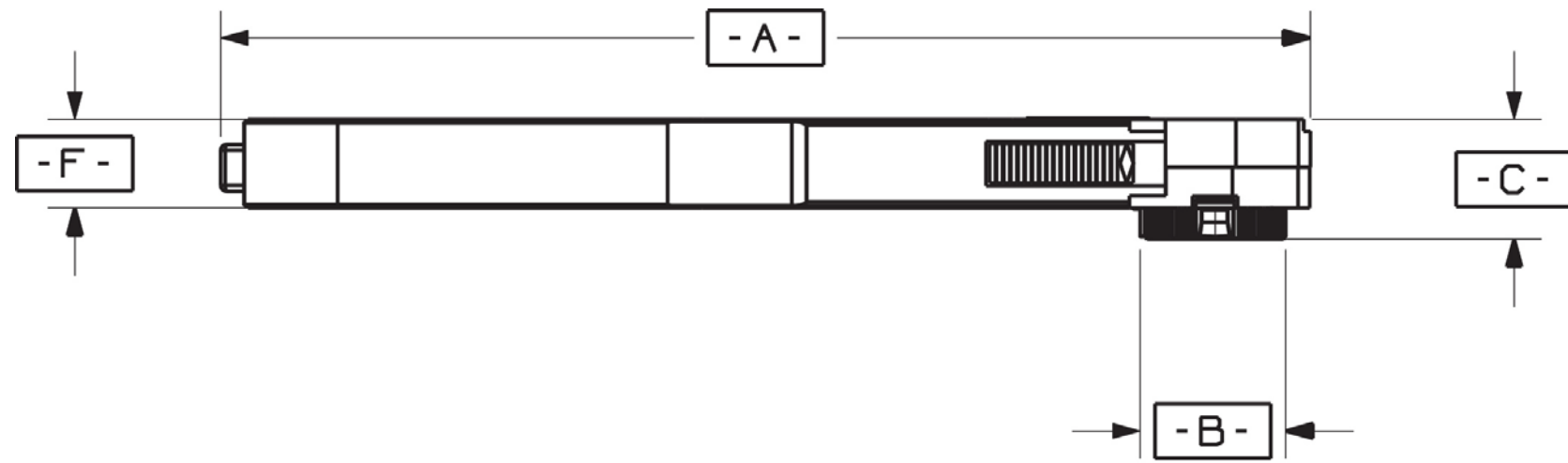

NOTES, UNLESS OTHERWISE SPECIFIED:

SPECIFICATIONS:
PANDUIT TOOL NO: CT-1000

TOOL WEIGHT: (WITHOUT FERRULES) 8.8 Oz (0,249 kg)

CRIMPS ALL STRIP FERRULE SIZES (MM²): 2,5; 1,5—1,0; 0,75—0,5

THIS TOOL'S FEATURES INCLUDE:

- EASY TOP LOADING OF STRIP FERRULES
- ADJUSTMENT KNOB TO SET FERRULES INTO CROSS SECTION SLOT
- EASY CRIMPING OF FERRULES ON THE STRIPPED WIRE
- STRIP AND CUT-OFF CAPABILITIES WITH THE CUT-OFF BLADE AND COMPLETE HAND CYCLE
- TOOL SPRING RETURNED TO OPEN POSITION AFTER CRIMPING

DIMENSIONS SHOWN IN PARENTHESES ARE (MM) METRIC (WITHOUT FERRULES).

| | | |
|----------|----------|--------------------|
| A = 8.25 | (210,00) | OVERALL LENGTH |
| B = 1.17 | (29,85) | OVERALL DIAMETER |
| C = 1.25 | (31,75) | OVERALL DEPTH |
| D = 4.05 | (102,87) | TOTAL HANDLE SPAN |
| E = 0.65 | (16,51) | REAR HANDLE HEIGHT |
| F = 0.86 | (21,84) | HANDLE WIDTH |

F:\RVUSERS\ENGDOCS\CUSTDWGS\TD25349B01_02 CD.doc

| REV | DATE | BY | CHK | APR | DESCRIPTION | ECN | CT-1000 TOOL | | | | | |
|-----|---------|-----|------|-----|-----------------------|------|---|------------------|-------------------------------|---------------|------------|-----------|
| | | | | | | | CUSTOMER DRAWING | | | | | |
| | | | | | | | ITEM REVISION NAME: TD25349B01_02 | | PANDUIT | | | |
| | | | | | | | UNLESS OTHERWISE SPECIFIED, DIMENSIONAL TOLERANCES ARE: (.x) ± --- (.xxx) ± --- (.xx) ± --- ANGLES ± --- | | MATERIAL: ----- | | | |
| 02 | 6-02-14 | BLR | BJPU | ABJ | UPD WEIGHTS | 4744 | THIRD ANGLE PROJECTION | | DRAWING NUMBER: TD25349B01 | | | |
| 01 | 6-24-13 | BLR | BJPU | ABJ | REDRAWN, UPD BRANDING | 4612 | DRAWN BY: TAD | DATE: 1-01-07 | CHK TAD | SCALE NONE | SHT 1 OF 1 | SIZE B |

Mouser Electronics

Authorized Distributor

Click to View Pricing, Inventory, Delivery & Lifecycle Information:

[Panduit:](#)

[CT-1000](#)