

THIS COPY IS PROVIDED ON A RESTRICTED BASIS AND IS NOT TO BE USED IN ANY WAY DETRIMENTAL TO THE INTERESTS OF PANDUIT CORP.

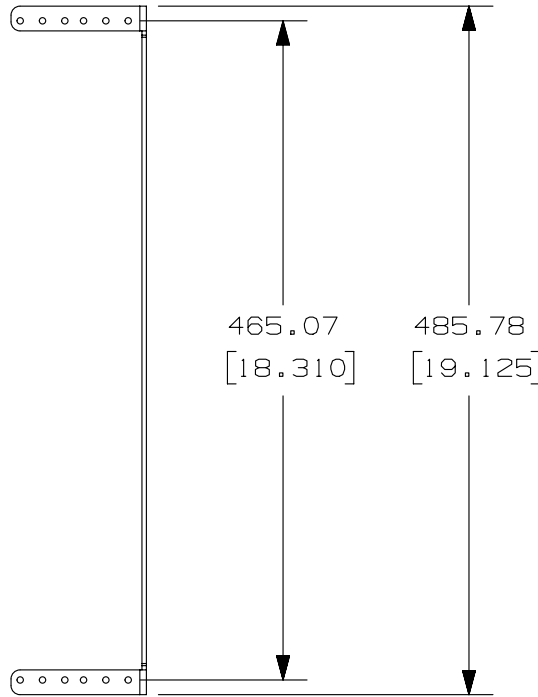

1. PANDUIT PART NUMBER: SN8VPPB
2. PRIMARY DIMENSIONS ARE IN MILLIMETERS (mm).
3. PARTS SUPPLIED:
 (1)-VERTICAL PATCH BRACKET
 (1)-HARDWARE KIT
 (4) M5 X 0.8mm SCREWS
 (1)-INSTRUCTION SHEET
4. ALLOWS ZERO RU VERTICAL MOUNTING OF 1 RU EIA 19" COPPER AND FIBER PATCH PANELS IN 800mm WIDE S-TYPE CABINETS.
5. MOUNTS TO SIDE OF EQUIPMENT RAIL.

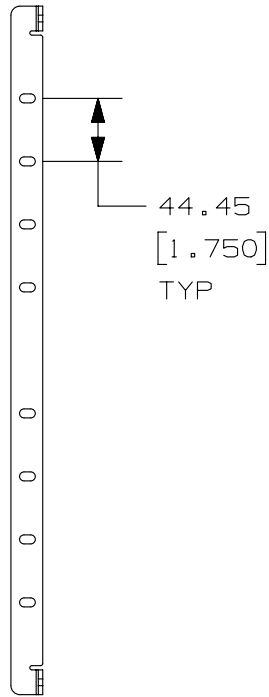
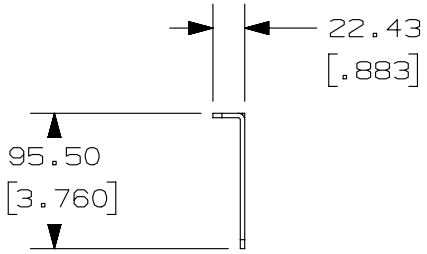
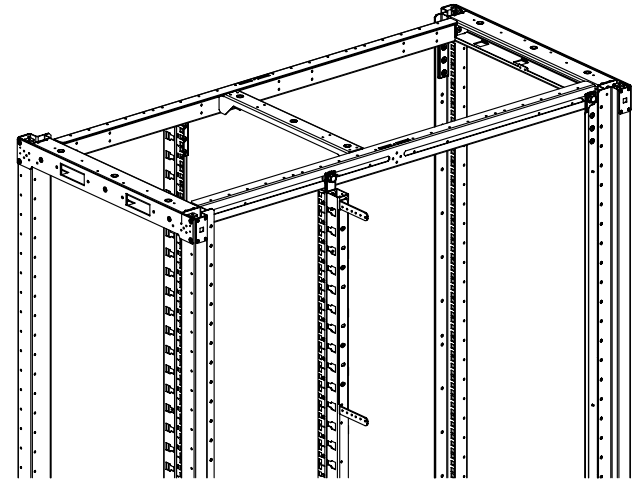

TITLE
VERTICAL PATCH BRACKET (SN8VPPB) FOR 800mm WIDE S-TYPE AND N-TYPE CABINETS CUSTOMER DRAWING

CUSTOMER DRAWING

ITEM REVISION NAME

13V379SA/00

DATASET FILE NAME

13V379SA_DC/00A



UNLESS OTHERWISE SPECIFIED,
 DIMENSIONAL TOLERANCES ARE: IN (mm)

MATERIAL:

SEE NOTES

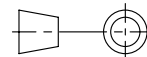

THIRD ANGLE
 PROJECTION

DRAWING NUMBER:

13V379SA - DC

00A	6/6/13	RAMA	JDWE	DRAWING RELEASED	13V379SA-DC
-----	--------	------	------	------------------	-------------

REV	DATE	BY	CHK	APR	DESCRIPTION	ECN	DRAWN BY	DATE	CHK	SCALE	DRAWING NUMBER	SIZE
							RAMA	6/6/13	JDWE	NONE	SHT 1 OF 1	A

Mouser Electronics

Authorized Distributor

Click to View Pricing, Inventory, Delivery & Lifecycle Information:

[Panduit:](#)

[SN8VPPB](#)