

THIS IS A C.A.D. GENERATED DRAWING
DO NOT MAKE MANUAL REVISIONS TO MASTER.

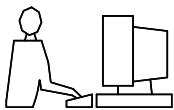

* UNLESS OTHERWISE SPECIFIED TOLERANCES
ON DECIMAL IS:
UNIT: MM

- BACKSHELL KIT INCLUDES:
- (2) BACKSHELL HALVES
 - (2) CLAMP
 - (2) CLAMP SCREWS
 - (2) SHELL SCREWS
 - (2) MOUNTING BRACKETS
 - (2) SCREWS

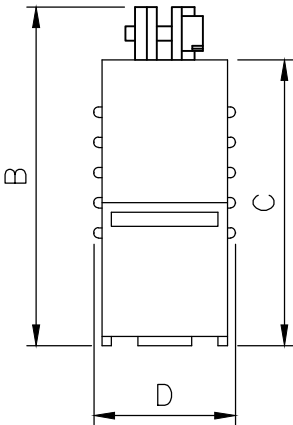
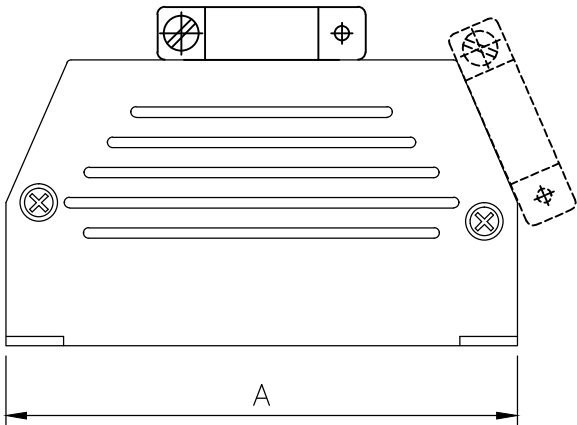

DIMENSIONS(MM/IN)				
SIZE	A±0.5	B±0.6	C±0.5	D±1.0
9	32.2	28.6	22.1	15.0
15	39.8	34.1	26.1	15.0
25	54.2	38.3	30.3	15.0
37	70.7	46.2	38.2	15.0

Ordering information:

SIZE	P/N-KITTED	Product Code
9-way	2801-0101-11	MHED-DS090F
15-way	2801-0101-12	MHED-DS150F
25-way	2801-0101-13	MHED-DS250F
37-way	2801-0101-14	MHED-DS370F

THESE DRAWINGS AND SPECIFICATIONS ARE THE
PROPERTY OF MH CONNECTORS LTD. AND SHALL NOT
BE REPRODUCED, COPIED OR USED AS THE BASIS FOR
THE MANUFACTURE OR SALE OF APPARATUS WITHOUT
WRITTEN PERMISSION.

DRAWN Haley		DATE 07-14-14	
APPROVED		DATE	
SCALE	SHEET 1 OF 1	OF	REV: 1.0
DRAWING No MHED-DSXXOF			



THIS SERIES FULLY CONFORMS TO THE
EUROPEAN UNION DIRECTIVES 2002/95/EC
AND 2002/96/EC FOR RoHS COMPLIANCY.



MH CONNECTORS LTD.

Mouser Electronics

Authorized Distributor

Click to View Pricing, Inventory, Delivery & Lifecycle Information:

[NorComp:](#)

[MHED-DS37OF-K](#) [MHED-DS25OF-K](#)