

DESCRIPTION: 972 SERIES D-SUB SLIM-LINE BACKSHELL

BACKSHELL KIT INCLUDES:

- (1) BACKSHELL
- (2) 4-40 THUMBSCREWS
- (1) PLASTIC STRAIN RELIEF
- (1) METAL STRAIN RELIEF CLAMP
- (2) STRAIN RELIEF SCREWS

TORQUE VALUE ON PLASTIC FOR STRAIN RELIEF SCREWS = 4 INCH POUNDS MAX.

972-YYY-01SRY1

SERIES _____
 POSITIONS _____
 009
 015
 025
 037
 MATERIAL _____
 01S = PLASTIC/SLIM LINE
 COLOR: _____
 01 = BLACK
 02 = WHITE
 03 = GREY
 04 = GREEN
 05 = BROWN - SPECIAL ORDER
 06 = RED
 07 = BLUE
 08 = YELLOW
 09 = BEIGE - SPECIAL ORDER
 11 = DEC GREY
 PUT-UPS _____
 1 = KIT

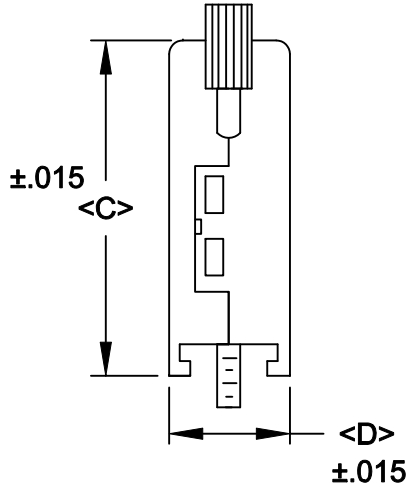
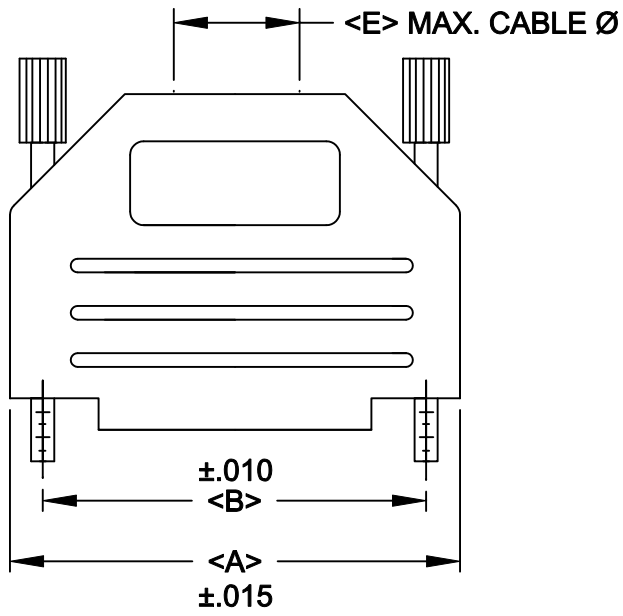

POS.	A	B	C	D	E
9	1.240	.984	1.339	.591	.315
	31.50	24.99	34.00	15.00	8.00
15	1.575	1.312	1.339	.591	.453
	40.00	33.32	34.00	15.00	11.50
25	2.106	1.852	1.575	.591	.453
	53.50	47.04	40.00	15.00	11.50
37	2.795	2.500	1.575	.591	.453
	71.00	63.50	40.00	15.00	11.50

MATERIAL: POLYAMIDE PA66 - UL 94H-B
MANY COLORS AVAILABLE

THUMBSCREWS: STEEL

OPERATING TEMP: -30°C TO +110°C
RoHS COMPLIANT

	THESE DRAWINGS AND SPECIFICATIONS ARE THE PROPERTY OF NorComp AND SHALL NOT BE REPRODUCED, COPIED OR USED AS THE BASIS FOR THE MANUFACTURE OF SALE OF APPARATUS WITHOUT WRITTEN PERMISSION.		DRAWN: PAM JENKINS	DATE: 6-10-05
			CHECKED:	DATE:
<h1>NorComp</h1>		SCALE:	SHEET 1 OF 1	REV 4
		DWG NO. 972-YYY-01SRY1		

Mouser Electronics

Authorized Distributor

Click to View Pricing, Inventory, Delivery & Lifecycle Information:

[NorComp:](#)

[972-025-01S-081](#) [972-025-01S-061](#) [972-009-01S-081](#) [972-037-01S-061](#) [972-037-01S-081](#) [972-015-01S-081](#)