

SPECIFICATIONS:

|                        |                            |
|------------------------|----------------------------|
| <b>ELECTRICAL:</b>     |                            |
| RATED CURRENT:         | 5A                         |
| RATED VOLTAGE:         | 300VDC                     |
| WITHSTANDING VOLTAGE:  | 500VAC (rms) FOR 1 MIN     |
| INSULATION RESISTANCE: | > 1,000 mΩ at 500VDC       |
| CONTACT RESISTANCE:    | 13mOhms MAX                |
| DIELECTRIC STRENGTH:   | 1000VAC FOR 1 MIN          |
| OPERATING TEMPERATURE: | -55°C TO +105°C            |
| <b>MATERIALS:</b>      |                            |
| SHELL:                 | NICKEL PLATED STEEL        |
| BRACKET:               | NICKEL PLATED STEEL        |
| INSULATOR:             | NYLON 6T, UL 94V-0, BLACK  |
| PROCESS TEMP:          | 260°C                      |
| INSULATOR:             | PATONE #322C, COLOR=Pc99   |
| CONTACT:               | TIN PLATED PHOSPHOR BRONZE |
|                        | MATING AREA (SEE P/N KEY)  |
|                        | TIN PLATED PCB SOLDER AREA |

190-025-163R00Y

CONTACT PLATING (MATING AREA):  
1 = GOLD FLASH  
2 = 30μ" GOLD

RoHS COMPLIANT



|   |                     |
|---|---------------------|
| THESE DRAWINGS AND SPECIFICATIONS ARE THE PROPERTY OF NorComp AND SHALL NOT BE REPRODUCED, COPIED OR USED AS THE BASIS FOR THE MANUFACTURE OR SALE OF APPARATUS WITHOUT WRITTEN PERMISSION. | DRAWN:<br>C. SMITH  |
|   | DATE:<br>04/14/2009 |

UNITS = inch [mm]

DO NOT SCALE FROM DRAWING

|         |                         |            |         |           |
|---------|-------------------------|------------|---------|-----------|
| NorComp | SCALE:<br>NTS           | SHEET<br>1 | OF<br>2 | REV<br>14 |
|         | DWG NO. 190-025-163R001 |            |         |           |

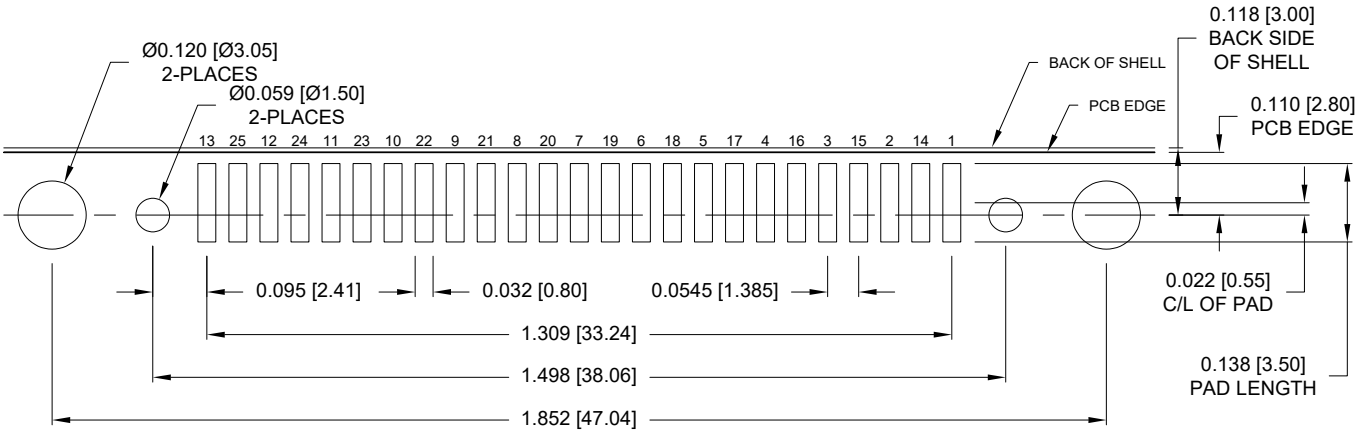

RECOMMENDED PCB LAYOUT

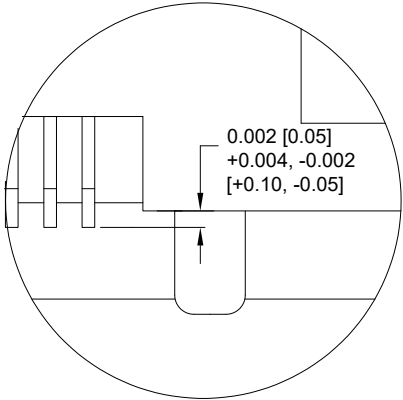

DETAIL "B"  
CONTACT COPLANARITY

SEE DETAIL "B"  
FOR CONTACT  
COPLANARITY

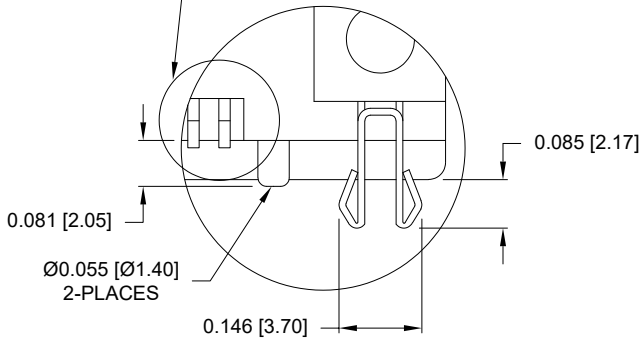

DETAIL "A"

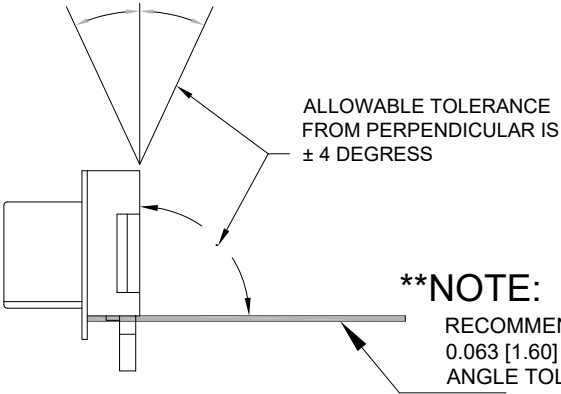

**\*\*NOTE:**  
RECOMMENDED PCB THICKNESS IS  
0.063 [1.60] ± 0.002 [0.05] TO MAINTAIN  
ANGLE TOLERANCE

RoHS COMPLIANT



THESE DRAWINGS AND SPECIFICATIONS ARE THE PROPERTY OF NorComp AND SHALL NOT BE REPRODUCED, COPIED OR USED AS THE BASIS FOR THE MANUFACTURE OR SALE OF APPARATUS WITHOUT WRITTEN PERMISSION.

DRAWN:  
C. SMITH

DATE:  
04/14/2009

UNITS = inch [mm]

DO NOT SCALE FROM DRAWING

NorComp

SCALE:  
NTS

SHEET OF  
2 2

REV  
14

DWG NO. 190-025-163R001

# Mouser Electronics

Authorized Distributor

Click to View Pricing, Inventory, Delivery & Lifecycle Information:

[NorComp:](#)

[190-025-163R001](#)