

LOOSE PIECE		TAPE MOUNTED		SPECIFICATIONS					
MATERIAL NUMBER	ENGINEERING NUMBER	MATERIAL NUMBER	ENGINEERING NUMBER	STUD SIZE	"S" ±.005 [0.13]	"W" ±.010 [0.25]	"C" MIN.	"L" MAX.	"H"
191410081	C-141-06	---	---	6	.146 [3.71]	.375 [9.53]	.301 [7.65]	.812 [20.62]	1.234 [31.35]
191410083	C-141-08	191410084	C-141-08T	8	.173 [4.39]				
191410085	C-141-10	191410086	C-141-10T	10	.198 [5.03]				

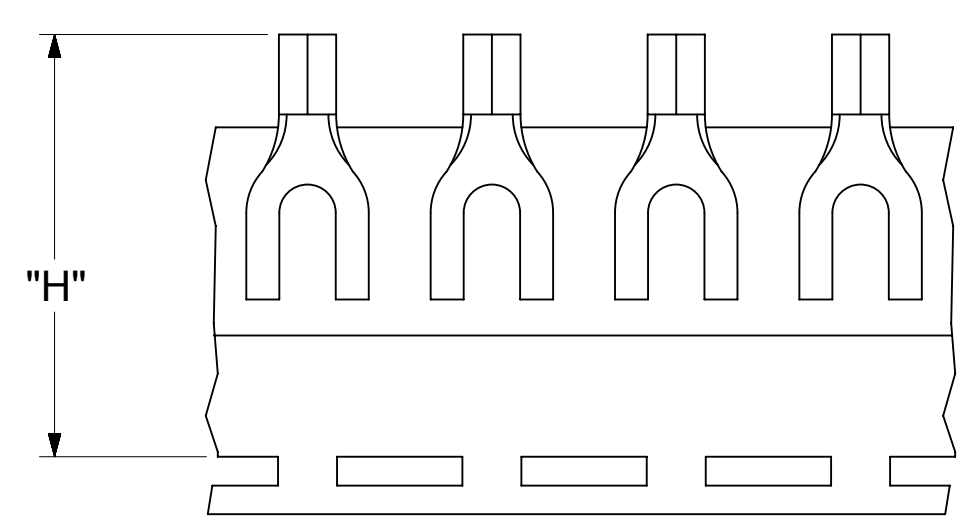
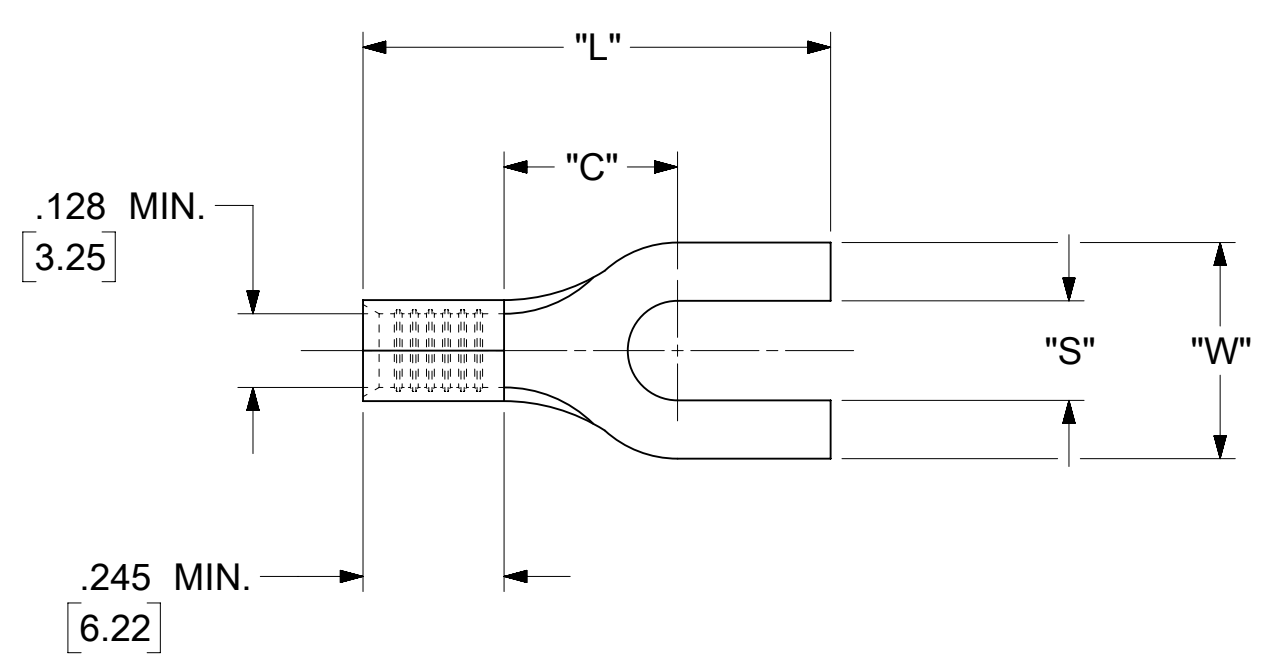

PARTS ON TAPE

NOTES:

1. MATERIAL: COPPER (.040±.001 [1.02] THK.)
2. PLATING: ELECTRO-TIN (.0003 MIN).
3. WIRE SIZE: 12-10 AWG  
4.0-6.0 MM<sup>2</sup>
4. "UL" LISTING #E32244  
"CSA" LISTING #18689
5. ALL DIMENSIONS IN INCHES/[MM].
6. PARTS ARE ROHS COMPLIANT.
7. DIMS. SHOWN ARE FOR REFERENCE ONLY.

SYMBOLS	THIS DRAWING CONTAINS INFORMATION THAT IS PROPRIETARY TO MOLEX ELECTRONIC TECHNOLOGIES, LLC AND SHOULD NOT BE USED WITHOUT WRITTEN PERMISSION										
	DIMENSION UNITS		SCALE		CURRENT REV DESC: MIGRATION TO ECTR/NX						
	INCH/MM		NTS		EC NO: 620815 DRWN: ABENJAMINLW 2019/07/03 CHK'D: GROJAS01 2019/07/18 APPR: JMACNEIL 2019/08/05						
	GENERAL TOLERANCES (UNLESS SPECIFIED)										
▽ = 0	4 PLACES	±	---	±	---	INITIAL REVISION: DRWN: JJ 1984/10/16 APPR: JMACNEIL 2019/08/05					
▽ = 0	3 PLACES	±	---	±	.005						
▽ = 0	2 PLACES	±	0.13	±	.01						
▽ = 0	1 PLACE	±	0.25	±	---	DOCUMENT NUMBER: 191410081 DOC TYPE: PSD DOC PART: 000 REVISION: A					
□ = 0	0 PLACES	±	---	±	---						
■ = 0	ANGULAR TOL ± 0.5 °				THIRD ANGLE PROJECTION		DRAWING		SERIES		
▽ = 0	DRAFT WHERE APPLICABLE MUST REMAIN WITHIN DIMENSIONS				C-SIZE		19141		MATERIAL NUMBER: SEE TABLE		
								CUSTOMER: GENERAL MARKET		SHEET NUMBER: 1 OF 1	

# Mouser Electronics

Authorized Distributor

Click to View Pricing, Inventory, Delivery & Lifecycle Information:

[Molex:](#)

[19141-0050](#)