

PLEASE CHECK WWW.MOLEX.COM FOR LATEST PART INFORMATION

Part Number: [0622018874](#)
Status: **Active**
Overview: [Application Tooling](#)
Description: Impact Backplane Press-In Tool

Documents:

[RoHS Certificate of Compliance \(PDF\)](#)

General

Product Family	Application Tooling
Series	207123
Function	Insertion
Geographic Area	Global
Level of Automation	Manual
More Detailed Tech Information	applicationtooling@molex.com
Overview	Application Tooling
Product Name	Impact
Tool Type	Press-Fit Insertion Tool
UPC	887191234366
Warranty Disclaimer	CAUTION: Molex tooling crimp specifications are valid only when used with Molex terminals and tooling manufactured by Molex and sold by Molex or authorized distributors ("Molex Tooling"). When using tooling other than Molex Tooling with Molex specific connector systems listed in our ATS documents, the Molex tooling qualification does not apply and the responsibility for full qualification of the connector system is that of the customer. Molex accepts no liability for connector performance or tooling support where tooling other than Molex Tooling is used or where Molex Tooling is modified.

Material Info

Reference - Drawing Numbers

Application Tooling Documents [ATS-622018874](#)

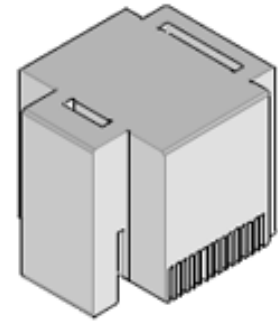

Series image - Reference only

EU ELV

Not Reviewed

EU RoHS

Not Reviewed

REACH SVHC

Not Reviewed

Halogen-Free

Status

Not Reviewed

For more information, please visit [Contact US](#)

China ROHS

Not Reviewed

ELV

Not Reviewed

RoHS Phthalates

Not Reviewed

Search Parts in this Series

[207123 Series](#)

Use With

[76145](#) Impact 100 Ohm Vertical Backplane Signal Module Assembly

Application Tooling | **FAQ**

Description	Product #
--------------------	------------------

Impact 100 Ohm 6 Pair Vertical Backplane Header, Unguided, Open Endwall, 16 Columns, 288 Circuits, Pin Length 4.50mm, Plated Through Hole Dimension 0.46mm, Lead-Free	761451603
---	---------------------------

Impact 100 Ohm 6 Pair Vertical Backplane Header, Unguided, Open Endwall, 16 Columns, 288 Circuits, Pin Length	761451604
---	---------------------------

4.90mm, Plated
Through Hole
Dimension 0.46mm,
Lead-Free
Impact 100 Ohm 761451605
6 Pair Vertical
Backplane Header,
Unguided, Open
Endwall, 16
Columns, 288
Circuits, Pin Length
5.50mm, Plated
Through Hole
Dimension 0.46mm,
Lead-Free
Impact 100 Ohm 761451606
6 Pair Vertical
Backplane Header,
Unguided, Open
Endwall, 16
Columns, 288
Circuits, Pin Length
4.50mm, Plated
Through Hole
Dimension 0.39mm,
Lead-Free
Impact 100 Ohm 761451607
6 Pair Vertical
Backplane Header,
Unguided, Open
Endwall, 16
Columns, 288
Circuits, Pin Length
4.90mm, Plated
Through Hole
Dimension 0.39mm,
Lead-Free
Impact 100 Ohm 761451608
6 Pair Vertical
Backplane Header,
Unguided, Open
Endwall, 16
Columns, 288
Circuits, Pin Length
5.50mm, Plated
Through Hole
Dimension 0.39mm,
Lead-Free
Impact 100 Ohm 761451613
6 Pair Vertical
Backplane Header,
Unguided, Left
Endwall, 16
Columns, 288
Circuits, Pin Length
4.50mm, Plated
Through Hole
Dimension 0.46mm,
Lead-Free
Impact 100 Ohm 761451614
6 Pair Vertical
Backplane Header,
Unguided, Left
Endwall, 16
Columns, 288

Circuits, Pin Length
4.90mm, Plated
Through Hole
Dimension 0.46mm,
Lead-Free

Impact 100 Ohm 761451615

6 Pair Vertical
Backplane Header,
Unguided, Left
Endwall, 16
Columns, 288

Circuits, Pin Length
5.50mm, Plated
Through Hole
Dimension 0.46mm,
Lead-Free

Impact 100 Ohm 761451616

6 Pair Vertical
Backplane Header,
Unguided, Left
Endwall, 16
Columns, 288

Circuits, Pin Length
4.50mm, Plated
Through Hole
Dimension 0.39mm,
Lead-Free

Impact 100 Ohm 761451617

6 Pair Vertical
Backplane Header,
Unguided, Left
Endwall, 16
Columns, 288

Circuits, Pin Length
4.90mm, Plated
Through Hole
Dimension 0.39mm,
Lead-Free

Impact 100 Ohm 761451618

6 Pair Vertical
Backplane Header,
Unguided, Left
Endwall, 16
Columns, 288

Circuits, Pin Length
5.50mm, Plated
Through Hole
Dimension 0.39mm,
Lead-Free

Impact 100 Ohm 761451623

6 Pair Vertical
Backplane Header,
Unguided, Dual
Endwall, 16
Columns, 288

Circuits, Pin Length
4.50mm, Plated
Through Hole
Dimension 0.46mm,
Lead-Free

Impact 100 Ohm 761451624

6 Pair Vertical
Backplane Header,
Unguided, Dual
Endwall, 16

Columns, 288
Circuits, Pin Length
4.90mm, Plated
Through Hole
Dimension 0.46mm,
Lead-Free
Impact 100 Ohm 761451625
6 Pair Vertical
Backplane Header,
Unguided, Dual
Endwall, 16
Columns, 288
Circuits, Pin Length
5.50mm, Plated
Through Hole
Dimension 0.46mm,
Lead-Free
Impact 100 Ohm 761451626
6 Pair Vertical
Backplane Header,
Unguided, Dual
Endwall, 16
Columns, 288
Circuits, Pin Length
4.50mm, Plated
Through Hole
Dimension 0.39mm,
Lead-Free
Impact 100 Ohm 761451627
6 Pair Vertical
Backplane Header,
Unguided, Dual
Endwall, 16
Columns, 288
Circuits, Pin Length
4.90mm, Plated
Through Hole
Dimension 0.39mm,
Lead-Free
Impact 100 Ohm 761451628
6 Pair Vertical
Backplane Header,
Unguided, Dual
Endwall, 16
Columns, 288
Circuits, Pin Length
5.50mm, Plated
Through Hole
Dimension 0.39mm,
Lead-Free
Impact 100 Ohm 761451633
6 Pair Vertical
Backplane Header,
Unguided, Right
Endwall, 16
Columns, 288
Circuits, Pin Length
4.50mm, Plated
Through Hole
Dimension 0.46mm,
Lead-Free
Impact 100 Ohm 761451634
6 Pair Vertical
Backplane Header,
Unguided, Right

Endwall, 16
Columns, 288
Circuits, Pin Length
4.90mm, Plated
Through Hole
Dimension 0.46mm,
Lead-Free
Impact 100 Ohm 761451635
6 Pair Vertical
Backplane Header,
Unguided, Right
Endwall, 16
Columns, 288
Circuits, Pin Length
5.50mm, Plated
Through Hole
Dimension 0.46mm,
Lead-Free
Impact 100 Ohm 761451636
6 Pair Vertical
Backplane Header,
Unguided, Right
Endwall, 16
Columns, 288
Circuits, Pin Length
4.50mm, Plated
Through Hole
Dimension 0.39mm,
Lead-Free
Impact 100 Ohm 761451637
6 Pair Vertical
Backplane Header,
Unguided, Right
Endwall, 16
Columns, 288
Circuits, Pin Length
4.90mm, Plated
Through Hole
Dimension 0.39mm,
Lead-Free
Impact 100 Ohm 761451638
6 Pair Vertical
Backplane Header,
Unguided, Right
Endwall, 16
Columns, 288
Circuits, Pin Length
5.50mm, Plated
Through Hole
Dimension 0.39mm,
Lead-Free
Impact 100 Ohm 761453603
6 Pair Vertical
Backplane Header,
Left Guided,
Open Endwall,
16 Columns, 288
Circuits, Pin Length
4.50mm, Plated
Through Hole
Dimension 0.46mm,
Lead-Free
Impact 100 Ohm 761453604
6 Pair Vertical
Backplane Header,

Left Guided,
Open Endwall,
16 Columns, 288
Circuits, Pin Length
4.90mm, Plated
Through Hole
Dimension 0.46mm,
Lead-Free

Impact 100 Ohm [761453605](#)

6 Pair Vertical
Backplane Header,
Left Guided,
Open Endwall,
16 Columns, 288
Circuits, Pin Length
5.50mm, Plated
Through Hole
Dimension 0.46mm,
Lead-Free

Impact 100 Ohm [761453606](#)

6 Pair Vertical
Backplane Header,
Left Guided,
Open Endwall,
16 Columns, 288
Circuits, Pin Length
4.50mm, Plated
Through Hole
Dimension 0.39mm,
Lead-Free

Impact 100 Ohm [761453607](#)

6 Pair Vertical
Backplane Header,
Left Guided,
Open Endwall,
16 Columns, 288
Circuits, Pin Length
4.90mm, Plated
Through Hole
Dimension 0.39mm,
Lead-Free

Impact 100 Ohm [761453608](#)

6 Pair Vertical
Backplane Header,
Left Guided,
Open Endwall,
16 Columns, 288
Circuits, Pin Length
5.50mm, Plated
Through Hole
Dimension 0.39mm,
Lead-Free

Impact 100 Ohm [761453614](#)

6 Pair Vertical
Backplane Header,
Left Guided,
Open Endwall,
16 Columns, 288
Circuits, Pin Length
4.90mm, Plated
Through Hole
Dimension 0.46mm,
Keying Orientation A,
Lead-Free

Impact 100 Ohm 761453667
6 Pair Vertical
Backplane Header,
Left Guided,
Open Endwall,
16 Columns, 288
Circuits, Pin Length
4.90mm, Plated
Through Hole
Dimension 0.39mm ,
Keying Orientation F,
Lead-Free

Impact 100 Ohm 761455603
6 Pair Vertical
Backplane Header,
Right Guided,
Open Endwall,
16 Columns, 288
Circuits, Pin Length
4.50mm, Plated
Through Hole
Dimension 0.46mm,
Lead-Free

Impact 100 Ohm 761455604
6 Pair Vertical
Backplane Header,
Right Guided,
Open Endwall,
16 Columns, 288
Circuits, Pin Length
4.90mm, Plated
Through Hole
Dimension 0.46mm,
Lead-Free

Impact 100 Ohm 761455605
6 Pair Vertical
Backplane Header,
Right Guided,
Open Endwall,
16 Columns, 288
Circuits, Pin Length
5.50mm, Plated
Through Hole
Dimension 0.46mm,
Lead-Free

Impact 100 Ohm 761455606
6 Pair Vertical
Backplane Header,
Right Guided,
Open Endwall,
16 Columns, 288
Circuits, Pin Length
4.50mm, Plated
Through Hole
Dimension 0.39mm,
Lead-Free

Impact 100 Ohm 761455607
6 Pair Vertical
Backplane Header,
Right Guided,
Open Endwall,
16 Columns, 288
Circuits, Pin Length
4.90mm, Plated
Through Hole

Dimension 0.39mm,
Lead-Free

Impact 100 Ohm 761455608

6 Pair Vertical
Backplane Header,
Right Guided,
Open Endwall,
16 Columns, 288
Circuits, Pin Length
5.50mm, Plated
Through Hole

Dimension 0.39mm,
Lead-Free

Impact 100 Ohm 761455614

6 Pair Vertical
Backplane Header,
Right Guided,
Open Endwall,
16 Columns, 288
Circuits, Pin Length
4.90mm, Plated
Through Hole

Dimension 0.46mm ,
Keying Orientation A,
Lead-Free

Impact 100 Ohm 761455617

6 Pair Vertical
Backplane Header,
Right Guided,
Open Endwall,
16 Columns, 288
Circuits, Pin Length
4.90mm, Plated
Through Hole

Dimension 0.39mm ,
Keying Orientation A,
Lead-Free

Impact 100 Ohm 761457603

6 Pair Vertical
Backplane Header,
Left Guided,
Right Endwall,
16 Columns, 288
Circuits, Pin Length
4.50mm, Plated
Through Hole

Dimension 0.46mm,
Lead-Free

Impact 100 Ohm 761457604

6 Pair Vertical
Backplane Header,
Left Guided,
Right Endwall,
16 Columns, 288
Circuits, Pin Length
4.90mm, Plated
Through Hole

Dimension 0.46mm,
Lead-Free

Impact 100 Ohm 761457605

6 Pair Vertical
Backplane Header,
Left Guided,
Right Endwall,
16 Columns, 288

Circuits, Pin Length
5.50mm, Plated
Through Hole
Dimension 0.46mm,
Lead-Free

Impact 100 Ohm 761457606

6 Pair Vertical
Backplane Header,
Left Guided,
Right Endwall,
16 Columns, 288

Circuits, Pin Length
4.50mm, Plated
Through Hole
Dimension 0.39mm,
Lead-Free

Impact 100 Ohm 761457607

6 Pair Vertical
Backplane Header,
Left Guided,
Right Endwall,
16 Columns, 288

Circuits, Pin Length
4.90mm, Plated
Through Hole
Dimension 0.39mm,
Lead-Free

Impact 100 Ohm 761457608

6 Pair Vertical
Backplane Header,
Left Guided,
Right Endwall,
16 Columns, 288

Circuits, Pin Length
5.50mm, Plated
Through Hole
Dimension 0.39mm,
Lead-Free

Impact 100 Ohm 761457636

6 Pair Vertical
Backplane Header,
Left Guided,
Right Endwall,
16 Columns, 288

Circuits, Pin Length
4.50mm, Plated
Through Hole
Dimension 0.39mm,
Polarizing Key

Position C, Lead
Free

Impact 100 Ohm 761459603

6 Pair Vertical
Backplane Header,
Right Guided,
Left Endwall, 16
Columns, 288

Circuits, Pin Length
4.50mm, Plated
Through Hole
Dimension 0.46mm,
Lead-Free

Impact 100 Ohm 761459604

6 Pair Vertical
Backplane Header,

Right Guided,
Left Endwall, 16
Columns, 288
Circuits, Pin Length
4.90mm, Plated
Through Hole
Dimension 0.46mm,
Lead-Free

Impact 100 Ohm 761459605

6 Pair Vertical
Backplane Header,
Right Guided,
Left Endwall, 16
Columns, 288
Circuits, Pin Length
5.50mm, Plated
Through Hole
Dimension 0.46mm,
Lead-Free

Impact 100 Ohm 761459606

6 Pair Vertical
Backplane Header,
Right Guided,
Left Endwall, 16
Columns, 288
Circuits, Pin Length
4.50mm, Plated
Through Hole
Dimension 0.39mm,
Lead-Free

Impact 100 Ohm 761459607

6 Pair Vertical
Backplane Header,
Right Guided,
Left Endwall, 16
Columns, 288
Circuits, Pin Length
4.90mm, Plated
Through Hole
Dimension 0.39mm,
Lead-Free

Impact 100 Ohm 761459608

6 Pair Vertical
Backplane Header,
Right Guided,
Left Endwall, 16
Columns, 288
Circuits, Pin Length
5.50mm, Plated
Through Hole
Dimension 0.39mm,
Lead-Free

Impact 100 Ohm 761459616

6 Pair Vertical
Backplane Header,
Right Guided,
Left Endwall, 16
Columns, 288
Circuits, Pin Length
4.50mm, Plated
Through Hole
Dimension 0.39mm,
Lead Free

This document was generated on 02/27/2021

PLEASE CHECK WWW.MOLEX.COM FOR LATEST PART INFORMATION

Mouser Electronics

Authorized Distributor

Click to View Pricing, Inventory, Delivery & Lifecycle Information:

[Molex:](#)

[62201-8874](#)