

C&K MIL Series 1-4 Pole Miniature Right

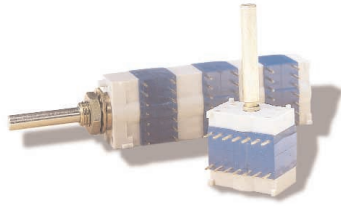

Features/Benefits

- Bushing option for panel mounting
- 1 to 4 poles per bank and up to 5 banks per switch
- Totally sealed (insert molded contacts and terminals)
- Low profile – 12 mm above PCB

Typical Applications

- Telecom switching equipment
- Military communications
- Instrumentation
- Medical monitors

Specifications

CONTACT RATING: Switch: 20 mA, 1 VA max. resistive load
Carry: 1 AMP.
ELECTRICAL LIFE: 20,000 operations.
OPERATING TORQUE: < 6 Ncm.
STOP STRENGTH: > 50 Ncm.
CONTACT RESISTANCE: < 40 mΩ
INSULATION RESISTANCE: 10⁹ Ω
DIELECTRIC STRENGTH: 500 V rms
OPERATING TEMPERATURE: -40°C to + 85°C
STORAGE TEMPERATURE: -55°C to + 85°C

NOTE: Specifications and materials listed above are for switches with standard options. For information on specific and custom switches, consult Customer Service Center.

Materials

HOUSING: Thermoplastic (nylon) and thermoset (diallyl phthalate)
ACTUATOR: Steel
MOVABLE CONTACTS: Brass, gold plated.
ROTOR: Thermoset (polysulfone)
O-RING: Silicone
STATIONARY CONTACTS & TERMINALS: Brass, gold plated.
TERMINAL SEAL: Totally sealed (insert molded).
BUSHING: Brass
STOP PIN: Stainless steel
HARDWARE: Nut: Brass, nickel plated. Washer: Brass, nickel plated.
Gasket: Neopren.

Build-A-Switch

To order, simply select desired option from each category and place in the appropriate box. Available options are shown and described on pages K-23 thru K-25. For additional options not shown in catalog, consult Customer Service Center.



Designation

MIL

Number of Banks

- 1 (STD.) 1 Bank
- 2 2 Banks
- 3 3 Banks
- 4 4 Banks
- 5 5 Banks

Switch Function

- 112S (STD.) SP, 30° Index, 12 pos. no stop
- 102B02 SP, 30° Index, 2 pos.
- 103B03 SP, 30° Index, 3 pos.
- 104B04 SP, 30° Index, 4 pos.
- 105B05 SP, 30° Index, 5 pos.
- 106B06 SP, 30° Index, 6 pos.
- 107B07 SP, 30° Index, 7 pos.
- 108B08 SP, 30° Index, 8 pos.
- 109B09 SP, 30° Index, 9 pos.
- 110B10 SP, 30° Index, 10 pos.
- 111B11 SP, 30° Index, 11 pos.
- 112B12 (STD.) SP, 30° Index, 12 pos.
- 206S (STD.) DP, 30° Index, 6 pos. no stop
- 202B02 DP, 30° Index, 2 pos.
- 203B03 DP, 30° Index, 3 pos.
- 204B04 DP, 30° Index, 4 pos.
- 205B05 DP, 30° Index, 5 pos.
- 206B06 (STD.) DP, 30° Index, 6 pos.
- 303S 3P, 30° Index, 3 pos. no stop
- 302B02 3P, 30° Index, 2 pos.
- 303B03 3P, 30° Index, 3 pos.
- 402S 4P, 30° Index, 2 pos. no stop
- 402B02 4P, 30° Index, 2 pos.

Switching Mode

- N (STD.) Non-shorting BBM (break-before-make)
- C Shorting, MBB (make-before-break)

Mounting Style

- SD (STD.) Without panel mount
- AD (STD.) With panel mount

Actuator Option

- (NONE) (STD.) 4 mm diameter shaft
- M10X3 4 mm shaft with flat
- F2X1 4 mm shaft with screwdriver slot

Actuator Option Angle*

- (NONE) (STD.)
- K0 0° angle
- K30 30° angle
- K60 60° angle
- K90 90° angle
- K120 120° angle
- K180 180° angle
- K270 270° angle

Actuator Option Length**

- 25 (STD.) 25 mm standard shaft

* Other angles available by request
** Other lengths available by request.



Rotary K

C&K MIL Series 1-4 Pole Miniature Right

DESIGNATION



MIL

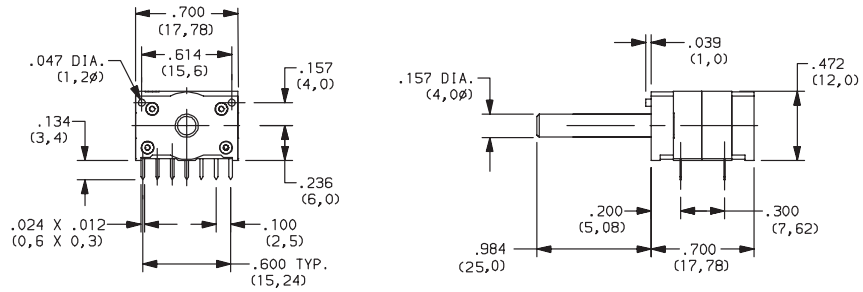

NUMBER OF BANKS



OPTION CODE	DIM. 'L'	WITH BUSHING DIM. 'L'
1	.770 (17,78)	.897 (22,78)
2	1.400 (35,56)	1.597 (40,56)
3	2.100 (53,34)	2.297 (58,34)
4	2.800 (71,12)	3.00 (76,12)
5	3.500 (88,90)	3.697 (93,90)

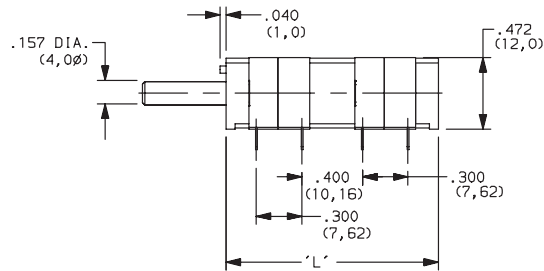

SWITCH FUNCTION

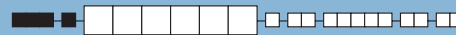

30° INDEXING		
NO. POLES	MODEL NO.	SWITCH FUNCTION
SP	112S	12 Position No Stops
	102B02	2 Positions
	103B03	3 Positions
	104B04	4 Positions
	105B05	5 Positions
	106B06	6 Positions
	107B07	7 Positions
	108B08	8 Positions
	109B09	9 Positions
	110B10	10 Positions
	111B11	11 Positions
	112B12	12 Positions

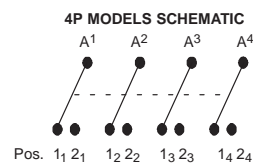
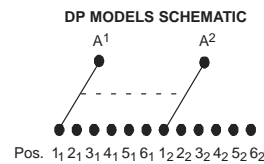
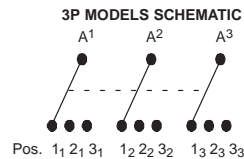
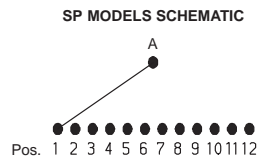

30° INDEXING		
NO. POLES	MODEL NO.	SWITCH FUNCTION
DP	206S	4 Position No Stops
	202B02	2 Positions
	203B03	3 Positions
	204B04	4 Positions
	205B05	5 Positions
	206B06	6 Positions
3P	303S	3 Positions No Stop
	302B02	2 Positions
	303B03	3 Positions
4P	402S	2 Positions No Stop
	402B02	2 Positions

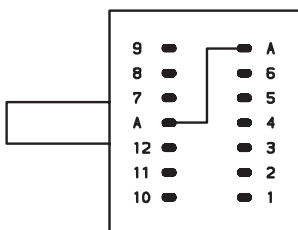

1 POLE
2 - 12 POSITIONS

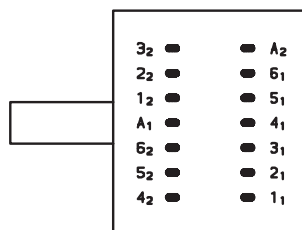

2 POLES
2 - 6 POSITIONS

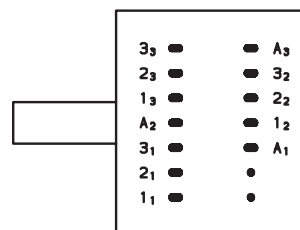

3 POLES
2 - 3 POSITIONS

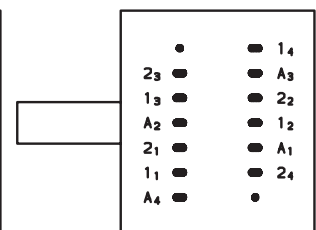

4 CIRCUITS
2 POSITIONS



Third Angle
Projection



K

Rotary

C&K MIL Series 1-4 Pole Miniature Right

SWITCHING MODE



- N** (STD.) NON-SHORTING, BBM (break-before-make)
- C** SHORTING, MBB (make-before-break)

MOUNTING STYLE



SD WITHOUT

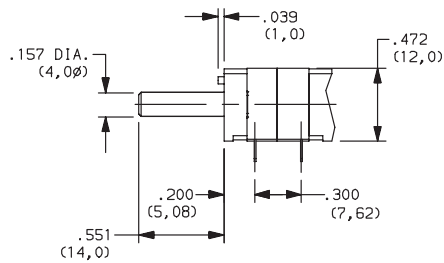

AD WITH PANEL MOUNT

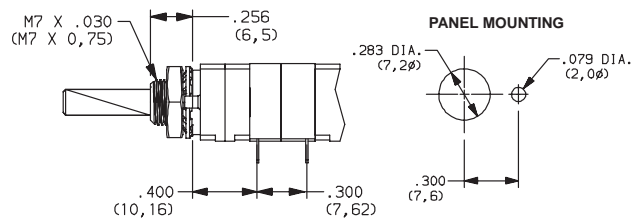

ACTUATOR OPTION



(NONE) (STD.) .157 DIA. (4,0)

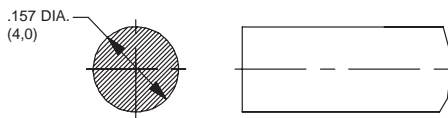

F2X1 SCREWCRIEVER SLOT

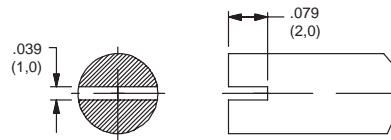

M10X3 FLAT

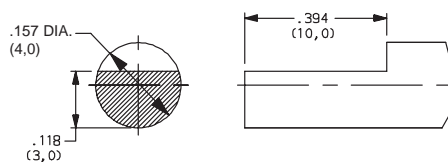

Third Angle
Projection

Dimensions are shown: IN (mm)
Dimensions subject to change



K

Rotary

ACTUATOR OPTION ANGLE



(NONE) (STD.)

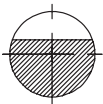

K0 (STD.) 0 ANGLE

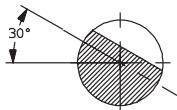

K30 30°

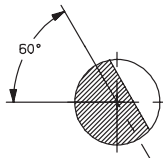

K60 60°

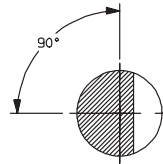

K90 90°

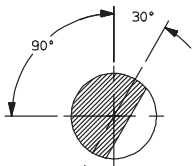

K120 120°

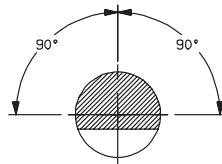

K180 210°

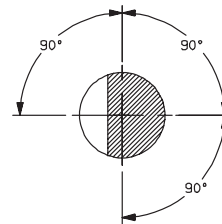

K270 300°



K0 (STD.) 0 ANGLE

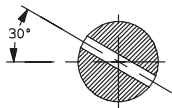

K30 30°

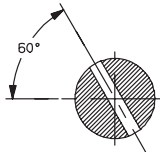

K60 60°

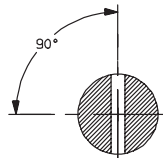

K90 90°

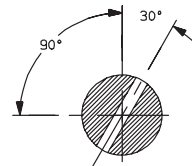

K120 120°



K

Rotary

ACTUATOR LENGTH



25 0,25 mm (.984) STANDARD SHAFT

Other lengths available by request.

Mouser Electronics

Authorized Distributor

Click to View Pricing, Inventory, Delivery & Lifecycle Information:

C&K Switches:

[MIL1106B06NSD25](#) [MIL1112B12NAD25](#) [MIL1112B12NSD25](#) [MIL1206B06NSD25](#) [MIL1206SNAD25](#)
[MIL1206B06NAD25](#)