

## SUMMARY

### # Wires

Low voltage 7



*Image is for illustrative purpose only*

Series 1P  
Termination type Female print PCB  
IP rating 50  
AWG wire size 0.00 - 0.00  
Cable Ø 0.00 - 0.00 mm  
Status active  
Matching parts [PAG.M0.7NL.AC52N](#)

### Download

[Request a quote](#)  
[PCB Eagle Pattern](#)  
[PCB Altium Pattern](#)  
[PCB KiCad Pattern](#)  
[Catalog](#)

## TECHNICAL DETAILS

### Mechanics

Shell Style/Model PK\*: Fixed receptacle with two nuts (back panel mounting), straight print contacts  
Keying 1 key (alpha=0; Plug: male contact; Receptacle: female contact)  
Housing Material PSU (Polysulfone), black  
Variant N : Black front nut  
Weight 4.78 g

### Performance

Configuration 1P.M07 : 7 Low Voltage  
Insulator L: PEEK (UL 94 / V-0/1.5)  
Rated Current 5 Amps

### Specifications

Contact Type: Print (straight)  
Contact Dia.: 0.7 mm (0.0275in)  
R (max): 6.5 mOhm  
Test voltage (kV rms) Contact-contact: 1.05  
Air clearance min.: 0.85 mm  
Creepage distance min.: 0.85 mm

*LEMO products and services are provided "as is". LEMO makes no warranties or representations with regard to LEMO product & services or use of them, express, implied or statutory, including for accuracy, completeness, or security. The user is fully responsible for his products and applications using LEMO components.*

## Others

Endurance (Shell): >2000 mating cycles

Temp (min / max): -50°C / +150°C

F ret (min): 50 N

F ret (max): 150 N

Steam sterilization: > 100 times (with potting on rear connection)

---

## DRAWINGS

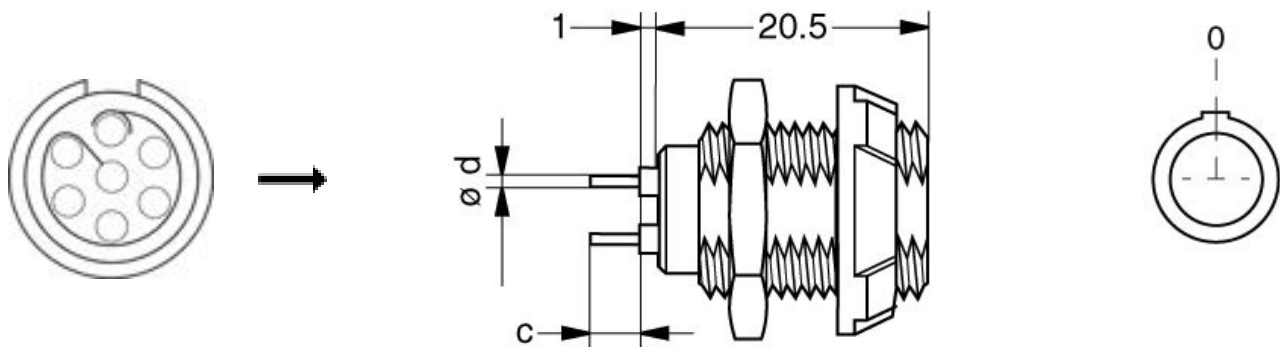

## Dimensions

	c	d
mm.	3-5	0.5-0.7
in.	0,12	0,02

---

## RECOMMENDED BY LEMO

## Tools

LEMO products and services are provided "as is". LEMO makes no warranties or representations with regard to LEMO product & services or use of them, express, implied or statutory, including for accuracy, completeness, or security. The user is fully responsible for his products and applications using LEMO components.

# Mouser Electronics

Authorized Distributor

Click to View Pricing, Inventory, Delivery & Lifecycle Information:

[LEMO:](#)

[PKG.M0.7NL.NN](#)