

SUMMARY

Wires

Low voltage 67



Image is for illustrative purpose only

Series 1R
Termination type Female print PCB
IP rating 50
AWG wire size 0.00 - 0.00
Cable Ø 0.00 - 0.00 mm
Status active

Download

[Request a quote](#)
[PCB Eagle Pattern](#)
[PCB Altium Pattern](#)
[PCB KiCad Pattern](#)
[Catalog](#)

TECHNICAL DETAILS

Mechanics

Shell Style/Model EBG*: Fixed receptacle, key (G) or key (A) with visible shell
Keying 3 keys (alpha=50,beta=30, plug: male contacts, receptacle: female contacts)
Housing Material Crastin® PBT (Polybutylene terephthalate), blue
Weight 16.72 g

Performance

Configuration 1R.367 : 67 low voltage
Insulator L: PEEK (UL 94 / V-0/1.5)
Rated Current 0.5 Amps

Specifications

Contact Type: Print (straight)

Others

LEMO products and services are provided "as is". LEMO makes no warranties or representations with regard to LEMO product & services or use of them, express, implied or statutory, including for accuracy, completeness, or security. The user is fully responsible for his products and applications using LEMO components.

DRAWINGS

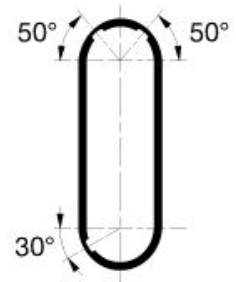
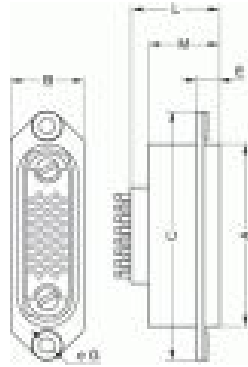

Dimensions

	A	B	L	M
mm.	24.5	9	30.5	23.5
in.	0,96	0,35	1,20	0,93

RECOMMENDED BY LEMO

Tools

LEMO products and services are provided "as is". LEMO makes no warranties or representations with regard to LEMO product & services or use of them, express, implied or statutory, including for accuracy, completeness, or security. The user is fully responsible for his products and applications using LEMO components.

Mouser Electronics

Authorized Distributor

Click to View Pricing, Inventory, Delivery & Lifecycle Information:

[LEMO:](#)

[EBG.1R.367.ALN](#)