

ACTUAL SIZE

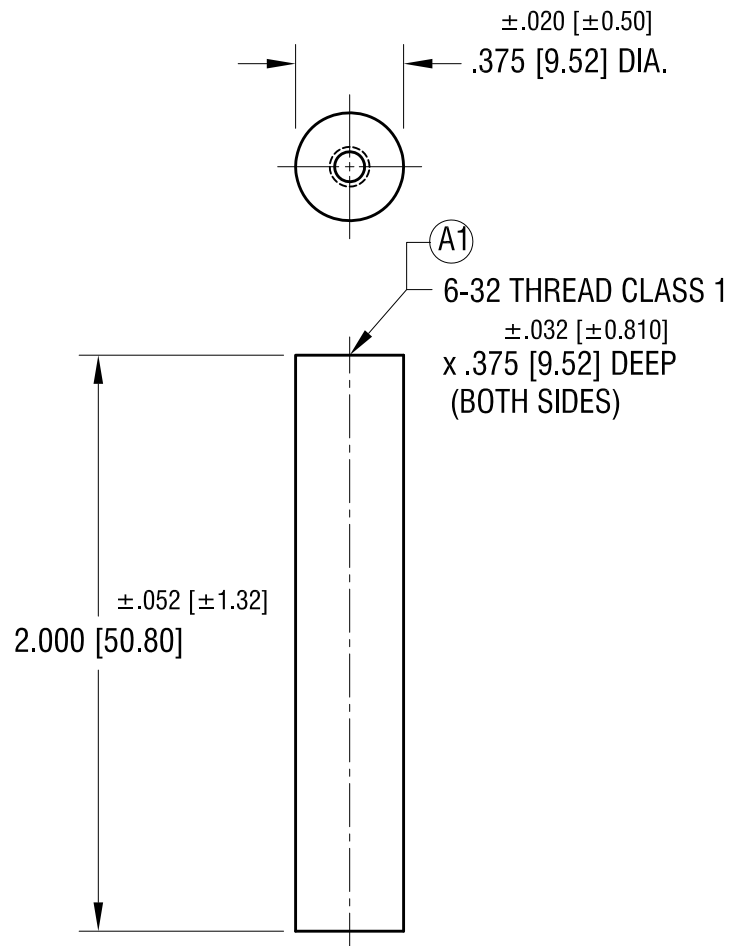

NOTE:

1. MARKED WITH NL #: NL523W01-016

|         |  |      |
|---------|--|------|
| 3.30.22 | A1 WAS .3750±.020 DEEP<br>CHANGE AS PER ECN 22-065 | A    |
| DATE    | DESCRIPTION  | REV. |

| KEYSTONE ELECTRONICS CORP.                                   |               |                  |              |
|--|---------------|------------------|--------------|
| www.keyelco.com • NEW HYDE PARK NY 11040 • Tel (516)328-7500 |               |                  |              |
| PART NAME  |               | CERAMIC STANDOFF |              |
| MATERIAL   |               | GRADE L5 CERAMIC |              |
| FINISH   |               | GLAZED           |              |
|  |               | DRN BY BOONE     | DATE 2.09.98 |
|  |               | APP'D RH         | SCALE 1X     |
| TOLERANCES   | INCH [MM]     | CODE             | DWG NO.      |
| DECIMAL  | ±.005 [±0.13] | C                | 7676         |
| ANGULAR  | ± 1°          |                  |              |
| UNLESS OTHERWISE SPECIFIED                                   |               |                  |              |

# Mouser Electronics

Authorized Distributor

Click to View Pricing, Inventory, Delivery & Lifecycle Information:

[Keystone Electronics:](#)

[7676](#)