

**KEMET Part Number: ERP610W222KDRU**  
(C835DR222K760J, ERP610VH4220KDRU)

**KEMET**  
a YAGEO company

ERP610 SFTY X1-760 Y1-500, Ceramic, 2200 pF, 10%, 760 VAC (X1), 500 VAC (Y1), Y5U, Lead Spacing = 10mm

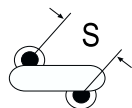
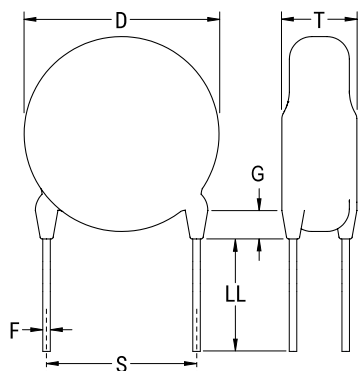

The measurement position of Lead Spacing (S) and Width (V) is critical in straight lead capacitors.

#### Dimensions

<b>D</b>	12mm MAX
<b>H</b>	18mm +2mm
<b>T</b>	5mm MAX
<b>S</b>	10mm +/-0.8mm
<b>F</b>	0.6mm +/-0.05mm
<b>G</b>	3mm MAX
<b>V</b>	2.1mm +/-0.5mm

#### Packaging Specifications

<b>Packaging:</b>	T&R, H = 18mm, Component Pitch = 25.4mm
-------------------	---

#### General Information

<b>Series:</b>	ERP610 SFTY X1-760 Y1-500
<b>Style:</b>	Radial Disc
<b>Description:</b>	Ceramic Single Layer Safety Disc Capacitors
<b>RoHS:</b>	Yes
<b>Termination:</b>	Tin
<b>Qualifications:</b>	UL, CSA, CAN, ENEC, VDE
<b>AEC-Q200:</b>	No
<b>Notes:</b>	Please See Bulletin For Taping Information. H Dimension Refers to Seating Plane To Center Hole of Tape.

#### Specifications

<b>Capacitance:</b>	2200 pF
<b>Capacitance Tolerance:</b>	10%
<b>Voltage AC:</b>	760 VAC (X1), 500 VAC (Y1)
<b>Temperature Range:</b>	-40/+125°C
<b>Temperature Coefficient:</b>	Y5U
<b>Dissipation Factor:</b>	2.5%
<b>Insulation Resistance:</b>	10 GOhms
<b>Safety Class:</b>	X1/Y1

Statements of suitability for certain applications are based on our knowledge of typical operating conditions for such applications, but are not intended to constitute - and we specifically disclaim - any warranty concerning suitability for a specific customer application or use. This Information is intended for use only by customers who have the requisite experience and capability to determine the correct products for their application. Any technical advice inferred from this Information or otherwise provided by us with reference to the use of our products is given gratis, and we assume no obligation or liability for the advice given or results obtained.

**KEMET**  
a YAGEO company

# Mouser Electronics

Authorized Distributor

Click to View Pricing, Inventory, Delivery & Lifecycle Information:

[KEMET:](#)

[C835DR222K760J](#)