

MICRO SWITCH
a Honeywell Division

FED. MFG. CODE 91929

SWITCH-BASIC

CATALOG LISTING
V7-1A37D8-000-3

CW-B0088

CATALOG LISTING
V7-1A37D8-000-3
REPLACES
RELEASE NO. PR-19025

ISSUE
M
3

REVISIONS

A	PR-19025	J A P	11 MAR 91
B	CO-76108	LJF	20 OCT 93

CHECK

CHECK

CHECK

CHECK

CHECK

CHECK

CHECK

CHECK

CHECK

CHECK

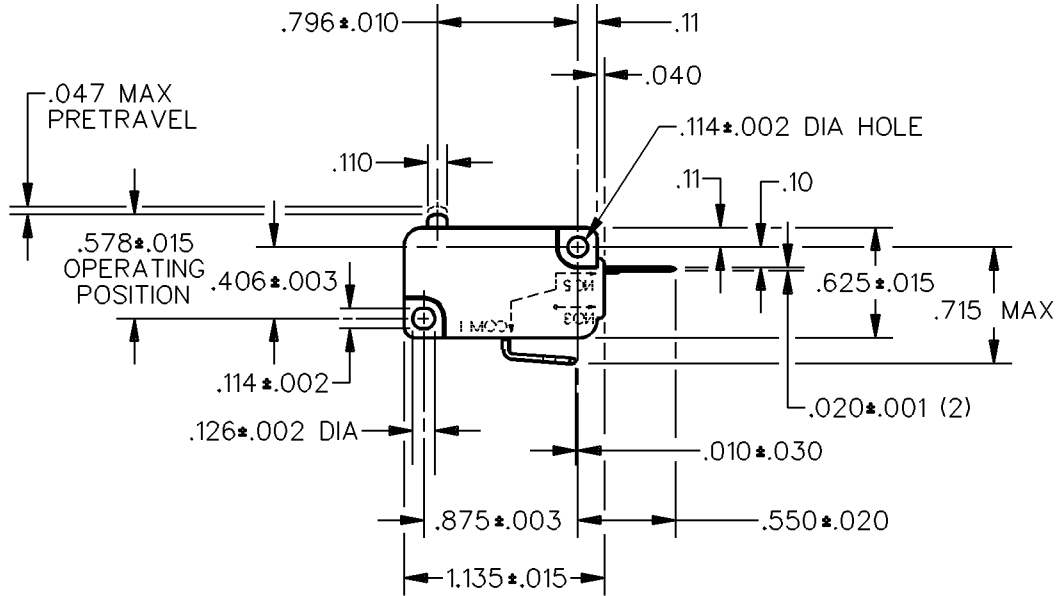
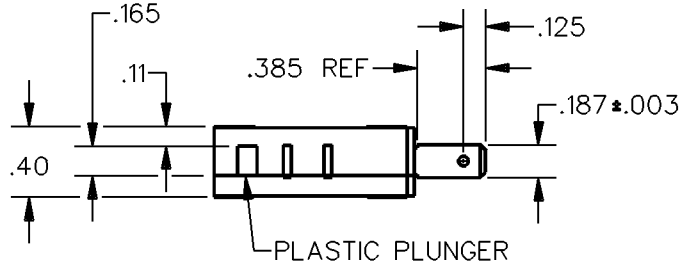

NOTE
1 - SWITCH WILL OPERATE AND RELEASE WITHIN FULL EXCURSION OF THE PLUNGER

THIS DRAWING COVERS A PROPRIETARY ITEM AND IS THE PROPERTY OF MICRO SWITCH, A DIVISION OF HONEYWELL. THIS DRAWING IS NOT TO BE COPIED OR USED WITHOUT THE APPROVAL OF MICRO SWITCH.

THIRD ANGLE PROJECTION

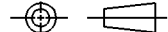

CHARACTERISTICS	ELECTRICAL DATA	SCALE FULL	DO NOT SCALE PRINT
OPERATING FORCE — — — 150 GRAM MAX	CONTACT ARRANGEMENT S P N C	UNLESS OTHERWISE SPECIFIED TOLERANCES ARE	
RELEASE TRAVEL — — — — .010 MIN		ONE PLACE (.0) ±.030	
RELEASE FORCE — — — 25 GRAM MIN	L162 5A 125, 250, 277 VAC 1/10HP 250 VAC	TWO PLACE (.00) ±.015	
DIFFERENTIAL TRAVEL — — — .002-.010		THREE PLACE (.000) ±.005	
OVERTRAVEL — — — — .050 MIN		ANGLES ±	
FREE POSITION — — — — .625 MAX	WEIGHT		



DDM/CAD
DRAWN

T J A 19 DEC 89

Mouser Electronics

Authorized Distributor

Click to View Pricing, Inventory, Delivery & Lifecycle Information:

[Honeywell:](#)

[V7-1A37D8-000-3](#)